

ACHIEVE

FACILITIES MAINTENANCE CENTER

3300 COLLEGE DRIVE, SAN BRUNO BLVD. CA 94066



47811 WARM SPRINGS BLVD.
FREMONT, CA 94539
OFFICE: 510.771.1200
FAX: 510.252.0109

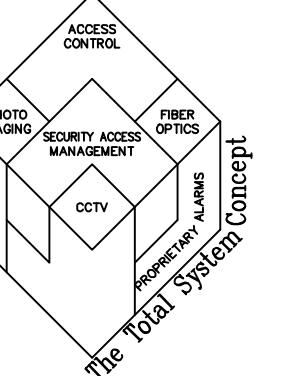

GENERAL NOTES

GENERAL CONDITIONS:

- ALL WORK TO BE IN ACCORDANCE WITH REQUIREMENTS OF GOVERNING LOCAL FIRE CODES AND BUILDING CODES.
- VERIFY ALL EXISTING DIMENSIONS AND CONDITIONS PRIOR TO STARTING CONSTRUCTION, NOTIFY OWNER'S REPRESENTATIVE OF ANY DISCREPANCIES FOUND. VERIFY DIMENSIONS OF ALL OWNER FURNISHED OPERATING EQUIPMENT TO ENSURE PROPER COORDINATION WITH CONSTRUCTION.
- SCHEDULE ALL WORK, INCLUDING CONSTRUCTION ACCESS AND STORAGE, WITH THE OWNERS OR THOSE DESIGNATED BY THE OWNERS.
- ALL UTILITIES REQUIRED FOR THE CONTINUOUS OPERATION OF ALL EXISTING FACILITIES MUST BE MAINTAINED IN SERVICE AT ALL TIMES.
- WHERE EXISTING CONSTRUCTION IS CUT, DAMAGED OR REMODELED, PATCH WITH MATERIALS TO MATCH IN KIND, QUALITY AND PERFORMANCE.
- THE WORK DELINEATED IN THE DRAWING "SET" DRAWING SHEETS SHALL BE PERFORMED BY THE CONTRACTOR. THE CONTRACTOR SHALL BE RESPONSIBLE TO PROVIDE AND INSTALL ALL WORK. WORK SUB-CONTRACTED BY THE CONTRACTOR (SUCH AS DOOR HARDWARE, CONDUIT, 120VAC POWER & AUTOMATIC DOOR OPERATOR INTERFACES) SHALL BE THE RESPONSIBILITY OF THE CONTRACTOR.
- THE CONTRACTOR SHALL COMMUNICATE PROGRESS SCHEDULE, AND COORDINATE ISSUES. CONTRACTORS SHALL WORK TOGETHER TO DEVELOP ACCEPTANCE TESTING PROCEDURES FOR WORK TO BE PROVIDED BY THE OTHERS.

GENERAL CONSTRUCTION NOTES:

- ALL WORK SHALL BE IN ACCORDANCE WITH THE LATEST EDITION OF THE NATIONAL ELECTRICAL CODE. THE CONTRACTOR SHALL NOT INTERMIX ANY HIGH VOLTAGE POWER WIRES (120 VAC) WITH ANY SIGNAL OR CONTROL WIRES IN ANY CONDUIT.
- THE CONTRACTOR SHALL CLEAN AND THOROUGHLY CHECK ALL INSTALLED WORK PRIOR TO CONCEALING OF ARCHITECTURAL FINISHING. THE CONTRACTOR SHALL ALSO REPAIR OR CLEAN ALL SOILED OR PAINTED SURFACES OR DAMAGED ARCHITECTURAL FINISHES TO MATCH WITH THE ADJACENT AREA WHERE REQUIRED. PATCHING OR PAINTING SHALL BE DONE TO BRING THE AFFECTED SURFACE OR FINISH BACK TO ITS ORIGINAL CONDITION.
- ALL SECURITY DEVICES AND EQUIPMENT SHALL BE INSTALLED WITH CONSIDERATION TO BARRIER FREE ACCESSIBILITY, AS DEFINED IN CALIFORNIA TITLE 24.
- THE CONTRACTOR SHALL FIELD VERIFY CONDITIONS FOR ALL WORK PRIOR TO MAKING HIS SUBMITTAL. HE SHALL IDENTIFY WHERE A SPECIFIED DEVICE TYPE OR MOUNT WORK AND RECOMMEND THE APPROPRIATE PRODUCT FOR THAT SITUATION AS PART OF HIS SUBMITTAL.

ELECTRICAL RACEWAYS AND POWER:

- CONDUITS WHERE INSTALLED SHALL BE FILLED TO NOT MORE THAN 40%.
- ALL ROUTES OF CABLES AS SHOWN ON PLANS ARE DIAGRAMMATIC. CONTRACTOR TO FIELD VERIFY EXACT ROUTING. CONDUIT STUB-OUTS SHALL BE INSTALLED WHERE CABLES ARE TO RUN CONCEALED INSIDE WALLS.
- CONDUITS SHALL BE SIZED AS INDICATED ON THE DRAWINGS. WHERE NOT SHOWN, PROVIDE A DIAMETER OF 3/4" CONDUIT WHERE SIZE IS NOT SPECIFIED.
- ALL PULL OR JUNCTION BOXES SHALL BE PROVIDED WITH BLANK COVERS. ALL WIREWAY AND BOXES SHALL BE PROVIDED WITH TAMPER-PROOF SCREWS. OUTDOOR INSTALLED BOXES SHALL BE THE WEATHER-PROOF TYPE.
- ALL BOX COVERS FLUSHED IN CEILING OR WALL LOCATED IN ANY OFFICE OR PUBLIC AREAS SHALL BE PAINTED TO MATCH THE COLOR OF THE ADJACENT SURFACE.
- THE CONTRACTOR SHALL PROVIDE FIRE RATING PENETRATION WHERE CONDUITS ARE RUNNING THROUGH FIRE RATED WALLS OR FLOORS. SEE DETAIL ON ELECTRICAL DRAWINGS. CORRIDOR WALLS ARE RATED AT 1 HOUR & FLOOR PENETRATIONS ARE RATED AT 2 HOURS.
- ALL BACKBOXES FOR SECURITY DEVICES LOCATED ON WALLS SHALL BE FLUSHED.
- A GROUND CONDUCTOR SHALL ALWAYS BE INSTALLED IN ANY POWER WIRING. ALL SECURITY EQUIPMENT UTILIZING ELECTRICAL POWER SHALL ALSO BE ADEQUATELY GROUNDING.
- EACH SINGLE PHASE 120 VAC WIRING TO ANY SECURITY DEVICE OR GROUP OF DEVICES SHALL BE SIZED AT 20 AMPS RATED FULL LOAD CURRENT.
- THE BRANCH CIRCUIT BREAKER SHALL BE LOCKABLE TYPE TO ENSURE THAT THERE WILL BE NO ACCIDENTAL SWITCH-OFF.
- CONDUITS RUNNING ACROSS BUILDING EXPANSION JOINTS SHALL BE PROVIDED WITH EXPANSION TYPE SLEEVE.
- ALL SECURITY RACEWAYS & BOXES SHALL BE LABELED AS "SECURITY". LARGE BOLD LETTERS SHALL BE PRINTED OR ATTACHED TO BOXES & RACEWAYS. CONTRACTOR SHALL PROVIDE SAMPLE LABELS FOR APPROVAL.
- CONDUITS INSIDE THE BUILDING SHALL BE CONCEALED IN WALLS AND CEILING SPACES AND SHALL BE EMT TYPE. UNDERGROUND CONDUIT SHALL BE SCHEDULE 80. CONDUITS EXPOSED TO MECHANICAL DAMAGE SHALL BE RIGID TYPE. ALL CONDUITS SHALL BE PROVIDED WITH PULL STRINGS. EXTERIOR/UNDERGROUND CONDUITS SHALL BE WEATHER TIGHT.

LOW VOLTAGE CABLES:

- ALL CABLE NUMBERS REFERRED TO ON THE PLANS OR SPECIFICATIONS ARE "WEST PENN" PART NUMBERS AND ARE LISTED AS A STANDARD CABLE QUALITY AND TYPE. ALL SECURITY CABLES SHALL BE CLASSIFIED FOR CLASS 2 AND 3 INSTALLATION FOR LOW-VOLTAGE WIRING.
- EACH SECURITY DEVICE SHOWN ON THE PLAN SHALL BE CABLED TO THE RESPECTIVE PANEL AS PER THE CABLE SCHEDULE. EACH CABLE RUN SHALL HAVE NO SPLICE IN BETWEEN UNLESS TWO OR MORE DEVICES ARE CONNECTED TO THE SAME ZONE OR THE DEVICE IS PROVIDED BY THE FACTORY WITH DIGITAL WIRES. WHERE SPLICING IS REQUIRED, IT SHALL BE DONE EITHER AT A SPECIAL TERMINAL BOX, AT THE BACKBOX OR AT THE DEVICE TERMINAL LUGS. NO TAPING OR WELDING OF WIRE LEADS IS ALLOWED. USE SUITABLE SIZE WIRE NUTS OR TERMINAL LUGS IN BLOCKS.
- ALL WIRES SHALL BE COLOR CODED AND SHALL BE CONNECTED IN A UNIFORM MANNER. TRANSPOSING OR CHANGING OF COLOR CODES SHALL NOT BE PERMITTED.
- A PRE-PRINTED WIRE MATERIAL MARKER WRAPPED IN ADHESIVE CLEAR PLASTIC SHALL BE PROVIDED TO THE FOLLOWING:
 - CABLES WITHIN 6" UPON ENTRY AT ANY SECURITY PANEL, TERMINATION OR SPLICING BOXES.
 - ALL WIRES LEADS WITHIN 2" FROM ANY TERMINAL BLOCK.
 THE CONTRACTOR SHALL SUBMIT SAMPLES OF MARKERS AND ANY NUMBERING OR MARKING SYSTEM FOR REVIEW AND APPROVAL PRIOR TO IMPLEMENTATION.

ABBREVIATIONS

GENERAL ABBREVIATIONS:

A.F.F.	ABOVE FINISHED FLOOR
A.G.L.	ABOVE GROUND LEVEL
AWG	AMERICAN WIRE GAUGE
BAS	BUILDING AUTOMATION SYSTEM
BKR	BREAKER
BLDG	BUILDING
B.P.	BOTTOM PLATE
C	CONDUIT
C.E.	CONTROLLER ELECTRONICS
CKT	CIRCUIT
CLG	CEILING
CONC.	CONCRETE
CONT.	CONTINUATION
DIAM.	DIAMETER
DI	DIMENSION
DPDT	DOUBLE POLE DOUBLE THROW
DWG.	DRAWING
ELECT.	ELECTRICAL
ELEV.	ELEVATION
EMT	ELECTRICAL METALLIC TUBING
EO	EXIT ONLY
FIN.	FINISHED
FLR.	FLOOR
GRD	GROUND
HZ	HERTZ MCC MARSHALL'S CONTROL CENTER
N.I.C.	NOT IN THE CONTRACT
NO.	NUMBER
O.C.	ON CENTER
PH	PHASE (ELECTRICAL)
PNL	PANEL
PTZ	PAN TILT ZOOM
PWR	POWER
RM	ROOM
RSC	RIGID STEEL CONDUIT
SECS	SECS SERVICE ENTRANCE CONTROL CENTER
SHIF	SHIFT
SER	SECURITY EQUIPMENT ROOM
TYP	TYPICAL
U.O.N.	UNLESS OTHERWISE NOTED
V	VOLTS
VAC	VOLTS ALTERNATING CURRENT
VDC	VOLTS DIRECT CURRENT
W	WIRE
WP	WEATHERPROOF
(E)	EXISTING
(F)	FUTURE
(N)	NEW
(R)	RELOCATED

LEGEND

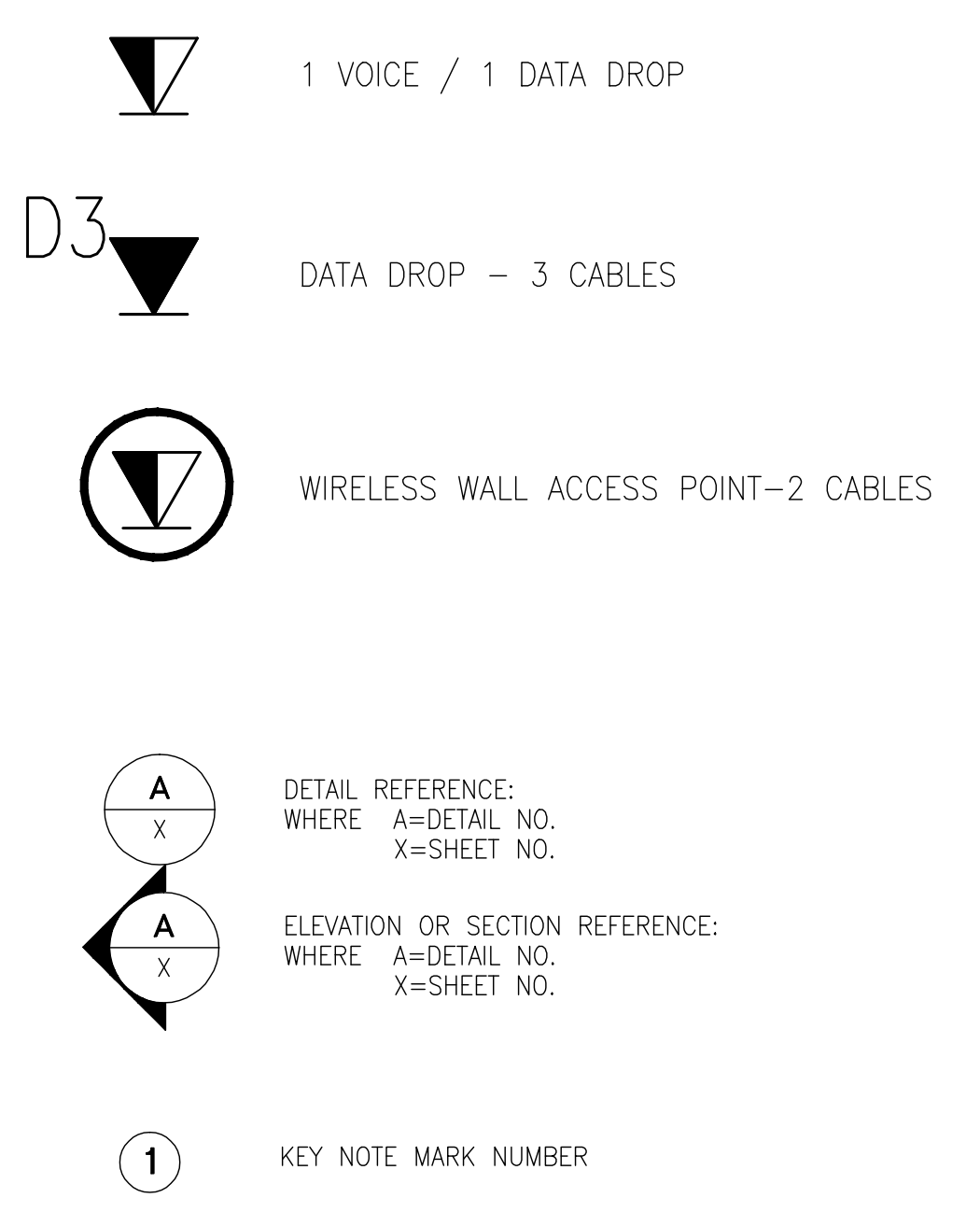

DRAWING INDEX

SCS-1.0	VOICE/DATA COMMUNICATION COVER SHEET & DRAWING INDEX
SCS-1.01	VOICE/DATA COMMUNICATION DEVICE LAYOUT PLAN FIRST LEVEL
SCS-1.02	VOICE/DATA COMMUNICATION DEVICE LAYOUT PLAN SECOND LEVEL

KEYPLAN:

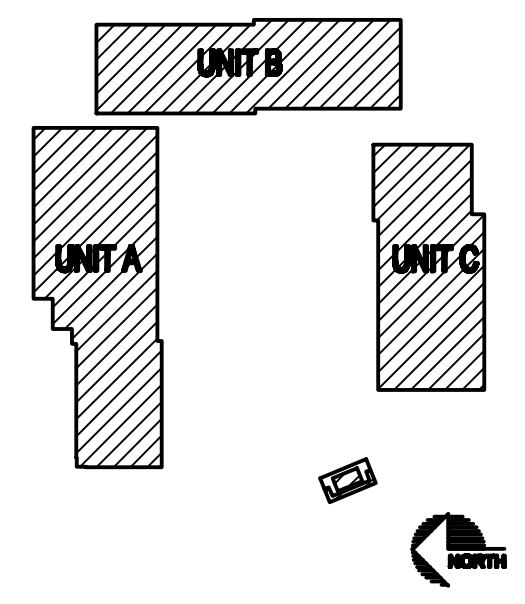

ISSUANCE:

AS BUILT DRAWINGS

PROPRIETARY INFORMATION
NO PART OF THIS DOCUMENT MAY BE COPIED, REPRODUCED OR TRANSMITTED IN ANY FORM OR BY ANY MEANS WITHOUT PRIOR WRITTEN CONSENT OF NETVERSANT.

REVISIONS

NO.	DATE	DESCRIPTION
1	9-4-09	REVISE FOR AS BUILTS

PROJECT:
SKYLINE COLLEGE
FACILITIES MAINTENANCE CENTER
3300 SAN BRUNO, CA 94066

SHEET TITLE:
TELECOMMUNICATIONS
COVER SHEET

CREATION DATE: ---
DRAWN BY: MLAYMAN
CHECKED BY: CMAUST
SCALE: NTS
JOB NO.:



SHEET NUMBER
SCS-1.0

SHEET 1 OF 3

GENERAL SHEET NOTES

1. REFER TO SECURITY SHEET SEC.2.01 AND SEC.2.02 FOR ADDITIONAL INFORMATION.

SYMBOL LEGEND:

-  1 VOICE / 1 DATA DROP
-  DATA DROP - 3 CABLES
-  WIRELESS WALL ACCESS POINT - 2 CABLES

A
SCS-1.02

1 TELECOMMUNICATIONS FMC SITE PLAN
SCALE: 1/8"=1'-0"

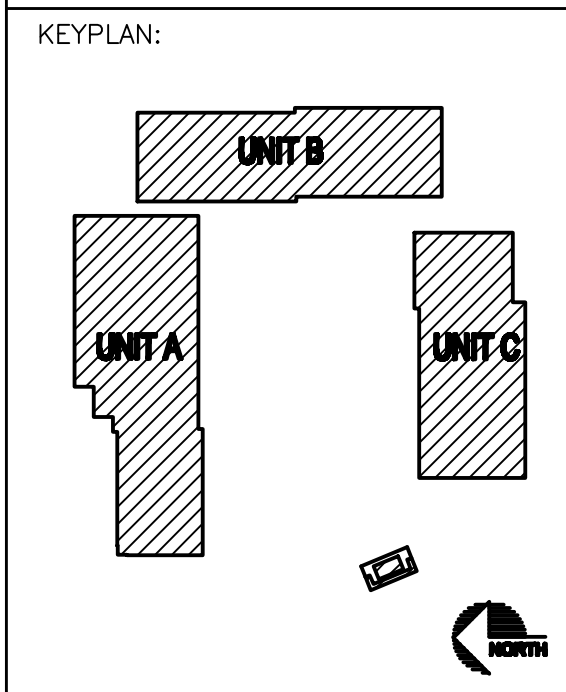

ISSUANCE:
AS BUILT DRAWINGS

PROPRIETARY INFORMATION
NO PART OF THIS DOCUMENT MAY BE COPIED, REPRODUCED OR TRANSMITTED IN ANY FORM OR BY ANY MEANS WITHOUT PRIOR WRITTEN CONSENT OF NETVERSANT.

REVISIONS

NO.	DATE	DESCRIPTION
1	9-4-09	REVISE FOR AS BUILTS

PROJECT:
SKYLINE COLLEGE
FACILITIES MAINTENANCE CENTER
3300 SAN BRUNO, CA 94066

SHEET TITLE:
TELECOMMUNICATIONS
FMC SITE PLAN

CREATION DATE: --
DRAWN BY: MLAYMAN
CHECKED BY: CMAUST
SCALE: NTS
JOB NO.:

SHEET NUMBER
SCS-1.01



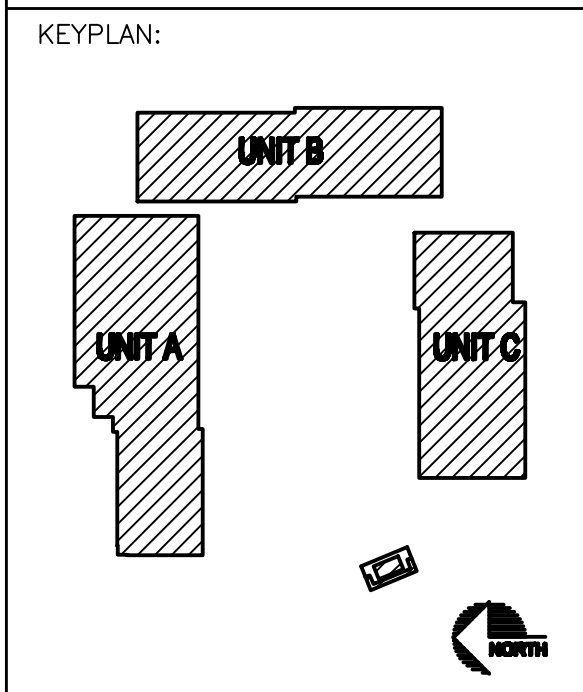
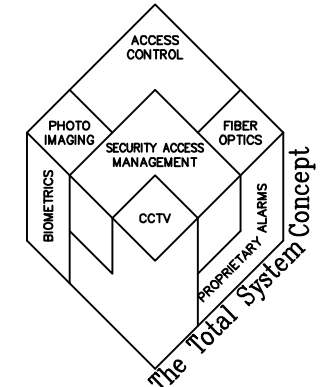

ISSUANCE:
AS BUILT DRAWINGS

PROPRIETARY INFORMATION
NO PART OF THIS DOCUMENT MAY BE COPIED, REPRODUCED OR TRANSMITTED IN ANY FORM OR BY ANY MEANS WITHOUT PRIOR WRITTEN CONSENT OF NETVERSANT.

REVISIONS

NO.	DATE	DESCRIPTION
9-4-09		REVISE FOR AS BUILTS

PROJECT:
SKYLINE COLLEGE
FACILITIES MAINTENANCE CENTER
3300 SAN BRUNO, CA 94066

SHEET TITLE:
TELECOMMUNICATIONS
DETAILS

CREATION DATE: --
DRAWN BY: MLAYMAN
CHECKED BY: CMAUST
SCALE: NTS
JOB NO.:
SHEET NUMBER

SCS-1.02
SHEET 3 OF 3



A CAT6-LAN PROTECTION MODULES
SCALE: NTS

Performance per TIA/EIA 568-B.2-1 Standard and Telco Specifications

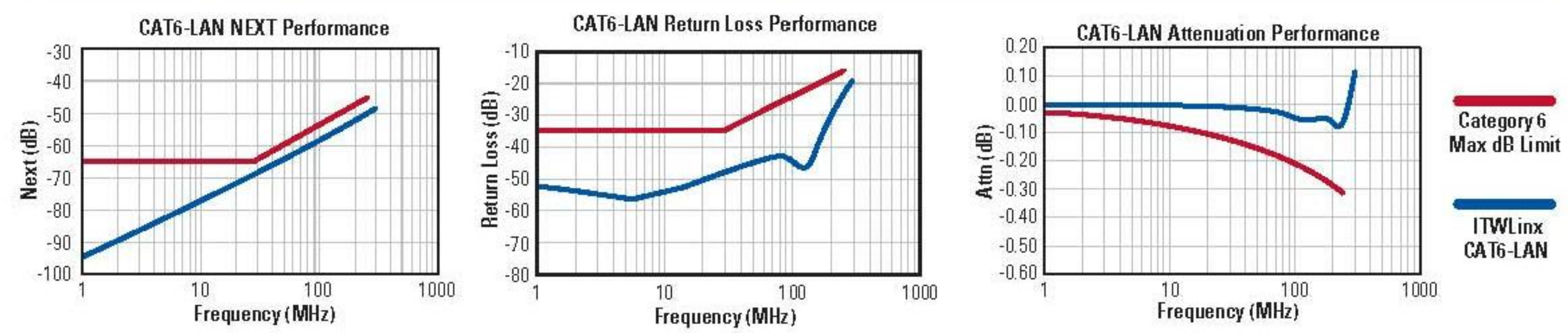

Multiple Building Installation—TIA/EIA 568-B & 758

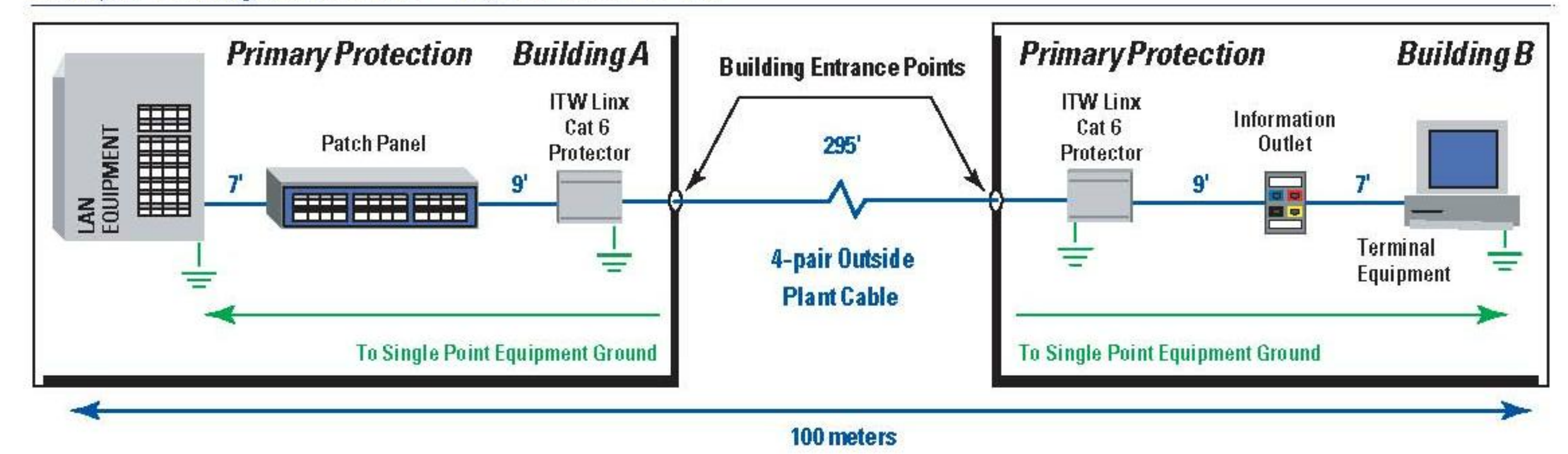

Single Building Installation—TIA/EIA 568-B & 758

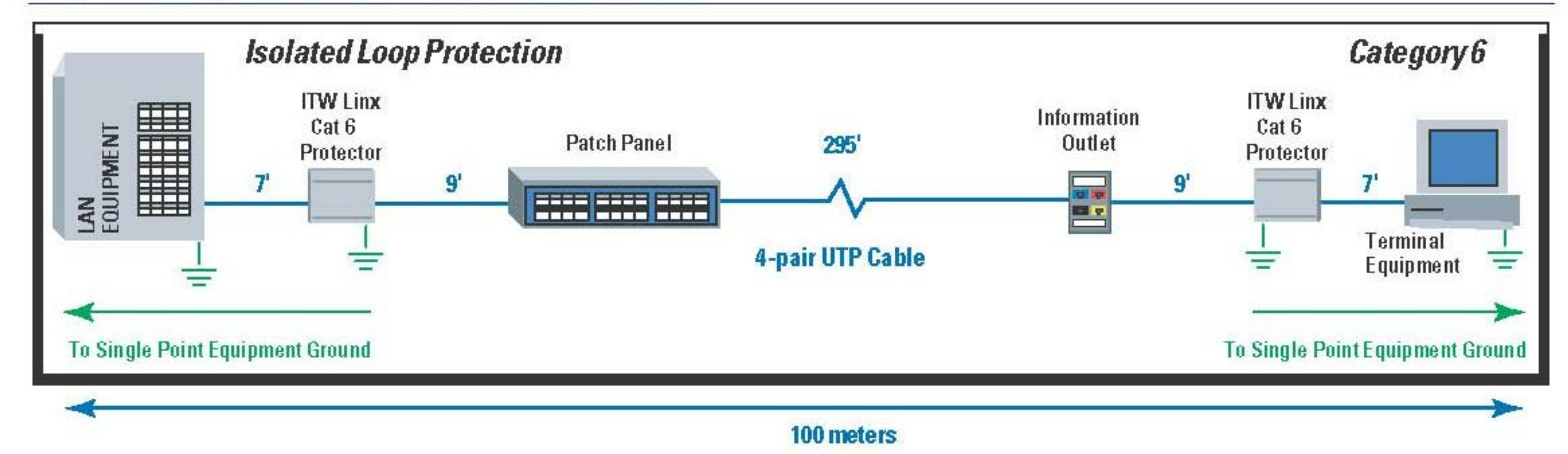

B CAT6-LAN PROTECTION MODULE SPECIFICATIONS
SCALE: NTS