

ALL MATERIALS, SERVICES, APPROPRIATELY MARKED AND REPRESENTED BY THIS DRAWING ARE OWNED BY AND THE PROPERTY OF VERDE DESIGN, INC. AND WERE CREATED, EVOLVED, AND DEVELOPED FOR USE AND IN CONNECTION WITH THE SPECIFIED PROJECT. NONE OF SUCH IDEAS, DESIGNS, ARRANGEMENTS OR PLANS SHALL BE USED, REPRODUCED, OR PUBLISHED IN WHOLE OR IN PART, OR DISCLOSED TO ANY PERSON, FIRM, OR CORPORATION FOR ANY PURPOSES WITHOUT THE WRITTEN PERMISSION OF VERDE DESIGN, INC.

SYM	DESCRIPTION	DTL REF
(A)	TRENCH DRAIN	(A)
(B)	4" BOTTOM OUTLET LOCATION	

GENERAL NOTES:

- CONTRACTOR SHALL FIELD VERIFY DIMENSIONS AND REVIEW SITE CONDITIONS PRIOR TO ORDERING MATERIALS.
- CONTRACTOR IS RESPONSIBLE FOR SURVEY AND LAYOUT, IF NEEDED.
- CONTRACTOR IS RESPONSIBLE FOR PATCHING/ RESTORING EXISTING CONDITIONS IN ORDER TO INSTALL WORK.

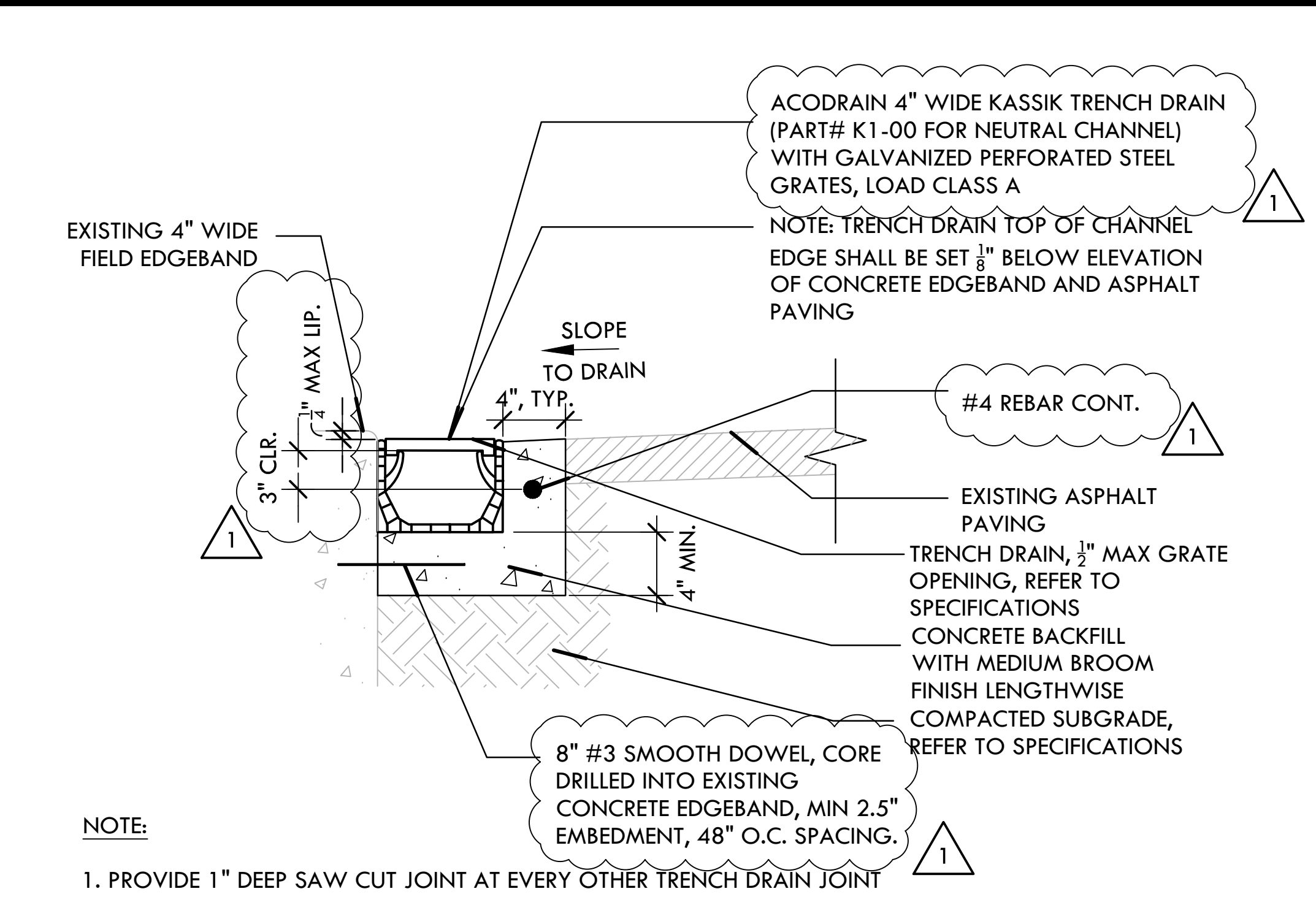

A TRENCH DRAIN NTS

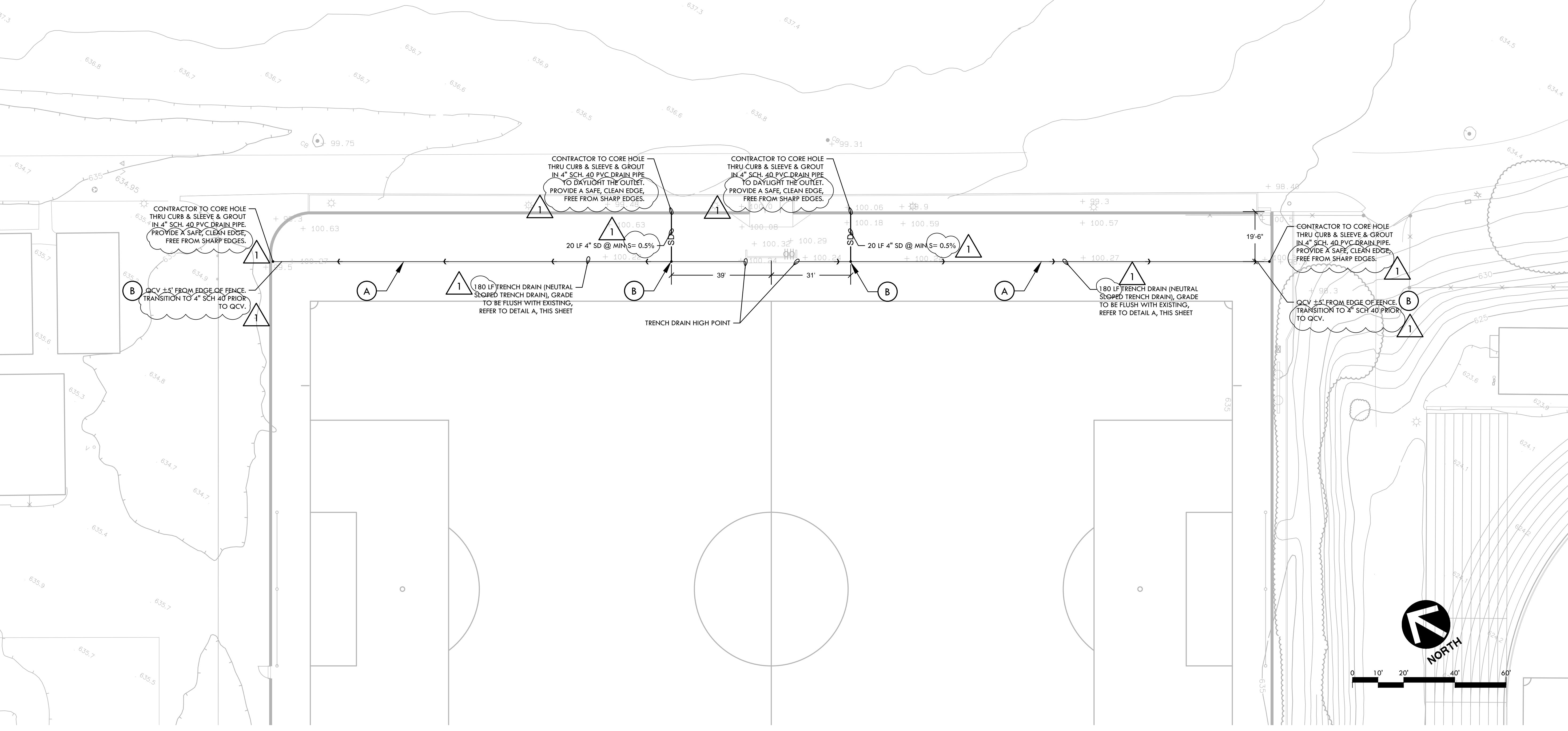

VERDE DESIGN
 LANDSCAPE ARCHITECTURE
 CIVIL ENGINEERING
 SPORT PLANNING & DESIGN

2455 The Alameda
 Santa Clara, CA 95050
 Tel: 408.985.7200
 Fax: 408.985.7260
 www.VerdeDesignInc.com

STAMP

CONSULTANT

SHEET TITLE

DRAINAGE PLAN

PROJECT NAME

**SKYLINE COLLEGE
 SOCCER FIELD
 IMPROVEMENTS**

PROJECT ADDRESS

**3300 COLLEGE DR.
 SAN BRUNO, CA
 94066**

SUBMITTAL	DATE
100% SUBMITTAL	12/15/14

NO.	REVISIONS	DATE
1	REVISION 1	3/27/15
2		
3		
4		
5		

DRAWN BY	CHECKED BY
JW	DC
DATE ISSUED	SCALE
12/15/14	1" = 20'-0"
PROJ. NO.	
1213400-1281	
SHEET NO.	
1	OF 1 SHEETS