

1

2 **SIDEWALL OVERHANG DETAIL**
SCALE: 3"=1'-0"

15 **TYP. CHANNEL BEAM @ CORNERS**
SCALE: 3"=1'-0"

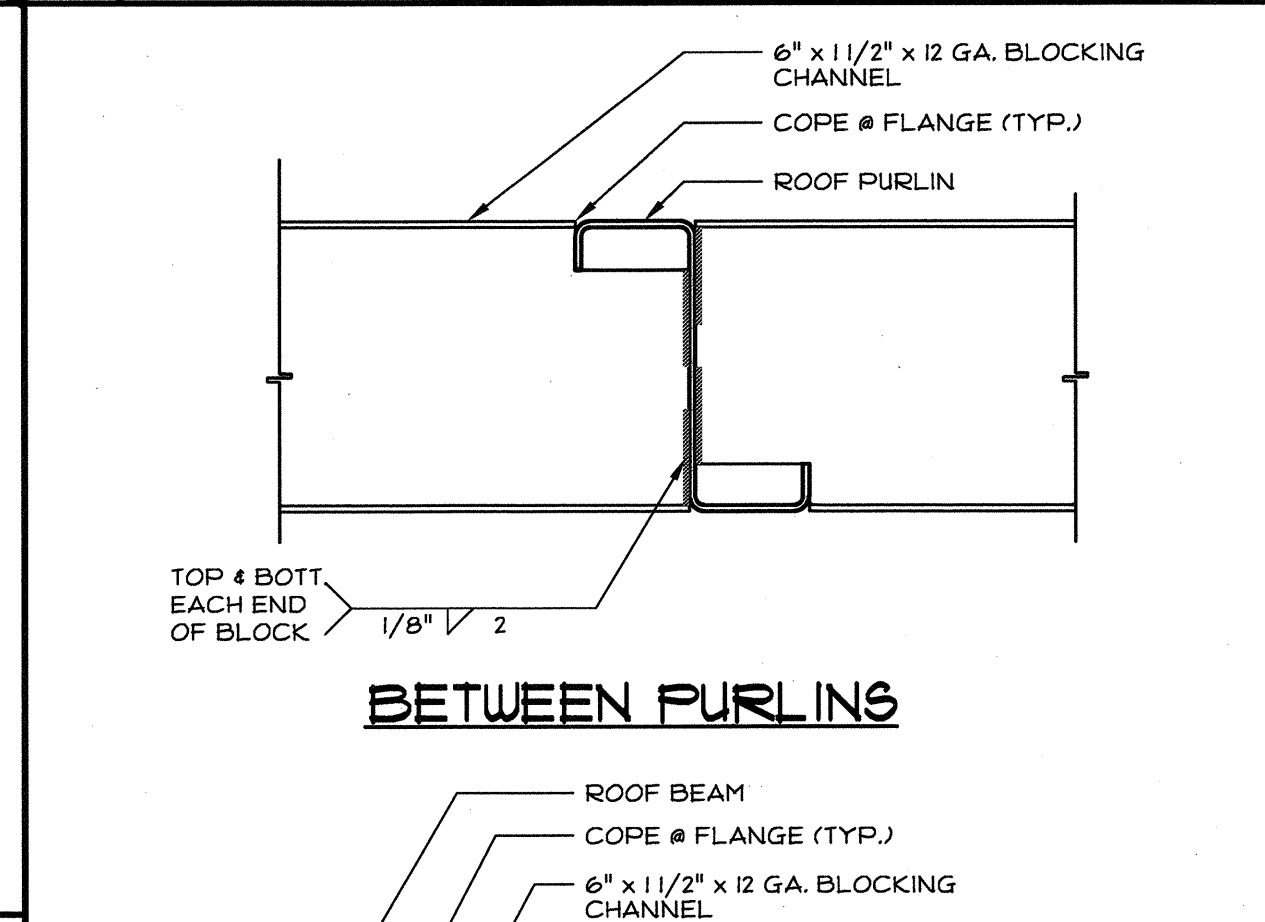
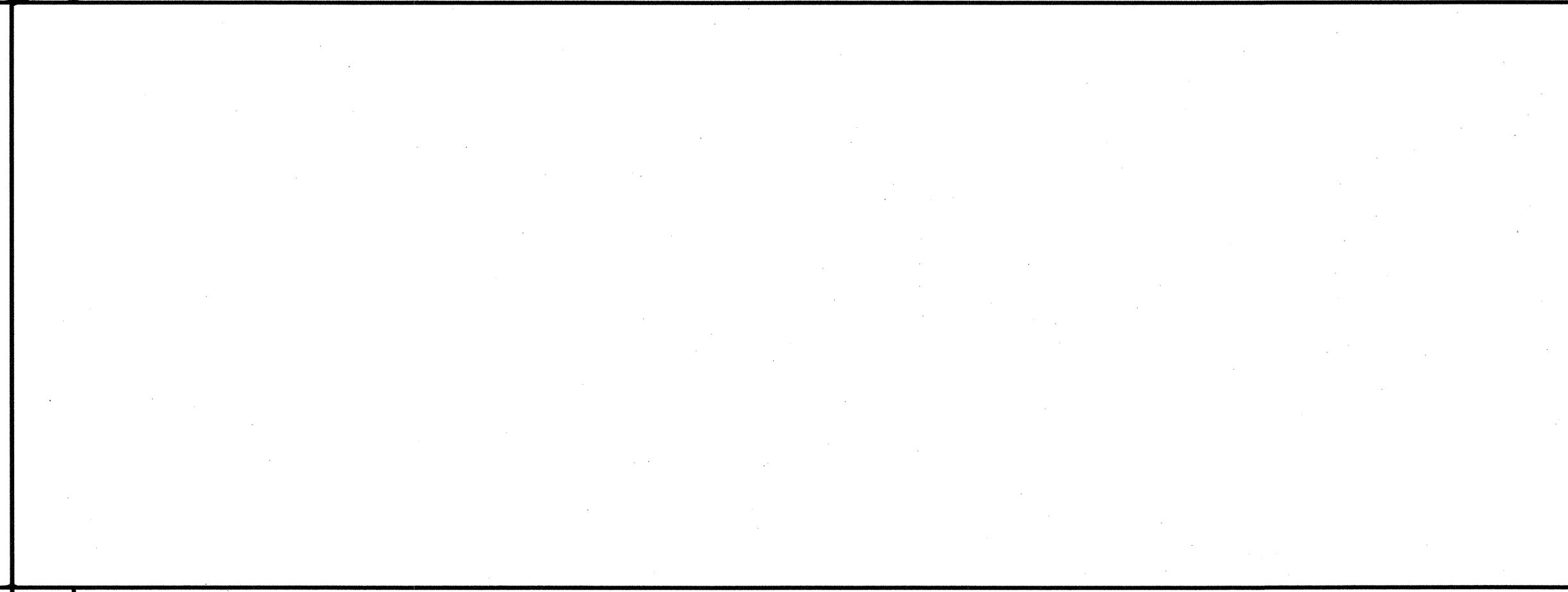
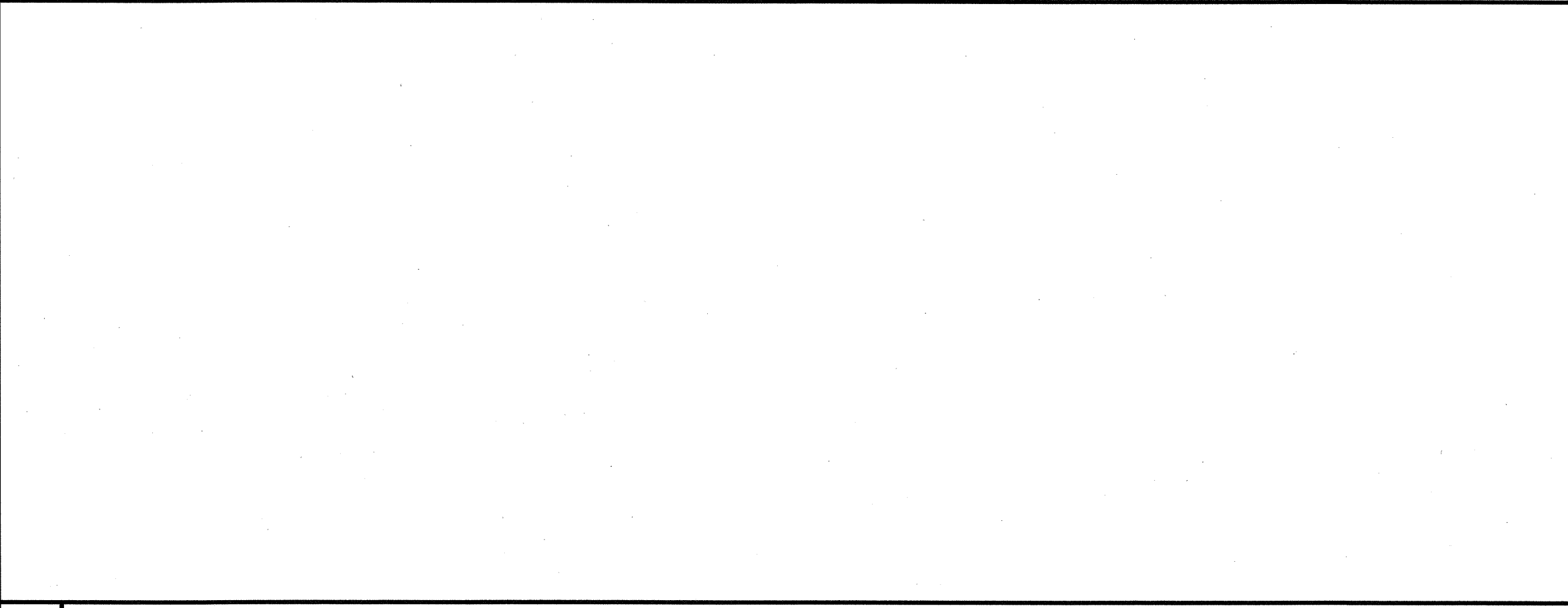

3

4

11 **TYP. CHANNEL BLOCK INSTALLATION**
SCALE: 3"=1'-0"

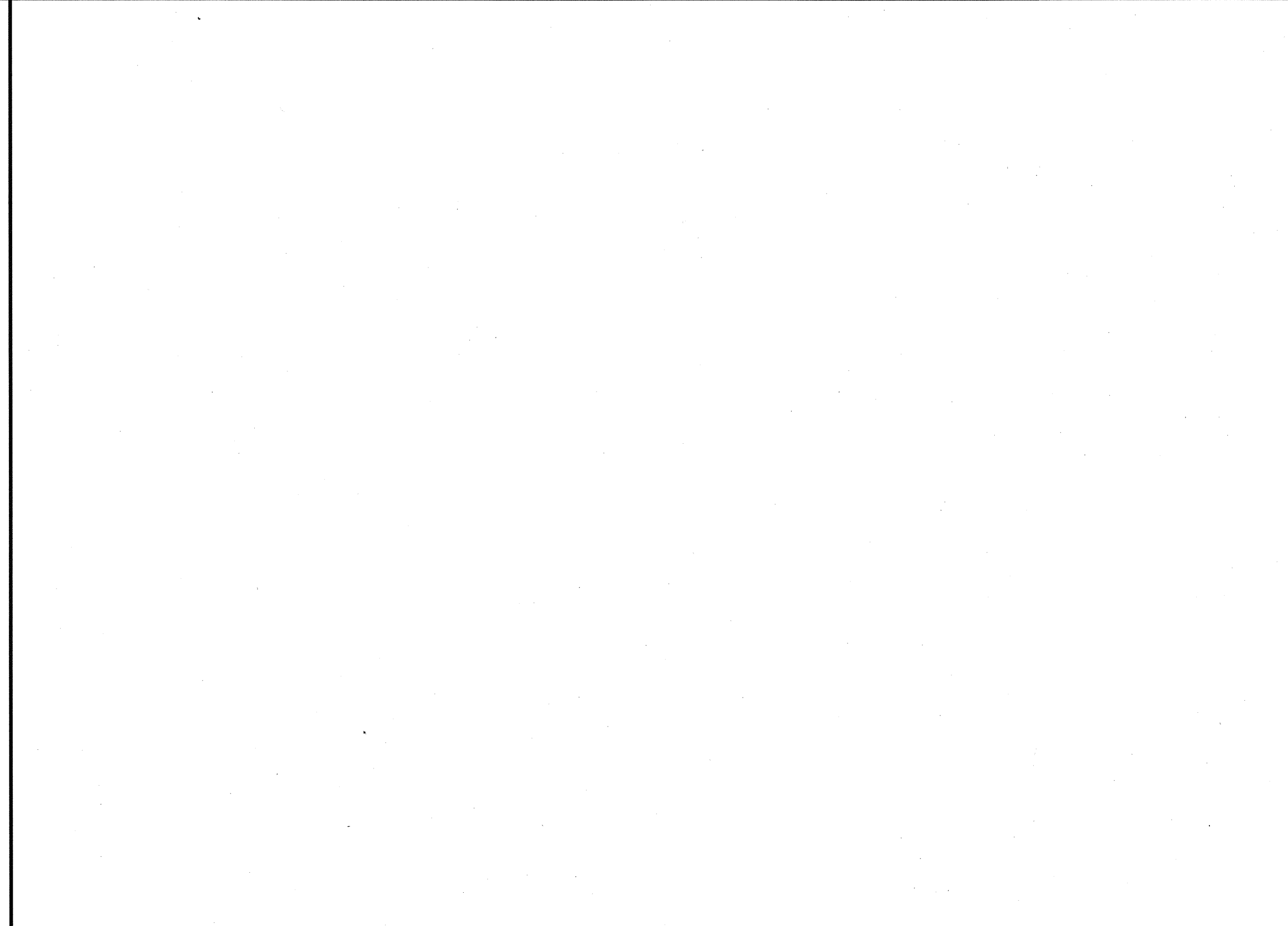

DIVISION OF THE STATE ARCHITECT

| | |
|-------------|----------|
| REV / DATE: | |
| JOB No.: | 12-19 |
| DRAWN BY: | JM |
| DATE: | 07-18-12 |

THIS MODULAR BLDG. HAS BEEN ENGINEERED BY A REGISTERED STRUCTURAL ENGINEER AND PREVIOUSLY REVIEWED & APPROVED BY THE DIVISION OF THE STATE ARCHITECT, FIRE & LIFE SAFETY AND ACCESS COMPLIANCE SECTION

12

14

APPROVALS

CYS
STRUCTURAL ENGINEERS INC.
1766 Creekside Oaks Dr., Suite 280
Sacramento, CA 95833
(916) 920-1556 FAX
www.cysinc.com

REGISTERED PROFESSIONAL ENGINEER
No. S2030
EXP. 9/30/13
STATE OF CALIFORNIA
STRUCTURAL ENGINEERING

THESE DRAWINGS ARE PRELIMINARY AND NOT FOR CONSTRUCTION UNLESS STAMPED & SIGNED BY THE ENGINEER OF RECORD.

ENVIROPLEX, INC.
4777 E. CARPENTER ROAD STOCKTON, CA. 95215, (209) 466-8000

1) 12'x40' RELOCATABLE RESTROOM BUILDINGS
FOR LA CANADA COLLEGE
SAI MATEO COMMUNITY COLLEGE DISTRICT

ALTERNATE STRUCTURAL DETAILS

PRELIMINARY

S4.1