

1 36' x 40' "70 P.S.F." WOOD FOUNDATION PLAN
SCALE: 1/4"=1'-0"

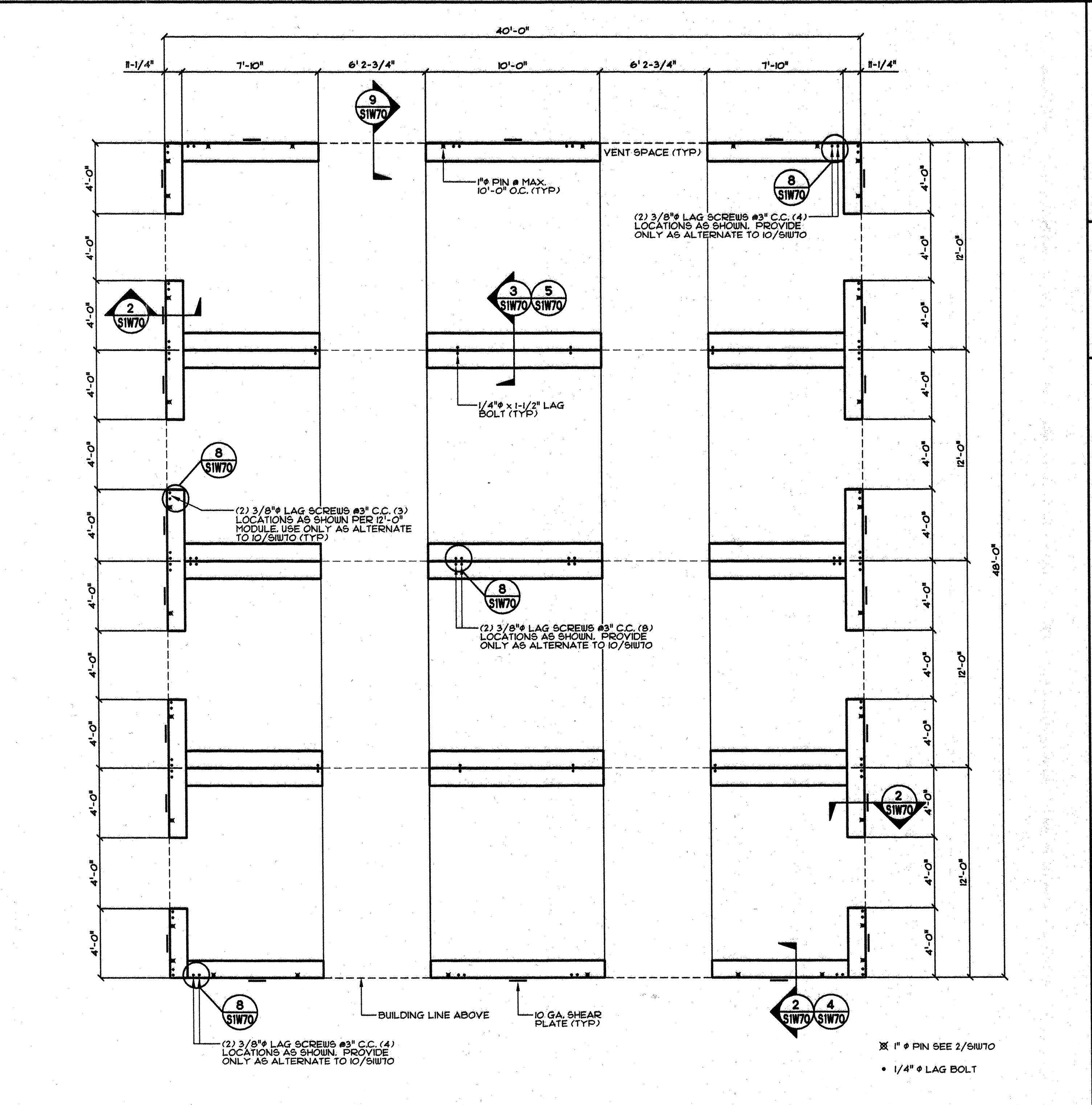

2 48' x 40' "70 P.S.F." WOOD FOUNDATION PLAN
SCALE: 1/4"=1'-0"

IDENTIFICATION STAMP DIVISION OF THE STATE ARCHITECT APPLD 104070 AC: FLS SS <i>CS/PT</i> DATE: 11/19/77	
PC IDENTIFICATION STAMP DIVISION OF THE STATE ARCHITECT 02-101236 AC: FLS SS <i>CS/PT</i> DATE: 11/19/77	DESIGN CRITERIA ROOF: DEAD LOAD - 8.0 PSF ROOF: LIVE LOAD - 20.0 PSF (SNOW) FLOOR: DEAD LOAD - 8.0 PSF FLOOR: LIVE LOAD - 50.0 PSF (OPRND) FLOOR: LIVE LOAD - 70.0 PSF (OPRND) FLOOR: LIVE LOAD - 100.0 PSF WALLS: DEAD LOAD - 8.0 PSF WIND: 80 MPH; EXPOSURE: C q _w =16.4 PSF; C _e =1.06; C _q AS REQ. SISMIC: ZONE 4.8+4.5, I _a =2.8, I _b =1.5, C _s =0.44, I _p =2.0, C _w =64.
CONFIDENTIAL MATERIAL - THESE DOCUMENTS ARE THE PROPERTY OF AND ARE NOT TO BE REPRODUCED OR DISTRIBUTED WITHOUT FULL KNOWLEDGE AND WRITTEN CONSENT FROM ENVIROPLEX, INC. © COPYRIGHT 1999 ENVIROPLEX, INC. (ALL DRAWINGS PREPARED BY ENVIROPLEX, INC.)	

3 APPROVAL

JH Lawder, Inc.
Structural Engineers
773 10TH STREET
MCKINNEY, TX 75069
(214) 961-1143 FAX (214) 961-1188

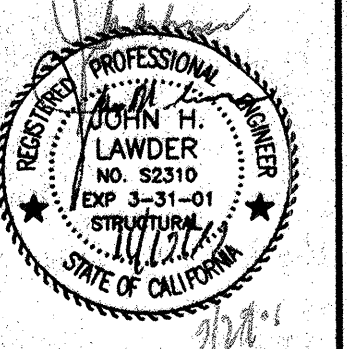

ENVIROPLEX, INC.
4777 E. CARPENTER ROAD STOCKTON, CA. 95215

70 P.S.F. WOOD FOUNDATION PLAN

REVISION DATE:	BY:

DATE:

THIS MODULAR BLDG. HAS BEEN ENGINEERED BY A REGISTERED STRUCTURAL ENGINEER & PREVIOUSLY REVIEWED & APPROVED BY THE DIVISION OF THE STATE ARCHITECT, FIRE & LIFE SAFETY AND ACCESS COMPLIANCE SECTION

SIW70A