

NO.	REVISIONS	DATE
1	10% SCHEMATIC DESIGN SUBMITTAL	03/2008
2	30% DESIGN DEVELOPMENT SUBMITTAL	03/2008
3	100% DESIGN DEVELOPMENT SUBMITTAL	03/2008
4	PERMITS	03/2008
5	PERMITS	03/2008
6	PERMITS	03/2008
7	PERMITS	03/2008
8	PERMITS	03/2008
9	PERMITS	03/2008
10	PERMITS	03/2008
11	PERMITS	03/2008

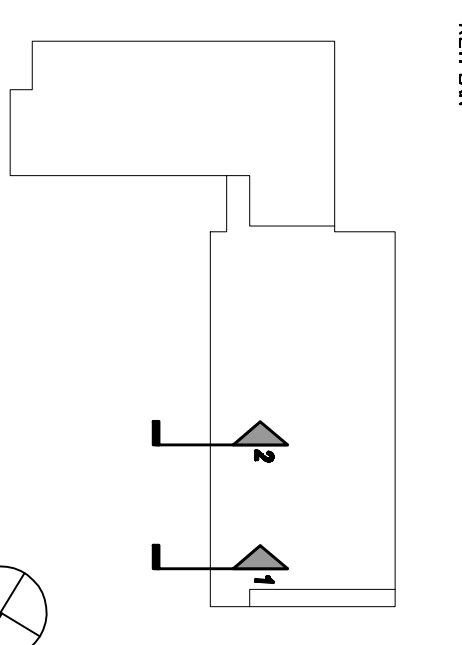

DIVISION OF THE  
 STATE ARCHITECT  
 APPL # 01-110117  
 FILE # AD-CL  
 AG \_\_\_\_\_ RS \_\_\_\_\_  
 SSS \_\_\_\_\_ DMK \_\_\_\_\_  
 IDENTIFICATION  
 STAMP

**SKYLINE COLLEGE**  
 SAN JUANITO COUNTY  
 COMMUNITY COLLEGE  
 DESIGN  
**CIP2 DESIGN-BUILD**  
**PROJECT**  
**BUILDING 4**  
**INCREMENT 2**



PROJECT NO: 0701200 DRAWN BY: JDC/CA  
 DATE: 04/2008 CHECKED BY:  
 SCALE: --

**WALL**  
**SECTIONS**

**AS BUILT DRAWINGS**  
 JANUARY 12, 2011

**PC-802**

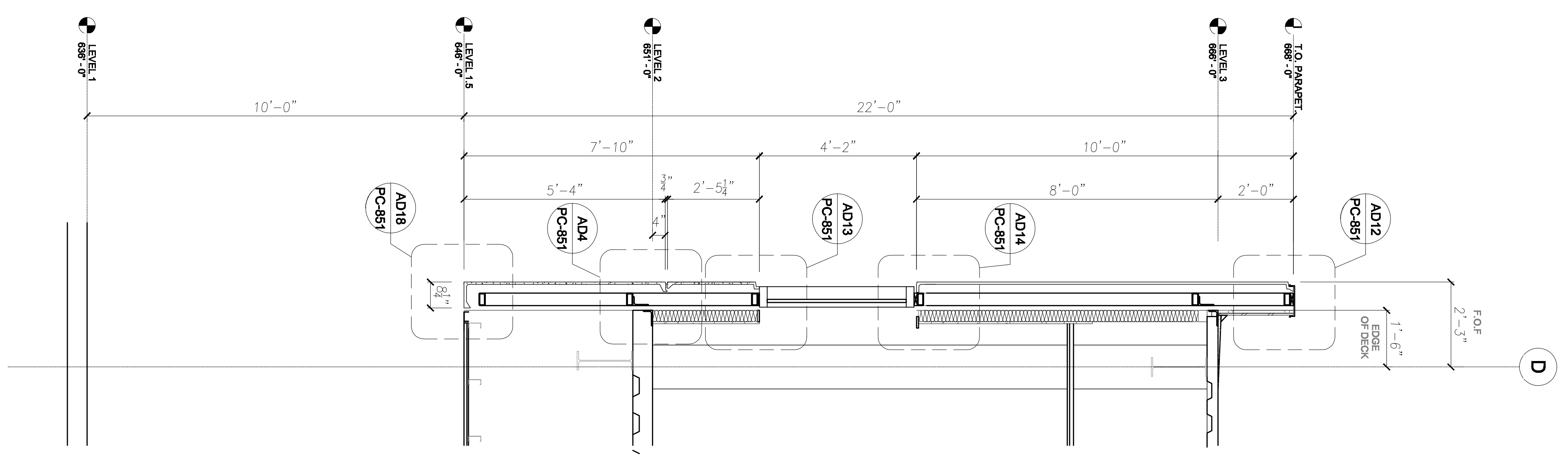

**2** SECTION BETWEEN 8/9  
 1/2" = 1'-0"

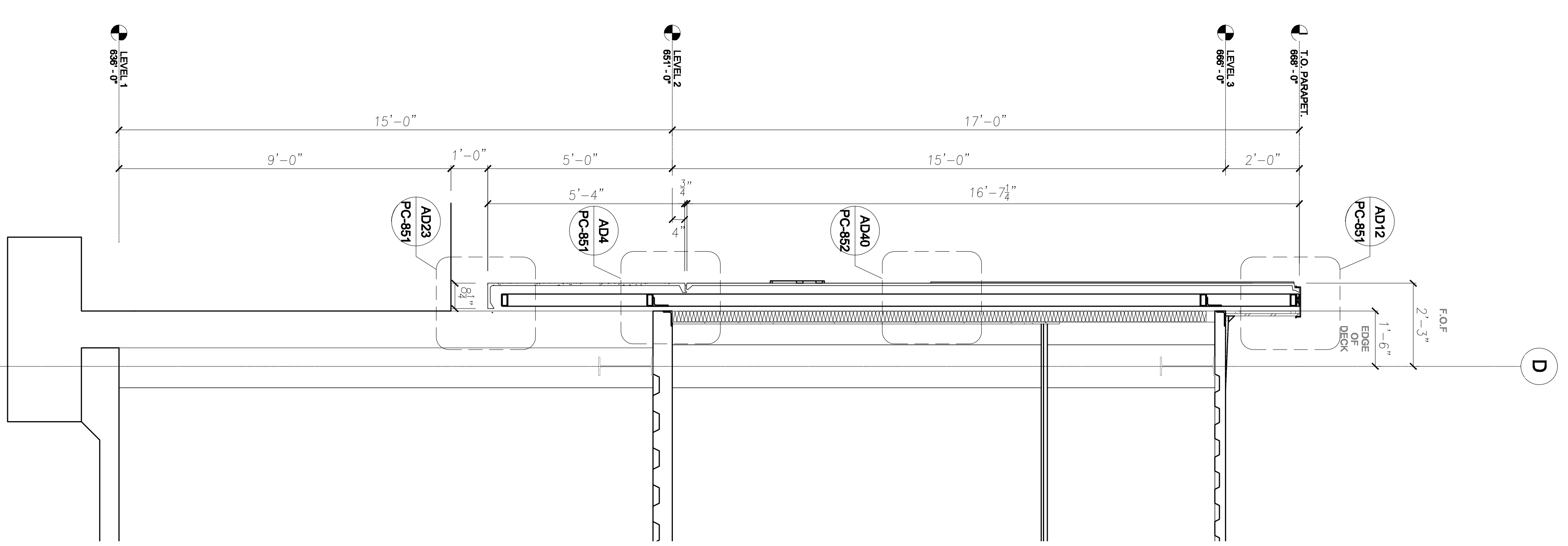

**1** SECTION BETWEEN 11.5/12  
 1/2" = 1'-0"

All drawings and sections are the property of the Architect. Any reproduction, use or disclosure without the consent of the Architect is prohibited.

This drawing is not for construction. It is for informational purposes only. It is not to be used for construction. The use of this drawing for construction is prohibited. The use of this drawing for construction is prohibited.