

NOTES:

- ONE BUBBLER SYMBOL IS SHOWN AT TREES FOR GRAPHIC CLARITY ONLY. INSTALL TWO BUBBLERS AT EACH TREE AS DETAILED.
- IRRIGATION EQUIPMENT MAY BE SHOWN WITHIN HARDSCAPE FOR GRAPHIC CLARITY ONLY. INSTALL ALL IRRIGATION EQUIPMENT WITHIN PLANTED AREAS. IRRIGATION PIPE AND WIRE CROSSING BENEATH HARDSCAPE SURFACES SHALL BE CONTAINED WITHIN SLEEVING OR SCHEDULE 40 PVC CONDUIT. SLEEVING SIZE SHALL BE A MINIMUM OF TWO TIMES THE AGGREGATE DIAMETER OF ALL PIPES CONTAINED WITHIN SLEEVE. PROVIDE VERTICAL SWEEP FOR ALL ELECTRICAL CONDUIT ON EACH SIDE OF HARDSCAPE AND TERMINATE ENDS AT 12" MINIMUM DEPTH AND 12" FROM HARDSCAPE SURFACE.
- UNSIZE LATERAL LINE PIPING LOCATED DOWN STREAM OF 1" PIPING SHALL BE 3/4" IN SIZE (TYPICAL).
- SIZING OF LATERAL PIPE SHALL BE AS FOLLOWS:

.75"	0-6 GPM
1"	7-12 GPM
1.25"	13-20 GPM
1.5"	21-32 GPM
2"	33-50 GPM
2.5"	51-70 GPM
3"	71-120 GPM

4" STUB-OUT AND REDUCED PRESSURE BACKFLOW ASSEMBLY FOR IRRIGATION FROM 8" DOMESTIC WATERLINE TO BE PROVIDED BY OTHER. MAXIMUM IRRIGATION DEMAND: 152 GPM AT A MINIMUM 80 PSI STATIC PRESSURE AT STUB-OUT LOCATION.

IRRIGATION CONTROLLER "A,B". MOUNT ON PEDESTAL AT THIS LOCATION AS DETAILED AND AS DIRECTED BY ARCHITECT. CONNECT TO 120 VOLT A.C. ELECTRICAL SERVICE INSTALLED AT THIS LOCATION UNDER ELECTRICAL CONTRACT. IRRIGATION CONTRACTOR SHALL COORDINATE LOCATION OF ELECTRICAL SERVICE PRIOR TO CONSTRUCTION.

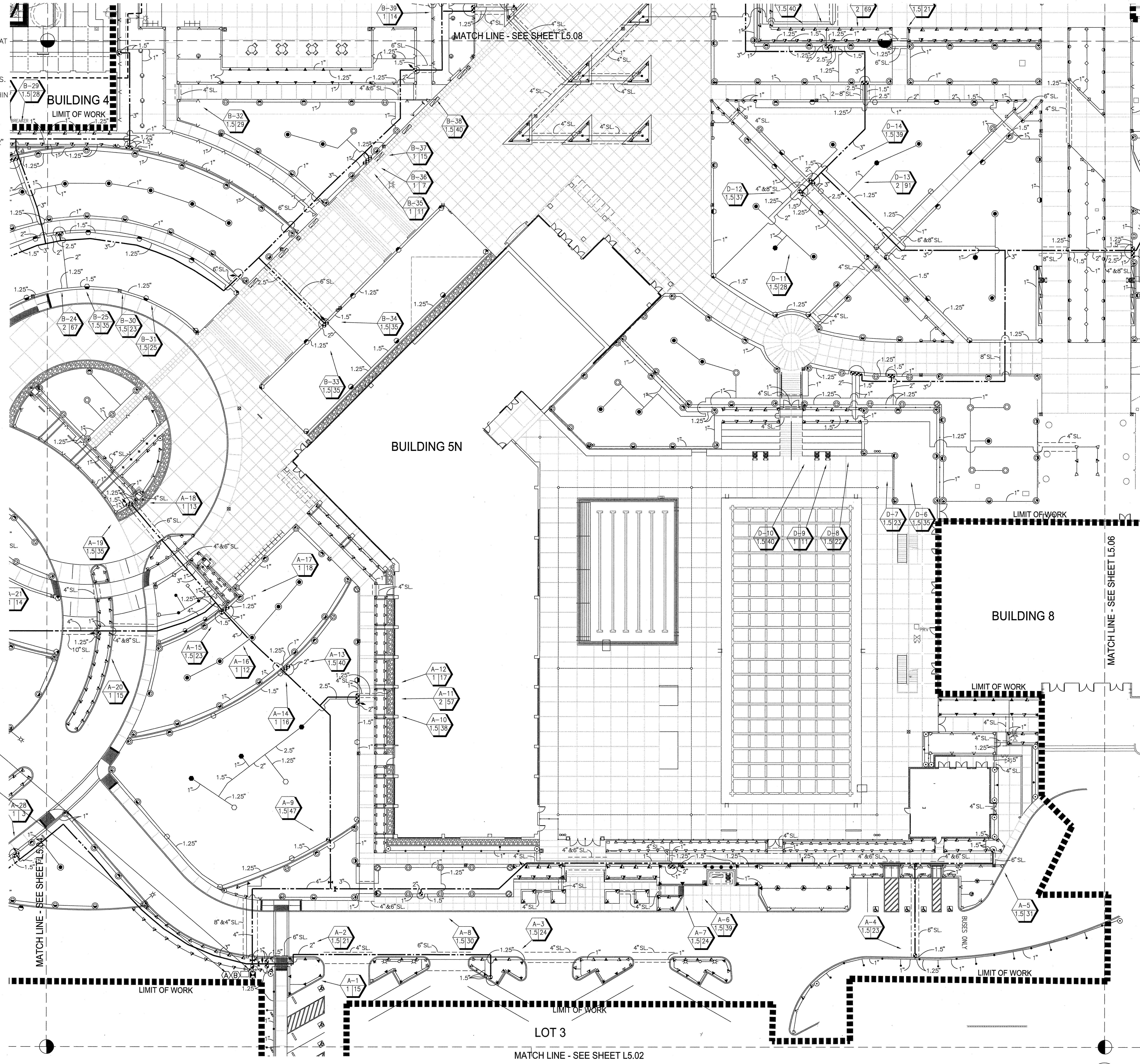

Preparation Consultant:
Russell D. Mitchell Associates, Inc.
 2780 Camino Diablo
 Walnut Creek, CA 94597
 Phone: (925) 933-3985
 Fax: (925) 932-9671
 WWW.RDMAIRRIGATION.COM

McCarthy Building Companies, Inc.
 343 Sansome Street, 14th Floor
 San Francisco, California 94104
 P 415 364-1339
 F 415 397-5999

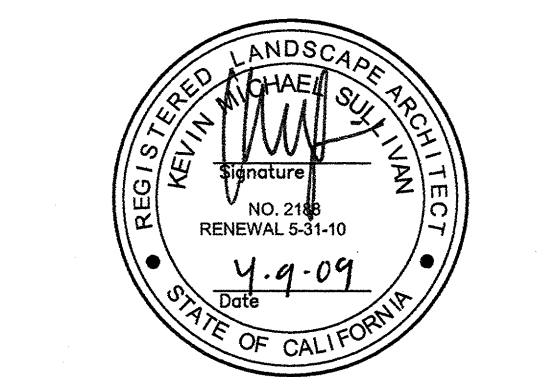
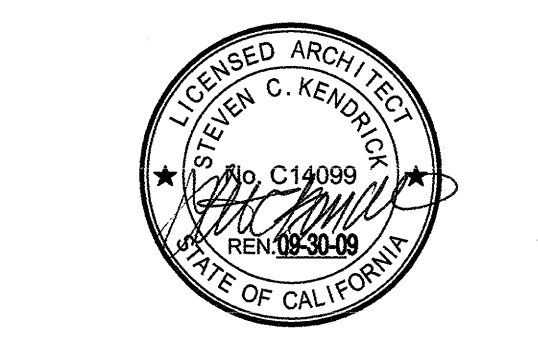

IDENTIFICATION STAMP
 DIV. OF THE STATE ARCHITECT
 OFFICE OF REGULATION SERVICE

APPL # 01-110097
 AC: [] FIS: [] SS: []
 DATE: APR 09 2009
 FILE NUMBER:

This and all other project documents and all ideas, methods and designs incorporated therein are instruments of service. All project documents are the exclusive property of LPA, KH, or McCarthy Building Companies, Inc. No part of any project document may be reproduced, stored in a retrieval system, or transmitted in any form or by any means, electronic, mechanical, photocopying, recording, or by any information storage and retrieval system, without the prior written consent of LPA, KH, or McCarthy Building Companies, Inc. The user of any project document shall be deemed to have accepted the terms and conditions of the instrument of service. LPA, KH, or McCarthy Building Companies, Inc. shall not be responsible for any damages or losses resulting from the use of any project document.

© Copyright 2009

College of San Mateo
Site Package
 San Mateo, CA

Developed for
 San Mateo County Community College District

Revision	Description	Date
1	ISSUE FOR PERMIT	09 APRIL 2009
2	ISSUE FOR CONSTRUCTION	19 SEPT 2009

Revision	Description	Date
1	ISSUE FOR PERMIT	09 APRIL 2009
2	ISSUE FOR CONSTRUCTION	19 SEPT 2009

Job No.	27082.30
Date	09 APRIL 2009
Drawn by	AG, RF
Checked by	SM
Scale	1" = 20'-0"