

ALL IDEAS, DESIGNS, ARRANGEMENTS, AND PLANS INDICATED OR REPRESENTED BY THIS DRAWING ARE OWNED BY AND THE PROPERTY OF VERDE DESIGN, INC. AND WERE CREATED, EVOLVED, AND DEVELOPED FOR USE ON AND IN CONNECTION WITH THE SPECIFIED PROJECT. NONE OF SUCH IDEAS, DESIGNS, ARRANGEMENTS OR PLANS SHALL BE USED, REPRODUCED, OR PUBLISHED BY ANY METHOD, IN WHOLE OR IN PART, OR DISCLOSED TO ANY PERSON, FIRM, OR CORPORATION FOR ANY PURPOSE WHATSOEVER WITHOUT WRITTEN PERMISSION OF VERDE DESIGN, INC.

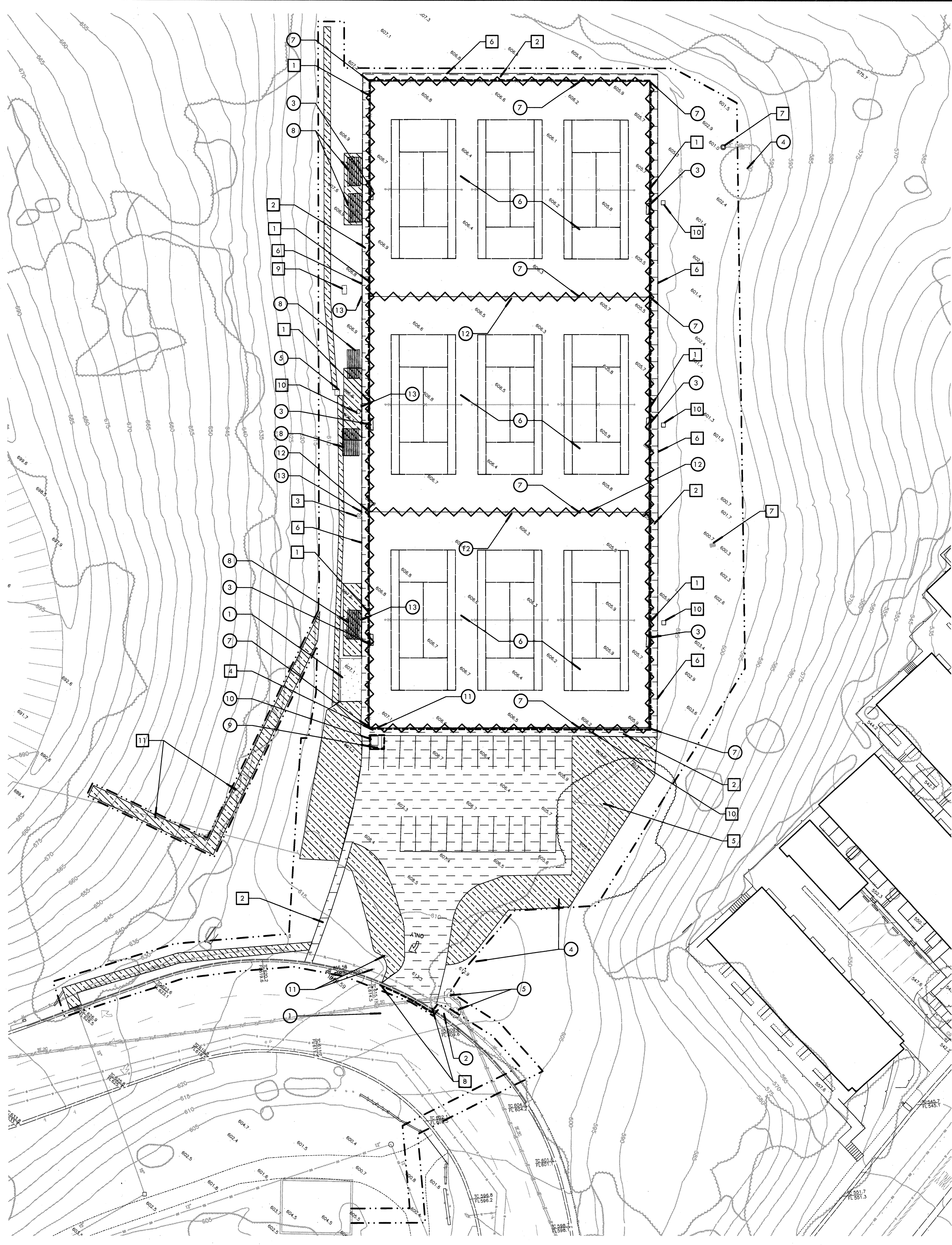

ITEMS TO BE DEMOLISHED AND REMOVED

- 1 GATES TO BE DEMOLISHED AND REMOVED.
- 2 EXISTING ASPHALT WALKWAY TO BE DEMOLISHED AND REMOVED.
- 3 DRINKING FOUNTAIN TO BE DEMOLISHED AND REMOVED. WATER LINE TO BE REUSED. REFER TO SHEET L3.0
- 4 ELECTRICAL PANEL LOCATED ON FENCE TO BE REMOVED AND RELOCATED TO NEW BUILDING. REFER TO ELECTRICAL DRAWINGS.
- 5 EUCALYPTUS TREE TO BE DEMOLISHED AND REMOVED INCLUDING STUMP. REFER TO SPECIFICATIONS.
- 6 REDWOOD HEADER BOARD TO BE DEMOLISHED AND REMOVED.
- 7 CATCH BASIN LID AND BOX TO BE DEMOLISHED AND REMOVED. STORM DRAIN LINE IS TO REMAIN ACTIVE. NEW 36" CATCH BASIN LIDS AND CONCRETE COLLARS TO BE PLACED. REFER TO SHEET L3.0.
- 8 CONTRACTOR TO SAWCUT AND REMOVE EXISTING SIDEWALK AND CURB AND GUTTER.
- 9 CONCRETE TABLE AND BASE TO BE DEMOLISHED AND REMOVED.
- 10 TRASH RECEPTACLES TO BE DEMOLISHED AND REMOVED.
- 11 CONTRACTOR TO CLEAR POISON OAK FOR TRENCHING OF ELECTRICAL ITEMS.

DEMOLITION NOTES

1. THE CONTRACTOR SHALL PERFORM ALL CLEARING, DEMOLITION, REMOVAL OF OBSTRUCTIONS AND SITE PREPARATIONS NECESSARY FOR THE PROPER EXECUTION OF ALL WORK CONTAINED IN THE CONTRACT DOCUMENTS.
2. CONTRACTOR SHALL VERIFY LOCATION OF ALL EXISTING UTILITIES AND PROVIDE THE REQUIRED COORDINATION FOR THEIR TEMPORARY DISCONNECTION, PROTECTION, REMOVAL AND/OR STORAGE AS MAY BE REQUIRED DURING CONSTRUCTION. CONTRACTOR SHALL COORDINATE WITH THE DISTRICT TO DETERMINE WHETHER TEMPORARY SERVICES ARE NECESSARY.
3. THE CONTRACTOR SHALL VISIT THE SITE PRIOR TO BID SUBMITTAL TO DETERMINE THE EXACT EXTENT AND DEPTH OF SITE DEMOLITION REQUIRED AND VERIFY COMPLIANCE WITH DRAWINGS. THE DISTRICT SHALL BE NOTIFIED IMMEDIATELY OF ANY DISCREPANCIES.
4. THE CONTRACTOR SHALL VERIFY THE LOCATIONS OF ALL EXISTING UTILITIES, STRUCTURES AND SERVICES BEFORE COMMENCING WORK. THE LOCATIONS OF UTILITIES, STRUCTURES AND SERVICES SHOWN IN THE CONTRACT DOCUMENTS SHALL BE DEEMED TO BE APPROXIMATIONS ONLY. ALL DISCREPANCIES BETWEEN WHAT IS SHOWN AND THE ACTUAL FIELD CONDITIONS SHALL BE REPORTED TO THE DISTRICT'S REPRESENTATIVE. THE CONTRACTOR SHALL CONTACT UNDERGROUND SERVICE ALERT (USA) AT (800) 227-2600 PRIOR TO ANY DEMOLITION OR EXCAVATION. UPON COMPLETION OF USA MARKING OPERATIONS, CONTRACTOR SHALL RECORD ALL UTILITY MARKINGS ON A SEPARATE SET OF DRAWINGS. THIS SET SHALL BE KEPT ON-SITE FOR REFERENCE FOR DURATION OF CONTRACT. NOTIFY THE DISTRICT'S REPRESENTATIVE IMMEDIATELY SHOULD CONFLICTS ARISE AND REDIRECT WORK TO AVOID DELAY.
5. ALL EXISTING ITEMS ARE TO REMAIN UNLESS OTHERWISE NOTED. THE CONTRACTOR SHALL BE RESPONSIBLE FOR REPAIRING OR REPLACING, AT CONTRACTOR'S EXPENSE, ANY EXISTING ITEM DAMAGED OR DESTROYED BY CONSTRUCTION OPERATIONS. CONTRACTOR SHALL ALSO BE RESPONSIBLE FOR REPAIRING OR REPLACING ANY AND ALL DAMAGES TO ADJACENT PROPERTIES. THE DAMAGED ITEMS SHALL BE RESTORED TO AN "AS-WAS" OR BETTER CONDITION OR REPLACED PER THE DISCRETION OF THE DISTRICT'S REPRESENTATIVE.
6. PRIOR TO ANY DEMOLITION WORK, CONTRACTOR SHALL INSTALL SELF-SUPPORTING INTERLOCKING CHAIN-LINK TEMPORARY CONSTRUCTION FENCING TO ENCLOSE AND SECURE THE PROJECT AREA LIMIT OF WORK. THE FENCING SHALL CONTAIN PEDESTRIAN AND/OR VEHICULAR ACCESS GATES AS NECESSARY AND SHALL BE MINIMUM 6 FEET HIGH WITH A TOP AND BOTTOM RAIL WITH KNUCKLED TOP AND BOTTOM SELVAGE (NO BARBED WIRE PERMITTED). FENCE SHALL INCLUDE FULL HEIGHT GREEN SHADE CLOTH COVERING. THE CONSTRUCTION FENCING WORK SHALL BE SUBJECT TO THE DISCRETION OF THE DISTRICT'S REPRESENTATIVE.
7. PRIOR TO ANY DEMOLITION WORK, CONTRACTOR SHALL PROTECT ALL EXISTING PLANT MATERIAL NOT SCHEDULED FOR REMOVAL BY INSTALLING TEMPORARY 4 FOOT HIGH "BLAZE ORANGE" CONSTRUCTION SAFETY FENCING AT THE DRIP LINE OR PERIMETER. THE FENCING SHALL BE SECURED WITH DRIVEN METAL STAKES. ALL TREE PROTECTION WORK SHALL BE SUBJECT TO THE DISCRETION OF THE DISTRICT'S REPRESENTATIVE.
8. DEMOLITION SHALL INCLUDE THE REMOVAL OF ITEM AND ANY FOUNDATION OR STRUCTURAL SUPPORT RELATED TO ITEM FOR PLANT MATERIAL THIS SHALL INCLUDE STUMPS AND ROOTS OVER 2 INCHES IN DIAMETER. DISPOSAL SHALL BE OFF-SITE IN A LEGAL MANNER ACCEPTABLE TO THE DISTRICT'S REPRESENTATIVE AND IN COMPLIANCE WITH ALL FEDERAL, STATE AND LOCAL CODES AND ORDINANCES.
9. REFER TO SPECIFICATIONS FOR ADDITIONAL CLEARING, GRUBBING, TOPSOIL STOCKPILING AND OTHER PERTINENT INFORMATION.

DEMOLITION LEGEND

SYM	DESCRIPTION
- - - - -	PROJECT LIMIT OF WORK
Ⓝ	KEY CALLOUT - ITEMS TO REMAIN AND BE PROTECTED
Ⓧ	KEY CALLOUT - ITEMS TO BE DEMOLISHED AND REMOVED
▨	HARDSCAPE TO REMAIN AND BE PROTECTED
▨	DEMOLISH AND REMOVE EXISTING HARDSCAPE PAVING, INCLUDING BASE MATERIAL
▨	SAWCUT EXISTING ASPHALT PAVING
▨	REMOVE EXISTING FENCE FABRIC AND TIE DOWNS. FENCE FRAME (I.E. RAILS, POSTS AND FOOTINGS) TO REMAIN AND BE PROTECTED.
▨	CLEAR AND GRUB

DEMOLITION KEY

ITEMS TO BE PROTECTED

- 1 HARDSCAPE TO REMAIN AND BE PROTECTED.
- 2 CONCRETE WALK TO REMAIN AND BE PROTECTED.
- 3 BENCHES TO REMAIN AND BE PROTECTED.
- 4 TREES TO REMAIN AND BE PROTECTED.
- 5 STORM DRAIN STRUCTURES AND UTILITIES SHALL REMAIN AND BE PROTECTED. REFER TO GRADING, DRAINAGE, AND UTILITY PLAN.
- 6 TENNIS COURT SURFACING IS TO REMAIN AND BE PROTECTED.
- 7 ALL TENNIS COURT FENCE POSTS AND RAILS TO REMAIN AND BE PROTECTED. POSTS, RAILS AND ALL HARDWARE TO BE CLEANED, PRIMED AND PAINTED BLACK. WINDSCREEN IS TO BE SALVAGED AND INSTALLED.
- 8 PORTABLE BLEACHERS ARE TO BE RELOCATED TO THE SOCCER PITCH ON CAMPUS.
- 9 BOLLARDS TO REMAIN AND BE PROTECTED.
- 10 PAY BOX TO REMAIN AND BE PROTECTED.
- 11 SIGNS TO REMAIN AND BE PROTECTED.
- 12 ELECTRICAL OUTLET BOX TO REMAIN AND BE PROTECTED.
- 13 QUICK COUPLER TO BE PROTECTED AND ADJUSTED TO GRADE. QUICK COUPLER TO BE PLACED IN NEW VALVE BOX. REFER TO DETAIL P, SHEET D1.0.

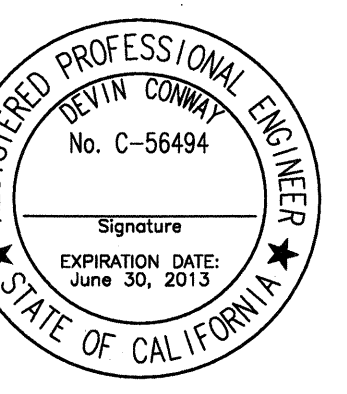
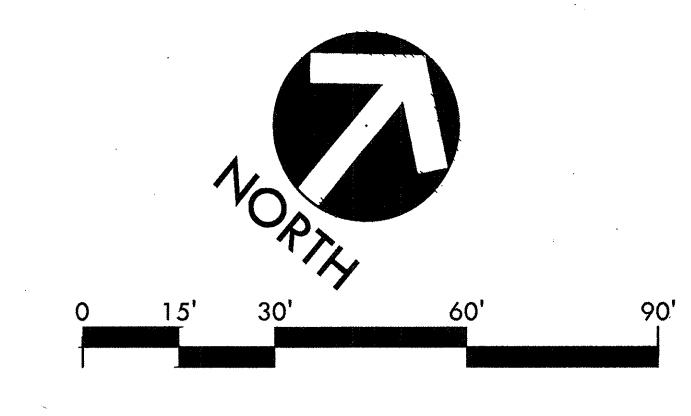

STAMP
CONSULTANT

SHEET TITLE

DEMOLITION PLAN

PROJECT NAME

**CANADA COLLEGE
TENNIS FACILITY
IMPROVEMENTS**

PROJECT ADDRESS

**4200 FARM HILL BLVD
REDWOOD CITY, CA 94061**

SUBMITTAL	DATE
90% SUBMITTAL	07/30/12
BID SUBMITTAL	08/21/12
CONFORM SET	09/24/12

NO.	REVISIONS	DATE

DRAWN BY CS	CHECKED BY DC
DATE ISSUED 08/21/12	SCALE 1"=30'-0"

PROJ. NO. **1207300-1281**

SHEET NO. **L-2.0** OF 39 SHEETS

DEMOLITION PLAN