

REVISION	DATE
ADDENDUM NO. 1	08/18/09
ADDENDUM NO. 2	11/08/09

DATE	STATUS
08/28/08	● DSA PLAN CHECK
01/22/09	● DSA BACK CHECK
09/18/09	● BIDDING / BID #66693
	○ CONSTRUCTION

FILE NO. 41-C1

IDENTIFICATION STAMP  
DIV. OF THE STATE ARCHITECT

01-110074

AC: FLS: SS: DATE:

**BUILDINGS 5 & 6  
RENOVATIONS**

San Mateo County Community  
College District

**BID ADDENDA**

APPROVED  
DIV. OF THE STATE ARCHITECT  
AC: FLS: SS: DATE: 8/22/08  
APPL. NO. 110074 DATE: 8/22/08

**CAÑADA COLLEGE**  
4200 Farm Hill Boulevard  
Redwood City, CA 94061

THIRD FLOOR  
DEMOLITION PLAN  
- ELECTRICAL

Date 08/29/08  
Drawing Number  
Scale AS NOTED  
Project Number 07013

**ED1.3**

**GENERAL SHEET NOTES**

- COORDINATE DEMOLITION WORK WITH ARCHITECT AND BUILDING OWNER PRIOR TO COMMENCEMENT OF WORK.
- DEMOLISH EXISTING LUMINAIRES, RECEPTACLES, VOICE/DATA OUTLETS, SWITCHES, OCCUPANCY SENSORS, FEEDERS, ETC., AS REQUIRED TO ACCOMMODATE NEW CONSTRUCTION. REUSE SPARE CIRCUITS AS MUCH AS POSSIBLE FOR NEW WORK. COORDINATE AND SEQUENCE DEMOLITION WORK WITH PROVISIONS OF CONSTRUCTION DOCUMENT DIVISIONS.
- REMOVE EXISTING MATERIALS CONFLICTING WITH REMODEL WORK INDICATED IN CONSTRUCTION DOCUMENTS AND SUBJECT TO CONDITIONS INDICATED IN SUCH.
- REMOVE ELECTRICAL MATERIALS MOUNTED IN OR ON WALLS AND CEILING TO BE REMOVED AS INDICATED IN ARCHITECTURAL CONSTRUCTION DOCUMENTS.
- MAINTAIN IN OPERATION EXISTING SYSTEMS NOT INDICATED FOR REMOVAL IN CONSTRUCTION DOCUMENTS.
- OBTAIN COPY OF EXISTING AS-BUILT DRAWINGS PRIOR TO BID.
- WHERE REMOVAL OF A LUMINAIRE, OUTLET, WALL OR PORTION OF THE CIRCUIT INTERRUPTS EXISTING CONDUIT AND/OR CIRCUIT AND RESULTS IN LOSS OF CIRCUIT CONTINUITY, REROUTE, EXTEND AND RECONNECT REMAINING CONDUIT AND/OR CIRCUIT AS REQUIRED TO PROVIDE CONTINUITY OF THE CIRCUIT THAT REMAINS IN SERVICE TO LUMINAIRES AND EQUIPMENT.
- PROVIDE UPDATED PANEL SCHEDULES THAT IDENTIFY EXISTING CIRCUITS AND NUMBER OF SPARE CIRCUITS AVAILABLE UPON COMPLETION OF DEMOLITION WORK.
- VERIFY EXISTING CONDITIONS PRIOR TO PROCEEDING WITH DEMOLITION WORK. PROVIDE ADDITIONAL SPLICE BOXES, ETC., AS REQUIRED FOR COMPLETE AND PROPERLY OPERATING SYSTEM. REUSE IN PLACE EXISTING CONDUIT NOT REMOVED DURING DEMOLITION IF SIZED IN ACCORDANCE WITH LATEST EDITION OF THE C.E.C. (CALIFORNIA ELECTRICAL CODE) AND THOROUGHLY CLEANED AND SWABBED PRIOR TO PULLING NEW WIRES.
- WHERE DRAWINGS INDICATE EXISTING ELECTRICAL EQUIPMENT OR DEVICES TO BE RELOCATED AND/OR REUSED, REFURBISH THEM. THOROUGHLY CLEAN SUCH ITEMS. NOTIFY ARCHITECT OF ANY DEFECTS IN SUCH INSTALLATIONS. REPAIR ANY DAMAGE CAUSED BY DEMOLITION OR CONSTRUCTION PERFORMED UNDER THIS CONTRACT.
- EXISTING IN SLAB CONDUIT FEEDING DEMOLISHED DEVICES TO BE ABANDONED. REMOVE WIRING BACK TO SOURCE. CUT AND CAP CONDUIT FLUSH WITH FLOOR AND PATCH SURFACE. DO NOT EXTEND STUBS ABOVE FLOOR. FINISHED SURFACE TO BE FLUSH WITH SURROUNDING AREA.
- ENSURE CONTINUOUS POWER MPOE IN BUILDING 8 DURING CONSTRUCTION. PROVIDE TEMPORARY POWER IF REQUIRED TO MAINTAIN ALL EQUIPMENT IN OPERATION INCLUDING COOLING.

**SHEET KEYNOTES**

- REMOVE ALL EXISTING LUMINAIRES, SWITCHES, WIRING, ETC., WITHIN THIS AREA.
- ALL EXISTING ELECTRICAL EQUIPMENT AND DEVICES TO REMAIN, UNLESS OTHERWISE NOTED.
- REMOVE EXISTING PENDANT LUMINAIRE.
- ALL EXISTING ELECTRICAL EQUIPMENT AND DEVICES TO REMAIN, UNLESS OTHERWISE NOTED.

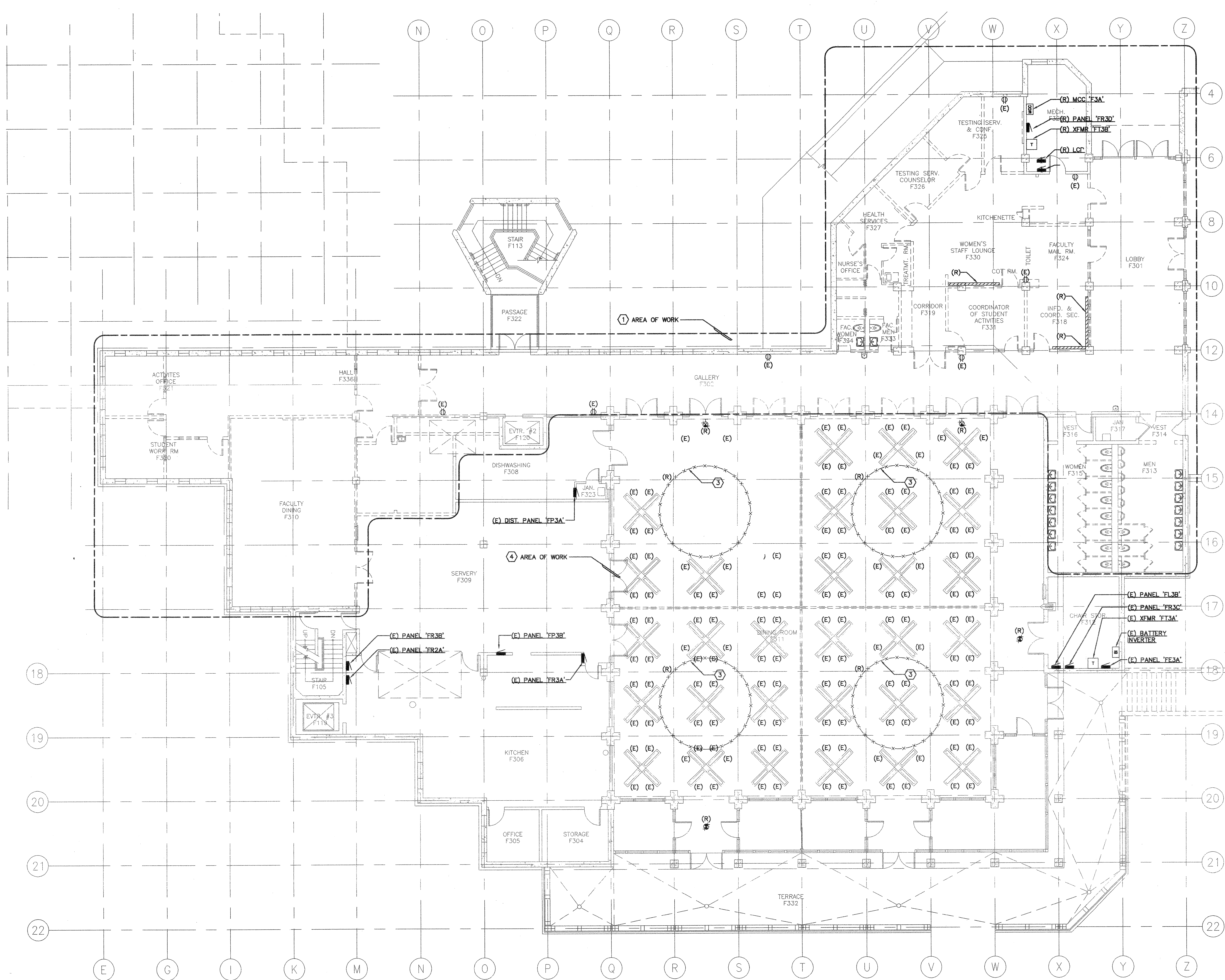

**1 THIRD FLOOR DEMOLITION PLAN - ELECTRICAL**

