



IDENTIFICATION STAMP
 DIV. OF THE STATE ARCHITECT
 OFFICE OF REGULATION SERVICE
 APPL. # 01-110097
 AC. FLS. SS. D.V.
 DATE APR 09 2009
 FILE NUMBER:

The use of other project documents and all items, including but not limited to, drawings, specifications, and other project documents are the property of LPA, KH, or McCarthy Building Companies, Inc. and shall remain the property of the respective owner. The user of these documents shall be held responsible for the accuracy of the information contained herein and shall not be held responsible for any errors or omissions. The user of these documents shall be held responsible for the accuracy of the information contained herein and shall not be held responsible for any errors or omissions. The user of these documents shall be held responsible for the accuracy of the information contained herein and shall not be held responsible for any errors or omissions.

© Copyright 2008

College of San Mateo
 Site Package
 San Mateo, CA
 Developed for
 San Mateo County Community College District

Date	Description

Date	Description
19 SEPT 2008	DSA SUBMITTAL
09 APRIL 2009	DSA FINAL

Job No.	300085
Date	09 APRIL 2009
Drawn by	REI CAD TEAM
Checked by	THSFRW
Scale	AS SHOWN

Site Lighting Plan - Overall-Key Plan

E2.00

GENERAL NOTES
 A. SEE LANDSCAPE LAYOUT SHEETS FOR EXACT LOCATION AND DIMENSIONS FOR EACH LIGHT LOCATION WITHIN THE LIMIT OF WORK.

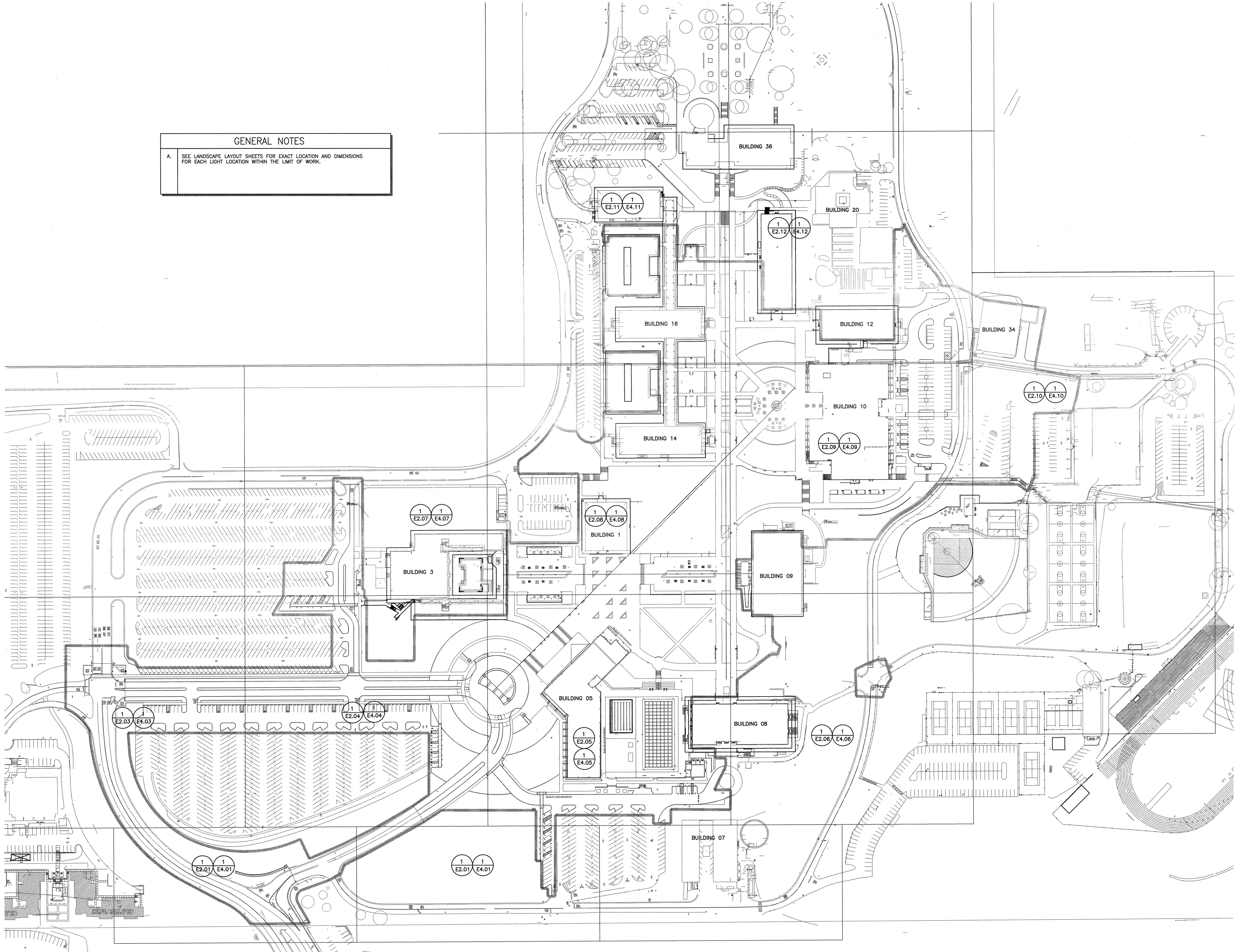

1 Electrical-Key Plan
 SCALE: 1"=60'-0"

120
 60
 30
 0