

NEW CONSTRUCTION FOR THE SAN MATEO COUNTY COMMUNITY COLLEGE DISTRICT ATHLETIC FIELDS PHASE 2 COLLEGE OF SAN MATEO SOFTBALL TEAM ROOM AND FOOTBALL HALL OF FAME BUILDINGS

1700 W. HILLSDALE BLVD.
SAN MATEO, CA 94402

DSA APPROVAL SET - APRIL, 2007
APPLICATION No. 01-108848 FILE No. 41-C1

AS-BUILTS

AS-BUILTS

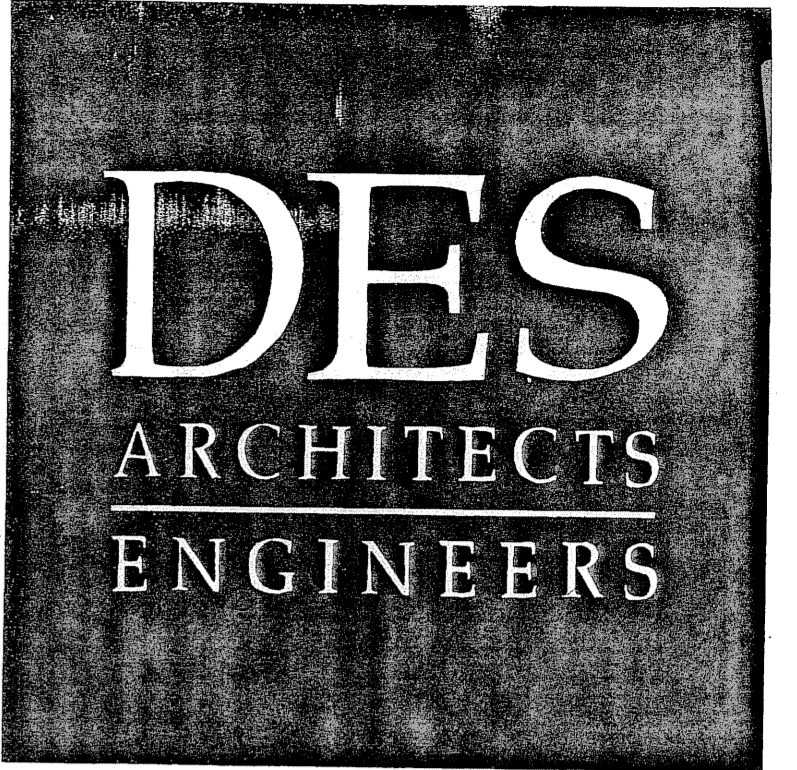

399 Bradford Street Redwood City, Ca. 94063
Tel: (650) 364-6453
Fax: (650) 364-2618
www.des-ae.com

**SARAMARK
INCORPORATED**
SAN JOSE, CALIFORNIA 95154
Ph: (408) 971-3881
Fax: (408) 971-3534

ROBERT A. BOTHMAN, INC.
General Engineering and Building Contractors
650 QUINN AVENUE
SAN JOSE, CA. 95112
Ph: (408) 279-2277
Fax: (408) 279-2281

**SAN MATEO COUNTY
COMMUNITY COLLEGE
DISTRICT
ATHLETIC FIELDS
PHASE 2
COLLEGE OF SAN MATEO
SOFTBALL FIELD TEAM ROOM
& FOOTBALL HALL OF FAME
San Mateo, Ca. 94402
1700 W. Hillside Blvd.**

TITLE SHEET

ISSUE:	DATE:	DESCRIPTION:
DSA	04/26/07	DSA SUBMISSION

DRAWN BY: A.BAKSH
REVIEWED BY: V. AMRHEIN
APPROVED BY: V. AMRHEIN

DES PROJECT NO.: 9126.12

IDENTIFICATION STAMP
DIVISION OF THE STATE ARCHITECT
APPL # 01-108848
FILE # 41-C1
DATE: OCT 1 0 2007



SHEET NO. **G0.01**

VICINITY MAP

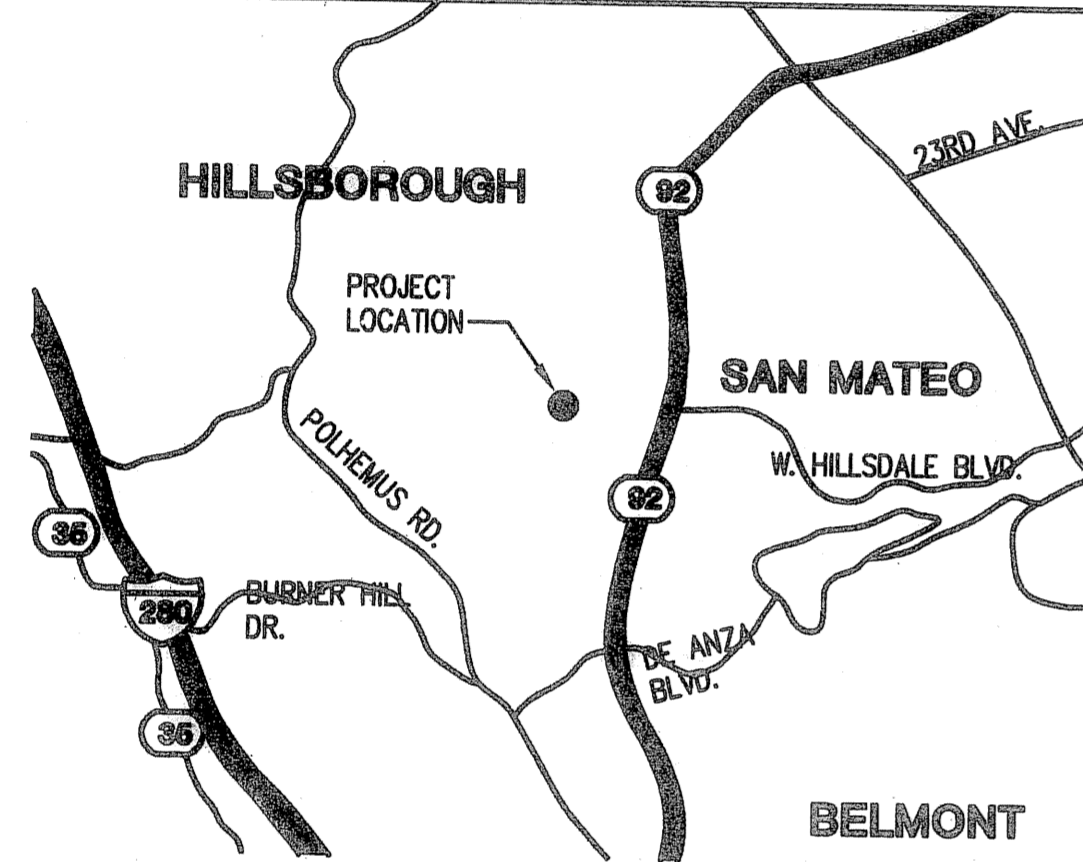

PROJECT TEAM

OWNER: SAN MATEO COUNTY COMMUNITY COLLEGE DISTRICT
3401 CSM DRIVE
SAN MATEO, CA. 94402

PROGRAM MANAGER: SWINERTON MANAGEMENT & CONSULTING, INC.
1700 W. HILLSDALE BLVD. BUILDING 6
SAN MATEO, CA 94402
(850) 378-7336
ROGER ANCHARTCHAHAR

DESIGN BUILDER: ROBERT A. BOTHMAN, INC.
650 QUINN AVE
SAN JOSE, CA 95112
408 279-2277 FAX: (408) 279-2288
JAMES MOORE

ARCHITECT: DES ARCHITECTS + ENGINEERS
399 BRADFORD STREET SUITE 300
REDWOOD CITY, CA. 94063
(650) 364-6453 FAX: (650) 364-2618
VINCENT AMRHEIN, AIA

DRAWING INDEX

- GENERAL**
- G0.01 TITLE SHEET
 - G0.02 ACCESSIBILITY STANDARDS
 - G0.03 CAMPUS WIDE SITE: ACCESSIBILITY
 - G1.01 ACCESSIBILITY AND SCOPE OF WORK
 - G1.02 ACCESSIBILITY AND SCOPE OF WORK
- ARCHITECTURAL**
- A-0 COVER SHEET
 - A-00 SPECIFICATIONS
 - C-1.1 SIGNAGE PLAN
- BUILDING A - TEAM ROOM - 4024 AX PC 01-105108**
- A-A-1 FLOORPLAN & DEPRESSED SLAB PLAN
 - A-A-1a EXTERIOR ELEVATIONS
 - A-A-7 REFLECTED CEILING PLAN
 - A-S-1 X-BRACING & FOUNDATION PLAN
 - A-S-1.1 WALL FRAMING
 - A-S-1.2 ROOF FRAMING
 - A-M-1 MECHANICAL PLAN
 - A-P-1 PLUMBING PLAN
 - A-E-1 POWER AND LIGHTING PLAN
- BUILDING B - HALL OF FAME**
- B-A-1 FLOORPLAN & EXTERIOR ELEVATIONS
 - B-A-2 REFLECTED CEILING PLAN AND INT. ELEV.
 - B-S-1 X-BRACING & FOUNDATION PLAN
 - B-S-2 WALL FRAMING
 - B-S-3 ROOF FRAMING
 - B-S-3a ROOFING PLAN
 - B-M-1 MECHANICAL PLAN
 - B-P-1 PLUMBING PLAN
 - B-E-1 POWER AND LIGHTING PLAN
- ARCHITECTURAL DETAILS - 4000AX PC10-105108**
- A-8 TYPICAL EXTERIOR AND INTERIOR DETAILS
 - A-9 TYPICAL EXTERIOR INTERIOR DETAILS
- ARCHITECTURAL DETAILS - 4000AX PC10-105108**
- S-7 TYPICAL STRUCTURAL DETAILS
 - S-8 TYPICAL STRUCTURAL DETAILS
 - S-9 TYPICAL STRUCTURAL DETAILS
 - S-10 TYPICAL STRUCTURAL DETAILS
 - S-11 TYPICAL STRUCTURAL DETAILS
 - S-12 TYPICAL STRUCTURAL DETAILS
- SITE SPECIFIC DETAILS**
- SS-1 SITE SPECIFIC DETAILS - LATH ALTERNATIVE
- FIRE ALARM**
- FA0.00 COVER SHEET / DRAWING INDEX / EQUIPMENT LIST
 - FA0.01 MISCELLANEOUS FIRE ALARM DETAILS
 - FA0.02 (E) MXL CONTROL PANEL
 - FA0.03 FIRE ALARM SITE PLAN
 - FA0.04 FIRE ALARM POWER SUPPLY DETAILS / RISER DIAGRAM
 - FA0.05 WIRING DETAIL OF FIELD DEVICES
 - FA0.06 FIRE ALARM PLAN - SOFTBALL TEAM ROOM AND FIRE ALARM PLAN - FOOTBALL HALL OF FAME
- AS-BUILTS**
- Ro.#1-1a P.O.C. BLDG. A PLUMB.
 - Ro.#1-1b P.O.C. PULL PLAN W/ALLS BLDG. A
 - Ro.#1-1c UNDERSLAB ELEC. BLDG. A
 - Ro.#1-2 BLDG. B P.O.C. PLUMB.
 - Ro.#1-2a BLDG. B P.O.C. PLUMB.
 - Ro.#1-2b BLDG. B P.O.C. UNDERSLAB ELEC.
 - Ro.#1-3 DETAIL SHEETS
 - Ro.#2-7 DETAIL SHEETS
- ALL OF THESE SHEETS ARE @ END OF THIS SET

CAMPUS KEY PLAN

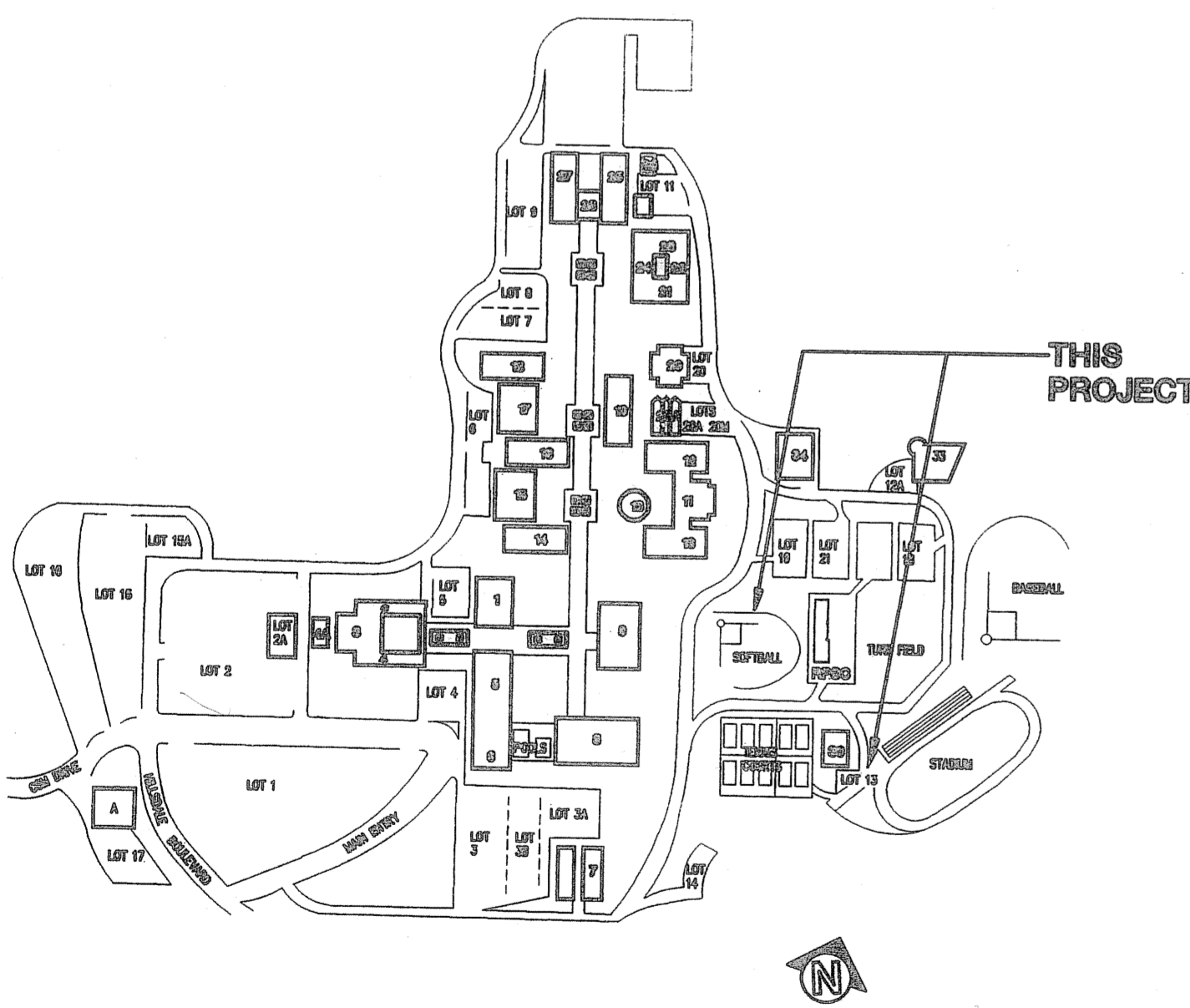

APPLICABLE CODES

**LIST OF 2001 CALIFORNIA CODE OF REGULATIONS
APPLICABLE CODES AS OF NOVEMBER 1, 2002:**

2001 California Codes - TITLE 24
State of California Title (2001 Edition) - Part 1 Building Standards Administrative Code
State of California Title 24 (2001 Edition) - Part 2/Volume 1 California Building Code / 2001 Amendment with 1997 UBC, Volume 1
State of California Title 24 (2001 Edition) - Part 2/Volume 2 California Building Code / 2001 Amendment with 1997 UBC, Volume 2
1997 Uniform Building Code, Volume 3
State of California Title 24 (2004 Edition) - Part 3 California Electrical Code / 2004 Amendment with 2002 NEC
State of California Title 24 (2001 Edition) - Part 4 California Mechanical Code / 2001 Amendment with 2000 UMC
State of California Title 24 (2001 Edition) - Part 5 California Plumbing Code / 2001 Amendment with 2000 UPC
State of California Title 24 (2005 Edition) - Part 6 California Energy Code
2001 California Elevator Safety Construction Code (CESCC), Title 24, Part 7, C.C.R.
State of California Title 24 (2001 Edition) - Part 9 C.C.R.
2001 California Code for Building Conservation, Title 24, Part 10, C.C.R.
State of California Title 24 (2001 Edition) - Part 12 California Referenced Standards Code Title 19, C.C.R., Public Safety, State Fire Marshall Regulations
Americans with disabilities act, 1990

NATIONAL REFERENCE STANDARDS

ASD (AISC) Manual of Steel Construction 9th Edition
1991 Revised National Design Specification for Wood Construction
ACI-318-95 Code & Commentary
NFPA 13, Automatic Sprinkler System, 2002 Edition
NFPA 14, Installation of Standpipe and Hose Systems, 2003 Edition
NFPA 17-A, Wet Chemical Extinguishing Systems, 1994 Edition
NFPA 24, Installation of Private Fire Service Mains, 2002 Edition
NFPA 72, National Fire Alarm Code, 2002 Edition (as amended by SFM)
NFPA 253, Critical Radiant Flux of Floor Covering System, 2000 Edition
NFPA 2001, Clean Agent Fire Extinguishing Systems, 2000 Edition

DEFERRED APPROVAL

NONE

SUMMARY OF WORK

CONSTRUCTION OF TWO ONE STORY MODULAR LIGHT GAUGE STEEL FRAME BUILDINGS ON 4" THICK REINFORCED CONCRETE SLAB ON GRADE WITH PERIMETER FOOTING

DSA STATEMENT

These drawings and/or specifications and/or calculations for the items listed below have been prepared by other design professionals or consultants who are licensed and/or authorized to prepare such drawings in this state. These documents have been examined by me for design intent and appear to meet the appropriate requirements of Title 24, California Code of Regulations and the project specifications prepared by me.

The items listed below have been coordinated with my plans and specifications and are acceptable for incorporation into the construction of this project for which I am the individual designated to be in general responsible charge.

Vincent Amrhein
Signature of the Architect/Engineer
Name, Title Affiliation/Date

10/10/07
Date

C28933
License Number

12/31/07
Expiration Date

DRAWING:

- ARCHITECTURAL**
- A-0 COVER SHEET
 - A-00 SPECIFICATIONS
 - C-1.1 SIGNAGE PLAN
- BUILDING A - TEAM ROOM - 4024 AX PC 01-105108**
- A-A-1 FLOORPLAN & DEPRESSED SLAB PLAN
 - A-A-1a EXTERIOR ELEVATIONS
 - A-A-7 REFLECTED CEILING PLAN
 - A-S-1 X-BRACING & FOUNDATION PLAN
 - A-S-1.1 WALL FRAMING
 - A-S-1.2 ROOF FRAMING
 - A-M-1 MECHANICAL PLAN
 - A-P-1 PLUMBING PLAN
 - A-E-1 POWER AND LIGHTING PLAN
- BUILDING B - HALL OF FAME**
- B-A-1 FLOORPLAN & EXTERIOR ELEVATIONS
 - B-A-2 REFLECTED CEILING PLAN AND INT. ELEV.
 - B-S-1 X-BRACING & FOUNDATION PLAN
 - B-S-2 WALL FRAMING
 - B-S-3 ROOF FRAMING
 - B-S-3a ROOFING PLAN
 - B-M-1 MECHANICAL PLAN
 - B-P-1 PLUMBING PLAN
 - B-E-1 POWER AND LIGHTING PLAN
- ARCHITECTURAL DETAILS - 4000AX PC10-105108**
- A-8 TYPICAL EXTERIOR AND INTERIOR DETAILS
 - A-9 TYPICAL EXTERIOR INTERIOR DETAILS
- ARCHITECTURAL DETAILS - 4000AX PC10-105108**
- S-7 TYPICAL STRUCTURAL DETAILS
 - S-8 TYPICAL STRUCTURAL DETAILS
 - S-9 TYPICAL STRUCTURAL DETAILS
 - S-10 TYPICAL STRUCTURAL DETAILS
 - S-11 TYPICAL STRUCTURAL DETAILS
 - S-12 TYPICAL STRUCTURAL DETAILS
- SITE SPECIFIC DETAILS**
- SS-1 SITE SPECIFIC DETAILS - LATH ALTERNATIVE
- FIRE ALARM**
- FA0.00 COVER SHEET / DRAWING INDEX / EQUIPMENT LIST
 - FA0.01 MISCELLANEOUS FIRE ALARM DETAILS
 - FA0.02 (E) MXL CONTROL PANEL
 - FA0.03 FIRE ALARM SITE PLAN
 - FA0.04 FIRE ALARM POWER SUPPLY DETAILS / RISER DIAGRAM
 - FA0.05 WIRING DETAIL OF FIELD DEVICES
 - FA0.06 FIRE ALARM PLAN - SOFTBALL TEAM ROOM AND FIRE ALARM PLAN - FOOTBALL HALL OF FAME