

**BUILDING 17 MECHANICAL FIRST FLOOR PLAN**  
SCALE: 1/8" = 1'-0"

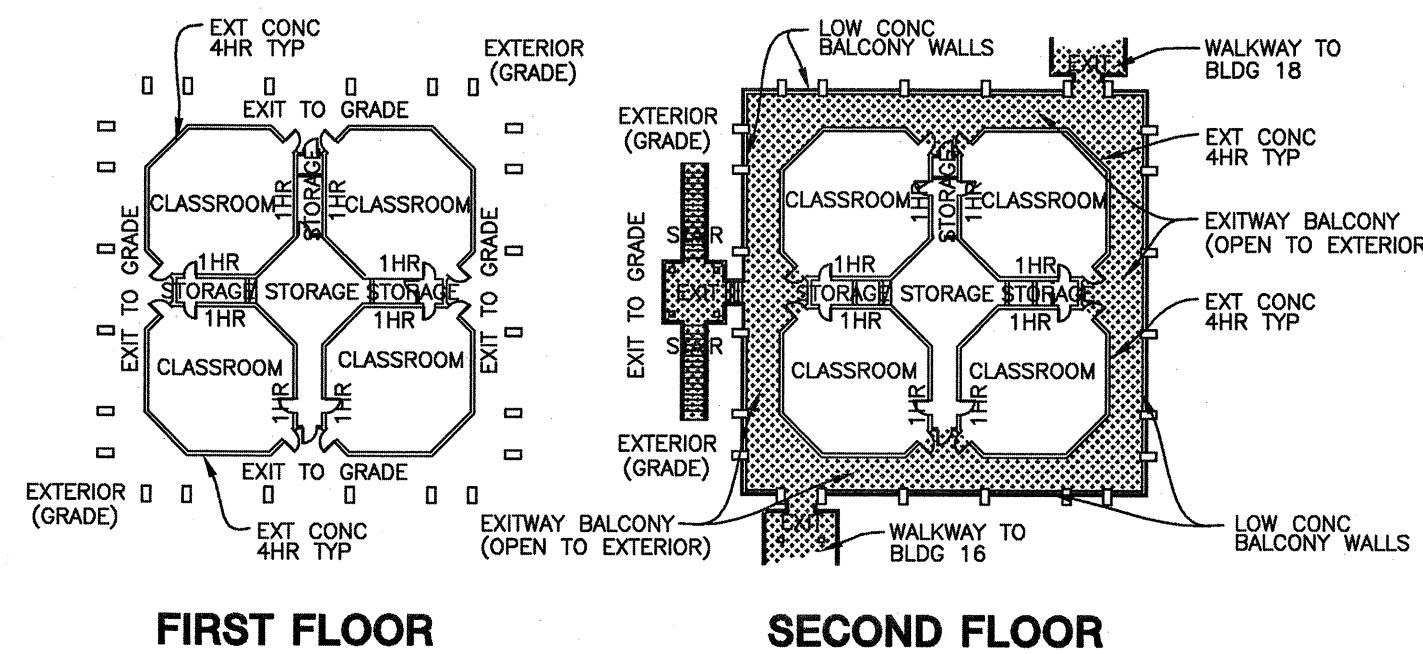

**BUILDING 17 OVERALL FLOOR PLANS**  
SCALE: 1" = 40'-0"

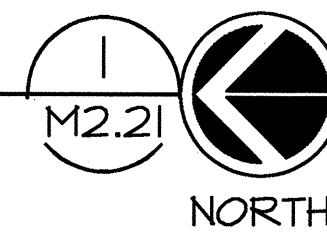
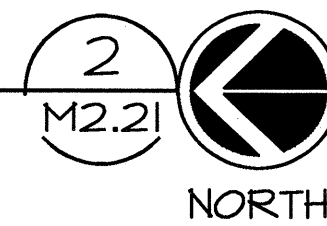

**SHEET NOTES**

1. VERTICAL FAN COIL UNIT ON FLOOR MOUNTED SPRING ISOLATORS. SEE SECTION 1/M3.21 FOR DUCT DETAILS, SEE 5/M5.04 FOR MOUNTING, SEE 1/M6.03 FOR CONTROL, SEE 1/M4.21 FOR PIPING.
2. 18" EXHAUST DUCT UP TO SECOND FLOOR LEVEL ABOVE. SEE 1/M2.22 FOR CONTINUATION. EXTEND DUCT THROUGH EXISTING 63"x63" (APPROX.) OPENING IN SECOND FLOOR DECK.
3. ALL DUCTWORK IS TO BE HELD TIGHT TO STRUCTURE ABOVE.
4. 18"x18" (MIN) WALL LOUVER, SEE ARCHITECTURAL DRAWINGS.
5. 36"x18" (MIN) WALL LOUVER, SEE ARCHITECTURAL DRAWINGS.
6. LOUVER TO BE LOCATED AS HIGH AS POSSIBLE. INSTALL 8" DEEP FLENUM ONTO BACK OF LOUVER AND CONNECT 14" DUCT AS SHOWN. DUCTWORK RUNS TIGHT TO UNDERSIDE OF SECOND FLOOR DECK AND MUST OFFSET DOWN TO MEET LOUVER.
7. REFRIGERANT PIPING UP THROUGH (E) OPENING IN SECOND FLOOR DECK. SEE 1/M2.22 FOR CONTINUATION.
8. TWO 14" DUCT STACKED VERTICALLY, HOLD BOTH DUCTS AS HIGH AS POSSIBLE.
9. OFFSET DUCT UP TO UNDERSIDE OF STRUCTURE.
10. (E) WALL OPENING TO BE ENLARGED TO ACCOMMODATE NEW DUCTWORK. SEE STRUCTURAL DRAWINGS. COORDINATE OPENING SIZE REQUIREMENTS WITH GENERAL CONTRACTOR.
11. NEW DUCTWORK TO EXTEND THROUGH (E) WALL OPENING.
12. BUILDING ENERGY MONITORING SYSTEM CONTROL PANEL. SEE 2/M6.07 FOR DETAILS.
13. EXISTING EMS CONTROL PANEL. VERIFY EXACT LOCATION IN FIELD. SEE 1/M6.01 FOR DETAILS.

**noll tam**  
architects and planners

725 Heinz Avenue  
Berkeley, CA 94710  
510.848.8295  
fax 510.649.3008

**McCracken & Woodman, Inc.**  
355 Grand Ave.  
Oakland, CA 94610  
Tel: (510) 763-4891  
Fax: (510) 763-0619



**CAÑADA COLLEGE**  
BUILDING 16, 17, 18  
RENOVATION  
SMCCCD  
3401 CSM Drive  
San Mateo, CA 94402  
Cañada College  
4200 FarmHills Blvd.  
Redwood City, CA 94061

**MECHANICAL / STRUCTURAL  
COORDINATION NOTES**

1. MECHANICAL CONTRACTOR IS TO DETERMINE ALL ROOF AND WALL OPENING SIZES REQUIRED FOR THE MECHANICAL SYSTEMS. THIS INFORMATION IS TO BE COORDINATED WITH THE GENERAL CONTRACTOR TO ENSURE NO CONFLICTS OR MISSED OPENINGS OCCUR.
2. MECHANICAL CONTRACTOR IS TO DETERMINE ALL ROOF AND HOUSEKEEPING PAD DIMENSIONS BASED ON THE ACTUAL EQUIPMENT BEING INSTALLED, INCLUDING REQUIRED EDGE DISTANCE CLEARANCE FOR ANCHOR BOLTS.

**SHEET TITLE  
BUILDING 17  
MECHANICAL  
FIRST FLOOR  
PLAN**

REVISIONS		
NO.	DATE	DESCRIPTION
1	08/11/08	ADDENDUM NO. 1 BLDG 17 MODERNIZATION
2	02/01/07	RECORD SET

DATE	
DRAWN	JP
CHECKED	BC
SCALE	1/8" = 1'-0"
N&T JOB NO.:	
SHEET NUMBER	<b>17</b>

**M2.21**

**acco** engineered systems  
1133 ALADDIN AVE  
SAN LEANDRO, CALIFORNIA 94577  
(510) 348-4300

Job Number: 626405  
Filename: RC  
Drawn By: RJS  
Project Mgr: 88519  
District Contract #:   
Contractor's Signature:   
DATE: 02-01-07

**RECORD DRAWING**

