

**BUILDING 17 MECHANICAL
SECOND FLOOR SEQUENCING PLAN** 2 MO.04 NORTH

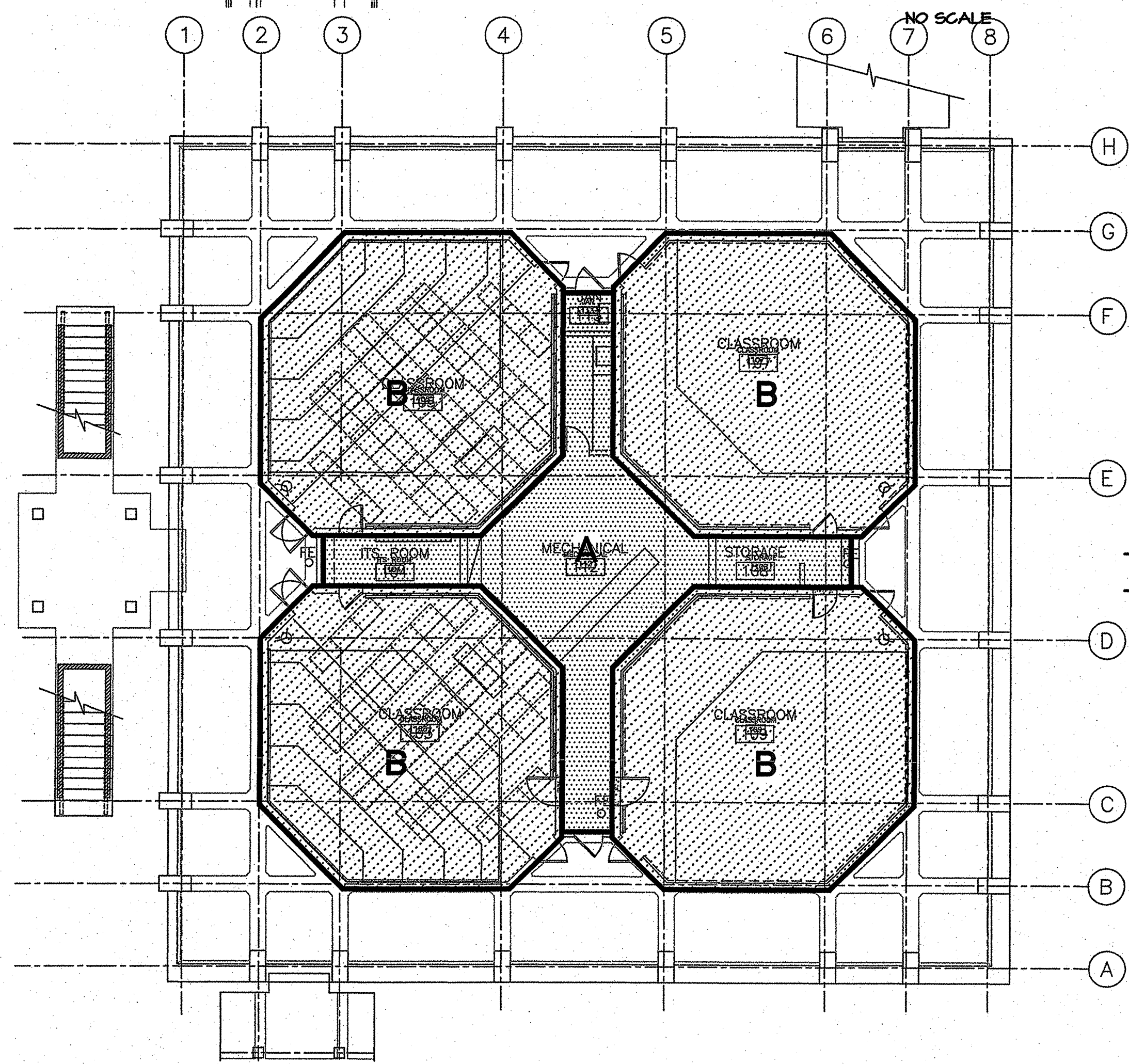

**BUILDING 17 MECHANICAL
FIRST FLOOR SEQUENCING PLAN** 1 MO.04 NORTH

BLDG. 17 SEQUENCING

GENERAL:

THE COLLEGE IS TO BE NOTIFIED A MINIMUM OF ONE (1) WEEK PRIOR TO ANY DOWNTIME OR CHANGE-OVER PERIOD OF THE MECHANICAL SYSTEMS. SYSTEM SHUTDOWN IS ONLY TO OCCUR AFTERHOURS OR ON WEEKENDS.

THE MECHANICAL WORK WILL TAKE PLACE IN ALL THREE BUILDINGS (16, 17, 18) SIMULTANEOUSLY. SEE THE BUILDING 16 PHASING PLAN, MO.03; AND THE BUILDING 18 PHASING PLAN, MO.05 FOR ADDITIONAL INFORMATION.

REFER TO THE GENERAL CONDITIONS AND CONSTRUCTION SCHEDULING DOCUMENTATION FOR ALL MILESTONE DATES AND TIMEFRAME REQUIREMENTS.

TEMPORARY VENTILATION AND HEATING FOR BUILDING 17 IS TO BE PROVIDED BY PORTABLE FANS AND HEATERS, SEE THE ARCHITECTURAL DRAWINGS AND GENERAL CONDITIONS SPECIFICATIONS.

ALSO REFER TO THE ARCHITECTURAL SEQUENCING DRAWINGS FOR ADDITIONAL INFORMATION.

SEQUENCE A:

1. COMPLETE DEMOLITION WORK IN THE FIRST AND SECOND FLOOR MECHANICAL CORE AREAS. DEMOLITION OF DUCTWORK TO STOP AT CLASSROOM WALLS.
2. NO WORK CAN BE PERFORMED INSIDE THE CLASSROOMS DURING THIS SEQUENCE A, THEREFORE THE EXISTING CLASSROOM DUCTWORK IS TO REMAIN TO THE PENETRATIONS OF THE CLASSROOM WALLS.
2. INSTALL A TEMPORARY ROOF MOUNTED EXHAUST FAN TO PROVIDE NEGATIVE PRESSURIZATION OF THE FIRST AND SECOND FLOOR MECHANICAL CORE AREAS WITH RESPECT TO THE CLASSROOMS. MAKE-UP AIR IS TO BE FROM THE EXISTING CLASSROOM DUCTWORK STUBBED THROUGH THE WALL INTO THE MECHANICAL ROOMS. APPROXIMATE CFM PER CLASSROOM = 820 CFM. TOTAL OF EIGHT (8) CLASSROOMS, TEMPORARY EXHAUST FAN = 6560 CFM.
3. PROVIDE TEMPORARY BLANK-OFF PANELS WHERE REQUIRED TO PROVIDE EQUAL MAKE-UP AIR CFM FROM EACH CLASSROOM.
4. THE INTENT OF THE TEMPORARY FAN IS TO CONTAIN THE CONSTRUCTION DUST IN THE MECHANICAL AREAS AND TO PROVIDE SOME VENTILATION (VIA TRANSFER OF MAKE-UP AIR) IN THE CLASSROOMS.
5. COMPLETE ALL NEW WORK IN THE MECHANICAL CORE AREAS.

SEQUENCE B:

1. REMOVAL OF TEMPORARY ROOF MOUNTED EXHAUST FAN.
2. ALL WORK IN CLASSROOMS TO BE COMPLETED.

ARCHITECT OF RECORD
noll & tam
architects and planners

729 Heinz Avenue
Berkeley, CA 94710
510.649.8295
fax 510.649.3006

CONSULTANTS
McCracken & Woodman
INCORPORATED
Consulting Mechanical Engineers
355 Grand Avenue, Oakland, California 94610
Telephone (510) 763-4891 Fax (510) 763-0619

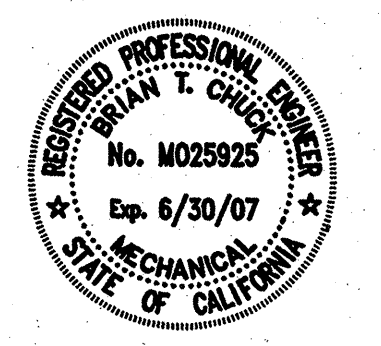

IDENTIFICATION STAMP
DIVISION OF THE STATE ARCHITECT
FILE NUMBER: 41-01
APPLICATION NUMBER: 01-00911
AC _____ FIS _____ SS _____
DATE _____

BID DOCUMENTS
CAÑADA COLLEGE
BUILDING 16, 17, 18
RENOVATION
SMCCCD
3401 CSM Drive
San Mateo, CA 94402
Cañada College
4200 Farm Hills Blvd.
Redwood City, CA 94061

SHEET TITLE
**BUILDING 17
MECHANICAL
SEQUENCING
PLAN**

NO.	DATE	DESCRIPTION
△	08/11/06	APPENDIX NO. 1 BLDG 17 MODERNIZATION
△	08/18/06	APPENDIX NO. 2 BLDG 16, 17, 18 MODERNIZATION
△	02/01/07	RECORD SET

DATE	MARCH 1, 2006
DRAWN	JP
CHECKED	BC
SCALE	1/8" = 1'-0"
N&T JOB NO.:	2220.07

SHEET NUMBER **17**
MO.04

acco engineered systems
1133 ALADDIN AVE
SAN LEANDRO, CALIFORNIA 94577
(510) 346-4300

628403 MO.01.DWG RC RISSE
Job Number Filename Drawn By Project Mgr
88519
RECORD DRAWING District Contract #
DATE: 02-01-07 Contractor's Signature

