

1 BUILDING 17 - SECOND FLOOR PLAN DEMOLITION
 E1.22 1/8"=1'-0" N

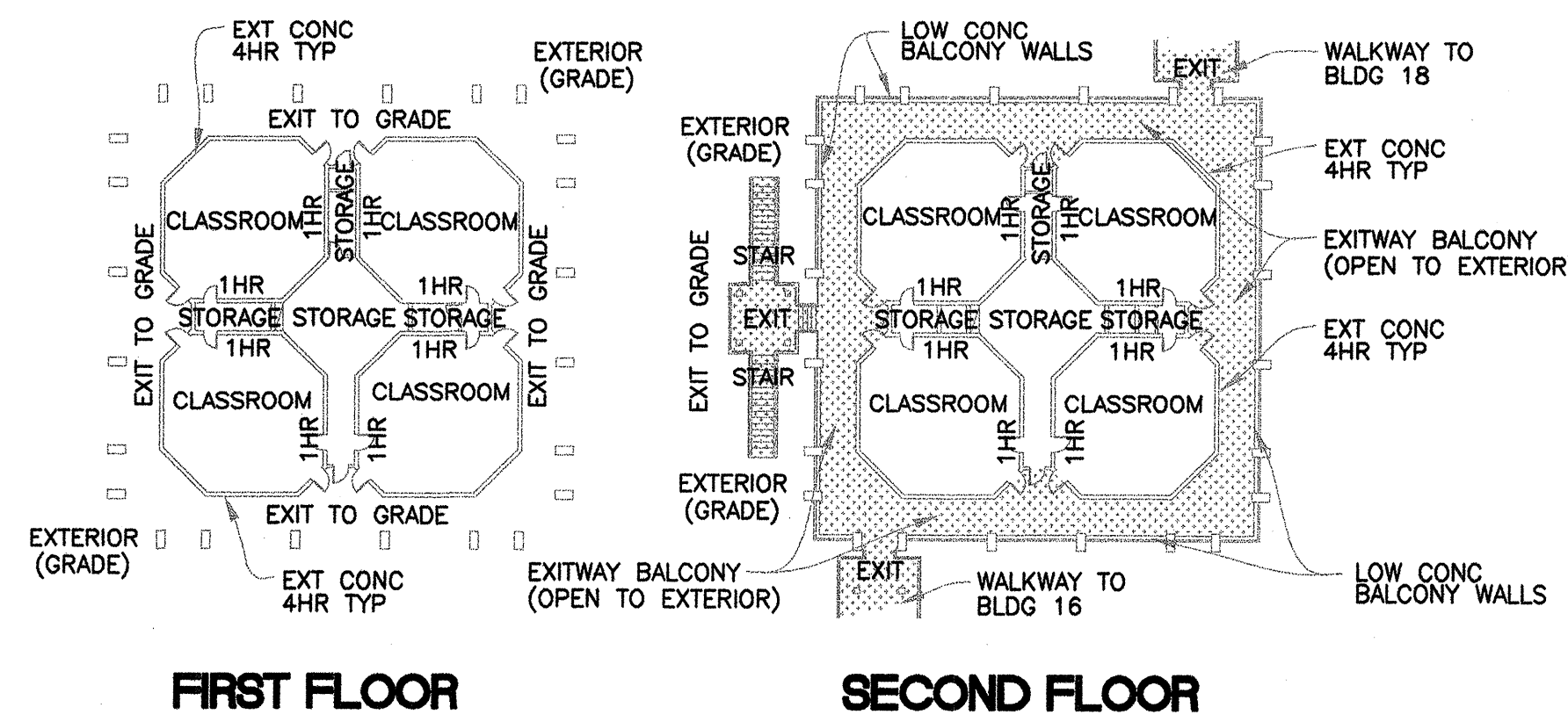

2 OVERALL FLOOR PLANS
 E1.22 BUILDING 17 1/32"=1'-0" N

NOTES:

1. REFER TO DWG. E0.01 FOR ELECTRICAL GENERAL NOTES, SYMBOLS AND ABBREVIATIONS.

DEMOLITION KEY NOTES:

- ① REMOVE AND PROPERLY DISPOSE OF ALL (E) LIGHT FIXTURES COMPLETE WITH ALL ASSOCIATED CONDUIT AND WIRE BACK TO CLOSEST JUNCTION BOX. REFLECTED CEILING PLAN SAME AS FIRST FLOOR PLAN.
- ② (E) LIGHT SWITCH(ES) TO REMAIN.
- ③ RELOCATE LIGHT SWITCH(ES), AS REQUIRED, TO ACCOMMODATE (N) DOORWAY. IF FOUR-WAY SWITCH REPLACE WITH THREE-WAY.
- ④ DISCONNECT AND REMOVE (E) AIR HANDLING UNIT DISCONNECT SWITCH AND ASSOCIATED CONDUIT AND WIRE BACK TO CLOSEST JUNCTION BOX.
- ⑤ RELOCATE RCPT TO 18" AFF.
- ⑥ REMOVE (E) LIGHT FIXTURES AND ASSOCIATED CONDUIT AND WIRE. REINSTALL (PENDANT MOUNT 9'-0") (E) LIGHT FIXTURES FOLLOWING MECHANICAL NEW WORK.
- ⑦ DISCONNECT AND PULL BACK (E) TEACHER PODIUM POWER WIRES TO CLOSEST JUNCTION BOX. CAP AND ABANDON WIRES. PROVIDE BLANK COVER FLUSH WITH FINISHED FLOOR.
- ⑧ DISCONNECT AND REMOVE (E) LIGHT SWITCH(ES) AND ASSOCIATED WIRE BACK TO CLOSEST JUNCTION BOX. PROVIDE BLANK STAINLESS STEEL COVER.
- ⑨ REPLACE (E) FOUR-WAY SWITCH(ES) WITH THREE-WAY SWITCH(ES).
- ⑩ DISCONNECT AND REMOVE (E) LIGHT SWITCH. REFER TO NEW WORK FOR (N) WALL-MOUNTED OCCUPANCY SENSOR.



CAÑADA COLLEGE
 BUILDING 16, 17, 18
 RENOVATION
 SMCCCD
 3401 CSM Drive
 San Mateo, CA 94402
 Cañada College
 4200 FarmHills Blvd.
 Redwood City, CA 94061

SHEET TITLE
 BUILDING 17
 SECOND FLOOR PLAN
 DEMOLITION

REVISIONS		
NO.	DATE	DESCRIPTION

PROJECT RECORD DOCUMENT
 BID: 86519 DATED 2-7-07
 PREPARED BY:
Engelhart
 ELECTRIC CO. INC.
 SERVES THE PENINSULA
 ELECTRICAL CONTRACTOR • LICENSE #399195
 1052 Commercial Street, San Carlos, Ca. 94070
 Bus: (650) 595-1091 • Fax: (650) 595-5489

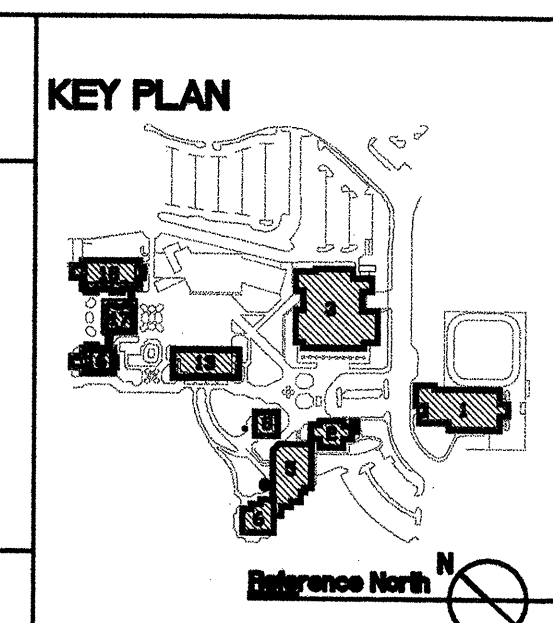

DATE
 DRAWN U. TRUONG
 CHECKED D. DIAS
 SCALE AS NOTED
 N&T JOB NO.:

SHEET NUMBER
E1.22