



IDENTIFICATION STAMP
 DIV. OF THE STATE ARCHITECT
 OFFICE OF REGULATION SERVICE

APPL. # 01-110097

AC: _____ FLS: _____ SS: _____

DATE: _____

FILE NUMBER: _____

This set of other project documents and all items, methods and design incorporated therein are trademarks of service. All project documents are the registered property of LPA, Inc. (LPA) and cannot be further used in whole or in part for any project or program not intended to be a reproduction of the original project documents. The reproduction or modification of any project document is prohibited without the written consent of LPA. LPA hereby grants limited access to any such project documents only for reproduction or modification (reused) if not only intended but substantially based on project documents prepared by LPA. LPA and LPA's Consultants shall retain the right to use any such project documents for any other project without the written consent of LPA. LPA and LPA's Consultants make no representation or warranty concerning the accuracy of documents and are not responsible for any discrepancies between project documents and the existing conditions.

© Copyright 2008

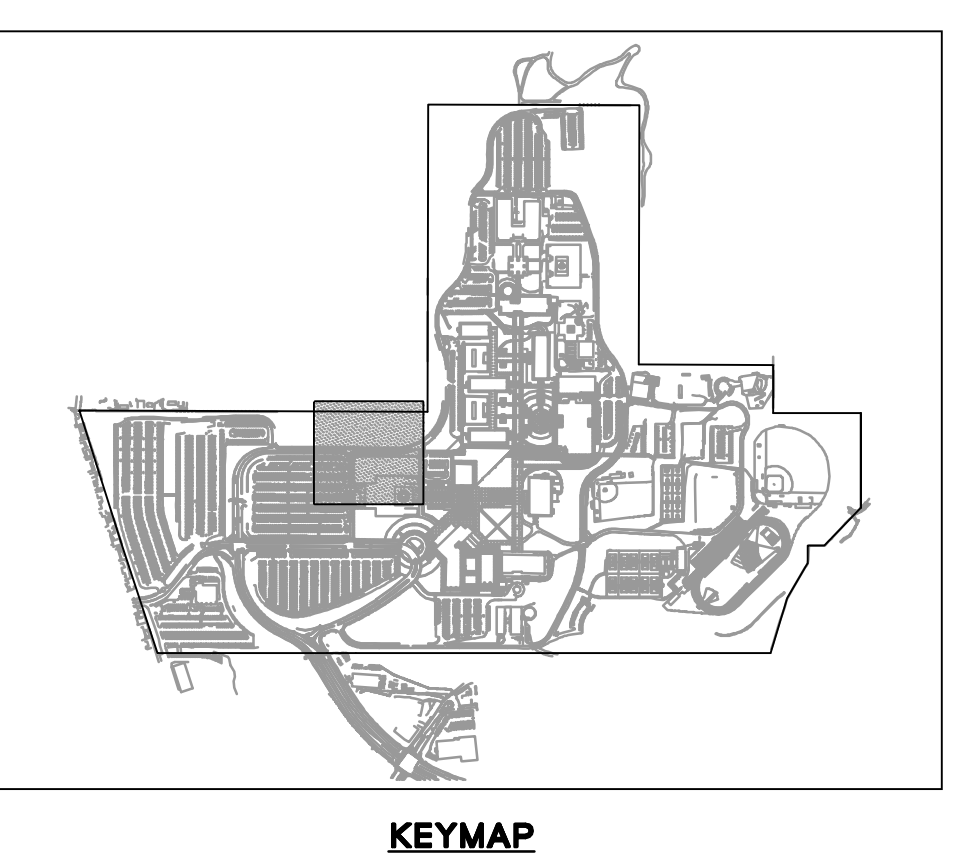
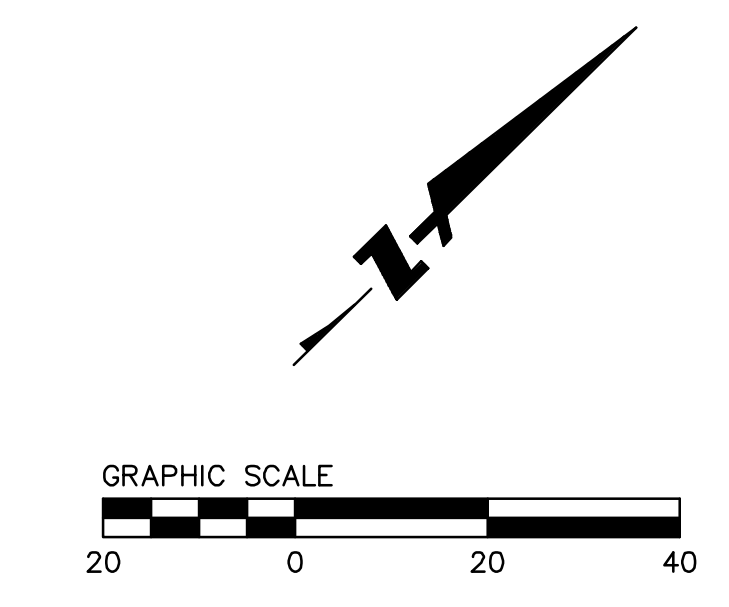
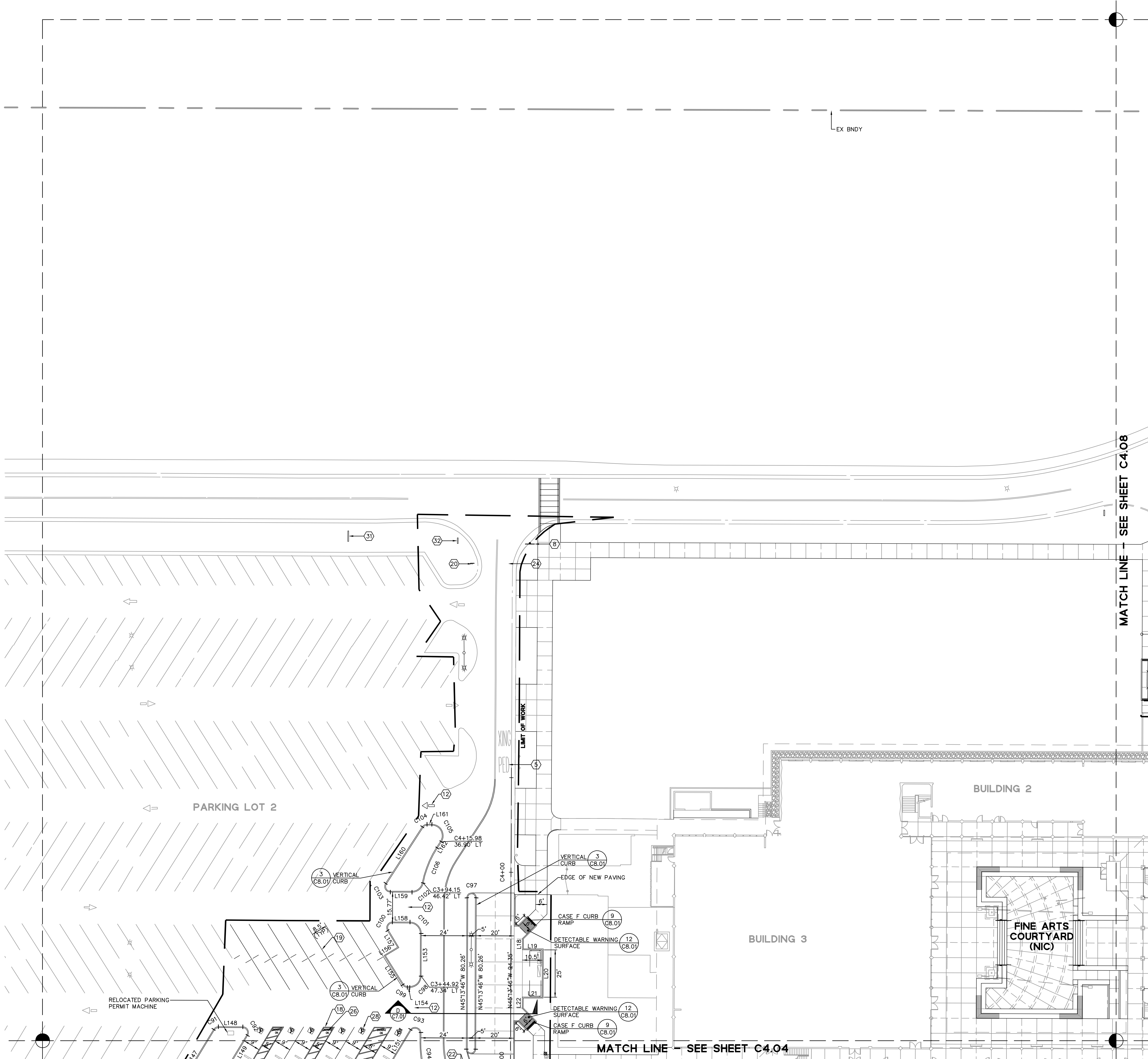

NOTES

1. SEE SHEET C4.01 FOR LINE & CURVE TABLE, AND HORIZONTAL CONTROL NOTES.

MARKING, SIGNING, & STRIPING LEGEND

SYMBOL	DESCRIPTION
1	LANE LINE STRIPING, CALTRANS DETAIL 13 PER STANDARD PLAN A20A
2	CHEVRON MARKING PER SEC. 38.101(CA) OF CALIFORNIA MUTCD
3	TYPE IV (L) ARROW PER CALTRANS STANDARD PLAN A24A
4	TYPE IV (R) ARROW PER CALTRANS STANDARD PLAN A24A
5	"PED XING" LETTERING (6" TALL LETTERS)
6	R59 (RT) SIGN WITH "RIGHT TURN ONLY"
7	"ONE-WAY" SIGN (R6-1)
8	STOP SIGN (R1-1)
9	R26(S)(CA) - "NO STOPPING ANYTIME" - SEE NOTES 4 & 6
10	BLUE REFLECTIVE MARKER
11	DETAIL 38, CHANNELIZING LINE PER STANDARD PLAN A200
12	THRU ARROW PER CALTRANS STANDARD PLAN A24A
13	"BUSES ONLY" SIGN
14	TYPE VII (R) ARROW PER CALTRANS STANDARD PLAN A24A (THRU/RIGHT TURN COMBINATION)
15	"VAN ACCESSIBLE" SIGNAGE, SEE DETAIL 1 ON SHEET C8.02
16	CA TYPE K-1 (OM2-1H) OBJECT MARKER WITH R4-7 "KEEP RIGHT" SIGN.
17	ACCESSIBLE STALL SIGN, SEE DETAIL 1 ON SHEET C8.02
18	4 INCH DIAGONAL STRIPING AT 36" O.C., SEE DETAIL 1 ON SHEET C8.02
19	4 INCH WHITE STRIPING FOR PARKING STALLS
20	TOW AWAY SIGNAGE, SEE DETAIL 1 ON SHEET C8.02
21	STOP BAR (12" WHITE STRIPING)
22	CROSSWALK (12" WHITE PAINT; 6' WIDE MINIMUM)
23	"NO PARKING" SIGN
24	"STOP" LETTERING (6" TALL LETTERS)
25	"YIELD" LETTERING (6" TALL LETTERS)
26	"NO PARKING" LETTERING (12" TALL LETTERS)
27	"LOADING ZONE" LETTERING (12" TALL LETTERS)
28	INTERNATIONAL SYMBOL OF ACCESSIBILITY - SEE DETAIL 1 ON SHEET C8.02
29	PERMIT PARKING SIGN - COORDINATE WITH SMCCCD
30	"BUSES ONLY" LETTERING (2.5' TALL LETTERS)
31	DIRECTIONAL SIGNAGE - SEE LANDSCAPE PLANS
32	CAMPUS MAP DIRECTORY - SEE LANDSCAPE PLANS
33	"STOP AHEAD" SIGN
34	"ONE WAY - DO NOT ENTER" SIGN
35	4 INCH WHITE DIAGONAL STRIPING AT 36" O.C.
36	"ACCESSIBLE DROP OFF/LOADING ZONE" LETTERING (2.5' TALL LETTERS)

RECORD DRAWINGS

THESE RECORD DOCUMENTS HAVE BEEN PREPARED BASED ON INFORMATION PROVIDED BY OTHERS. BKF ENGINEERS HAS NOT VERIFIED THE ACCURACY AND/OR COMPLETENESS OF THIS INFORMATION AND SHALL NOT BE RESPONSIBLE FOR ANY ERRORS OR OMISSIONS THAT MAY BE INCORPORATED HEREIN AS A RESULT. BKF ENGINEERS DOES NOT ASSUME ANY RESPONSIBILITY FOR THE FIELD MODIFICATIONS TO THE PLANS.

BY: BKF ENGINEERS DATE: JUNE 2011

College of San Mateo
 Site Package
 San Mateo, CA

Developed for
 San Mateo County Community College District

Date: _____
 Revision Description: _____

Revision Description: _____
 Date: _____

19 SEPT 2008
 09 APRIL 2009
 PROJECT RECORD DRAWING JUNE 2011

Job No: 27082.30
 Date: 02 APRIL 2009
 Drawn by: MD, JT
 Checked by: RH
 Scale: 1"=20'

HORIZONTAL CONTROL PLAN

C4.07