

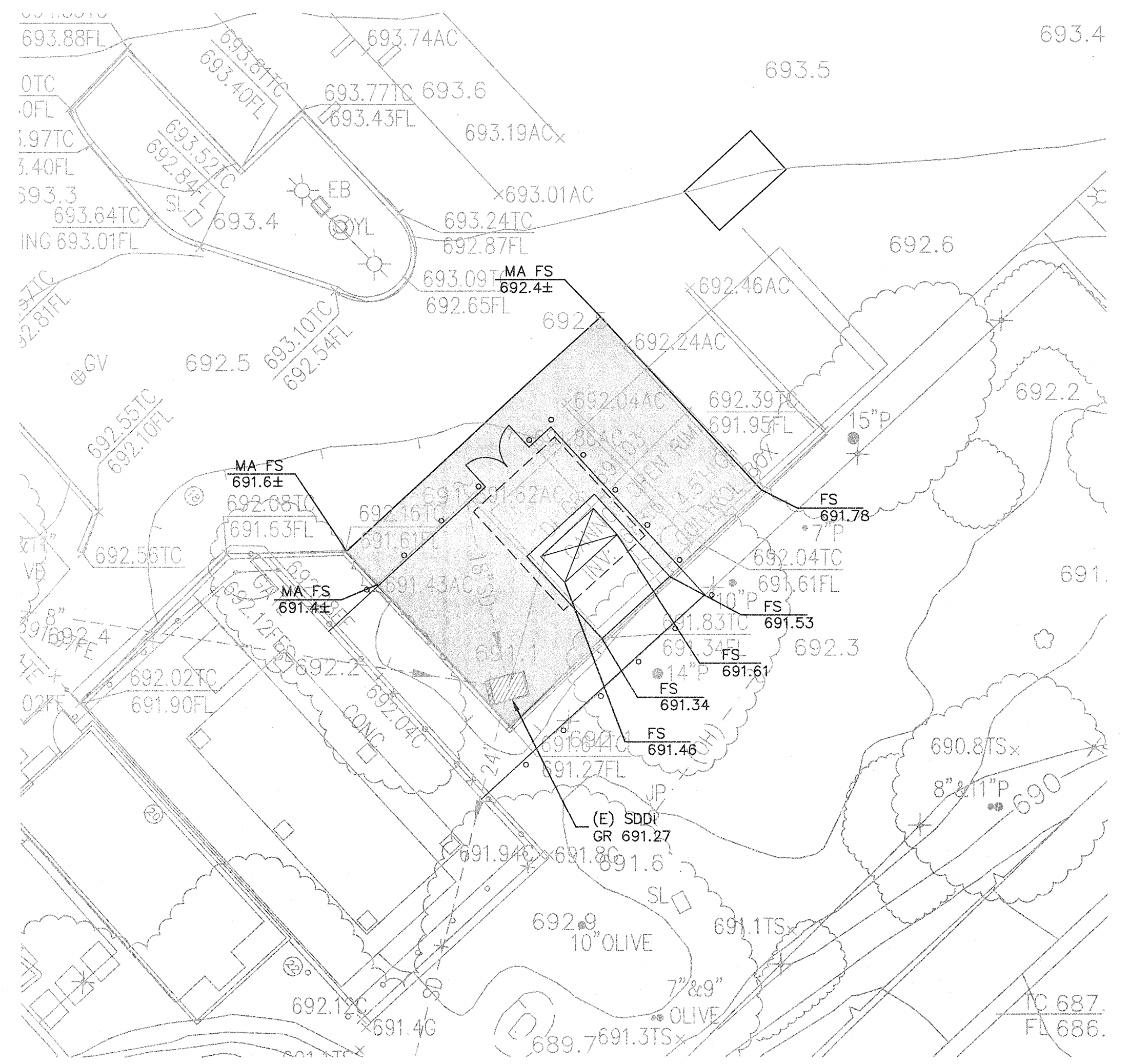

1 **BUILDING 16**  
SCALE: 1" = 10'



2 **BUILDING 3**  
SCALE: 1" = 10'

- NOTES:**
1. ALL PROPOSED STORM DRAIN INLETS SHALL BE 12"x12" UNLESS OTHERWISE NOTED.
  2. EXISTING UTILITY COVERS TO BE ADJUSTED TO GRADES SHOWN ON PLAN.
  3. FOR WALKS AND IN ADA ACCESSIBLE AREAS CROSS SLOPES SHOULD NOT EXCEED 2% GRADE.
  4. IF, DURING CONSTRUCTION, ARCHEOLOGICAL OR NATIVE AMERICAN REMAINS OR ARTIFACTS ARE ENCOUNTERED, THE CONTRACTOR SHALL HALT CONSTRUCTION IN THE VICINITY AND SHALL NOTIFY DISTRICT IMMEDIATELY.

- LEGEND**
- SD CLEANOUT
  - SD DROP INLET
  - PROPOSED FLOW DIRECTION
  - (N) PVC STORM DRAIN LINE
  - PERFORATED PIPE
  - FLOW LINE
  - (262) EXISTING CONTOUR
  - (283) PROPOSED CONTOUR
  - ADJ ADJUST
  - (E) EXISTING
  - FG FINISHED GRADE (EARTH)
  - FL FLOWLINE
  - FS FINISHED SURFACE (AC OR PCC)
  - GR GRADE
  - INV INVERT
  - LF LINEAL FEET
  - MA MATCH
  - (N) NEW
  - PERF PERFORATED
  - S SLOPE
  - SD STORM DRAIN

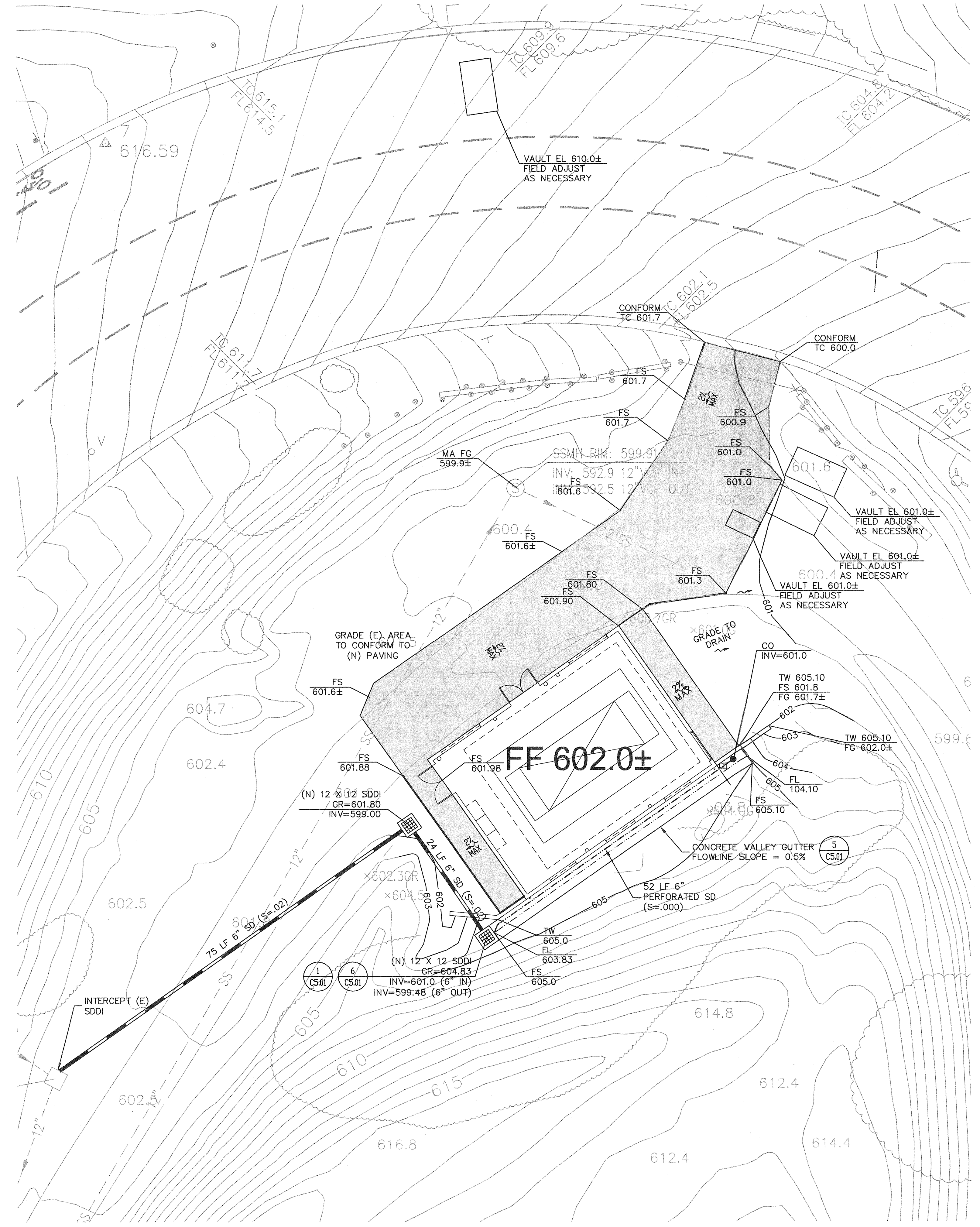

3 **BUILDING 30**  
SCALE: 1" = 10'

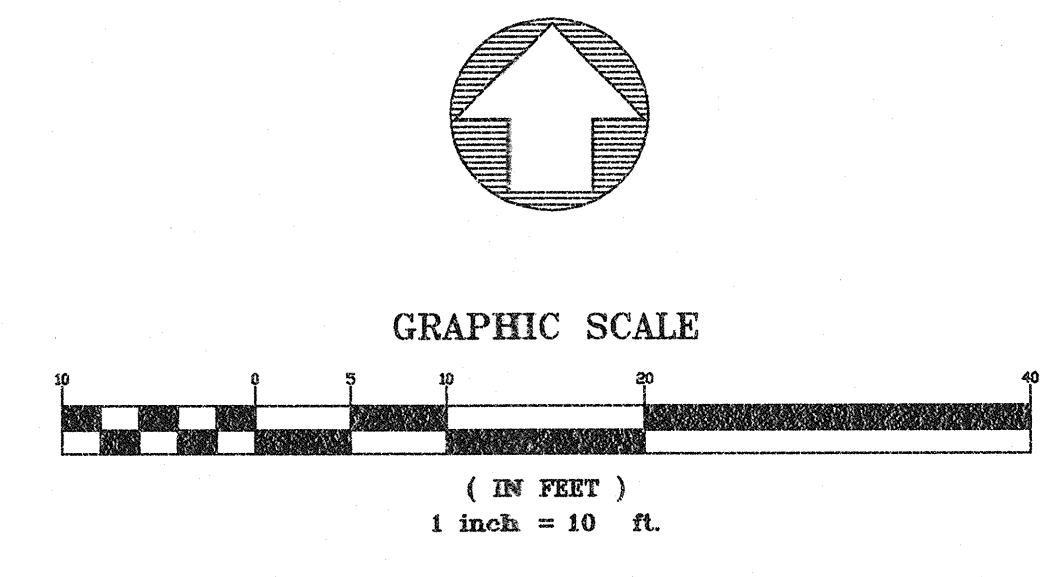

**noll & tam**  
architects and planners  
725 Heinz Avenue  
Berkeley, CA 94710  
510.845.8295  
fax 510.849.3008

**BKF**  
ENGINEERS / SURVEYORS / PLANNERS  
1646 N. CALIFORNIA BLVD.  
SUITE 400  
WALNUT CREEK, CA 94596  
925-940-2200  
925-940-2299 (FAX)

REGISTERED PROFESSIONAL ENGINEER  
No. 51158  
Exp. 09/30/11  
CIVIL  
STATE OF CALIFORNIA

IDENTIFICATION STAMP  
DIVISION OF THE STATE ARCHITECT  
APPLICATION NUMBER 01-11618  
DATE 2/9/11

CALIFORNIA STATE FIRE MARSHAL  
APPROVED

**CAÑADA COLLEGE**  
Electrical  
Infrastructure  
Replacement  
Project  
4200 Farm Hill Blvd  
Redwood City, CA 94061

BID SET

SHEET TITLE  
**GRADING AND DRAINAGE PLAN  
BUILDING 30**

REVISIONS

NO.	DATE	DESCRIPTION

DATE January 14, 2011  
DRAWN ESS  
CHECKED RCS  
SCALE 1" = 10'  
JOB NO. 2921.01  
SHEET NUMBER  
**C4.01**