

KEYMAP

NOTES

- SEE SHEET C4.01 FOR LINE & CURVE TABLE, AND HORIZONTAL CONTROL NOTES.

MARKING, SIGNING, & STRIPING LEGEND

SYMBOL	DESCRIPTION
(1)	LANE LINE STRIPING, CALTRANS DETAIL 13 PER STANDARD PLAN A20A
(2)	CHEVRON MARKING PER SEC. 38.101(CA) OF CALIFORNIA MUTCD
(3)	TYPE IV (L) ARROW PER CALTRANS STANDARD PLAN A24A
(4)	TYPE IV (R) ARROW PER CALTRANS STANDARD PLAN A24A
(5)	"PED XING" LETTERING (6" TALL LETTERS)
(6)	R59 (RT) SIGN WITH "RIGHT TURN ONLY"
(7)	"ONE-WAY" SIGN (R6-1)
(8)	STOP SIGN (R1-1)
(9)	R26(S)(CA) - "NO STOPPING ANYTIME" - SEE NOTES 4 & 6
(10)	BLUE REFLECTIVE MARKER
(11)	DETAIL 38, CHANNELIZING LINE PER STANDARD PLAN A20D
(12)	THRU ARROW PER CALTRANS STANDARD PLAN A24A
(13)	"BUSES ONLY" SIGN
(14)	TYPE VII (R) ARROW PER CALTRANS STANDARD PLAN A24A (THRU/RIGHT TURN COMBINATION)
(15)	"VAN ACCESSIBLE" SIGNAGE, SEE DETAIL 1 ON SHEET C8.02
(16)	CA TYPE K-1 (OM2-1H) OBJECT MARKER WITH R4-7 "KEEP RIGHT" SIGN.
(17)	ACCESSIBLE STALL SIGN, SEE DETAIL 1 ON SHEET C8.02
(18)	4 INCH DIAGONAL STRIPING AT 36" O.C., SEE DETAIL 1 ON SHEET C8.02
(19)	4 INCH WHITE STRIPING FOR PARKING STALLS
(20)	TOW AWAY SIGNAGE, SEE DETAIL 1 ON SHEET C8.02
(21)	STOP BAR (12" WHITE STRIPING)
(22)	CROSSWALK (12" WHITE PAINT; 6" WIDE MINIMUM)
(23)	"NO PARKING" SIGN
(24)	"STOP" LETTERING (6" TALL LETTERS)
(25)	"YIELD" LETTERING (6" TALL LETTERS)
(26)	"NO PARKING" LETTERING (12" TALL LETTERS)
(27)	"LOADING ZONE" LETTERING (12" TALL LETTERS)
(28)	INTERNATIONAL SYMBOL OF ACCESSIBILITY - SEE DETAIL 1 ON SHEET C8.02
(29)	PERMIT PARKING SIGN - COORDINATE WITH SMCCCD
(30)	"BUSES ONLY" LETTERING (2.5' TALL LETTERS)
(31)	DIRECTIONAL SIGNAGE - SEE LANDSCAPE PLANS
(32)	CAMPUS MAP DIRECTORY - SEE LANDSCAPE PLANS
(33)	"STOP AHEAD" SIGN
(34)	"ONE WAY - DO NOT ENTER" SIGN
(35)	4 INCH WHITE DIAGONAL STRIPING AT 36" O.C.

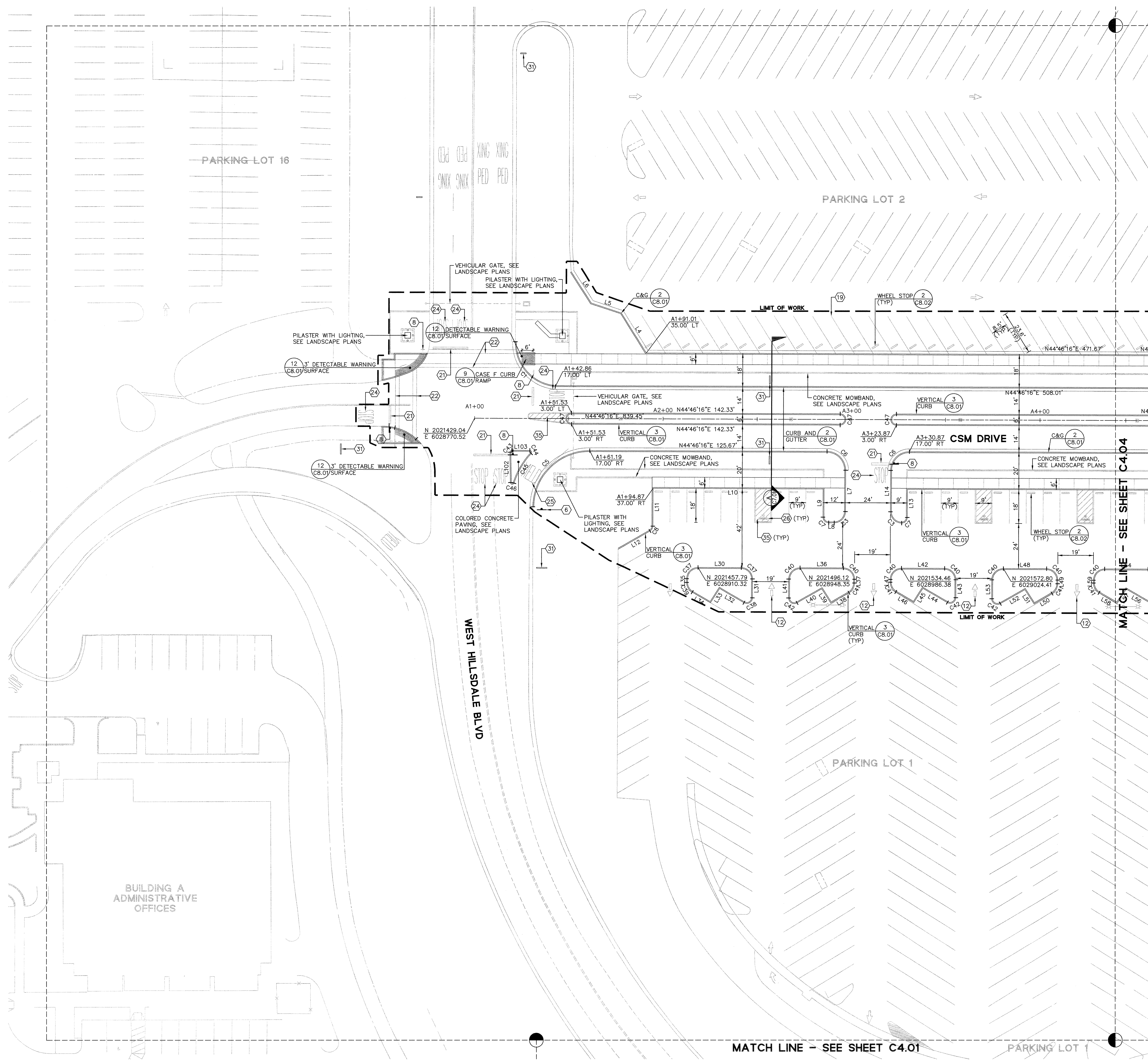

PARKING LOT 16

PARKING LOT 2

PARKING LOT 1

BUILDING A
ADMINISTRATIVE
OFFICES

WEST HILLSDALE BLVD

CSM DRIVE

MATCH LINE - SEE SHEET C4.01

MATCH LINE - SEE SHEET C4.04