

01 (E) CONDITIONS BUILDING 16 AREA DETAIL
SCALE: 1" = 10'

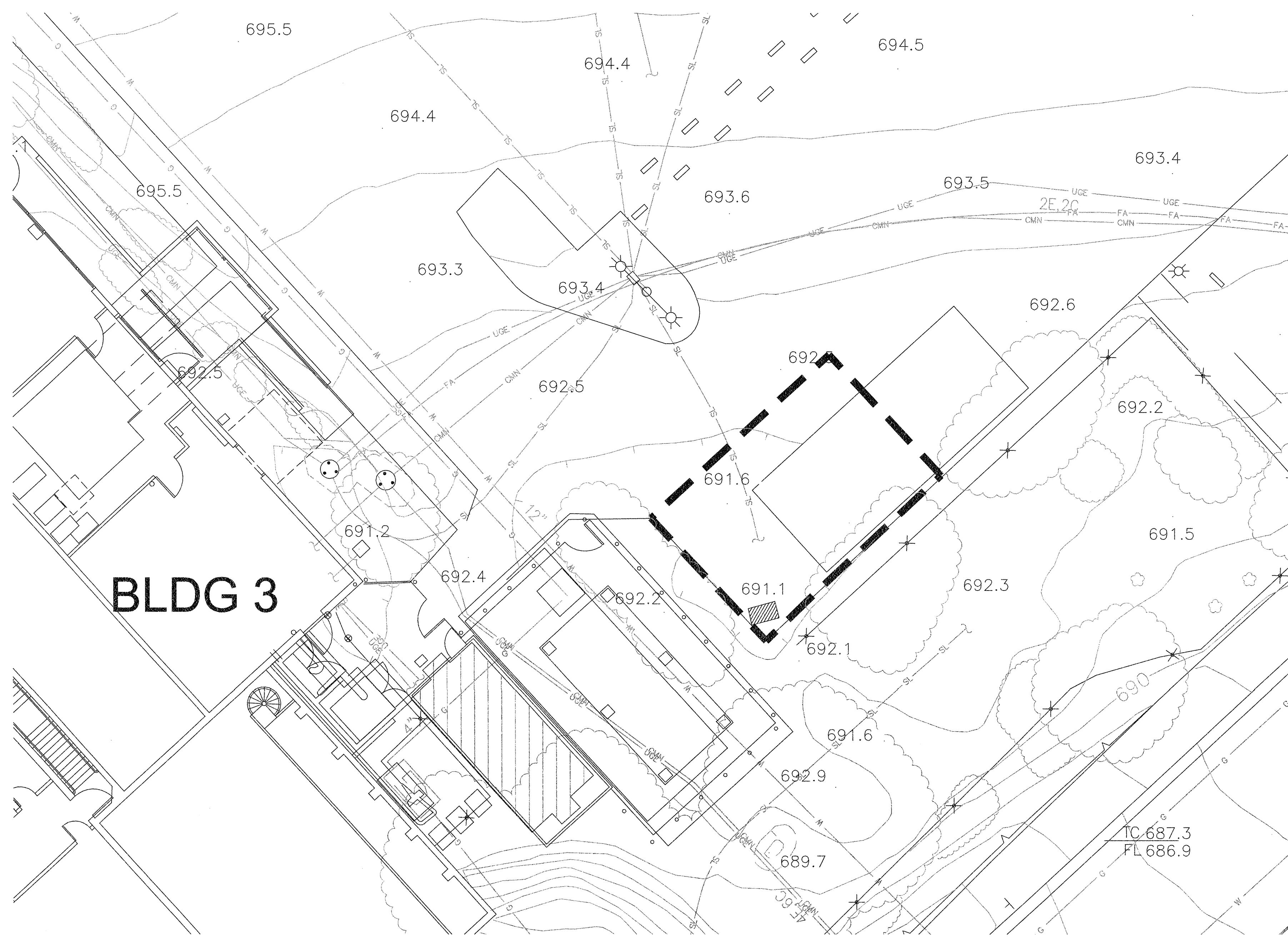

02 (E) CONDITIONS BUILDING 3 AREA DETAIL
SCALE: 1" = 10'

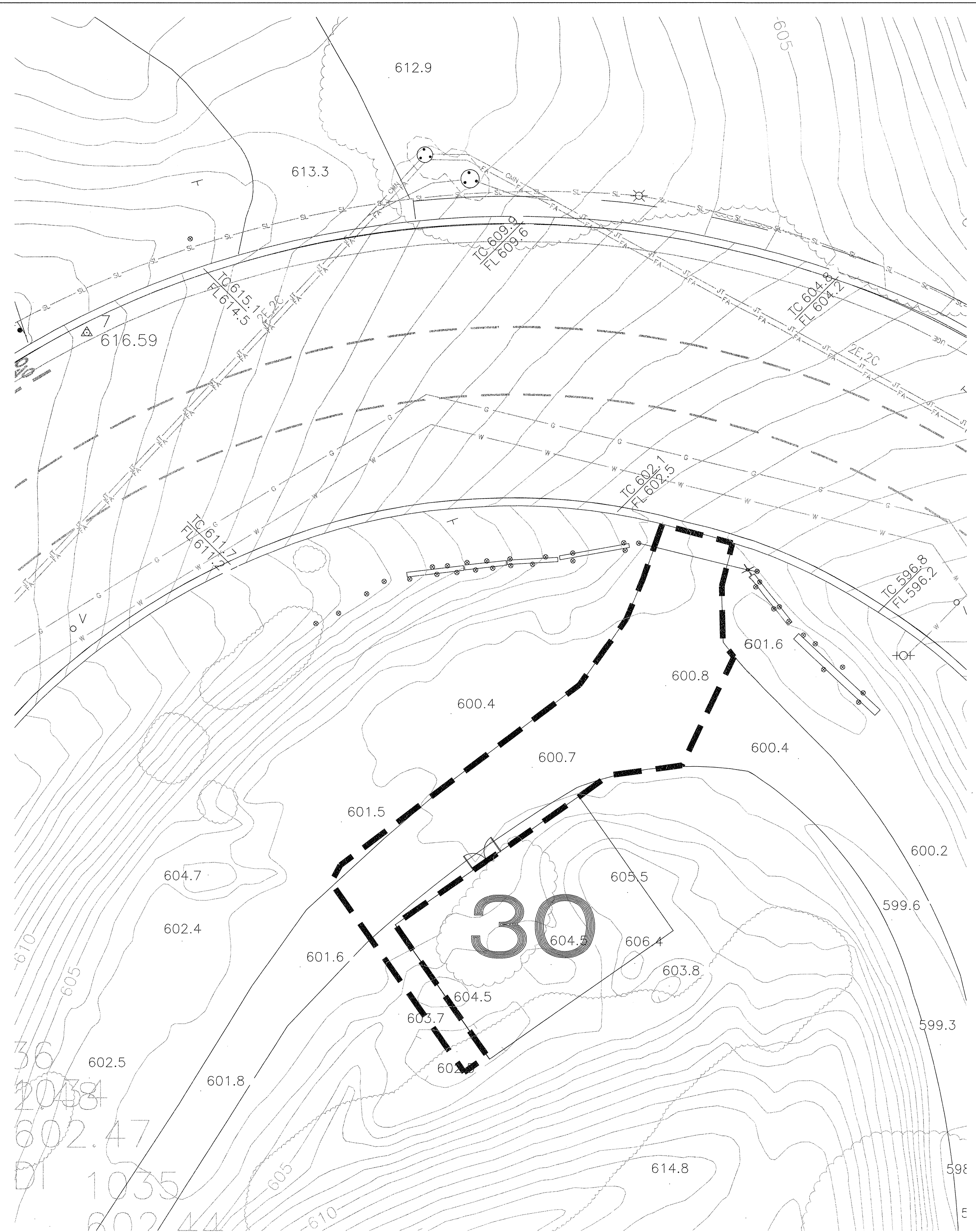

03 (E) CONDITIONS BUILDING 30 AREA DETAIL
SCALE: 1" = 10'

NOTES:

1. NOTED IMPROVEMENTS INCLUDE, BUT ARE NOT LIMITED TO, THOSE AS OUTLINED BY DASHED LINES WITHIN THE DETAILS SHOWN.

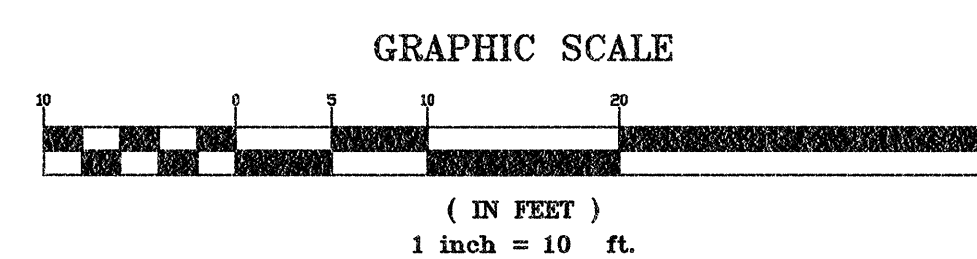
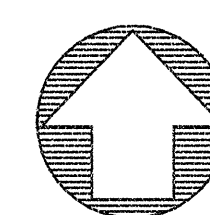

noll & tam
architects and planners
729 Heinz Avenue
Berkeley, CA 94711
510.648.2295
fax 510.648.3008

BKF
ENGINEERS / SURVEYORS / PLANNERS
1646 N. CALIFORNIA BLVD.
SUITE 400
WALNUT CREEK, CA 94596
925-940-2200
925-940-2299 (FAX)

PROFESSIONAL REGISTERED
No. 51158
EXP. 09/30/11
CIVIL
STATE OF CALIFORNIA
[Signature]

IDENTIFICATION STAMP
DIVISION OF THE STATE ARCHITECT
APPLICATION NUMBER: 102618
AC: [Signature] FILE: [Signature] DATE: 2/9/11

CALIFORNIA STATE FIRE MARSHAL
APPROVED
APPROVAL OF THIS PLAN DOES NOT AUTHORIZE OR APPROVE ANY
CONSTRUCTION OR DEVIATION FROM APPLICABLE REGULATIONS. FINAL
APPROVAL SUBJECT TO FIELD INSPECTION. ONE SET OF APPROVED
PLANS SHALL BE AVAILABLE ON THE PROJECT SITE AT ALL TIMES.
REVIEWED BY: DATE:

CAÑADA COLLEGE
Electrical
Infrastructure
Replacement
Project
4200 Farm Hill Blvd
Redwood City, CA 94061

BID SET

SHEET TITLE
DETAILED
EXISTING CONDITIONS

REVISIONS		
NO.	DATE	DESCRIPTION

DATE January 14, 2011
DRAWN ESS
CHECKED RCS
SCALE 1" = 10'
JOB NO. 2921.01
SHEET NUMBER
C1.02