

NOTE: PROVIDE FASTENERS TO ACHIEVE A 30#/SF UPLIFT LOAD.

20 BASE FLASHING @ CONC. CURB
6" = 1'-0"

16 COUNTER FLASHING @ CONC. CURB
6" = 1'-0"

12 FLOOR TRANSITION AT STAIR 07
3" = 1'-0"

8 ROOF ACCESS HATCH & LADDER SEC.
1 1/2" = 1'-0"

4 TYP. SINGLE-PLY ROOF SECTION
3" = 1'-0"

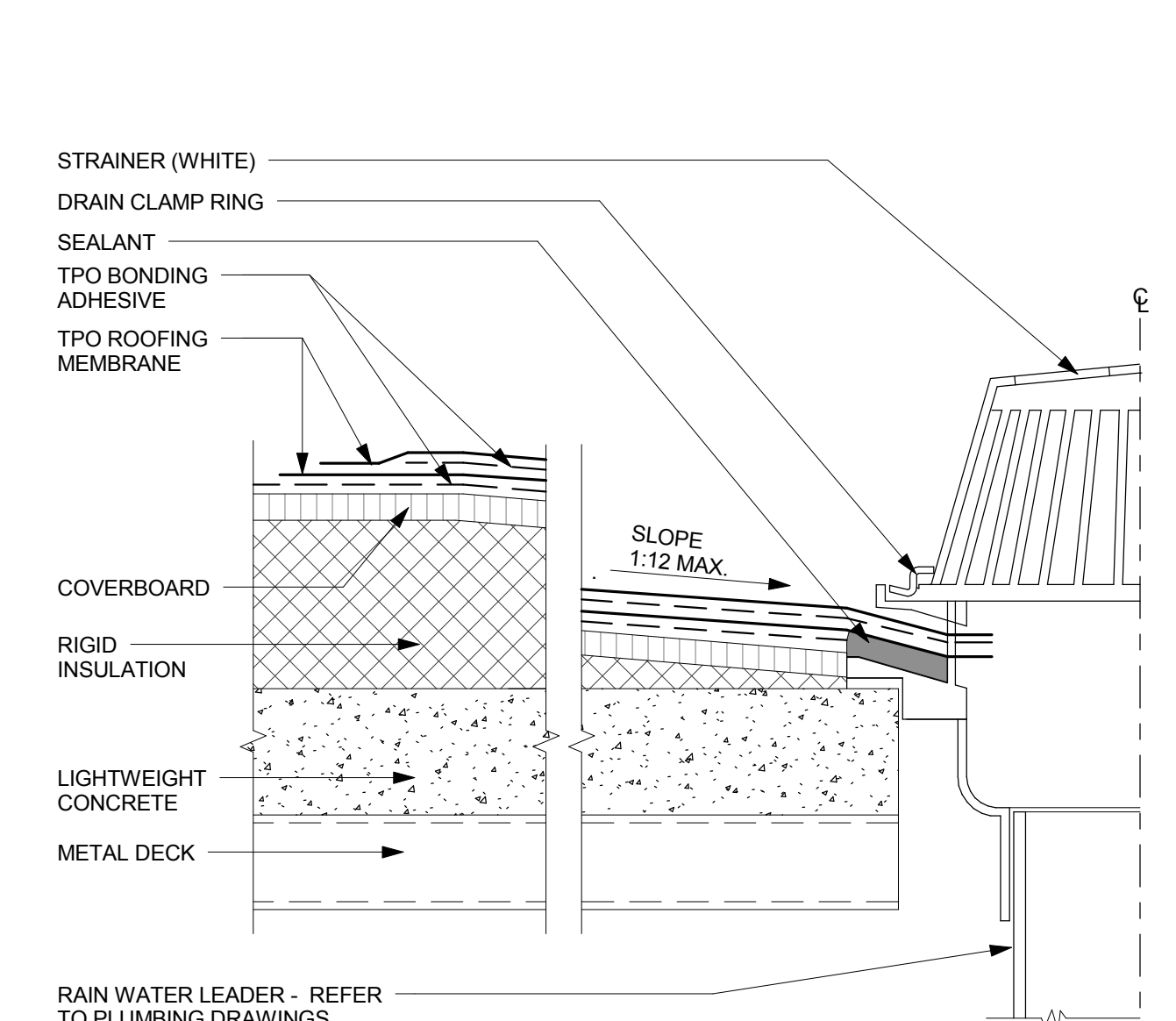
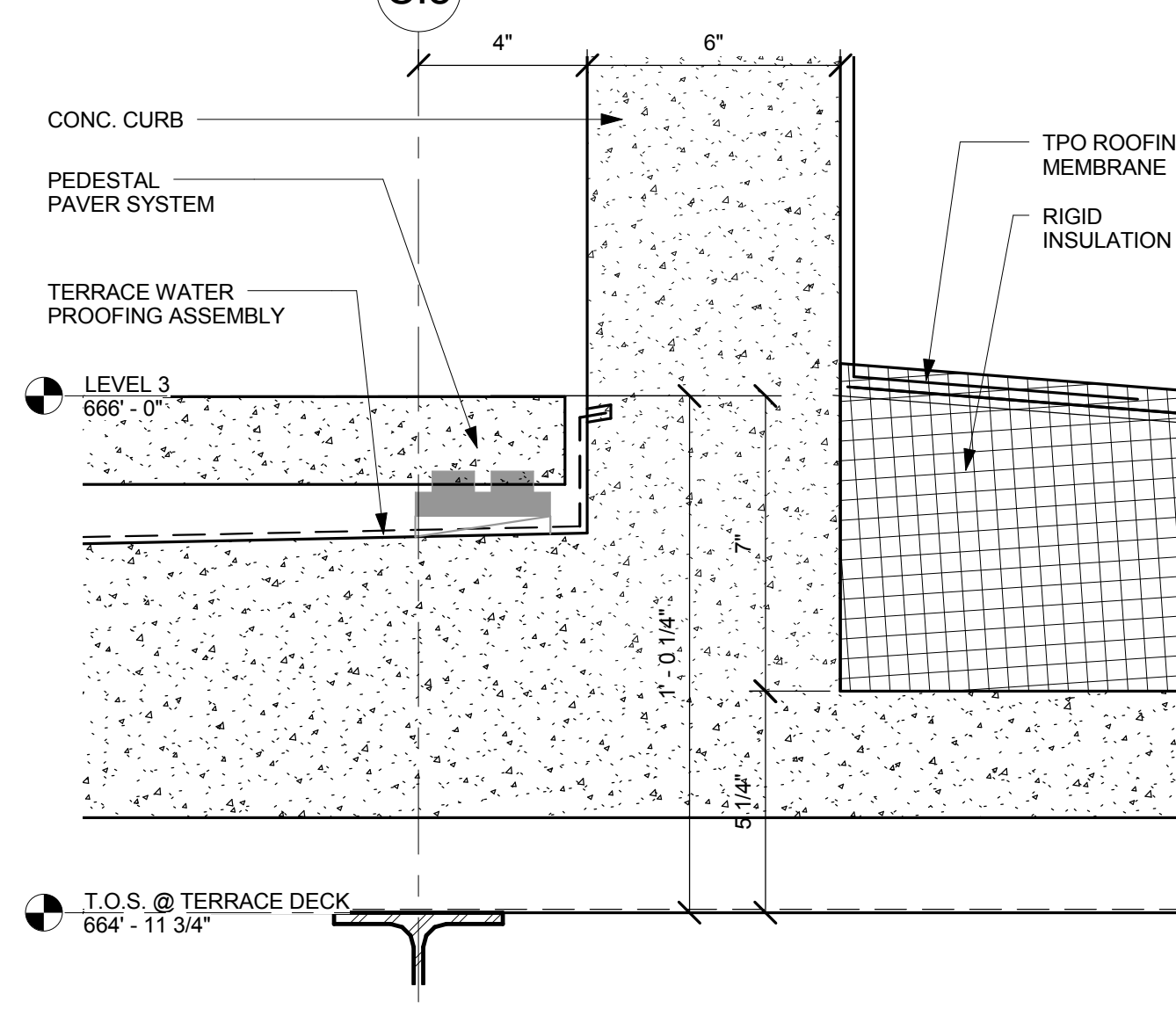
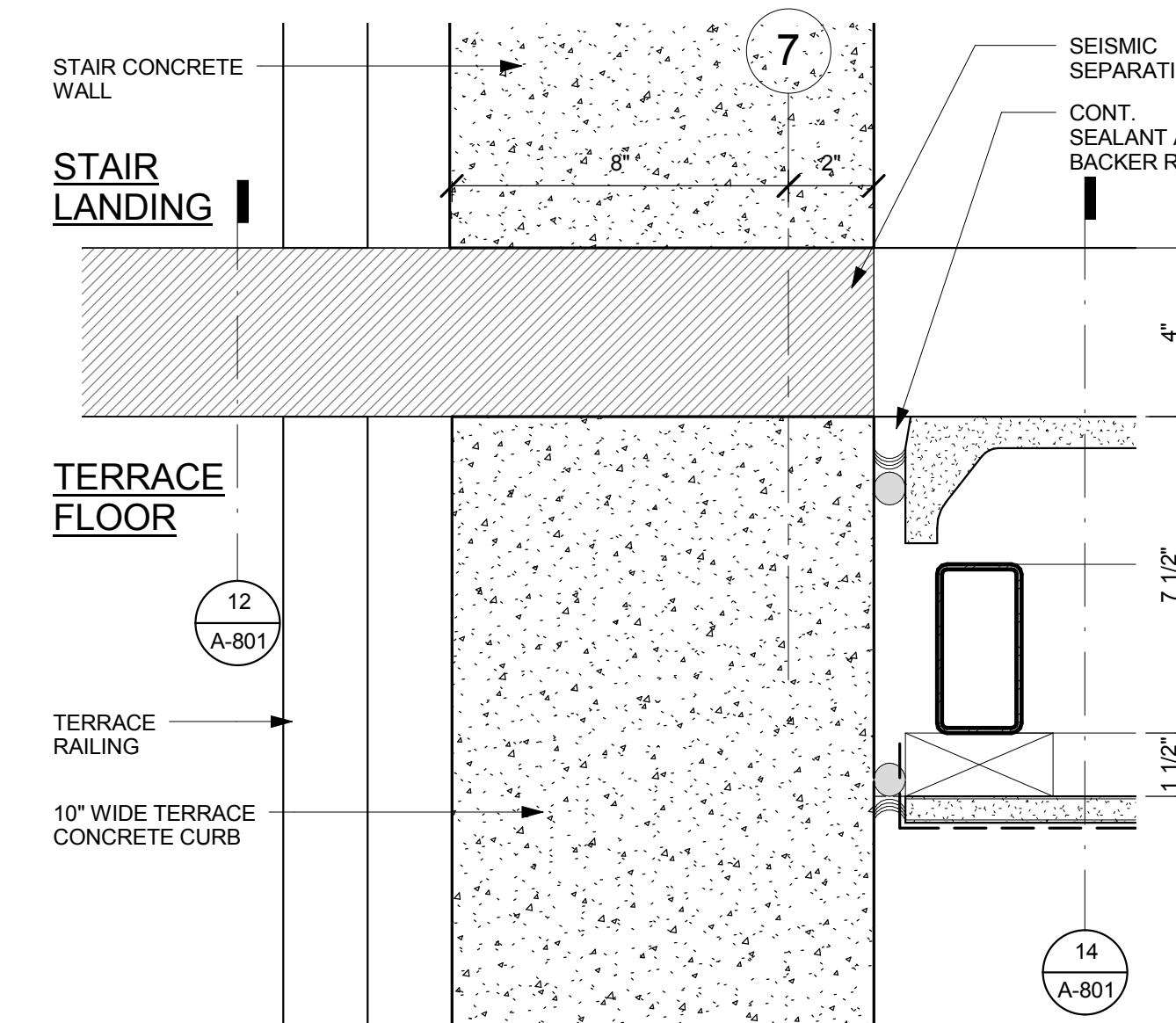
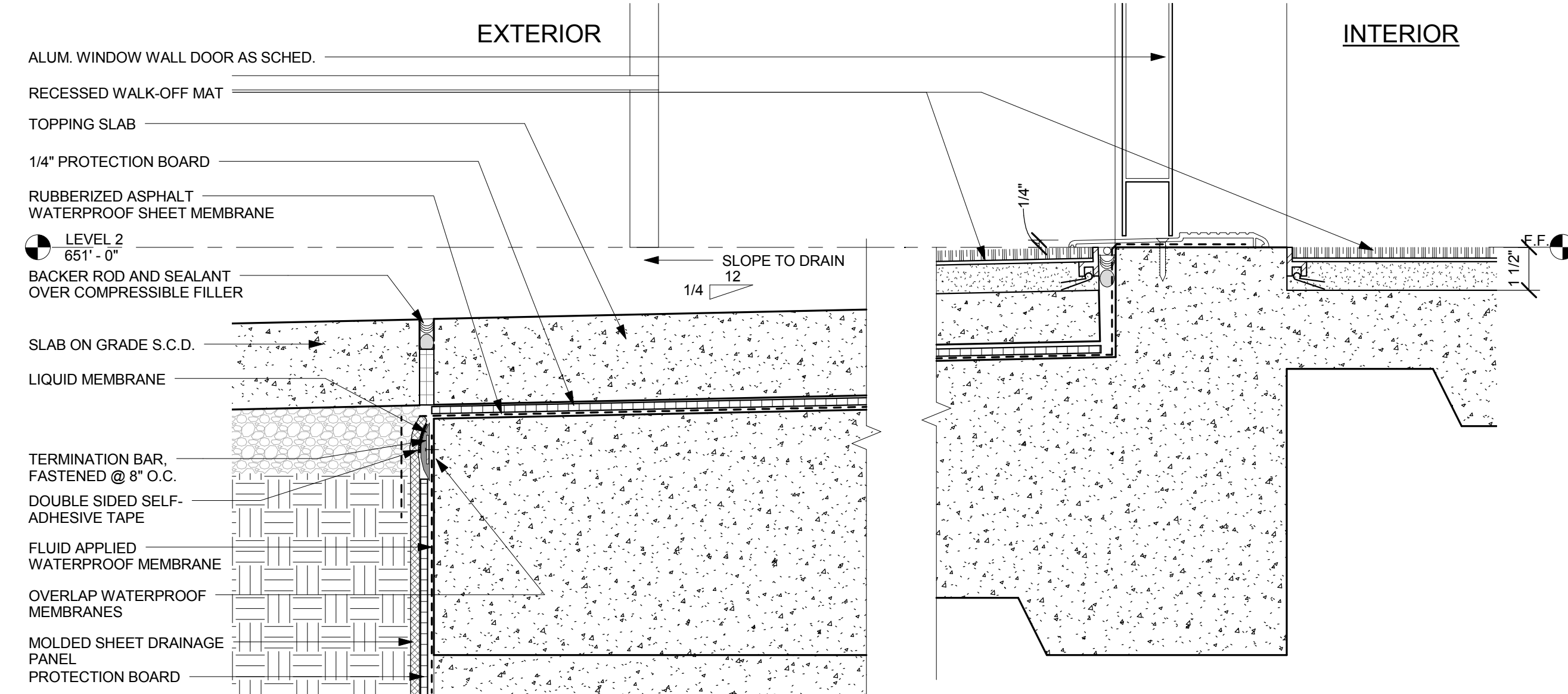

19 DEPRESSED SLAB AT WEST ENTRY
3" = 1'-0"

11 WALL JOINT DETAIL AT STAIR 07
3" = 1'-0"

7 CONC. CURB SECTION AT TERRACE
3" = 1'-0"

3 ROOF DRAIN
N.T.S.

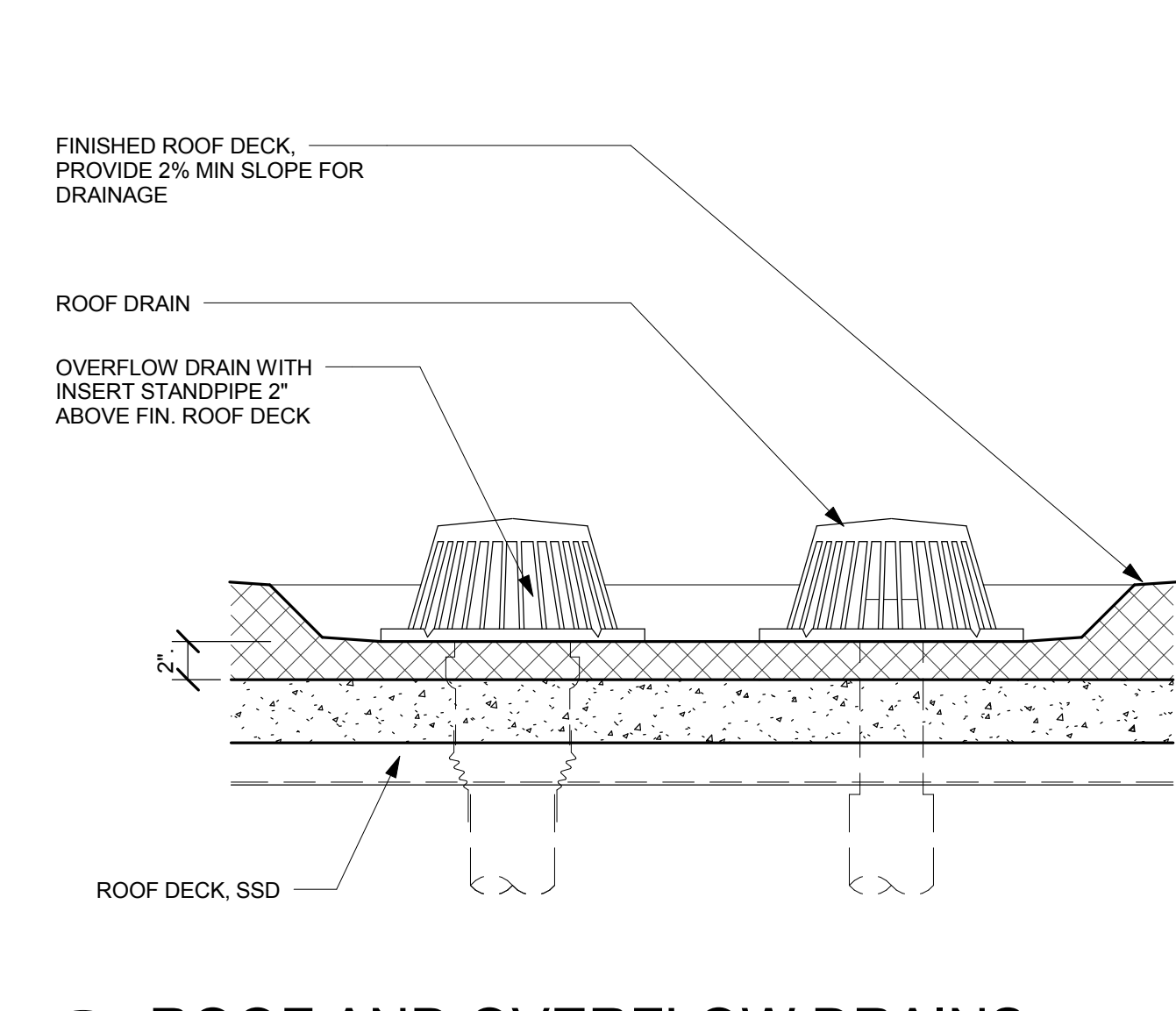
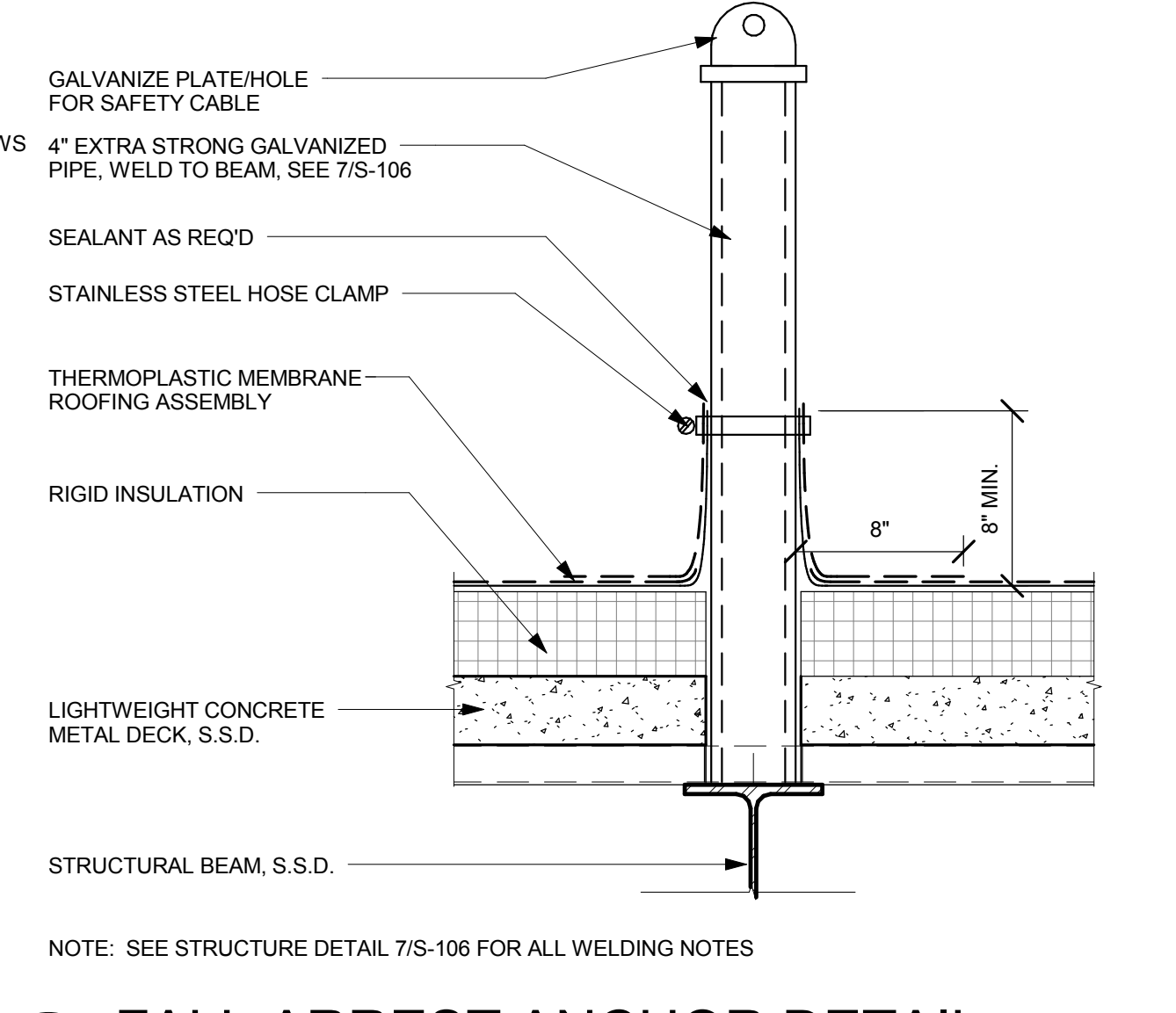
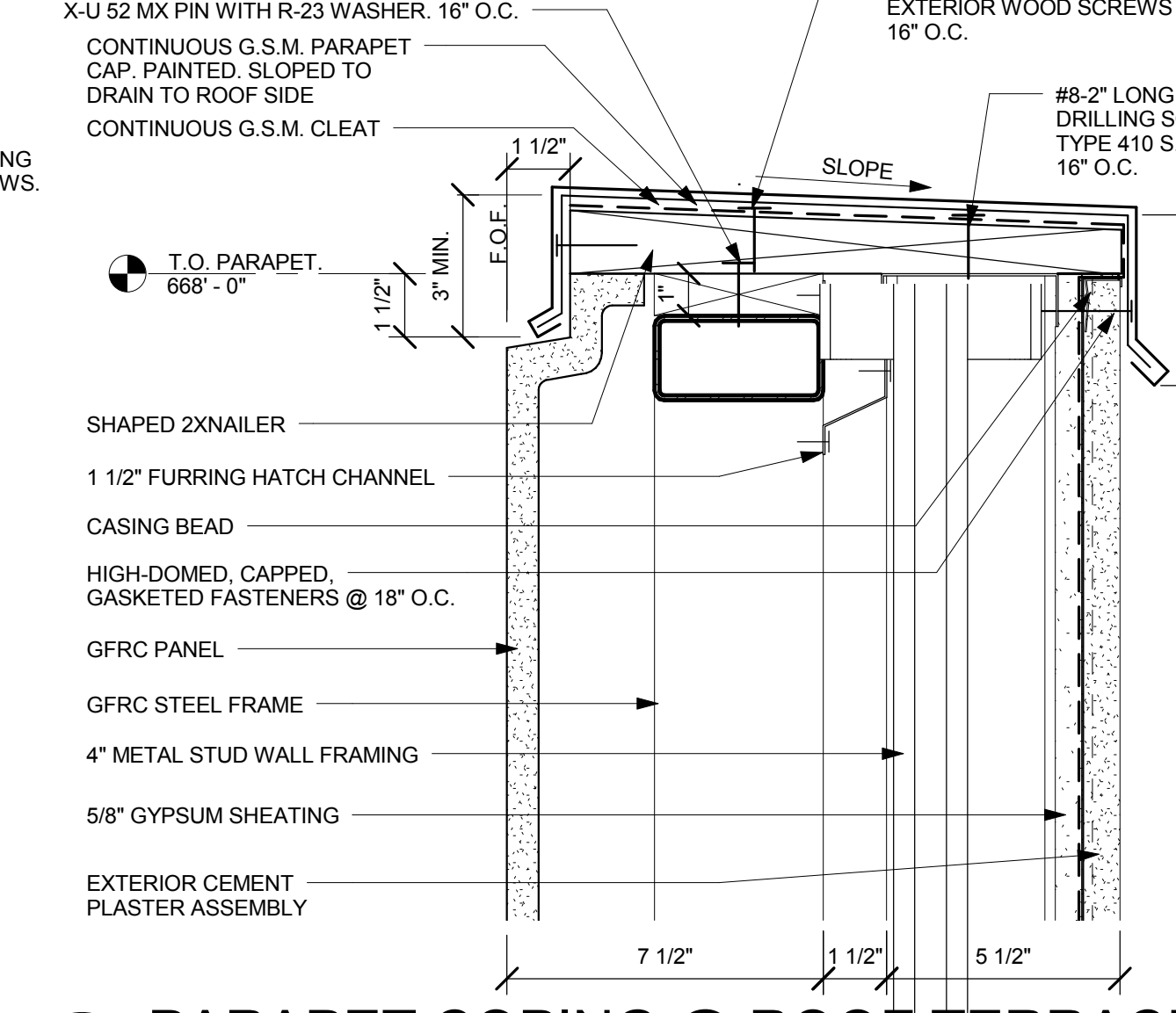
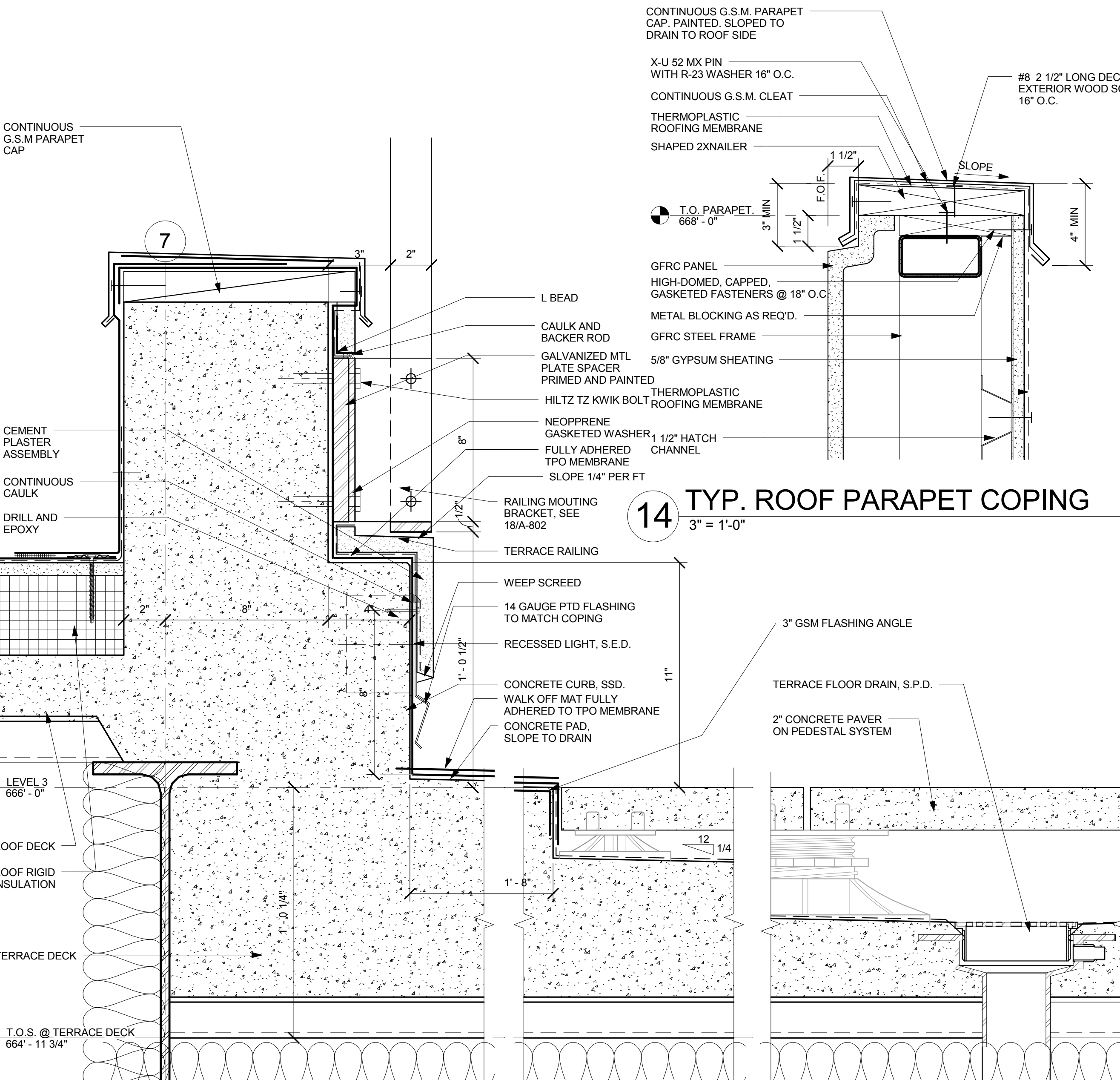

17 R. SECTION THROUGH ROOF TERRACE
3" = 1'-0"

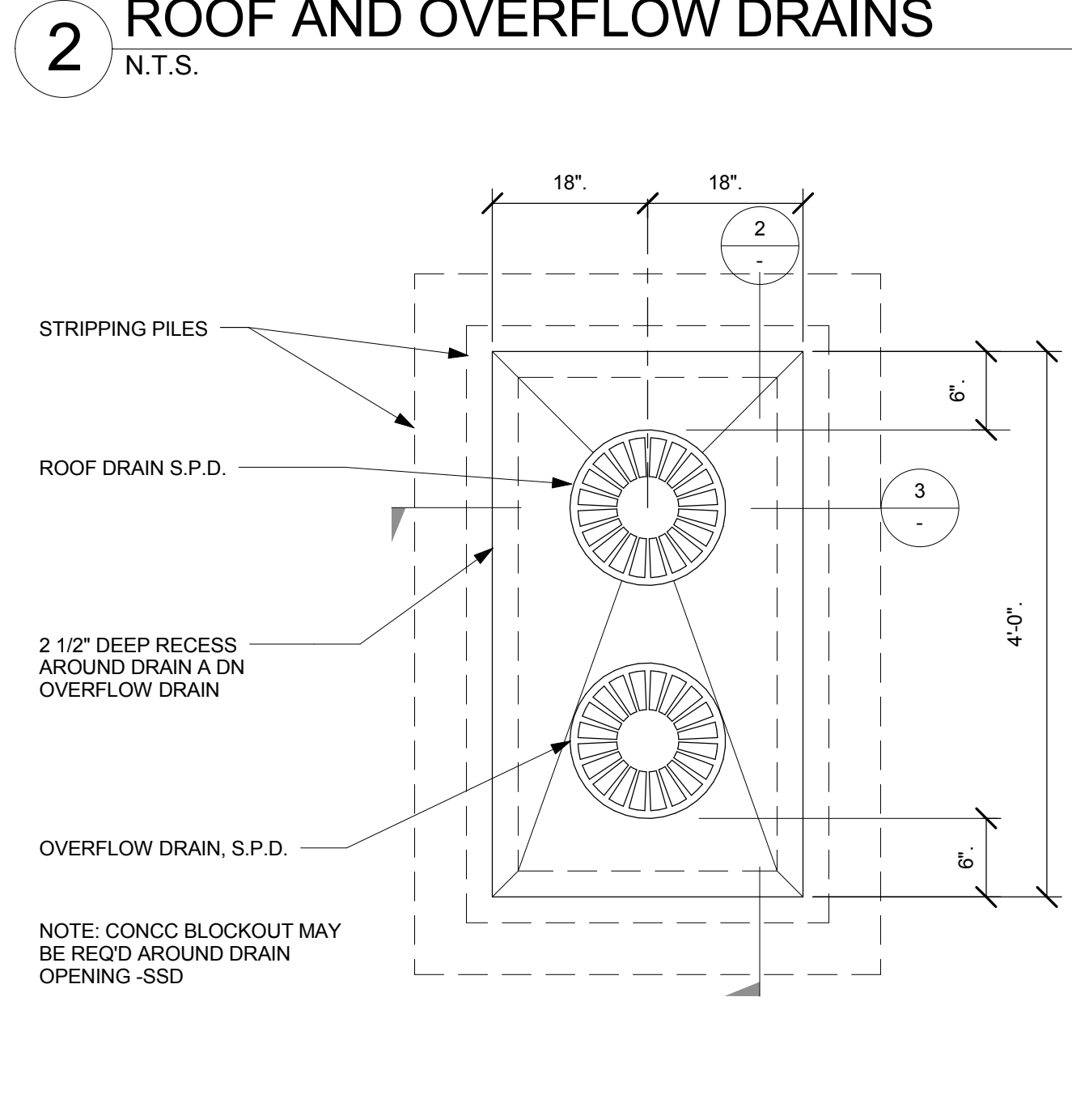
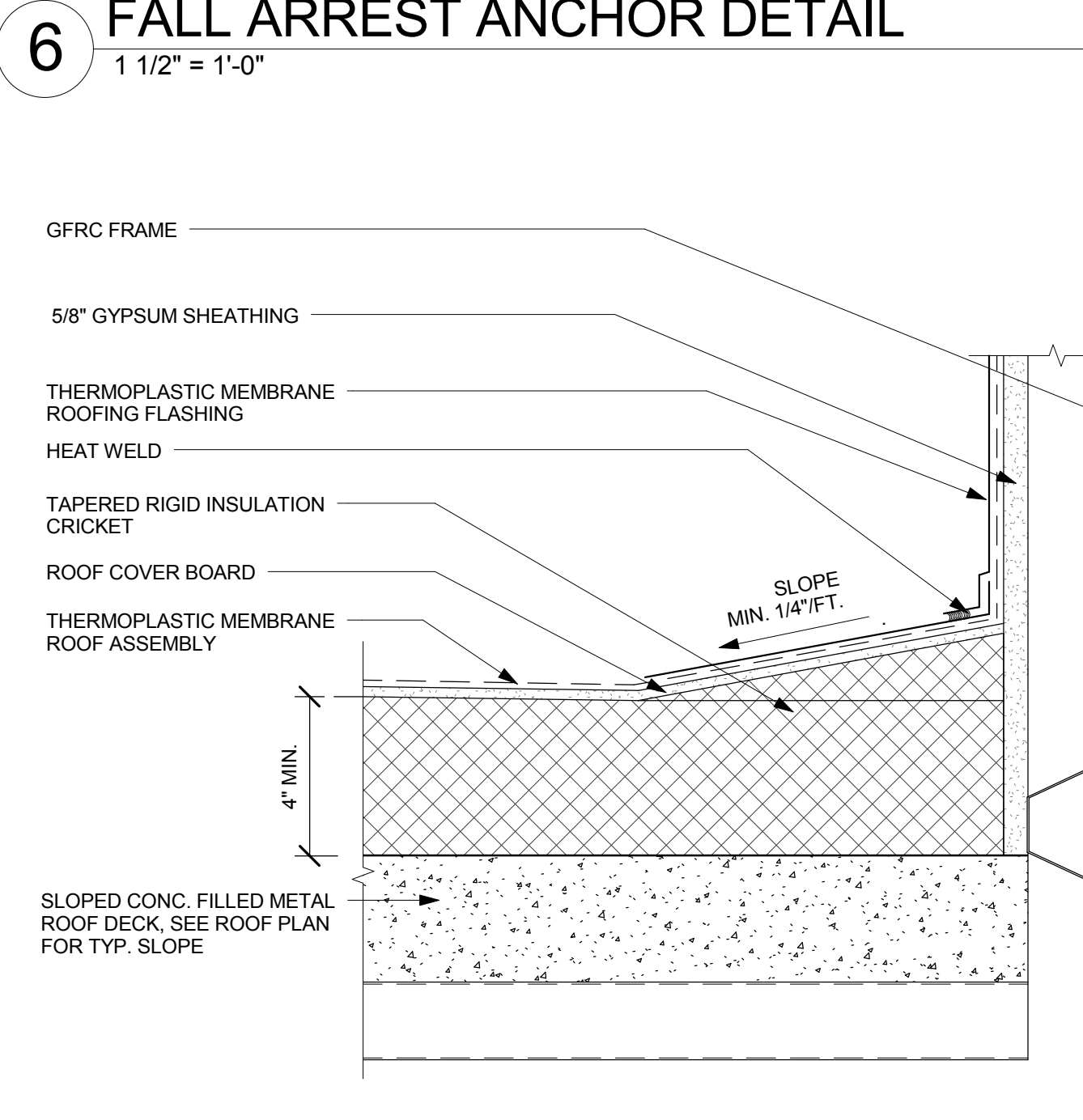
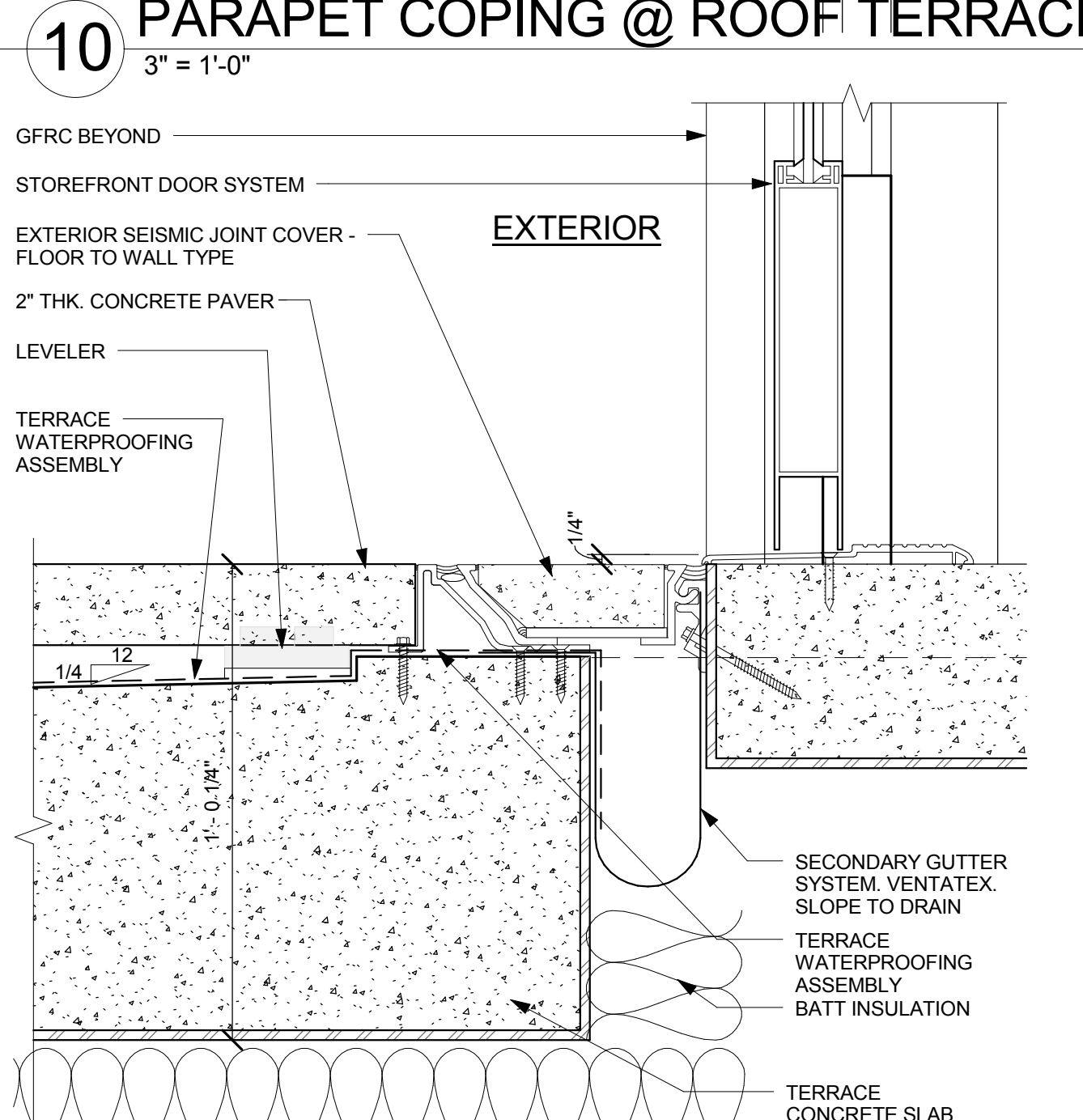

5 TYP. CRICKET AT ROOF FLOOR
3" = 1'-0"

1 TYP. ROOF/OVERFLOW DRAIN PAN
N.T.S.

NO. ISSUES/REVISIONS DATE

PROJECT RECORD SET

BUILDING 4
SKYLINE COLLEGE

SAN MATEO COUNTY
COMMUNITY COLLEGE
DISTRICT

CIP2 DESIGN-BUILD
PROJECT
BUILDING 4

PROJECT NO.: 07012.00
DATE: 07/15/08
SCALE: As indicated

SHEET TITLE:
**ROOF/EXTERIOR
DETAILS**

SHEET NO. A-801

All drawings and written material appearing herein constitute original and unpublished work of the Architect/Engineer and may not be duplicated, used or disclosed without consent of Architect/Engineer.

If this drawing is not 30"x42", then the drawing has been revised from its original size. Note: scales must be adjusted. This line should be equal to one inch.