

FOR FASTENER SCHEDULE, SEE "S3" SHEETS

2 SECTION - COLUMN @ CORNER  
SCALE: 3/4"=1'-0"

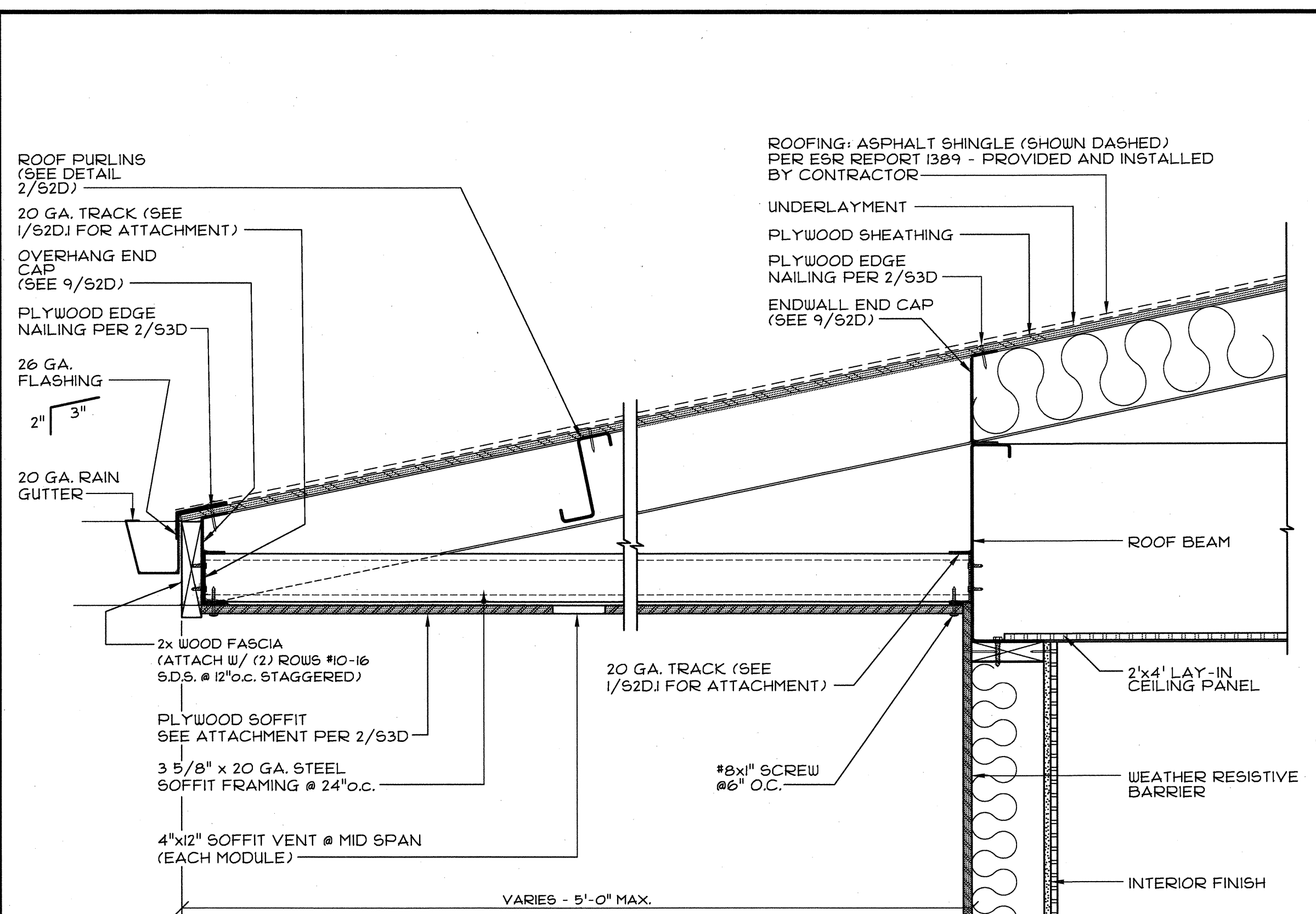

FOR FASTENER SCHEDULE, SEE "S3" SHEETS

7 SECTION - FRONT OVERHANG  
SCALE: 1 1/2"=1'-0"

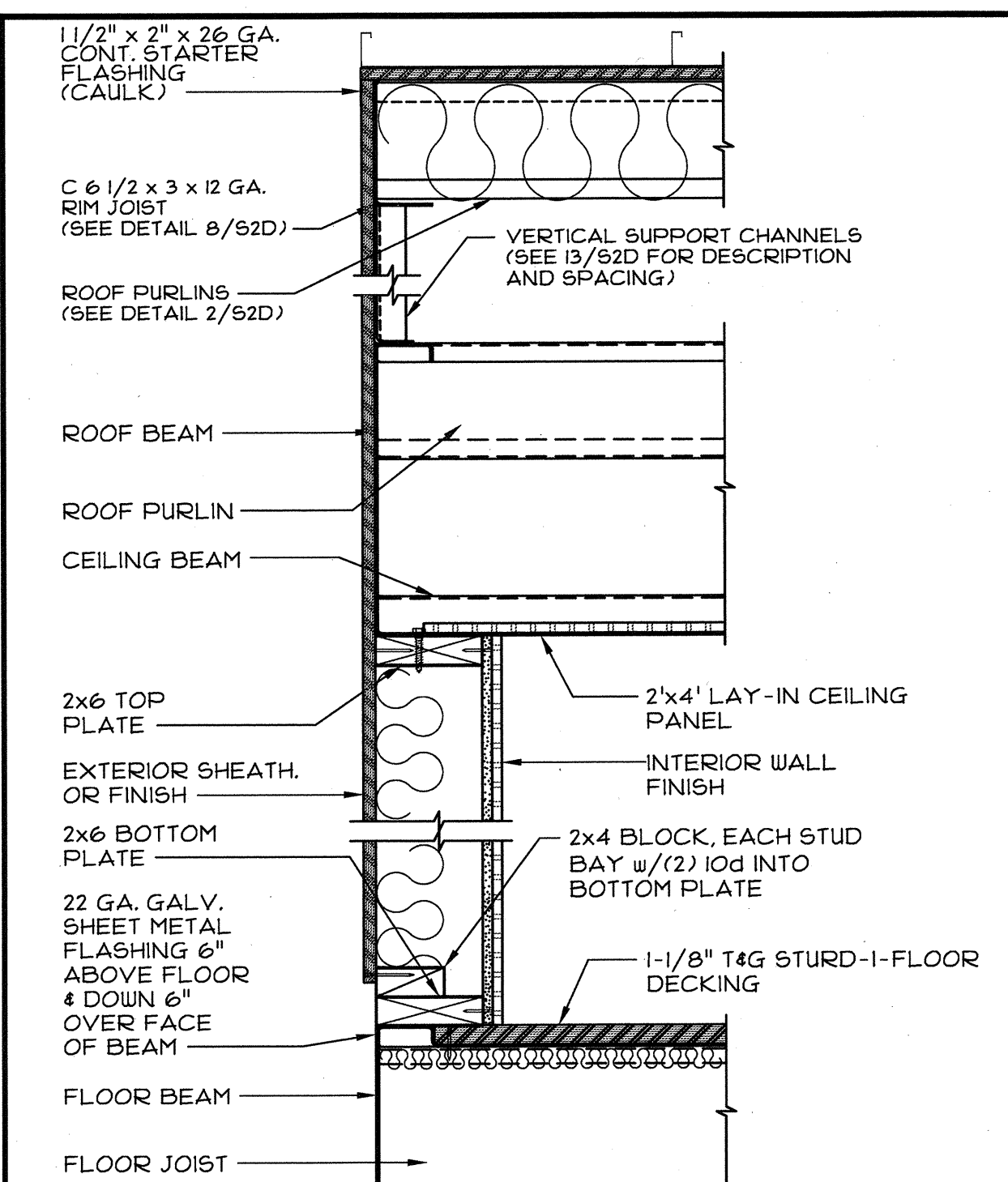

9 SECTION - @ SIDEWALL  
SCALE: 1 1/2"=1'-0"

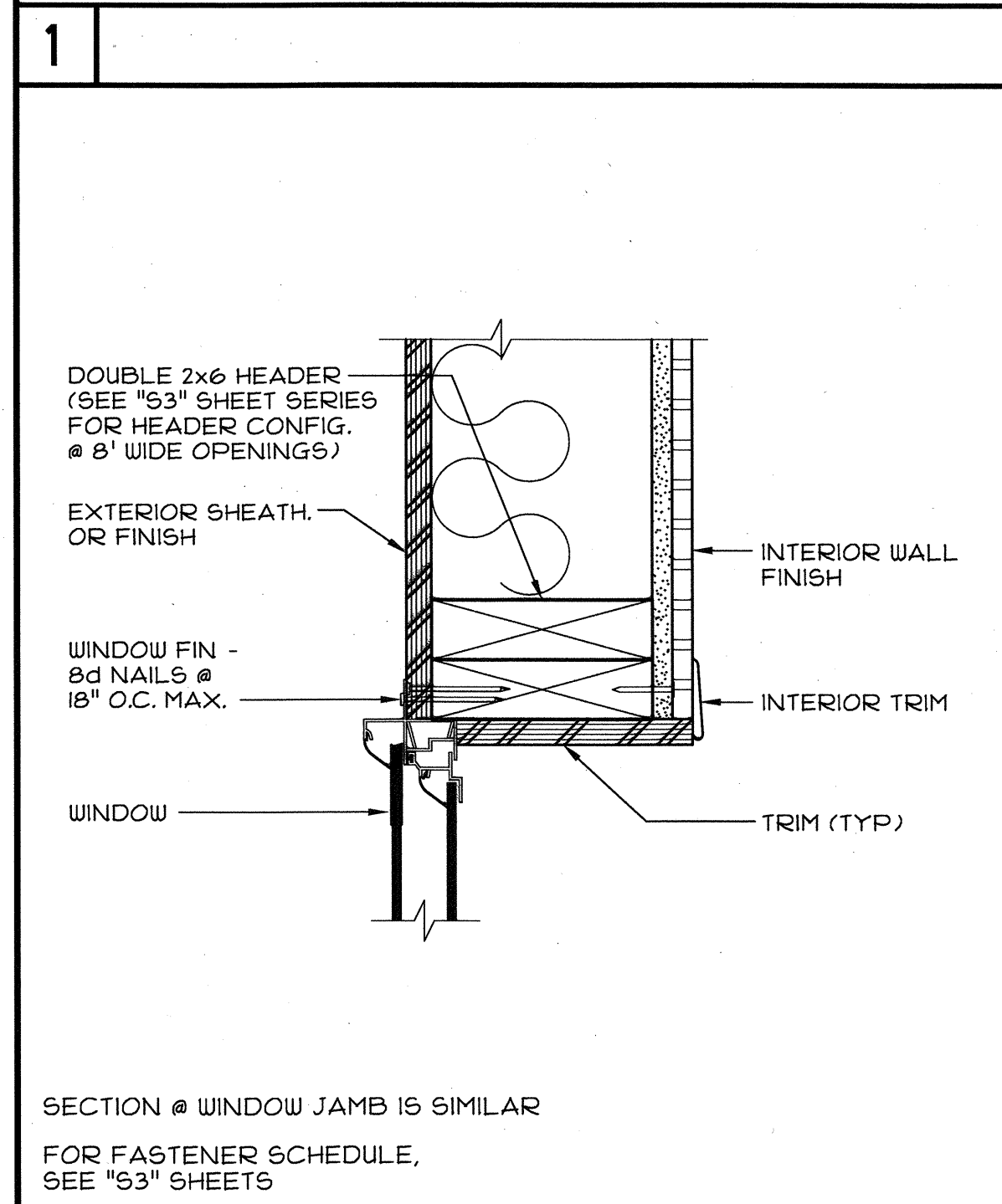

SECTION @ WINDOW JAMB IS SIMILAR  
FOR FASTENER SCHEDULE, SEE "S3" SHEETS

3 SECTION - WINDOW HEADER  
SCALE: 3/4"=1'-0"

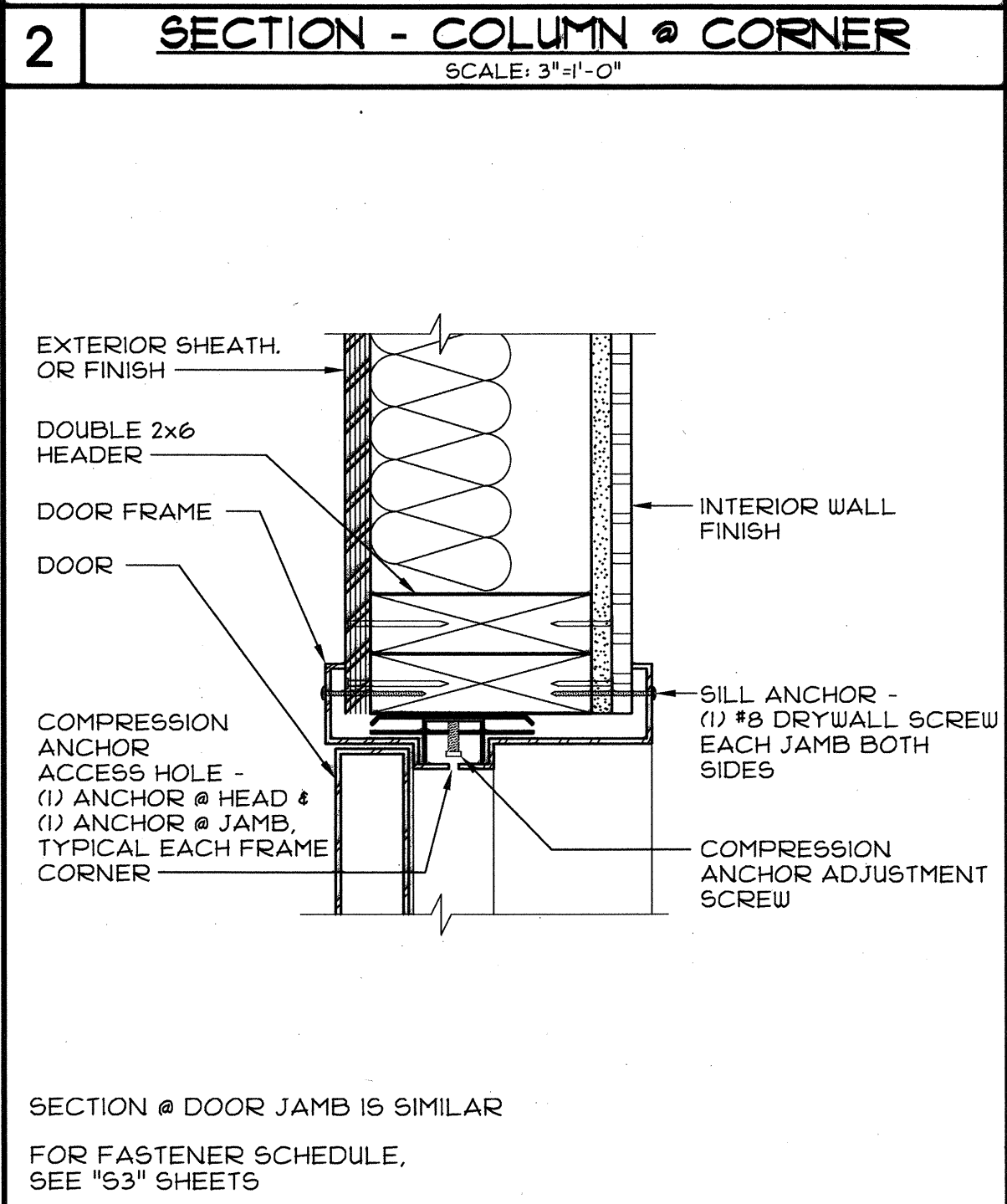

SECTION @ DOOR JAMB IS SIMILAR  
FOR FASTENER SCHEDULE, SEE "S3" SHEETS

4 SECTION - DOOR HEADER  
SCALE: 3/4"=1'-0"

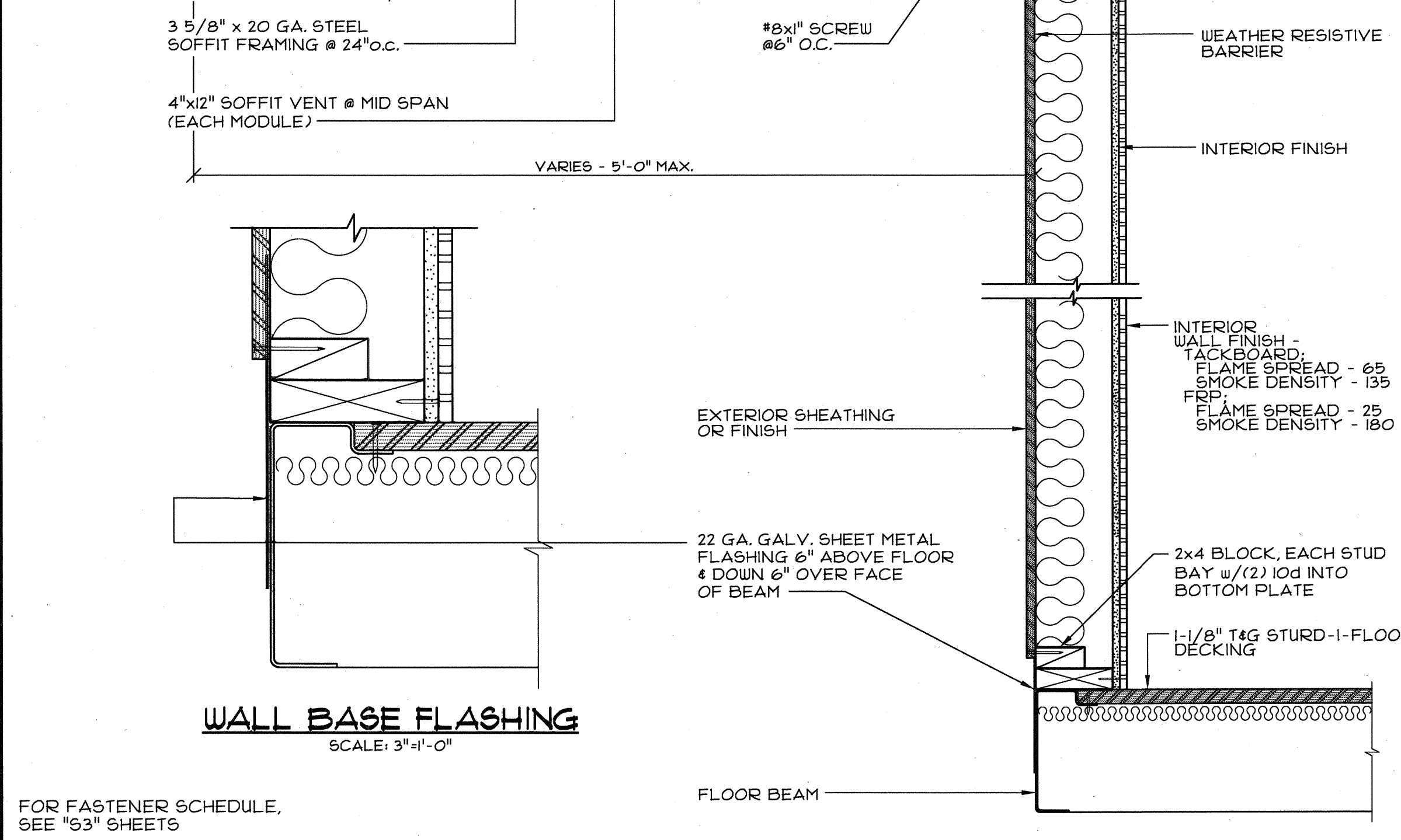

FOR FASTENER SCHEDULE, SEE "S3" SHEETS

7 SECTION - FRONT OVERHANG  
SCALE: 1 1/2"=1'-0"

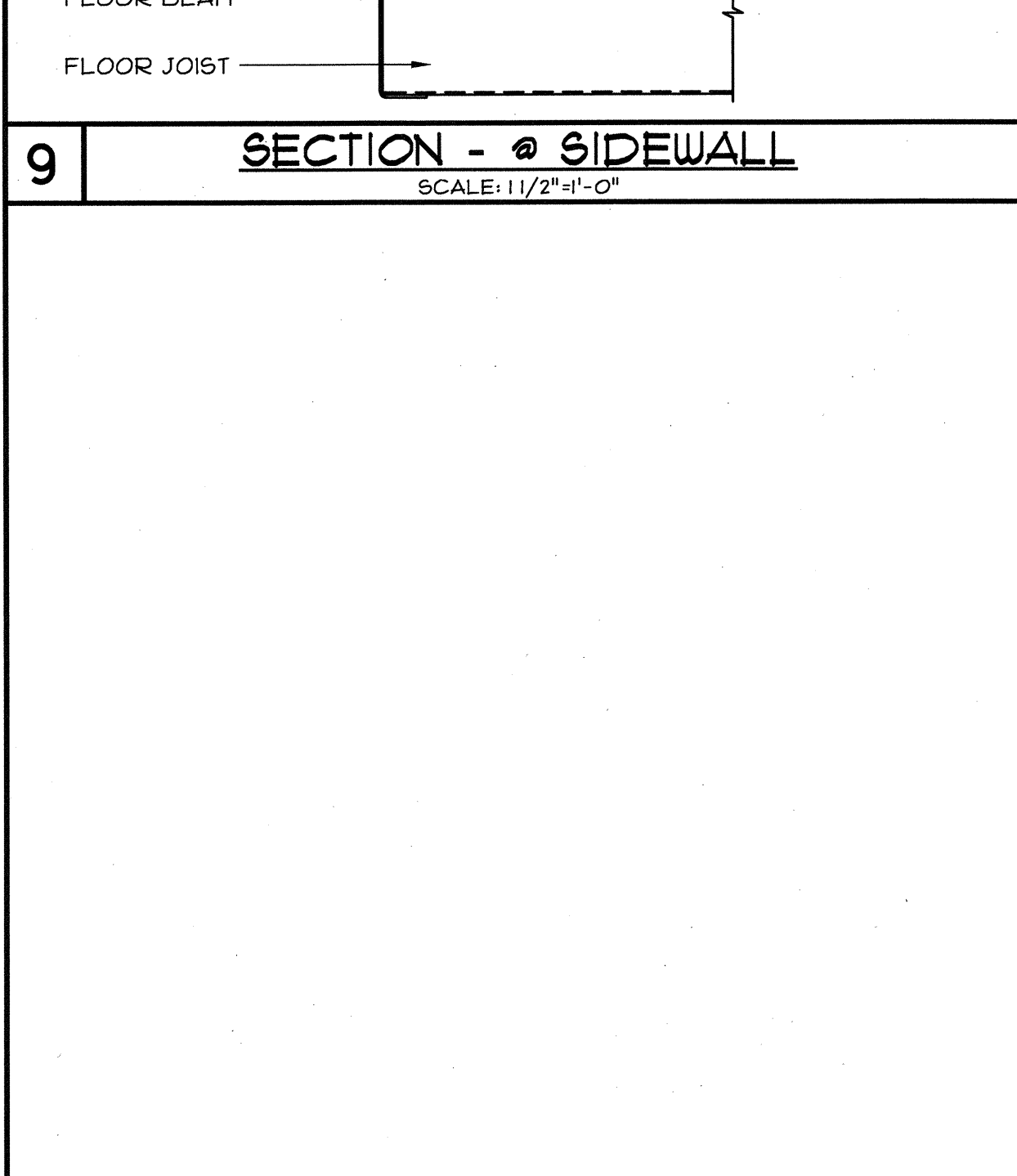

FOR FASTENER SCHEDULE, SEE "S3" SHEETS

7 SECTION - FRONT OVERHANG  
SCALE: 1 1/2"=1'-0"

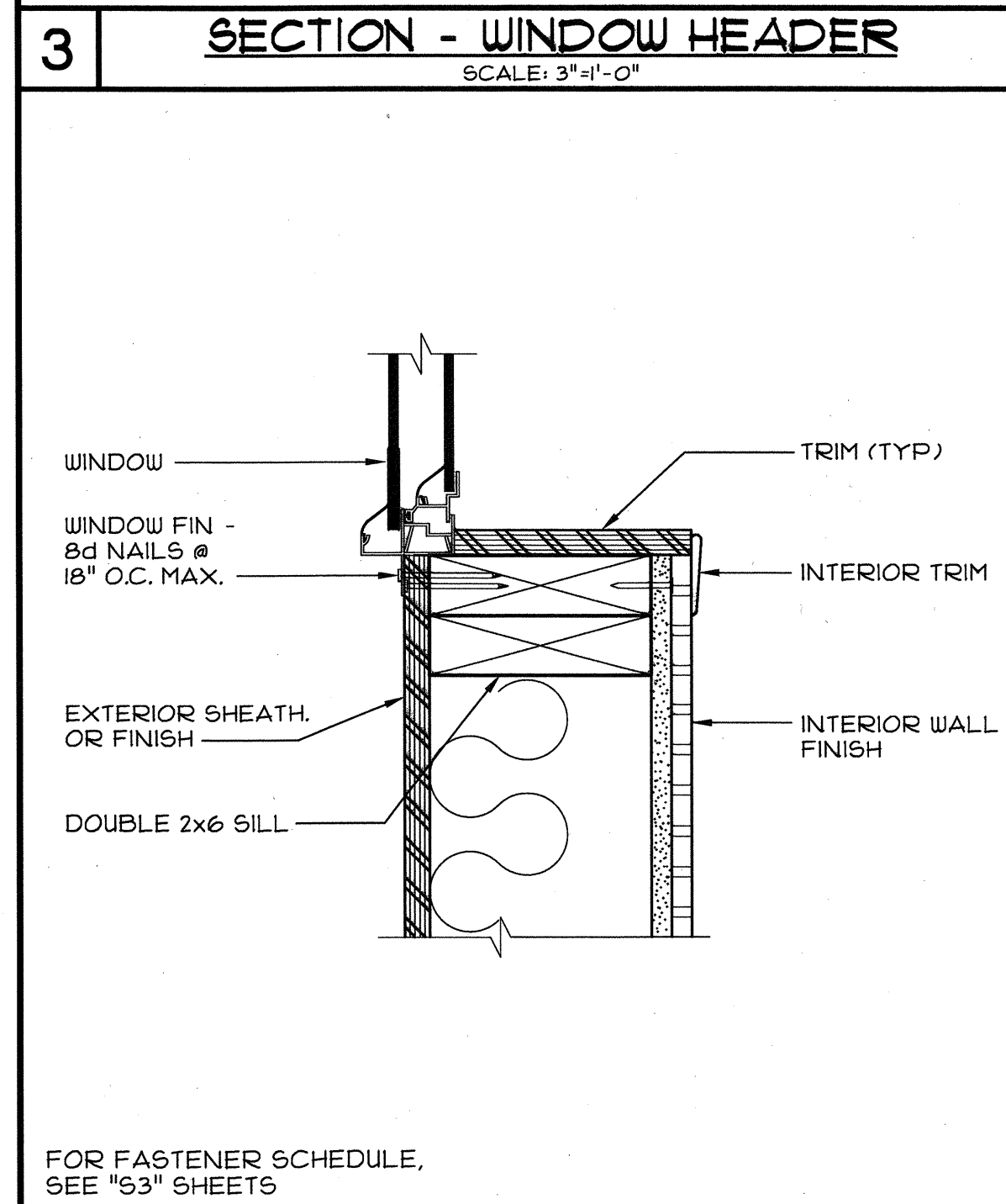

FOR FASTENER SCHEDULE, SEE "S3" SHEETS

5 SECTION - WINDOW SILL  
SCALE: 3/4"=1'-0"

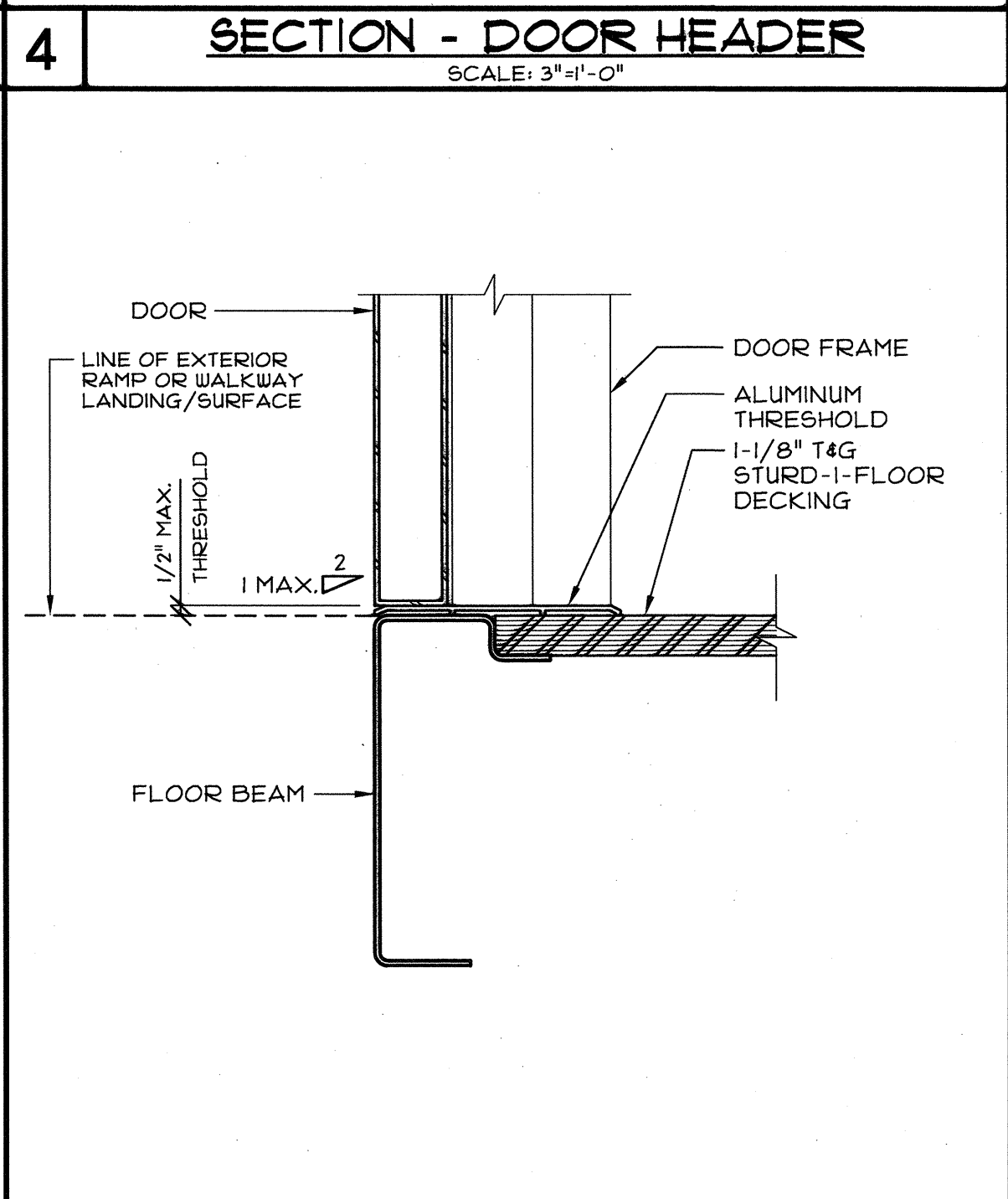

6 SECTION - DOOR THRESHOLD  
SCALE: 3/4"=1'-0"

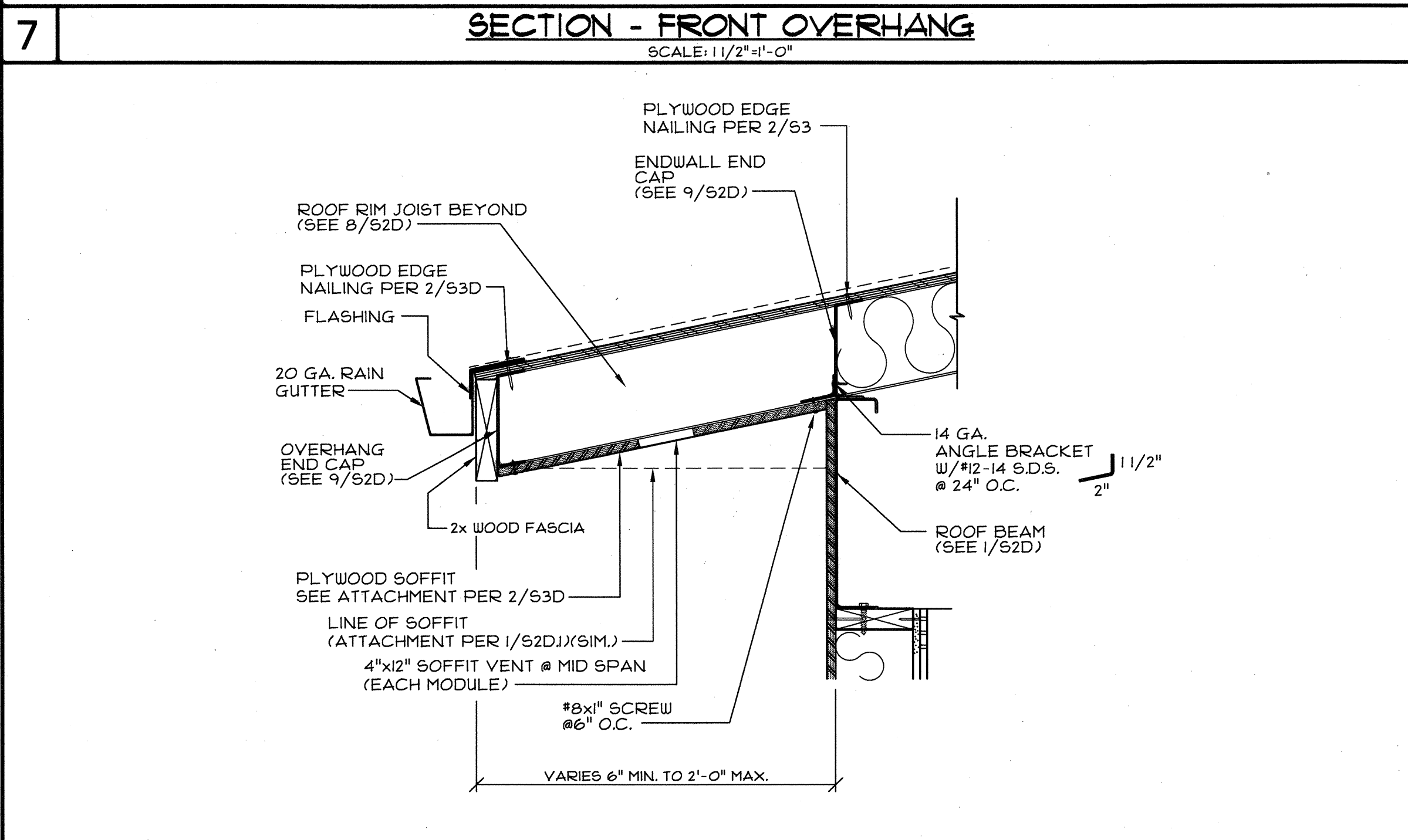

FOR FASTENER SCHEDULE, SEE "S3" SHEETS

8 SECTION - REAR OVERHANG  
SCALE: 1 1/2"=1'-0"

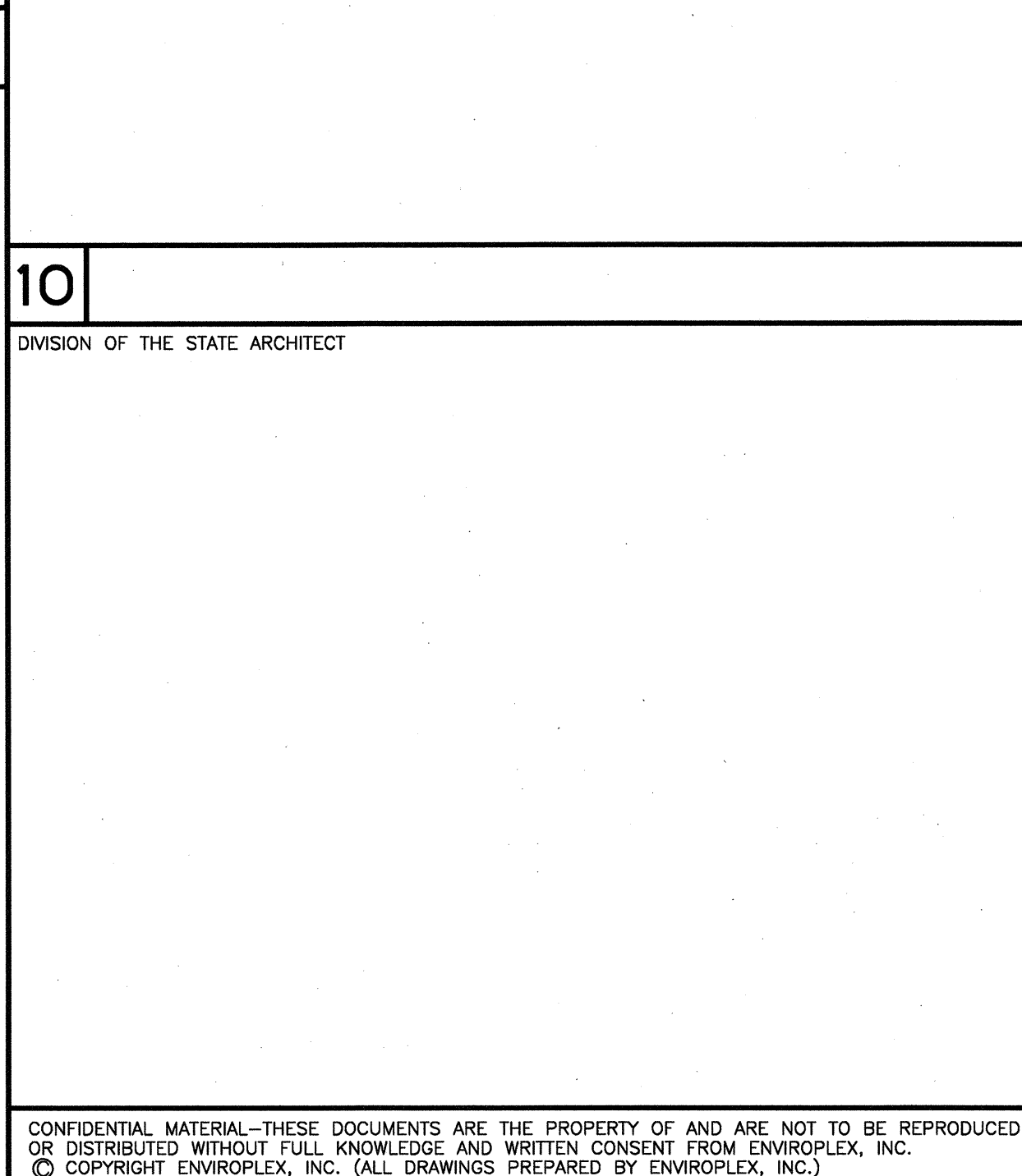

CONFIDENTIAL MATERIAL—THESE DOCUMENTS ARE THE PROPERTY OF AND ARE NOT TO BE REPRODUCED OR DISTRIBUTED WITHOUT FULL KNOWLEDGE AND WRITTEN CONSENT FROM ENVIROPLEX, INC. © COPYRIGHT ENVIROPLEX, INC. (ALL DRAWINGS PREPARED BY ENVIROPLEX, INC.)

APPROVALS

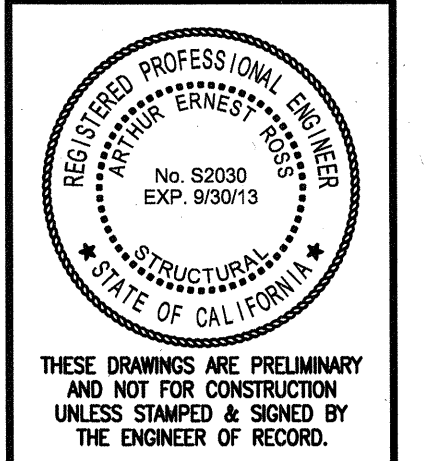
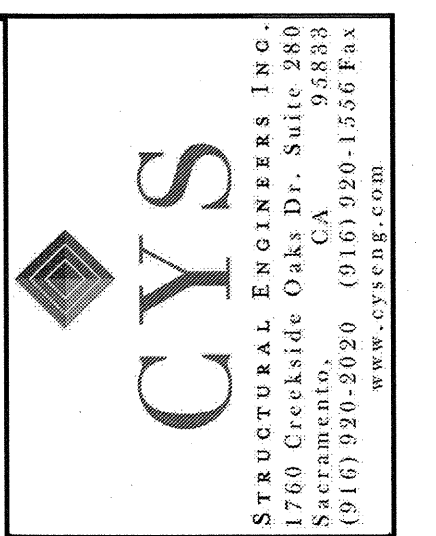

THESE DRAWINGS ARE PRELIMINARY AND NOT FOR CONSTRUCTION UNLESS STAMPED & SIGNED BY THE ENGINEER OF RECORD.

ENVIROPLEX, INC.  
4777 E. CARPENTER ROAD STOCKTON, CA. 95215, (209) 466-8000  
1) 12' x 40' RELOCATABLE RESTROOM BUILDINGS  
FOR CANADA COLLEGE  
SAI WILHELM COMMUNITY COLLEGE DISTRICT

VARIABLE PITCH ROOF SECTIONS AND DETAILS (2x6 EXTERIOR WALLS)

REV / DATE:	
JOB No.:	12-119
DRAWN BY:	JM
DATE:	07-18-12

THIS MODULAR BLDG. HAS BEEN ENGINEERED BY A REGISTERED STRUCTURAL ENGINEER AND PREVIOUSLY REVIEWED & APPROVED BY THE DIVISION OF THE STATE ARCHITECT, FIRE & LIFE SAFETY AND ACCESS COMPLIANCE SECTION

A4D