

SEE TO PERMIT PACKAGE #2 FOR CONTINUATION

REFLECTED CEILING PLAN

1/8"=1'-0" 0 2' 4' 8' 16' 24'

KEYED NOTES (DENOTED BY #)

1. (N) ACOUSTICAL SUSPENDED CEILING GRID AND PANELS. REFER TO SHEET A4.3.
2. (E) TRANSLUCENT PANELS TO REMAIN.
3. DENOTES (E) HARD-CAPPED CEILING TO REMAIN.
4. (N) GYP. BD. CEILING. USE 6" METAL JOISTS @ 6" O.C. WITH 5/8" TYPE 'X' GYP. BD. @ BOTTOM. TAPE, TEXTURE AND PREP TO PAINT.
5. (E) GYP. BD. CEILING W/ 4"X4" OR 12"X12" GLUED ON ACOUSTICAL TILES.
6. INSTALL (N) ACOUSTICAL TILES (GLUE-ON) WHERE MISSING OR DAMAGED. NEW TILES TO MATCH EXISTING TEXTURE, PATTERN AND COLOR.
7. (E) METAL RACEWAY TO REMAIN.
8. INSTALL (N) METAL RACEWAY MATCH EXISTING. PAINT TO MATCH WALL. REF TO DETAIL S/A4.4.
9. INSTALL (N) 2M FIRE STOP MATERIAL AROUND ALL PIPE/GONDUIT PENETRATIONS THROUGH FIRE RATED WALL.
10. (E) EXPOSED T&G WOOD ROOF DECK. REF. TO FINISH SCHEDULE FOR PAINTING REQUIREMENT.
11. (E) 1040 SURFACE-MTD. FLUORESCENT LIGHT FIXTURES. REF. TO ELEC. DWGS FOR REQUIREMENTS TO RE-LENS THE FIXTURES. (WHERE OCCURS)
12. PROVIDE AND INSTALL UNI-STRUT GRID SYSTEM HUNG FROM THE ROOF STRUCTURE. REFER TO STRUCTURAL DWGS 20/52.
13. DENOTES (E) WALL MOUNTED HVAC UNIT TO REMAIN.
14. DENOTES (E) EXPOSED GLU-LAM BEAMS TO REMAIN.
15. DENOTES THE LOCATION OF UNISTRUT THREADED RODS HUNG FROM (E) ROOF STRUCTURE. REFER TO STRUCTURAL DRAWINGS FOR REQUIREMENTS.
16. PROVIDE AND INSTALL (N) METAL CORRUGATED PANELS TO MATCH (E). INSTALL WHERE PANELS ARE MISSING.
17. (E) ACCESS HATCH TO REMAIN.
18. (N) 1040 SURFACE-MOUNTED LIGHT FIXTURES. REF. TO ELEC DWGS.
19. (E) PERFORATED METAL CEILING TILES AND GRID TO REMAIN (TYP)
20. (N) CURTAIN & TRACK REF TO 10/A4.1
21. INSTALL GYP. BD. CEILING & GLUE ON ACOUSTIC TILE FINISH TO MATCH (E) EXTEND (E) 2X4 @ 16" O.C. CLG JOISTS W/ (N) 2X4'S LAPPED 32" O.C. SPIKE TO (E) W/ (2) @ 16" O.C. MARK ATTACH JOISTS TO (N) 2X4 DPM LEDGER AT WALL W/ SIMPSON U24 JOIST HANGERS. ATTACH LEDGER TO WALL W/ (2) #10 S.M.S. @ EA. MTL STUD OR W/ (2) # WOOD SCREWS @ EA. WOOD STUD. P.O. PROVIDE 2X4 NAILER AT ALL OTHER PERIMETER EDGES, ATTACHED TO WALL STUDS AS NOTED ABOVE.

GENERAL NOTES

1. ALL (N) T-BAR CEILINGS SHALL BE +8'-0" A.F.F. U.O.N.

LEGEND

- (E) 1X4' SURFACE-MTD FLUORESCENT LIGHT FIXTURE
- (N) 1X4' SURFACE-MTD FLUORESCENT LIGHT FIXTURE
- (N) 2X4' LAY-IN FLUORESCENT LIGHT FIXTURE
- (N) 2X4' LAY-IN FLUORESCENT EMERGENCY LIGHT FIXTURE
- (N) 2X4' ACOUSTICAL SUSPENDED CEILING
- (E) 2X4' ACOUSTICAL SUSPENDED CEILING TO REMAIN
- (N) 1-HR. FIRE RATED CEILING/CEILING ACCESS HATCH
- CEILING MOUNTED MOTION SENSOR
- WALL MOUNTED MOTION SENSOR
- (N) EXIT SIGN
- SUPPLY DIFFUSER
- RETURN AIR GRILLE

KEY PLAN

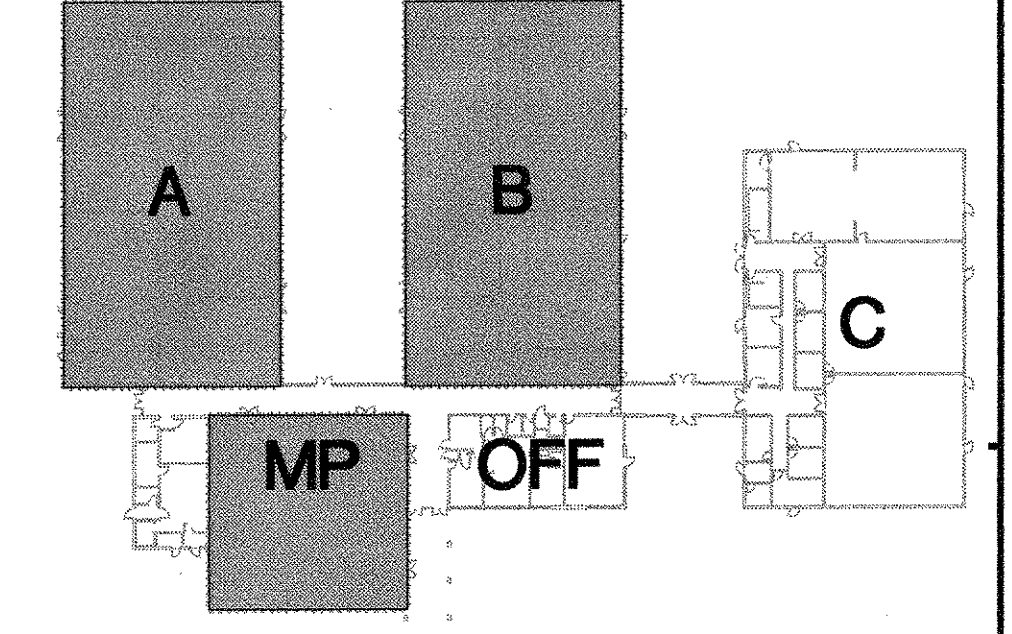

Sugimura & Associates Architects
 Architecture • Interiors
 Landscape Architecture
 2155 South Bascom Ave. Suite 200
 Campbell, CA 95008
 408-879-0600 Fx 408-377-8066
 COPYRIGHT © 2003 Sugimura & Associates Architects

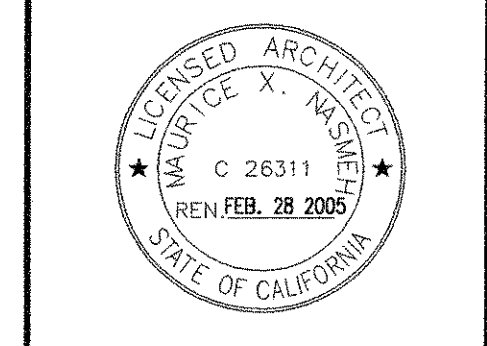

REGISTRATION STAMP
 OFFICE OF REGULATION SERVICES
 DIVISION OF THE STATE ARCHITECT
 Regional Office
 1301
 Oakland, CA 94612

REFLECTED CEILING PLAN
PACIFIC HEIGHTS
 SKYLINE COLLEGE SWING SPACE
 PERMIT PACKAGE #3
 SKYLINE COLLEGE
 3300 COLLEGE DRIVE
 SAN BRUNO, CA 94066

REVISIONS

NO.	ITEM	DATE
1	DBA BACKCHECK	5/28/04
2	CONSTRUCTION ISSUE	6/10/04
3	CONFORM SET	9/1/04

G As-Built 3/1/05

CLIENT APPROVAL:
 DRAWN BY: KH
 CHECKED BY:
 JOB NO: 2145.002 DATE: 13 FEB 2004