

owner  
SAN MATEO COUNTY  
3401 CSM DRIVE  
SAN MATEO CA 94402

architect  
STEINBERG ARCHITECTS  
60 Pierce Avenue  
San Jose CA 95110

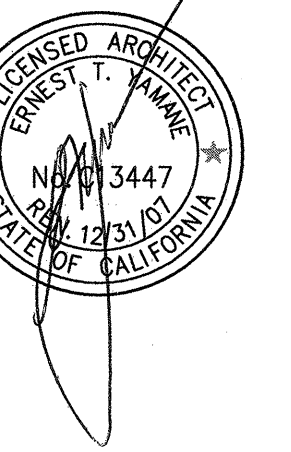

**GENERAL NOTES**

- A. CONTRACTOR SHALL FIELD VERIFY ALL EXISTING CONDITIONS. NOTIFY ARCHITECT IMMEDIATELY OF ANY DISCREPANCIES PRIOR TO CONSTRUCTION.
- B. SEE MECH. DWGS. FOR EXTENT OF MECH. WORK.
- C. SEE ELECT. DWGS. FOR EXTENT OF ELECT. WORK.
- D. SEAL ALL PIPE / DUCT PENETRATIONS THROUGH WALLS.

**KEYNOTES**

- 1. REMOVE ENTIRE (E) 2X4 SUSPENDED ACOUSTICAL TILE CEILING, INCLUDING TILES, GRID, LIGHT FIXTURES, HVAC DIFFUSERS.
- 2. SALVAGE ALL SUSPENDED LIGHT FIXTURES TO OWNER.
- 3. (E) 2X4 SUSPENDED ACOUSTICAL TILE CEILING, INCLUDING TILES, GRID, LIGHT FIXTURES, HVAC DIFFUSERS, EXIT LIGHTS, TO REMAIN.
- 4. (E) EXPOSED CONC. "WAFFLE SLAB", INCLUDING LIGHT FIXTURES AND ACOUSTICAL PANELS TO REMAIN.
- 5. REMOVE (E) PROJECTOR AND REINSTALL PER NEW LAYOUT, SEE SHEET -----.
- 6. REMOVE (E) SCREEN, SPEAKERS AND REINSTALL PER NEW LAYOUT, SEE SHEET -----.

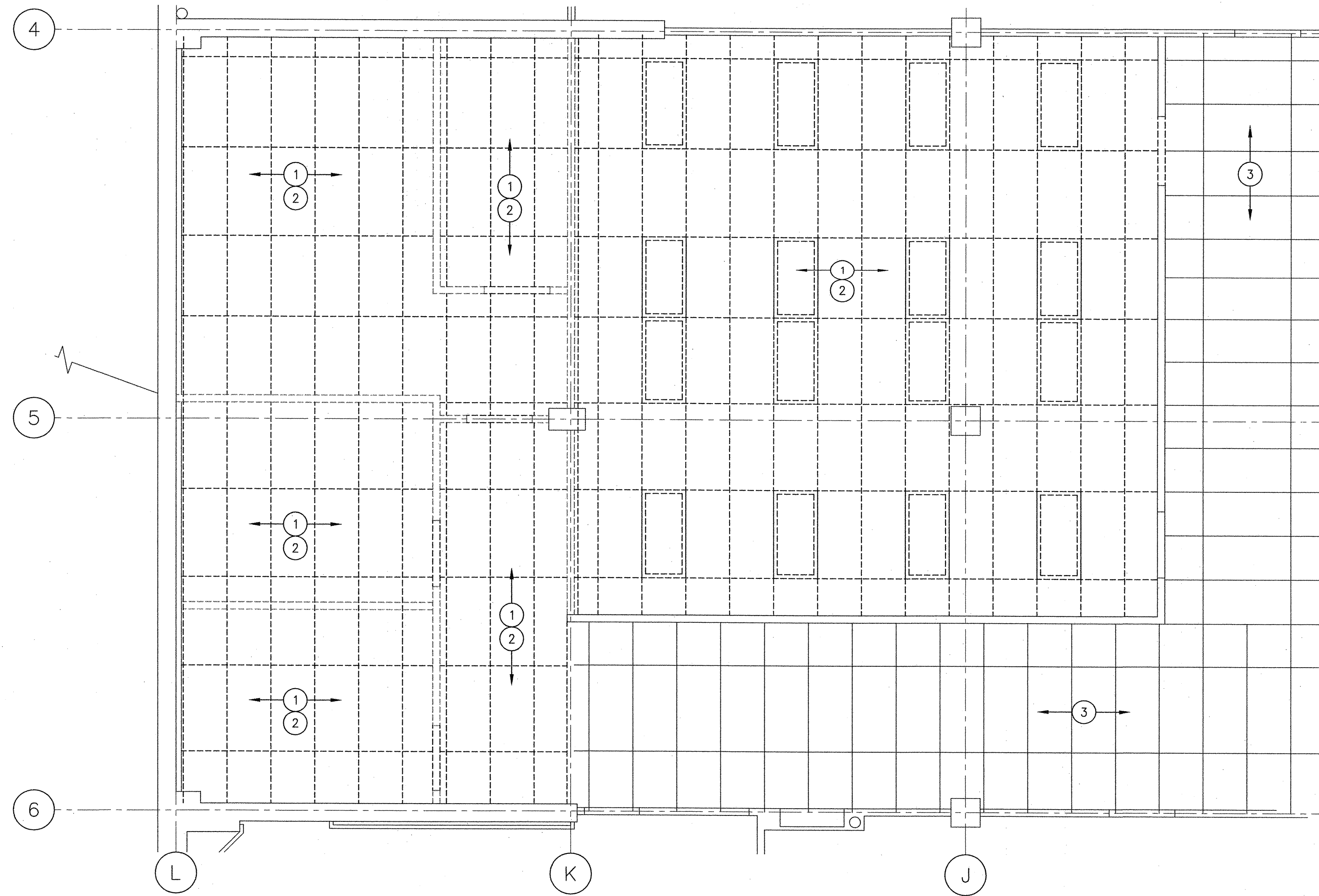

1 ROOM 2111 REFLECTED CEILING DEMO PLAN  
1/4" = 1'-0"

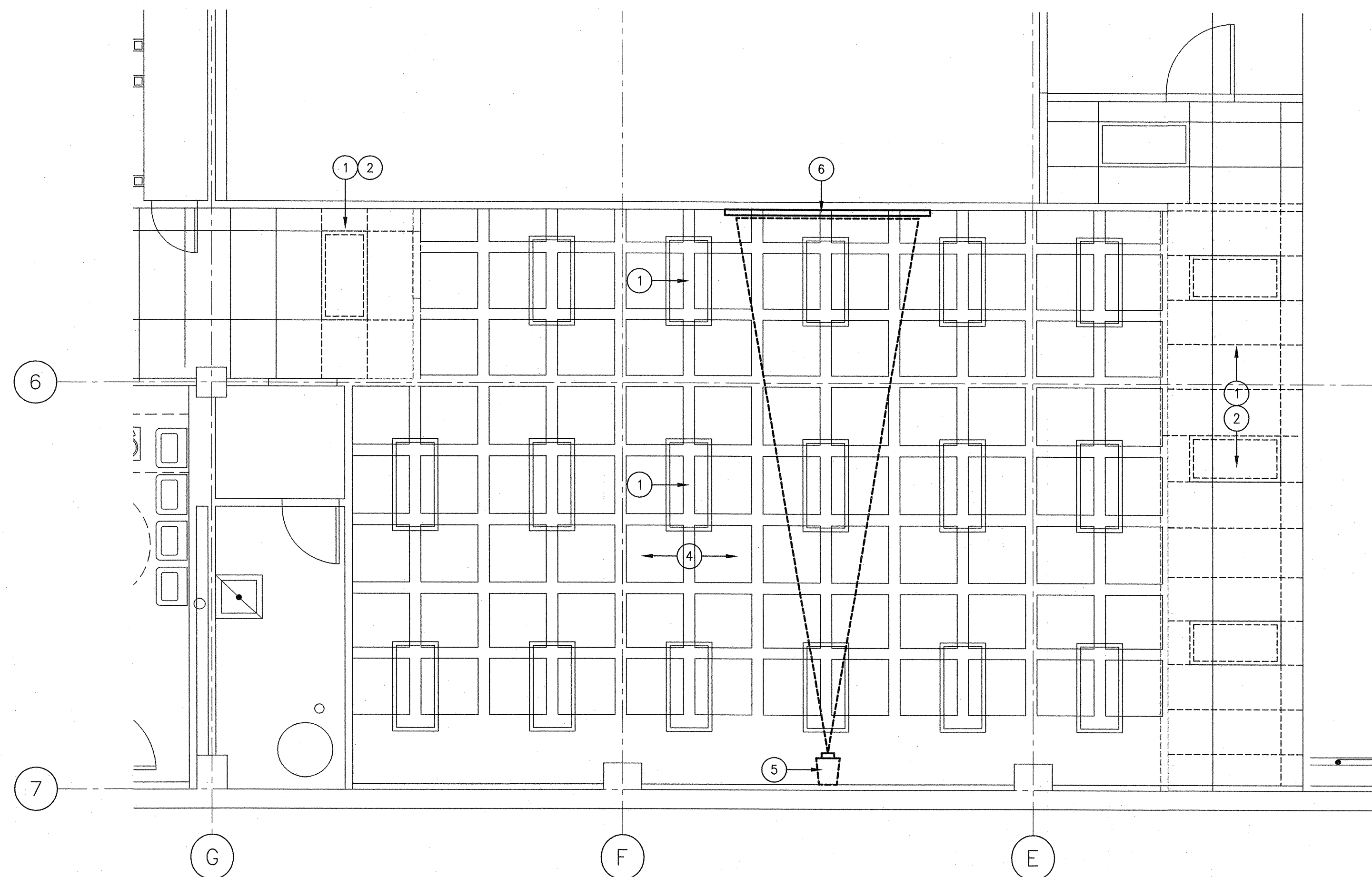

2 ROOM 2108 REFLECTED CEILING DEMO PLAN  
1/4" = 1'-0"

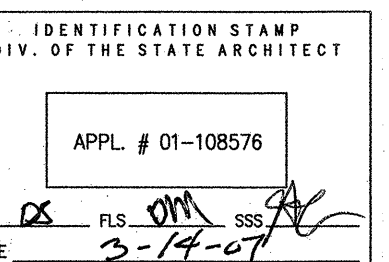

02.02.07 DSA SUBMITTAL  
03.14.07 DSA BACKCHECK

rev. date issue

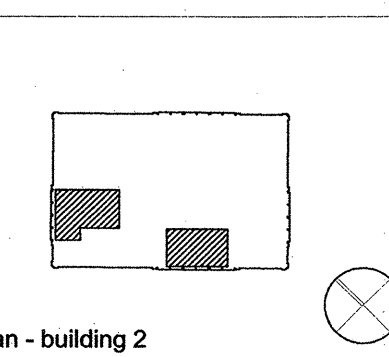

**STEINBERG ARCHITECTS**

project no: 06044 date: 02-02-07  
drawn by: JC checked by: RS  
scale: 1/4" = 1'-0"

REFLECTED CEILING  
DEMOLITION PLANS  
**A4.01**

Copyright © Steinberg Architects, Inc. All rights reserved. This drawing is the property of Steinberg Architects, Inc. and may not be reproduced, stored in a retrieval system, or transmitted in any form or by any means, electronic, mechanical, photocopying, recording, or by any information storage and retrieval system, without the express written consent of Steinberg Architects, Inc.

P:\2007\06-04\_MultiMedia\06-04\_TCOM\06-04\_TCOM.dwg  
P:\2007\06-04\_MultiMedia\06-04\_TCOM\06-04\_TCOM.dwg  
P:\2007\06-04\_MultiMedia\06-04\_TCOM\06-04\_TCOM.dwg