

DOOR SCHEDULE													
NO	SIZE	THK	MTL	TYPE	CONST	FRM	DETAILS			HOW GRP	DR FIN	FRM FIN	REMARKS
							HEAD	JAMB	SILL				
21	32 x 78	1 3/4"	WD	B	S.C.	HM	10/A19	14/A19	13/A19	7	PAINT	PAINT	1" CUT @ BOTTOM; HANDICAP SIGN @ 60"
22	32 x 78	1 3/4"	WD	B	S.C.	HM	11/A19	10/A19	9/A19	8	PAINT	PAINT	1" CUT @ BOTTOM; MEN RESTRM SIGN +60
23	32 x 78	1 3/4"	WD	B	S.C.	HM	11/A19	10/A19	9/A19	8	PAINT	PAINT	1" CUT @ BOTTOM; WOMEN RESTRM SIGN +60

INTERIOR MATERIAL and FINISH SCHEDULE											
ROOM NAME	FLOOR		BASE		WALLS		CEILING		TRIM		REMARKS
	MTL	FIN	MTL	FIN	MTL	FIN	MTL	FIN	MTL	FIN	
VESTIBULE	CT.	-	C.T.	-	GWB*	PAINT	GWB	PAINT	-	-	* EXPOSED STEEL PAINT
MEN TOILETRM.	CT.	-	C.T.	-	CT/GWB	PAINT	GWB	PAINT	-	-	
WOMEN TOILETRM.	CT.	-	C.T.	-	CT/GWB	PAINT	GWB	PAINT	-	-	

OS.A - STRUCTURAL SAFETY SECT.

OS.A - ACCESS COMPLIANCE SECT.

53721 DEC 14 '90

APPLICATOR PER M. JIM BOYER

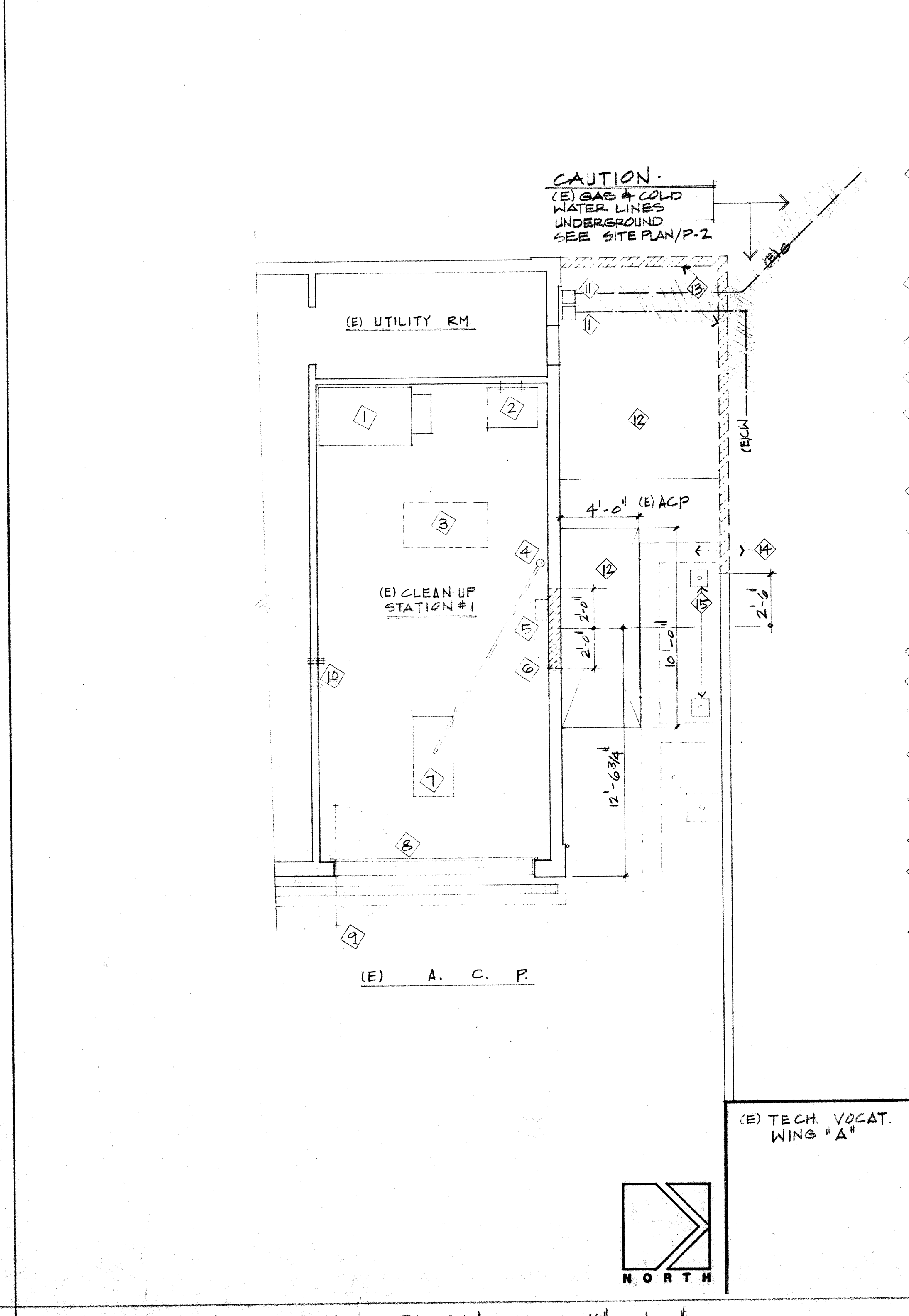
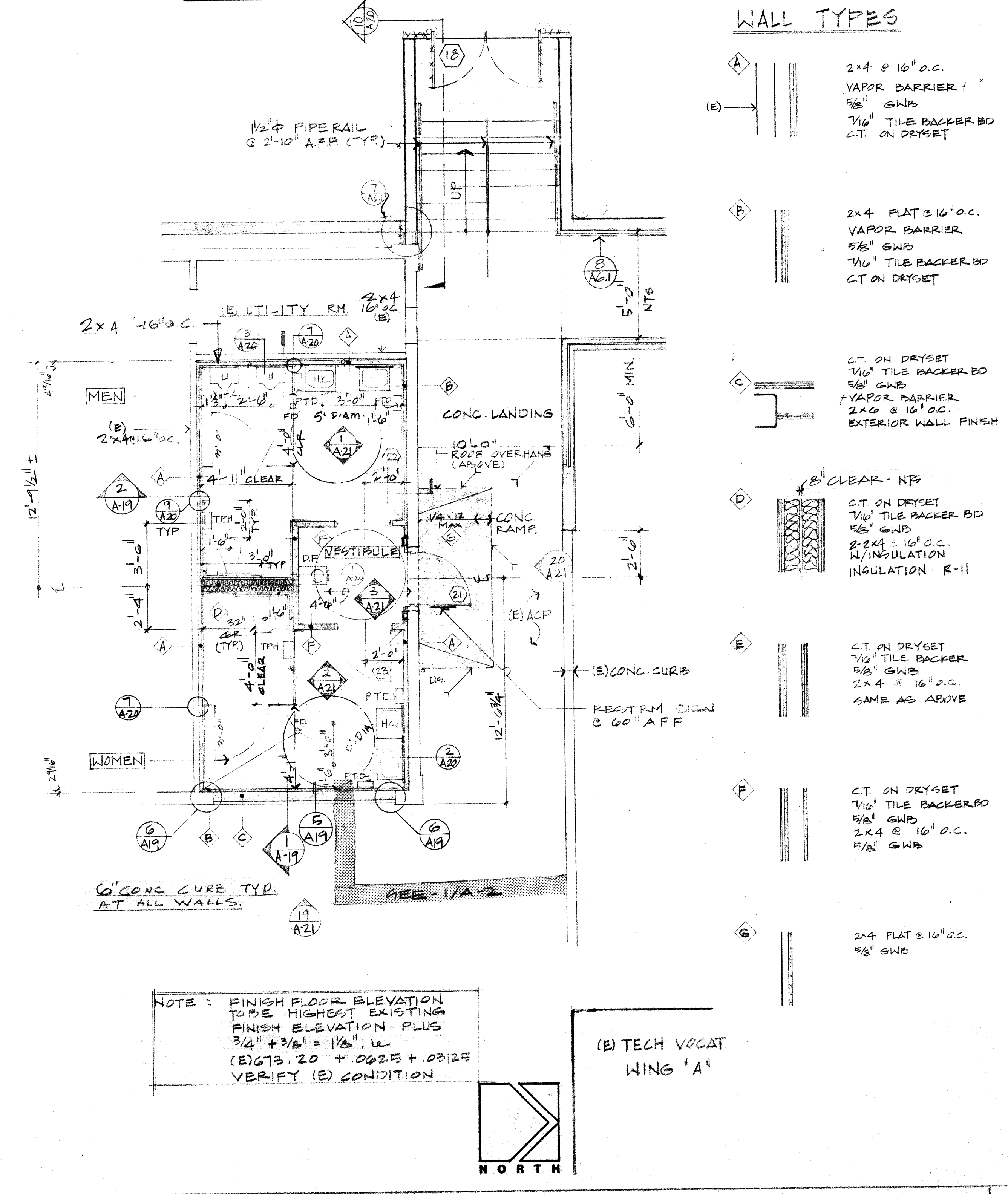

- WALL TYPES**
- (A) 2x4 @ 16" O.C. VAPOR BARRIER 5/8" GWB 7/16" TILE BACKER BD C.T. ON DRYSET
 - (B) 2x4 FLAT @ 16" O.C. VAPOR BARRIER 5/8" GWB 7/16" TILE BACKER BD C.T. ON DRYSET
 - (C) C.T. ON DRYSET 7/16" TILE BACKER BD 5/8" GWB VAPOR BARRIER 2x4 @ 16" O.C. EXTERIOR WALL FINISH
 - (D) 8" CLEAR - NF C.T. ON DRYSET 7/16" TILE BACKER BD 5/8" GWB 2x4 @ 16" O.C. R/INSULATION INSULATION R-11
 - (E) C.T. ON DRYSET 7/16" TILE BACKER 5/8" GWB 2x4 @ 16" O.C. SAME AS ABOVE
 - (F) C.T. ON DRYSET 7/16" TILE BACKER BD 5/8" GWB 2x4 @ 16" O.C. 7/8" GWB
 - (G) 2x4 FLAT @ 16" O.C. 5/8" GWB

- SHEET NOTES:**
- 1 REMOVE & RELOCATE (E) AGITATING HOT TANK TO NEW CLEAN UP AREA SEE FLOOR PLAN FOR NEW LOCATION (TYP FOR ALL REMOVE & RELOCATE ITEMS)
 - 2 REMOVE & RELOCATE (E) SINK TO NEW CLEANUP AREA
 - 3 REMOVE (E) HEATER (ABOVE)
 - 4 REMOVE & RELOCATE (E) BOOM TO NEW CLEAN UP AREA
 - 5 REMOVE & RELOCATE (E) DYNAMETER PUMP & ELECT CONNECTIONS TO NEW CLEANUP STATION SEE PLUMBING & ELECT DRAWINGS FOR DET. SAWCUT (E) CONG. WALL FOR NEW DOOR OPENING
 - 6 REMOVE (E) COVERS & GATE CAP PIPES & FILL (E) SAND & GRAVEL INTERCEPTOR W/ AGGREGATE SEE PLUMBING DRAWINGS FOR DETAILS. REMOVAL OF (E) SLUDGE IN INTERCEPTOR BY OWNER
 - 7 REMOVE (E) ROLL UP DOOR REMOVE (E) DOOR
 - 8 (E) HOT & COLD WATER PIPES TO REMAIN CAP (E) AIR PIPE.
 - 9 RAISE (E) VALVE BOX TO NEW FINISH GRADE
 - 10 REMOVE (E) ACP & BASE FOR CONG. RAMP & LANDING REMOVE (E) CONG CURB
 - 11 USE CAUTION - (E) CONG. TANK FOR STORAGE WATER BELOW.
 - 12 (E) STEEL PLATE FOR (E) CONG. TANK.

FLOOR PLAN - TOILET ROOMS 1/4" = 1'-0"

DEMOLITION FLOOR PLAN 1/4" = 1'-0"

KELLER AND DASEKING - ARCHITECTS
 WALTER L. KELLER A.I.A.
 WILLIAM H. DASEKING A.I.A.
 825 OAK GROVE AVENUE
 MENLO PARK, CA 94025 415/322-5386
 C-1334

AUTOMOTIVE CLASSROOM BUILDING
 TOILET ROOM RENOVATIONS
SKYLINE COLLEGE
 SAN MATEO COUNTY COMMUNITY COLLEGE DISTRICT

8906

7-12-90

A18

20 of 41