

SAN MATEO COUNTY
COMMUNITY
COLLEGE DISTRICT

FACILITIES PLANNING,
MAINTENANCE & OPERATIONS

Bond Oversight Committee CIP Project Update

DECEMBER 1, 2016



College of San Mateo



College of San Mateo Softball Field Turf Replacement

- Budget \$492,300
 - Redevelopment Funds; Fund 4 Unrestricted Funds
- Project Scope
 - Replacement of entire softball field synthetic turf
 - Refurbish pitchers mound and batters box
 - Replace Bull Dog logo
 - Install new concrete curb to retain clay at batting cages
- Schedule
 - Project completed July 18, 2016

College of San Mateo Softball Field Turf Replacement

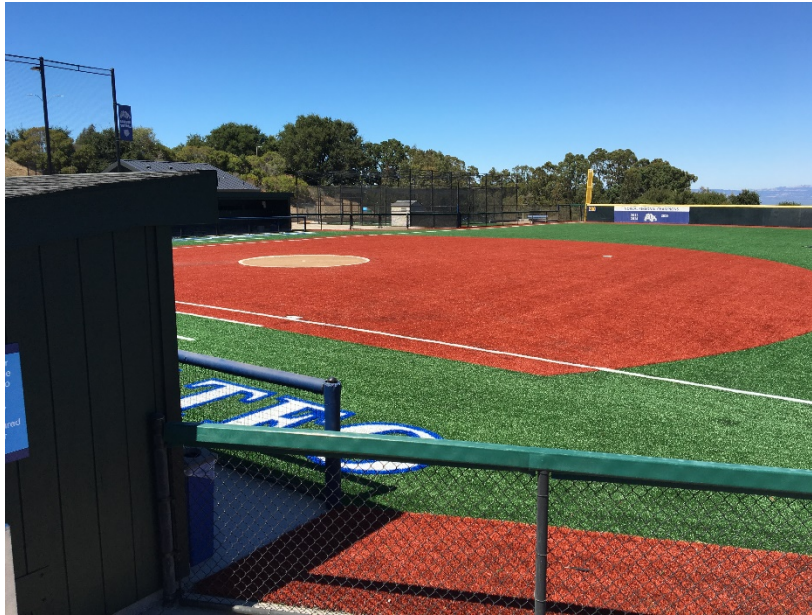

College of San Mateo Marie Curie Parking Lot Repairs

- Budget \$439,000
 - Measure A
- Project Scope
 - Resurfacing Marie Curie Parking Lot
 - Repairing tree planters from root growth
 - Installing infrastructure for Electric Vehicle charging stations
 - Restriping Socrates Parking Lot
 - Changing speed bumps to comply with City of San Mateo fire department standards with cut outs for fire trucks
- Schedule
 - Project completed August 16, 2016

College of San Mateo Marie Curie Parking Lot Repairs



Districtwide Exterior Lighting Upgrade

- Budget \$3,000,000
 - Energy Efficiency Funds
 - Prop 39
 - PG&E Incentives
 - Measure H
- Project Scope
 - Design-Build project to upgrade 1,100 exterior fixtures and lighting controls at all three campuses.
- Schedule
 - All planned fixtures installed (with some additions on order)
 - Commissioning of lighting controls mostly completed 11/18/16 - few punchlist items outstanding
 - Final change order work completed 10/30/16 – District considering additional items for Astronomy

Districtwide Exterior Lighting Upgrade



Districtwide Utility Measurement & Verification Project



- Budget \$2,500,000
 - Measure A
- Project Scope
 - Design-Build project to provide an energy measurement and verification and management system, including replacing all outdated building management system controllers and software system, and adding utility meters to most buildings throughout the District, and adding an Energy Information System to monitor energy usage.
- Schedule
 - Building Management System commissioning completion: 12/30/16
 - Energy Information System commissioning completion: 12/30/16
 - Analytics System software completion and customization: 3/30/17

Districtwide Fire Alarm Panels Replacement Project

- Budget \$3,500,000
 - Measure H
- Project Scope
 - Design-Bid-Build project to replace all existing Fire Alarm Panels with new updated panels at existing buildings across the District. The existing Siemens MXL panel products installed in 2006 have been discontinued and parts will no longer be available in the near future. All panels will be replaced with the newest Siemens XLS model. Updating the system will also ensure a full integration with the new buildings being constructed in CIP3.
- Schedule
 - Design start: November 2016
 - Design completion and submittal to DSA: Q1 2017
 - Construction start Q3 2017; Completion Q2 2018

Cañada College Kinesiology and Wellness Building (B1N)

- Budget \$88,000,000
 - Measure H
- Project Scope
 - Construct a New 84,500 GSF Wellness and Kinesiology Building (B1)
 - Elements of the Program: Separate enterprise and student locker and shower facilities, basketball gym, dance studios, entrance lobby, offices, outdoor competition and instructional swimming pools
- Status
 - Design Build Entity – Awarded to Blach/ELS by Board of Trustees September 14, 2016.
 - Schematic Design Phase started October 26, 2016.
- Schedule
 - Construction start in Q1 2018; Completion Q3 2019.

Cañada College Kinesiology and Wellness Building (B1N)



Cañada College Math and Science Building (B23N)

- Budget \$55,300,000
 - Measure H
- Project Scope
 - Construct a New 50,000 GSF Math and Science Building (B23)
 - Elements of the Program: Classrooms, Science Laboratories and Lab Prep Spaces, Large and Medium Lecture Halls, Offices
- Status
 - Programming complete
 - DBE RFP responses from short-listed teams under review, interviews conducted November 29, 2016
 - Contract award by Board of Trustees anticipated in January 2017
- Schedule
 - Construction start in Q3 2018; Completion Q1 2020

Cañada College Math and Science Building (B23N)

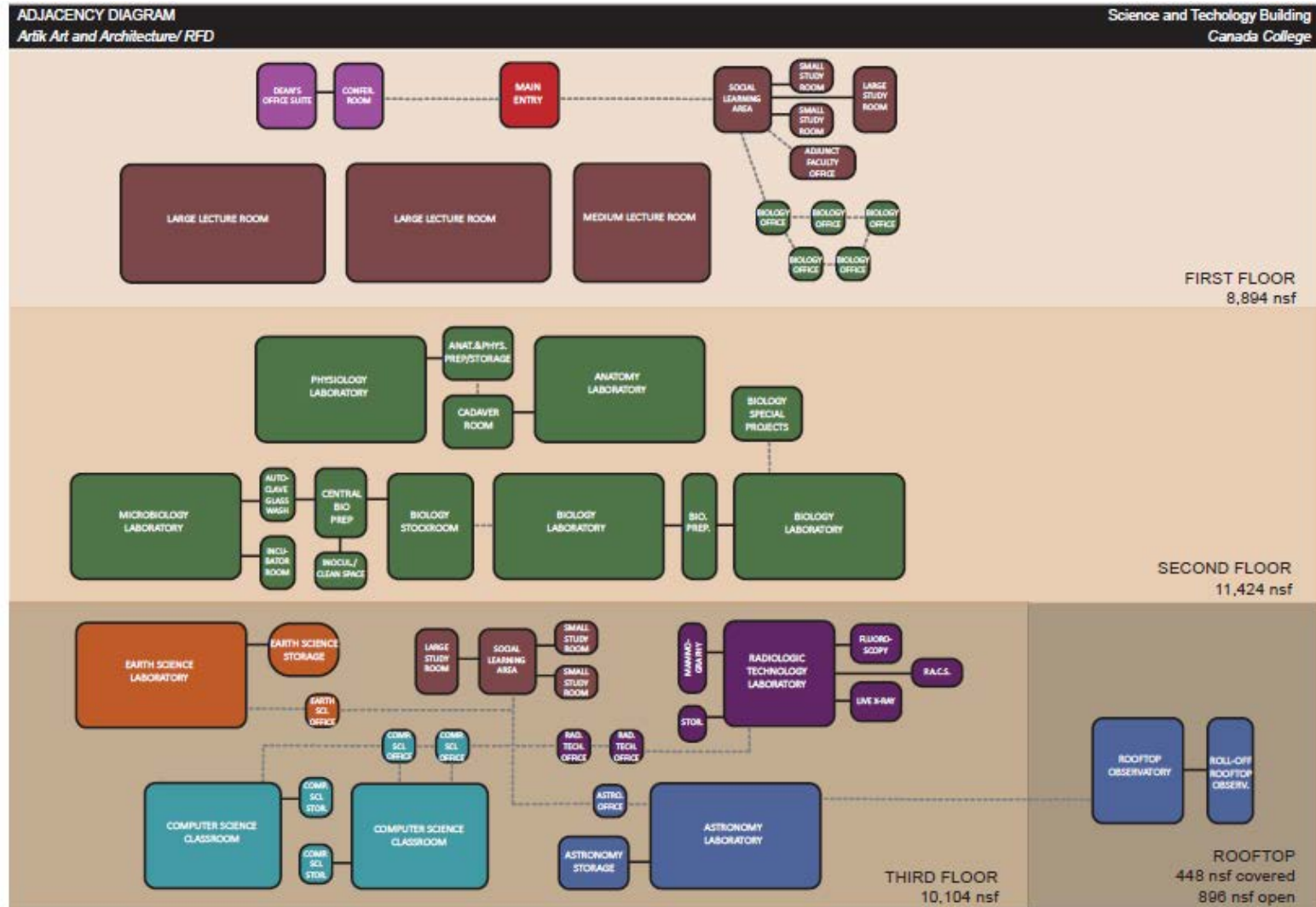

College of San Mateo Theatre Modernization (B3)

- Budget \$12,200,000
 - Measure H
- Project Scope
 - Interior modernization of building, focused on replacing aging mechanical, electrical and plumbing building infrastructure of existing Building (B3) 28,000 GSF
 - Modernize areas and features as required to provide ADA access to the building, including the lower stage, seating and back of stage areas
 - Modernize interior areas of the building, including dressing rooms, restrooms, rehearsal and back of stage rooms
 - Modernize Theatre audio/visual, acoustical and lighting systems as allowed by the budget
- Schedule
 - Design completion and submittal to DSA: Q4 2016
 - Construction start Q4 2017; Completion Q4 2018

College of San Mateo Theatre Modernization (B3)

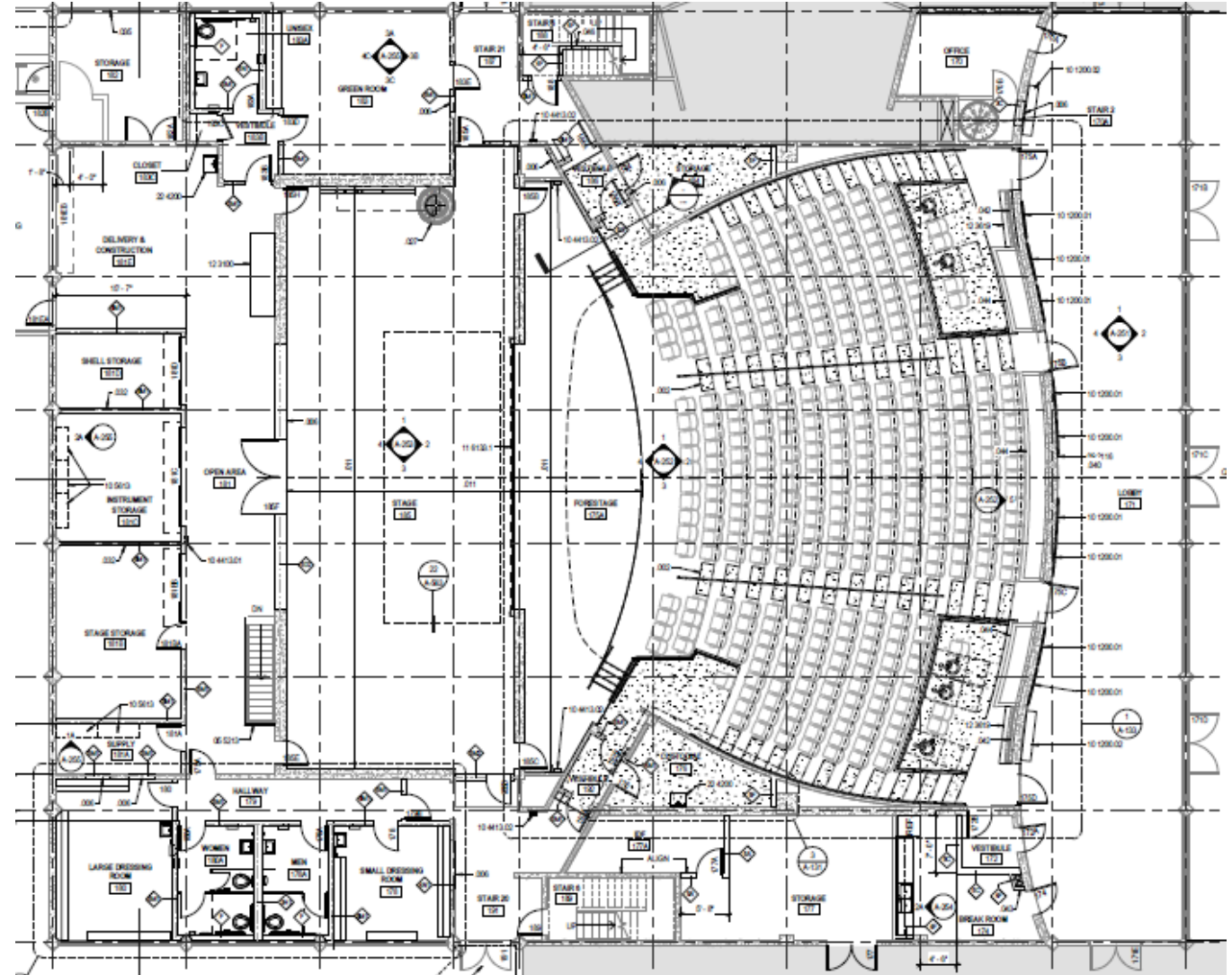

College of San Mateo Student Life & Learning Communities Modernization (B17)

- Budget \$4,000,000
 - Measure H
 - State Special Maintenance and Special Repairs (SMSR)
- Project Scope
 - Project Budget was increased from \$3Mil to \$4Mil to add re-roofing the building to the project scope and to add budget for FF&E.
 - Interior modernization of building to create dynamic student support areas housing several Learning Communities adjacent with the existing Student Life and Student Government areas in existing Building (B17) 7,400 GSF
 - Demolish interior demising walls to remove current faculty offices and reconfigure areas for the new program
 - Provide mechanical, electrical and plumbing systems within new program spaces per District Design Standards and as supported by existing building infrastructure
 - Modernize building courtyard entryway to enliven the space and invite students into the building
- Schedule
 - Construction Documents submitted to Division of State Architect (DSA) August 23, 2016
 - Construction start Q2 2017; Completion Q2 2018

College of San Mateo Student Life & Learning Communities Modernization (B17)



College of San Mateo Engineering & Technology (B19N)

- Budget \$60,000,000
 - Measure H
- Project Scope
 - Demolition of (E) Engineering & Technology Building (B19) and (E) Fire Technology Building (B12)
 - Construct a New 53,232 GSF Engineering & Technology Building (B19N)
 - Elements of the Program: Classrooms, Offices, Labs, Emerging Technology Labs including Tech Shop spaces
 - Modernize Edison Lot/ Building 20 area (pending litigation clearance)
- Schedule
 - Construction and Completion TBD pending adjudication

College of San Mateo Engineering & Technology (B19N)



Skyline College Social Science and Creative Arts Building (B1N)

- Budget \$160,000,000
 - Measure H
- Project Scope
 - Demolition of (E) Social Science and Creative Arts Building (B1) 72,853 GSF (79,453 – 6,600)
 - Retain and Protect 6,600 GSF of Level One during demolition and construction
 - Construct a New ~115,000 GSF and renovate Social Science and Creative Arts Building (B1)
 - Elements of the Program: 520 Seat New Theater w/Orchestra Pit, Scene Shop, Gallery, Music Choral Room/Recital Hall, Concert Band Room, Labs (Piano and MDI), Recording Rooms, Sculpture, Digital Arts, Art History, 2D Design, Photography, Social Sciences, Quad (Plaza) Extension
- Status
 - DBE shortlist receiving RFP today December 5, 2016
 - Proposals due February 2017
 - Award March 2017
- Tentative Schedule
 - Construction start Q3 2018; Completion Q3 2020

Skyline College Social Science and Creative Arts Building (B1N)



Skyline College Environmental Studies Building (B12N)

- Budget \$28,700,000
 - Measure H
- Project Scope
 - Construct a New 21,060 GSF Environmental Studies Building (B12N)
 - Elements of the Program: (2) Flexible (Flat) 60 seat/each Classrooms, (2) Lecture (Tiered) 128 seat/each Classrooms, Event Space for 250 Occupants, Catering Kitchen, Entrance Lobby, Offices, Outdoor Lab, Connecting Corridor to Main Campus, Optimal Building Location (Panoramic View of Pacific Ocean)
- Status
 - Board of Trustees approved award of design-build contract to XL/DES on November 9, 2016
 - Program validation and schematic design in progress
- Tentative Schedule
 - Construction start Q3 2017; Complete Q3 2018

Skyline College Environmental Studies Building (B12N)



Skyline College Environmental Studies Building (B12N)

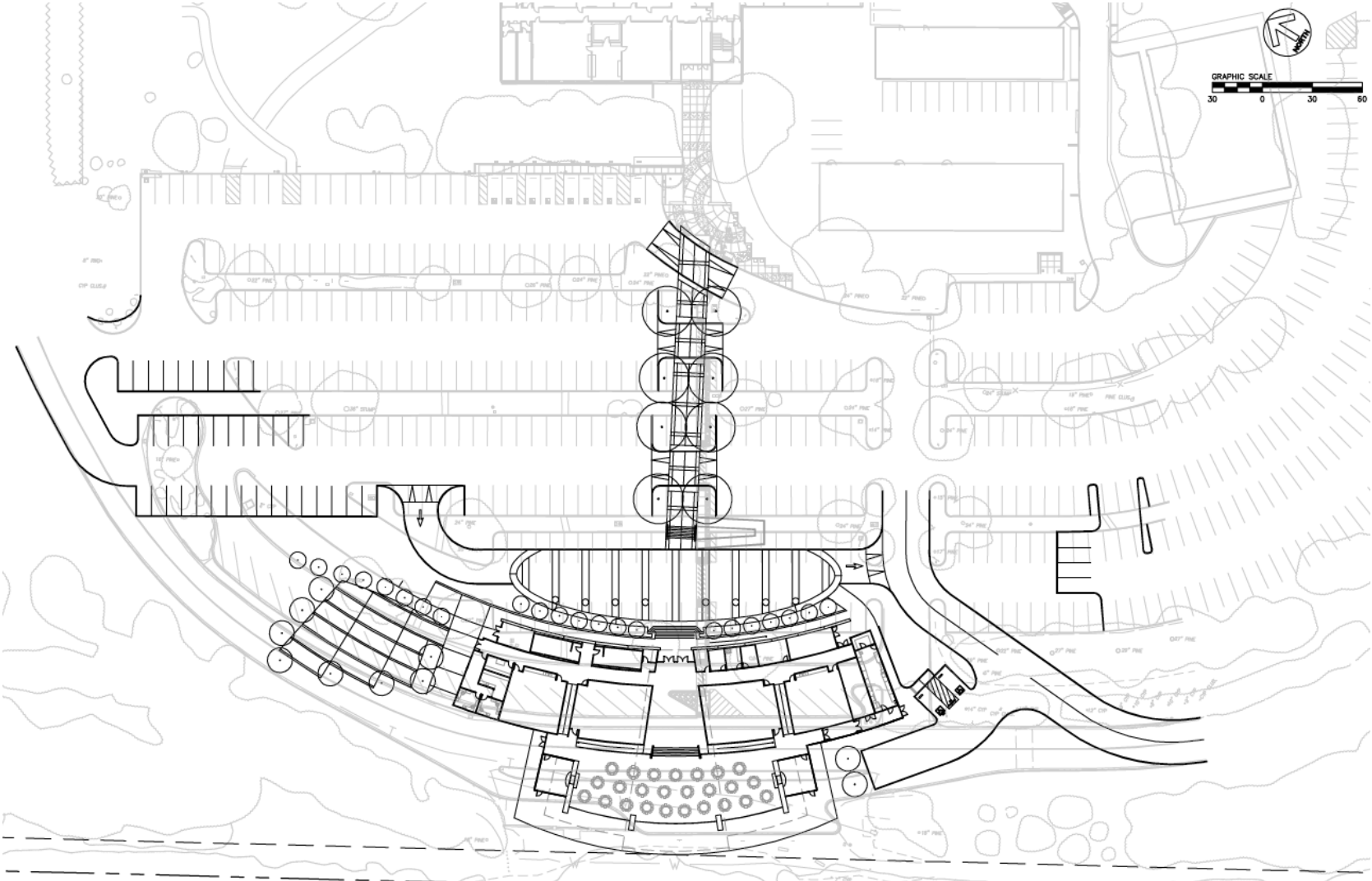

Skyline College Environmental Studies Building (B12N)

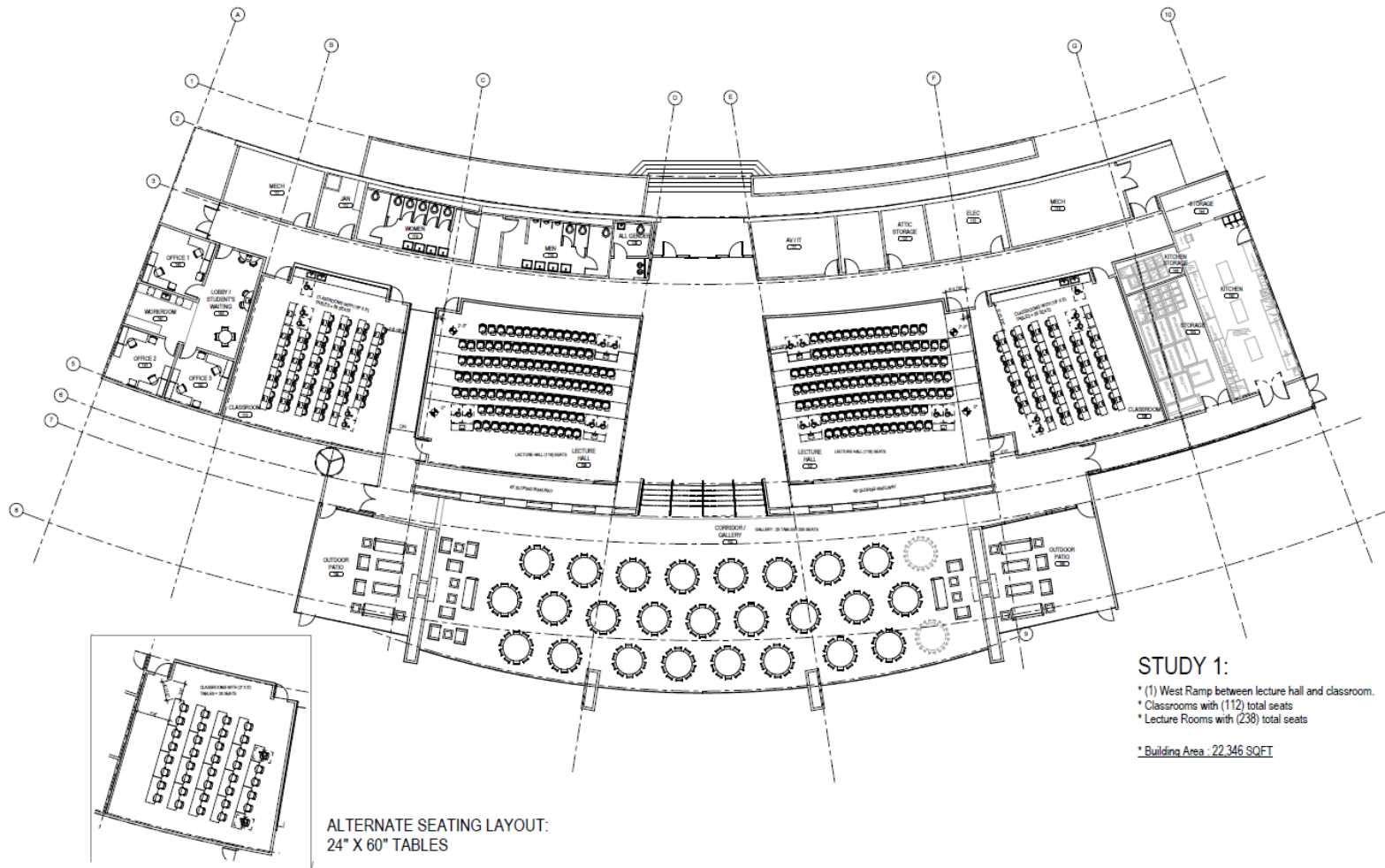

STUDY 1:

- * (1) West Ramp between lecture hall and classroom.
- * Classrooms with (112) total seats
- * Lecture Rooms with (238) total seats

* Building Area : 22,346 SQFT

ALTERNATE SEATING LAYOUT:
24" X 60" TABLES

Skyline College Environmental Studies Building (B12N)



Skyline College Lot L Expansion

- Budget \$5,000,000
 - Measure H
- Project Scope
 - Expand Parking Lot L
 - Current total parking spaces: 2,494
 - At Lot L completion: 2,690
 - During B1 & B2 construction: 2,505
 - At completion of B1 & B12: 2,523
- Status
 - Construction Documents submitted to DSA October 20, 2016
 - Will go to bid in Spring 2017
- Tentative Schedule
 - Construction start Q3 2017; Completion late Q4 2017

Skyline College Parking Lot L Expansion



USER GROUP MEETING 9 & CIP COMMENTS

LOT L EXPANSION, SKYLINE COLLEGE
SAN BRUNO, CALIFORNIA

GRAPHIC SITE PLAN



REV - AUGUST 26, 2016

Skyline College Pacific Heights Swing Space (B19)

- Budget \$23,000,000
 - Measure H
- Project Scope
 - Phase 1, Building used for swing space for during construction/modernization of B1, B2;
 - Provide minimal renovations to accommodate Building 1 programs: SparkPoint, CTTL, CWD, Faculty Offices, Administration of Justice, Career Services, English Language Institute, Cooperative Education; Permanent space for GAP and Shipping/Receiving
 - Art, music, drama will swing to San Bruno Union High School facilities
 - Phase 2: Modernization for general lecture classrooms, faculty offices, Middle College, ITS
- Status
 - Swing space design in progress
- Tentative Schedule
 - Phase 1 construction start Q1 2018; Complete Q2 2018

Skyline College Pacific Heights (B19) Option 5B

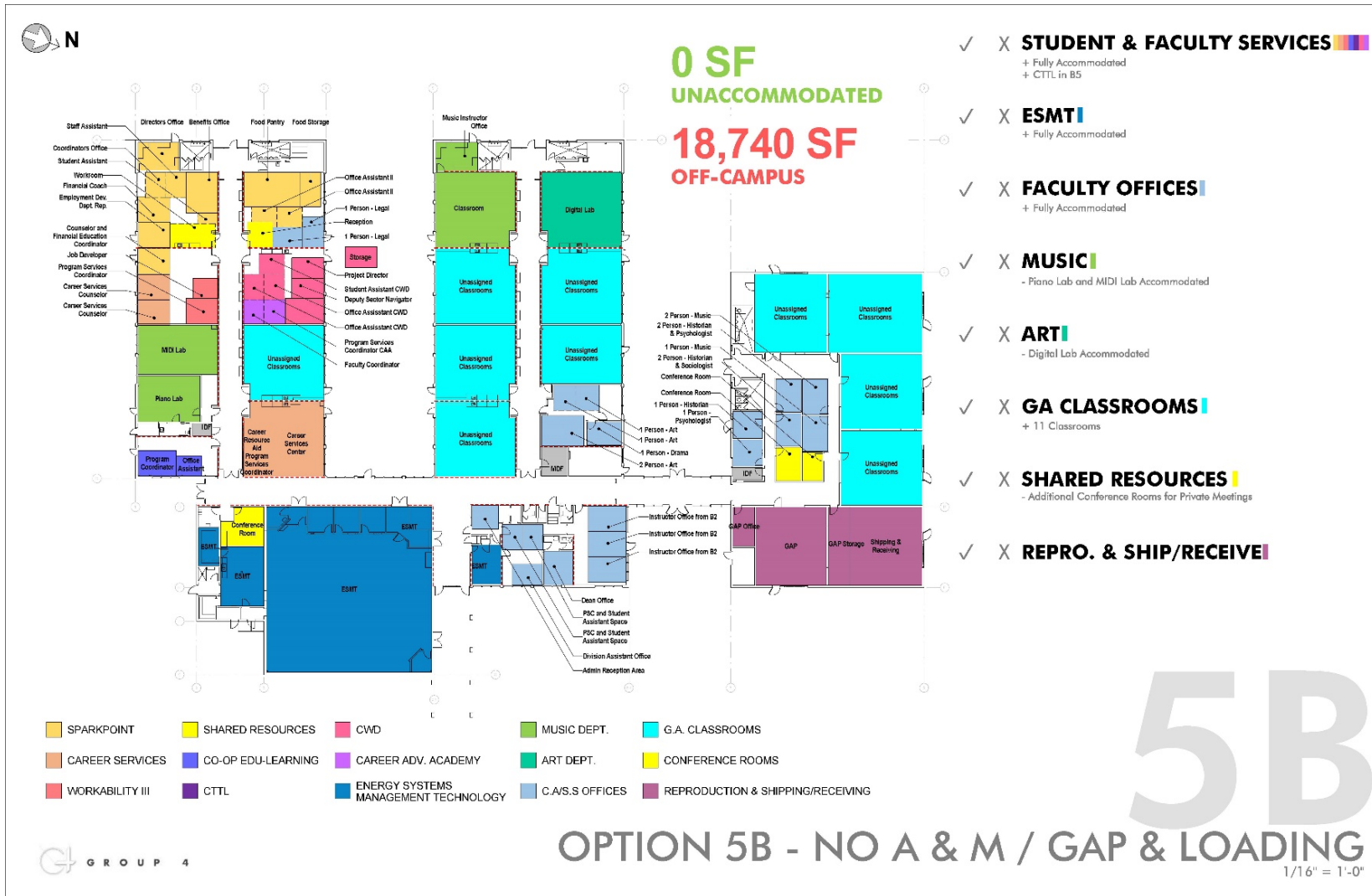

Skyline College Tentative Schedule*

	2016					2017					2018					2019					2020					2021					2022					2023																																																		
	A	M	J	J	A	S	O	N	D	J	F	M	A	M	J	J	A	S	O	N	D	J	F	M	A	M	J	J	A	S	O	N	D	J	F	M	A	M	J	J	A	S	O	N	D	J	F	M	A	M	J	J	A	S	O	N	D	J	F	M	A	M	J	J	A	S	O	N	D	J	F	M	A	M	J	J	A	S	O	N	D	J	F	M	A	M
SKY Lot L Expansion	Design & DSA					Bid					Construction																																																																											
SKY B12	RFSOQ/P					Design & DSA					Construction																																																																											
SKY B19 Pac Hts	Design & DSA - Swing Space					Bid					Construction										Design & DSA - Modernization					Bid					Construction																																																							
SKY B1	RFSOQ/P					Design & DSA					Construction																																																																											
SKY B14 Loma Chica	Design & DSA					Bid					Construction																																																																											
SKY B2**						Design & DSA					Bid					Construction																																																																						
SKY B5						Design & DSA					Bid					Construction																																																																						

* Schedule is subject to change due to agency requirements, unforeseen conditions, and/or design build contractor input

** Subject to identifying swing space

Logistics

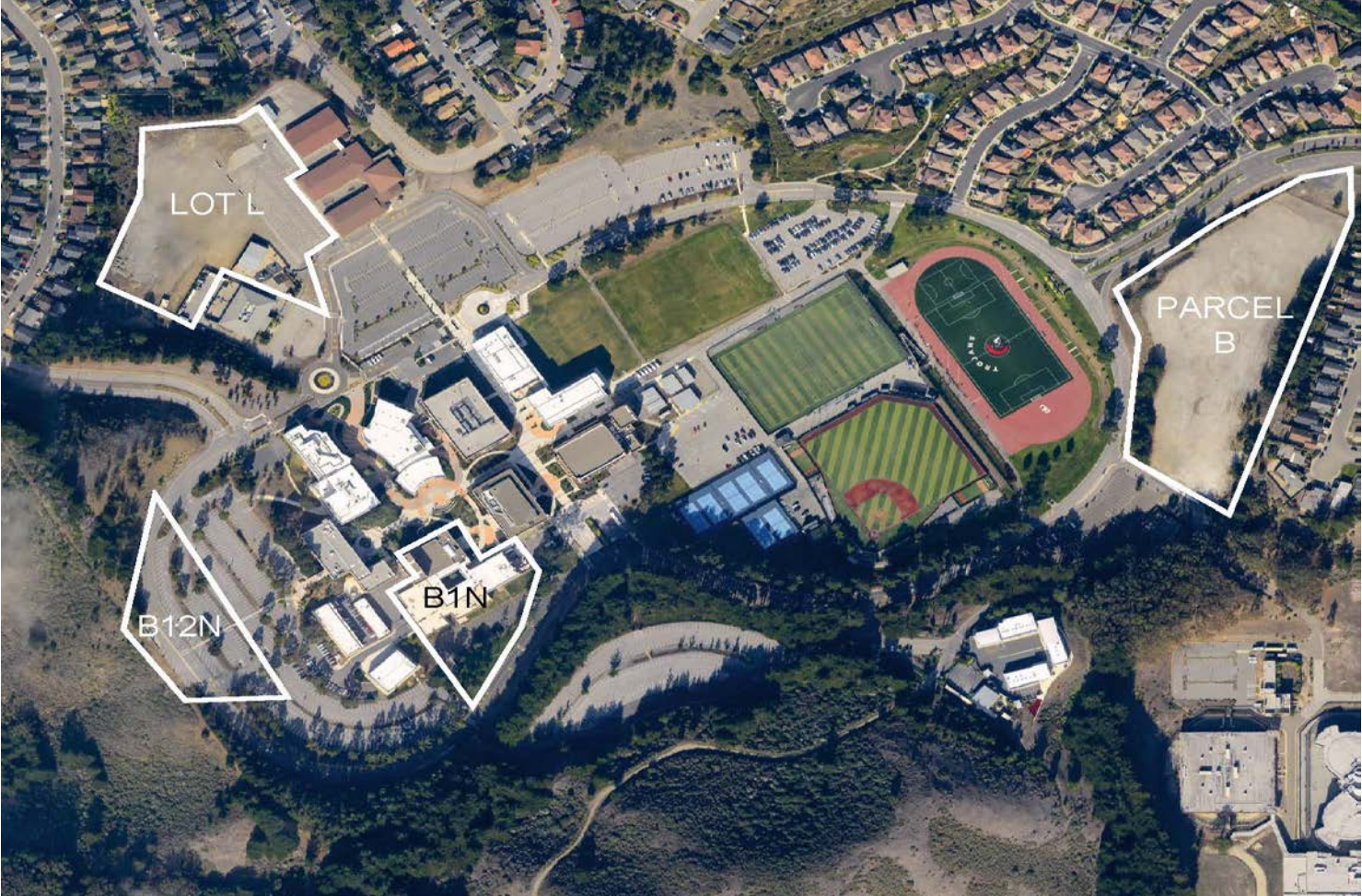

Questions and Answers



**SAN MATEO COUNTY
COMMUNITY
COLLEGE DISTRICT**

Cañada College • College of San Mateo • Skyline College