



SAN MATEO COUNTY  
**COMMUNITY**  
COLLEGE DISTRICT

# Cañada College Planning & Budget Council

Capital Improvement Program (CIP3) Update

March 4, 2015

# CIP 3 Planning Efforts Currently Underway

- ▶ Scheduling Consultant - Completed
- ▶ Cost Estimating Consultant - Completed
- ▶ California Environmental Quality Act (CEQA) - Winter 2015
- ▶ Construction Management - RFP in Progress
- ▶ Project Controls RFP - expected issuance Spring 2015
- ▶ Design Standards Revision - Spring 2015
- ▶ Swing Space Planning (Onuma) - In Progress
- ▶ Architect & Engineer (A&E) selection for design of first wave of projects - Spring 2015
- ▶ Annual General Contractor and Major Sub Contractor - 2015 Prequalification Completed

# Contract Templates- Legal Revision

- ▶ A&E Short Form Professional Services Agreement (PSA) for conceptual assignments
- ▶ A&E Long Form PSA for Design-Bid-Build (DBB)
- ▶ A&E Agreement for Lease Lease-Back (LLB)
- ▶ Pre-Construction Services Agreement for (LLB)
- ▶ Construction Contracts
  - ▶ Design Build (DB)
  - ▶ Design-Bid-Build (DBB) - Micro, Medium and Large Projects
  - ▶ Site and Facilities Lease Agreements (LLB)
  - ▶ Project Labor Agreement (PLA)

# Facilities Master Plan Amendment

San Mateo County Community College District

## 2015 Facilities Master Plan Amendment to the 2011 Facilities Master Plan



"Facilities Excellence"

# Cañada College Facilities Master Plan Map



# Cañada College Project List

- ▶ Cañada Building 1 Physical Education / Athletics(Demo & New Construction)
- ▶ Cañada Math / Science / Technology (New Construction)
- ▶ Cañada Building 3 Humanities
- ▶ Cañada Building 9 Library / Student Resource Center
- ▶ Cañada Building 13 Multiple Disciplinary Instructional
- ▶ Cañada Building 16/18 Science / Physical / Life Sciences (Secondary Effects)

# District Wide Project List

- ▶ Network (10GB) Upgrade / Phone Replacement
- ▶ Energy Efficiency/ Renewable Projects
- ▶ Roadways / Parking / Infrastructure
- ▶ Emergency Building Repair Fund (EBRF)
- ▶ Small Projects

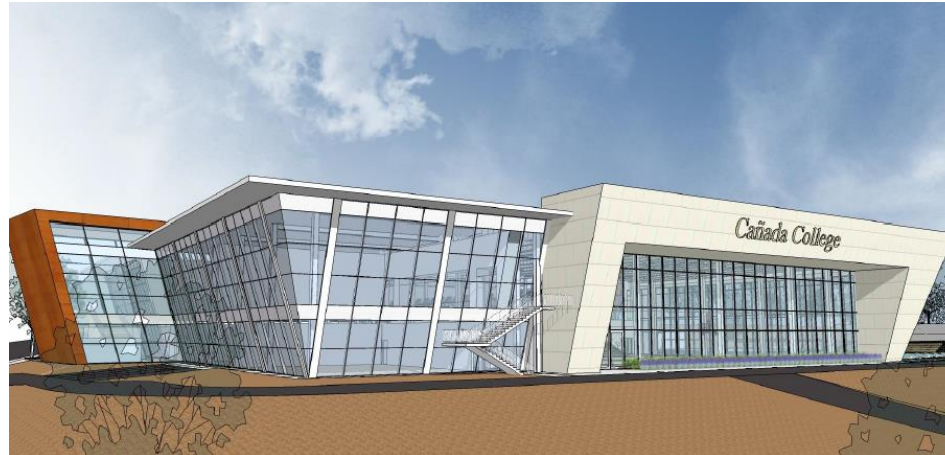

"Facilities Excellence"

# Process of a Project

- ▶ Facilities Planning is based upon Educational Planning
- ▶ Budget (Conceptual vs. Actual)
- ▶ A&E Selection & Design Process (9-12 months)
  - ▶ Programming / Schematic Design / Design Development / Construction Documents
- ▶ Schedule Development & Execution
  - ▶ Academic vs. Construction Logistics
- ▶ Delivery Method (DBB vs. DB vs. LLB)
- ▶ Contractor Procurement (DBB vs. DB vs. LLB)
- ▶ Permitting (4-6 Months)
- ▶ Construction (12-24 Months)
- ▶ Furniture, Fixtures and Equipment Installation (FF&E)
- ▶ Commissioning
- ▶ Occupancy
- ▶ Close Out



# CIP 3 Phase 1 Projects

- ▶ CAN 1 Demo & New Kinesiology - Schematic Design
- ▶ CAN New Math & Science - Programming
- ▶ CSM 3 Theater Modernization - Pending A&E Selection
- ▶ CSM 12 / 19 Demo & New Construction - Pending A&E Selection
- ▶ CSM 17 Student Life / Faculty Office Tenant Improvement - Pending A&E Selection
- ▶ SKY 1 Social Science / Creative Arts (Demo & New Construction) and Boiler Plant Relocation - Pending A&E Selection
- ▶ SKY New Environmental - Pending Design Build RFQ/RFP
- ▶ SKY New Energy Management - Pending A&E Selection

# Active Projects Under Construction

- ▶ CAN & CSM Parking Light LED Retrofits - Spring 2015
- ▶ CAN & CSM Theater House Lights - Spring 2015
- ▶ CSM North Gateway - Fall 2015
- ▶ CSM Bldg. 6 HHW Boiler Integration - Fall 2015
- ▶ CSM & SKY Roofing and Waterproofing - Fall 2015
- ▶ DW Measurement & Verification - Spring 2016
- ▶ DW Access Control Upgrade - Fall 2015
- ▶ DW Exterior LED Lighting Retrofits - Spring 2016



# Question & Answer

**José D. Nuñez, LEED® AP**

**Vice Chancellor**

**Facilities Planning, Maintenance & Operations**

**(650) 574-6512**

**[nunezj@smccd.edu](mailto:nunezj@smccd.edu)**

**Chris Strugar-Fritsch**

**Director of Capital Projects**

**Facilities Planning**

**Effective April 2015**

**Karen Powell**

**Executive Director of**

**Facilities Planning & Operations**

**Facilities Planning, Maintenance & Operations**

**(650) 358-6808**

**[powellk@smccd.edu](mailto:powellk@smccd.edu)**