

SECTION 00 91 01

ADDENDUM NO. 1**SUMMARY**

This document includes requirements that clarify or supersede portions of the Request for Proposal. This Addendum is a Contract Document.

General

The following changes, additions and deletions shall be made to the following document(s); all other conditions shall remain the same.

I. SPECIFICATIONS

Item	Reference	Description
1.	Table of Contents	Section 00 0110 - Table of Contents: Replace Table of Contents in its entirety. See attachment.
2.	Section 00 91 01	Section 00 91 01 – Addendum No. 1 – This Addendum is a NEW SECTION.

II. DRAWINGS

Item	Reference	Description
1.	G0.01	General Notes – Contractor to power wash terrace once work is completed; it is anticipated the existing rust marks left by previous furniture would be removed
2.	L1.1	All planters are estimated to be on site by Wednesday, August 15 th , 2012.
3.	L1.1	General Contractor responsible for relocating planters from Loma Chica area at Skyline up and onto roof deck of SKY B4. For bidding purposes, this relocation of planters is to be performed during normal working hours.

III. CLARIFICATIONS

Item	Reference	Description
1.	G0.01	Question: Are the existing rust marks on the pavers the responsibility of the contractor? Response: Contractor to power wash the terrace once work is completed; it is anticipated the existing rust marks left by previous furniture would be removed.

2.	L1.01	<p>Question: Is the contractor to purchase and install the planters as part of this project?</p> <p>Response: Owner has purchased the planters; Contractors responsible for relocating the planters up and onto the roof deck of SKY B4.</p>
3.	L1.01	<p>Question: Are the planters currently on site?</p> <p>Response: Planters are expected to be on site on Wednesday, August 15th. Planters will be delivered to Loma Chica at Skyline; Contractor responsible for relocating the planters from Loma Chica up and onto roof deck of SKY B4.</p>
4.	L1.01	<p>Question: Can we relocate the planters during the day / close the pathway from Loma Chica to Building 4 in order to relocate the planters?</p> <p>Response: For bidding purposes Contractor will be allowed to move planters from Loma Chica to Building 4 during normal working hours given 48 hour advance notice to Swinerton for approval by District before proceeding.</p>
5.	L1.01	<p>Question: How heavy are the planters?</p> <p>Response: The Small, Medium and Large Round planters are made of polymer resin (plastic), there is not an exact weight available at this time, but this information could be obtained from the manufacturer listed in Furniture Note 1, sheet L1.01. The rectangular Quick Crete planters are made of light weight concrete and weigh 488 lbs. each. The square Restoration Hardware planters are made of concrete and weigh 46 lbs. each.</p>
6.	L1.1	<p>Question: Will the existing pavers withstand the weight of the planters along with the plants, soils and water in the planters?</p> <p>Response: Yes. Per the product information provided to us by Kanjana on the installed products (attached), the Stepstone pavers are 24" square, 2" thick, 5000 PSI reinforced concrete, sitting on standard Bison "Level-It" pedestals. When we talked to Stepstone, they said the pedestals are by far the limiting part of the system and they will hold up to 750 lbs per pedestal. The material cut sheets for the pavers are included as part of the reference documents for bidding this project.</p>
7.	L1.02	<p>Question: Will the pavers need to be routed on the backside in order to allow electrical low voltage to run under the pavers?</p> <p>Response: The low voltage wiring should run under the pavers without routing out the back of the pavers. The wiring for the lighting within the pots could be coupled with the irrigation lines, coming up through the same hole drilled in the paver. It is noted on the irrigation sheet that the hole in the paver be a minimum of 3" from the edge of the paver to reduce the risk of cracking. The wiring for the 2 ground mounted fixtures for the wall mural could either be brought up through a gap between the pavers or through a small hole drilled in the pavers. This hole should be kept a minimum of 3" from the</p>

		edge as mentioned above and may require a slight adjustment to the fixture locations.
8.	L2.01	<p>Question: Do the pavers have enough room to run the ¾" Schedule 40 PVC Under the pavers as shown on plans?</p> <p>Response: No. Space under existing pavers is ~ ½"; Contractor to use flex irrigation line under pavers that will fit within constraints of ½" space under existing pavers.</p>
9.	L1.01	<p>Question: Will planters be placed on existing rubber mat that runs along parapet wall?</p> <p>Response: No. Planters will be placed just off of and not on top of rubberized mat (expansion joint between the buildings)</p>
10.	L1.01	<p>Question: Detail 2 on Sheet L1.01 does not indicate any lateral bracing for the wood screens; do we need to brace the wood screens to the metal railing along the parapet wall?</p> <p>Response: For bidding purposes, detail to install and brace wood screen to be followed.</p>
11.	L2.01	<p>Question: Where is water source for irrigation? Where is power source for irrigation clock?</p> <p>Response: Water is to be sourced from adjacent hose bib as shown on Sheet L201. Contractor to use copper pipe from hose bib up to irrigation clock. Copper pipe to be installed on sleepers along roof deck with walkpads along one side of sleepers as part of base contract scope. Flex line can be used from irrigation clock to planters. Irrigation clock is battery operated.</p>
12.	L1.02	<p>Question: Will Existing GFIs need to be relocated as part of base contract to accommodate placement of planters?</p> <p>Response: No.</p>
13.	L2.01	<p>Question: Who is the manufacturer of the adjacent roof from which we will be routing the water line from the existing hose bib?</p> <p>Response: The manufacturer for urethane rubber membrane is GACO WESTERN, the manufacturer for thermoplastic membrane is RED SHIELD ROOFING SYSTEM. The roofing contractor that install the adjacent roof was ALCAL ARCADE CONTRACTING, INC. Contact at AICal is Mark McAtee, Phone Number 510.477.9380; Email: mark.mcatee@alcalarcade.com.</p>
14.	L2.01	<p>Question: Will benches need to be assembled by Contractor as part of this project?</p> <p>Response: No. Benches will be assembled by District installer on top of B4 Roof. Contractor will not be responsible for relocating finished benches to roof terrace of B4.</p>

END OF ADDENDUM



**Hensel Phelps
Construction Co.**

Submittal

Job: 5008046
Skyline College CIP 2 D/B
3600 College Drive
San Bruno, CA 94066

Submittal No:

0002-077600-A

Submittal Title:

Roof Pavers - Pavers - Product
Data

Submittal Date:

December 29, 2009

PROVIDE LEED BUYOUT
PER 1.7 D.

- | | |
|--|---|
| <input checked="" type="checkbox"/> Reviewed | <input type="checkbox"/> Make Corrections Noted |
| <input type="checkbox"/> Revise & Resubmit | <input type="checkbox"/> Rejected |
| | <input type="checkbox"/> Not Reviewed |

The Architect shall review and take appropriate action on shop drawings, product data, samples, and other submittals required by the Contract Documents. Such review shall be only for general conformance with the design concept and general compliance with the information given in the Contract Documents. It shall not include review of quantities, dimensions, weights or gauges, fabrication processes, construction means and methods, coordination with the work of other trades, or construction safety precautions, all of which are the sole responsibility of the Contractor. The Architect's review shall be conducted with reasonable promptness consistent with sound professional practice. Review of a specific item shall not indicate acceptance of an assembly of which the item is a component. The Architect shall not be required to review and shall not be responsible for any deviations from the Contract Documents not clearly noted by the Contractor, nor shall the Architect be required to review partial submissions or those for which submissions for correlated items have not been received. Such review by the Architect shall not relieve the Contractor of any of his responsibilities under the Construction Contract. When professional certification of performance characteristics of materials, systems or equipment is required by the Contract Documents, the Architect shall be entitled to rely upon such certification to establish that the materials, systems or equipment will meet the performance criteria required by the Contract Documents.

WRNSSTUDIO

801 SECOND STREET
4TH FLOOR, STE. 402
SAN FRANCISCO
CALIFORNIA 94102
415.489.2924 TEL
415.388.6100 FAX
WWW.WRNSSTUDIO.COM

Date: 01-25-2009 By: EK

HPCC Stamp

HENSEL PHELPS CONSTRUCTION CO.

<input type="checkbox"/> REVIEWED	<input checked="" type="checkbox"/> NO EXCEPTIONS TAKEN
<input type="checkbox"/> REVISE & RESUBMIT	<input type="checkbox"/> MAKE CORRECTIONS NOTED
	<input type="checkbox"/> REJECTED

THIS SUBMITTAL HAS BEEN REVIEWED FOR GENERAL COMPLIANCE WITH THE CONTRACT DOCUMENTS. APPROVAL DOES NOT RELIEVE THE SUBCONTRACTOR/SUPPLIER OF THE RESPONSIBILITY FOR CONFORMANCE TO THE QUALITY STANDARDS AS SET FORTH IN THE CONTRACT DOCUMENTS NOR DOES IT RELIEVE RESPONSIBILITY FOR FIELD VERIFICATION OF ALL CONDITIONS RELATING TO THE WORK OF SUBCONTRACTOR/SUPPLIER. SUBCONTRACTOR/SUPPLIER IS RESPONSIBLE FOR DIMENSIONS AND QUANTITIES OF MATERIALS RELATING TO THIS CONTRACT.

CK'D BY ETJ DATE 12/29/2009

SUBMITTAL NO. 0002-077600-A

AE Stamp

AE Stamp



Roof Pavers

National Distribution



Roof Pavers

Stepstone, Inc. offers commercial and residential projects the ultimate in rooftop environments. These elevated entertaining areas are appealing to the consumer and convenient to the contractor. Stepstone's Roof Paver Line transforms an ordinary rooftop into a sophisticated outdoor space rich with ambience. Four design styles offer solutions for slopes and flat surfaced roofs, plus drainage and reinforcing considerations, lightweight options and more.



CALL 800 572-9029

GARDENA, CALIFORNIA

VISIT OUR WEBSITE WWW.STEPSTONEINC.COM



Roof Pavers™

National Distribution

Reinforced Roof Pavers, Pedestal Supported (22 psf), are steel reinforced and carry the span to independent adjustable pedestals at the corners. These pedestal supported pavers allow you to have a flat, level paved surface which compensates for the slope of the roof.

Drydeck™ Pavers (22 psf) are uniquely designed. A polystyrene pedestal (60 pound density) is cast into each corner to raise the paver 1/2" off the water proof surface allowing drainage under the roof pavers.

Lightweight Roof Pavers (12 psf) were invented for applications where an existing roof or new roof requires a lighter load. Cast with 1" of concrete laminated to 1 1/2" of expanded polystyrene foam, these pavers are a lightweight roof paver but weigh in at half the load.

COLORS TO TBD
PER OWNERS
APPROVAL

Rooftrac Pavers (30 psf) are a planking runway around the roof perimeter to ease the movement of the window washing equipment.

Stepstone offers unique solutions to your perimeter installations. See details.

CatalArc Colors*

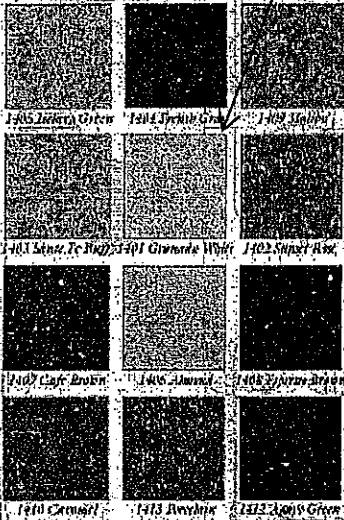

Short Form Specification:
Material: 5,000-PSI Hardrock Concrete
Finishes: Fine Grain Stipple, Sandblast & Sonorastone®
Size*: 24" x 24" x 2"
 See details for additional sizes
 *All Sizes are Nominal

*See actual color, concrete samples before ordering. Roof Pavers are hand formed of natural materials. Variations in color are to be expected. Some minor chipping may result from shipping, but is not detrimental to appearance or function. This material is copyrighted and is intended solely for the use of customers of Stepstone, Inc.

Stepstone proudly distributes the following pedestal systems: BISON, APPIAN & PAVE-EL

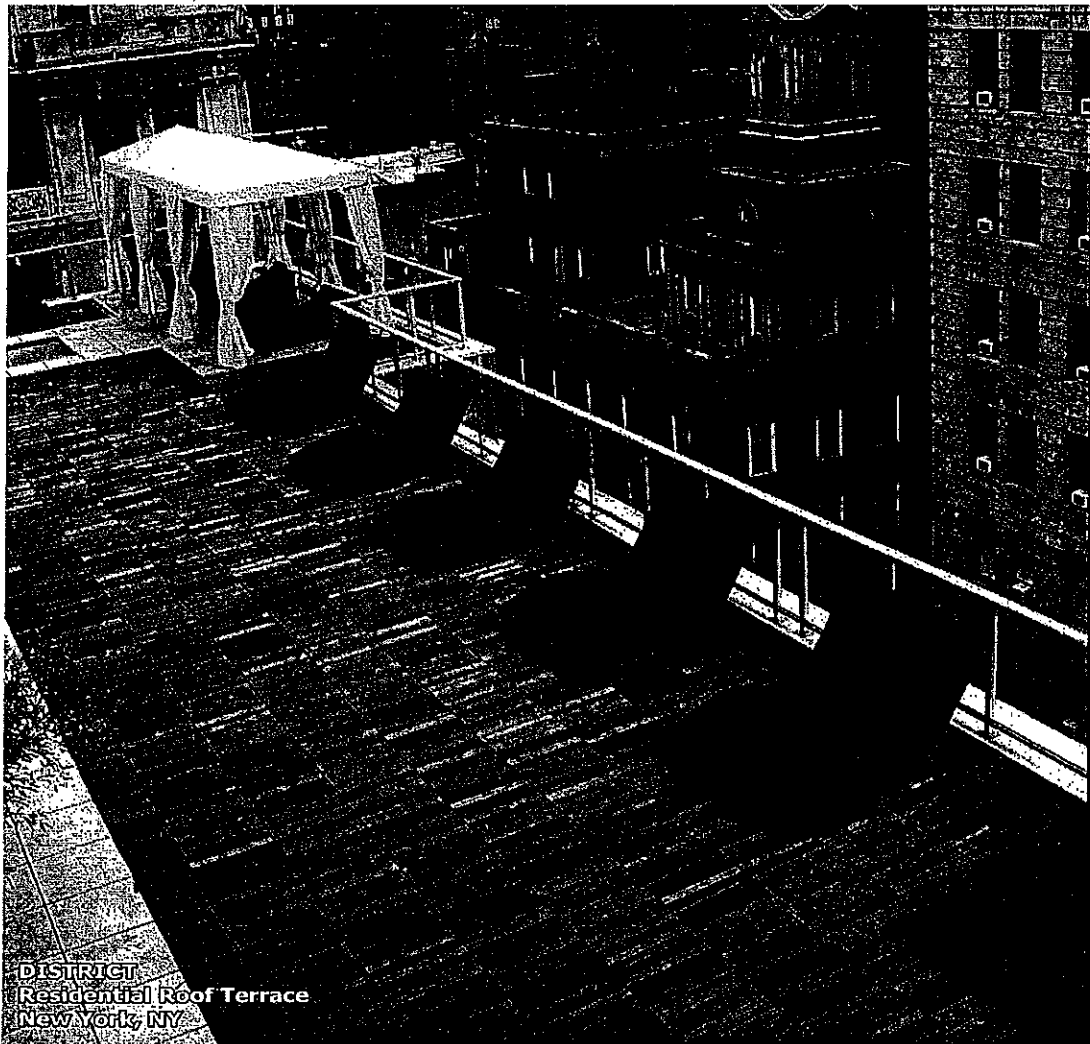

DISTRICT
Residential Roof Terrace
New York, NY

LEVEL-IT

Design and build level decks on rooftops or any structural surface.

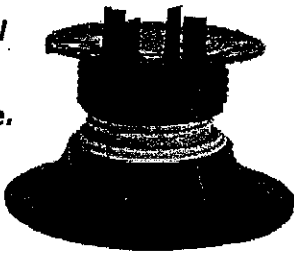

Model LC

- Simple Pedestal Design
- Commercial Grade For Residential Use
- Supports 750 lbs per Pedestal
- Pedestal System Reaches 12"
- Fast Screw-to-Adjust Installation

Bison supports creativity . . .

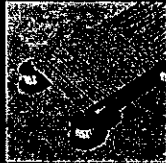

Wood Tiles



Stone Tiles



Concrete Pavers



Water Features



Granite Slabs



and many more



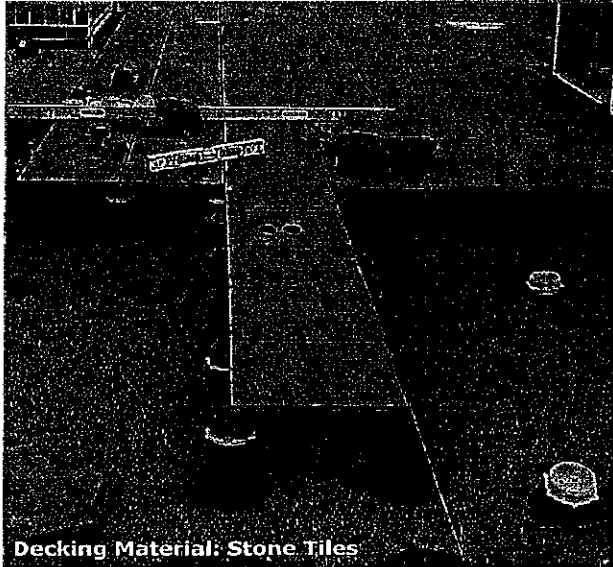

Decking Material: Stone Tiles

Level-It Specifications

- Supports up to 750 lbs. (FS2)
- Maximum elevation to 12" using couplers
- Impervious to water, mold and freeze-thaw
- Preassembled
- Packaged in weather resistant boxes
- Made in the USA
- Contains 20% Post-Industrial Recycled Material
- Engagement 'bumps' warn of over-extension*

*Patent Pending

www.BisonDeckSupports.com
(800) 333-4234

Online Resources:

- CAD Details
- Specifications
- Technical Cut Sheets
- Maintenance Guide
- Videos: Planning, Installation & more

In-House Resources:

- Take-Off Assistance
- Samples Available
- Technical Assistance
- Customer Service
- Hours of operation: Mon-Fri: 8:00AM-5:00PM, MST

Model Number	Description	Height Range	Max Height
	LC Adjustable Pedestal	2" - 4 3/4"	4 3/4"
	C1 Gray Coupler	Adds up to 1 1/2"	
	C4 Black Coupler	Adds up to 4" each	
Tab Choices			
	LT18 Tab	1/8" wide	
	LT316 Tab	3/16" wide	
Accessories			
	VT18 Use for Ultra Low Height	1/8" high	Tab 1/8" w
	VT316 Use for Ultra Low Height	1/8" high	Tab 3/16" w
	HD25 Fixed Height Stackable Pedestals	1/4"	Tab 1/8" or 3/16" wide
	HD50 Fixed Height Stackable Pedestals	1/2"	
	HD75 Fixed Height Stackable Pedestals	3/4"	
	LO Low Height Adjustable Pedestal	1 1/4" - 2"	2"
	B11 Flexible Shim	1/16"	
	PS1 Plastic Shim	1/8"	
	LD4 Base Leveler	Stack up to 4"	1/4" - 1" per foot slope
	FS1 Wood Tile Fastening Kit: Utilize to secure Bison Wood Tiles to pedestal system.		
	FIB Floating Insulation Base- 12" x 12" x 11/16" For use over roofing systems with 20psi insulation.		
	FFB Floating Foundation Base- 12" x 12" x 1/4" For use on grade (soil) under each pedestal.		

IMPORTANT: Refer to Level-It product specifications to ensure proper use and installation. Find specifications at www.BisonDeckSupports.com.

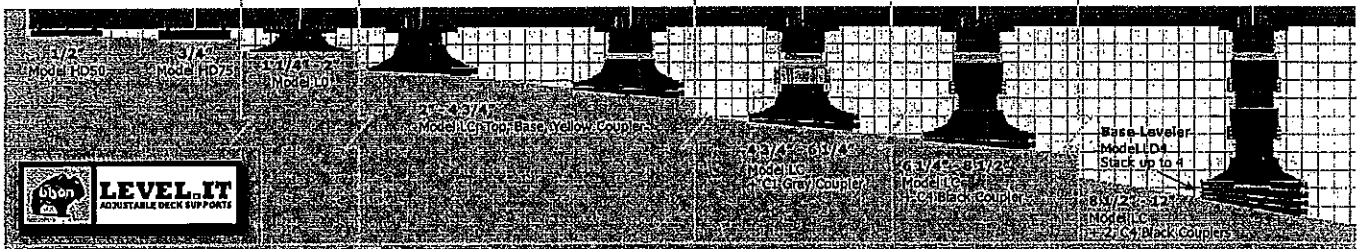

Copyright 2009 United Construction Products, Inc. All Rights Reserved.

BISON DECK SUPPORTS
a United Construction Products, Inc. Company
1975 W. 13th Ave.
Denver, CO 80204

We welcome your questions.
(800) 333-4234
Sales@BisonDeckSupports.com
www.BisonDeckSupports.com

BISON DECK SUPPORTS

a United Construction Products, Inc. Company
1975 W. 13th Ave Denver, CO 80204
Phone: 800-333-4234
Online: www.BisonDeckSupports.com
Email: support@BisonDeckSupports.com



Copyright 2009 United Construction Products, Inc. All Rights Reserved

INSTALLATION DETAILS

UNDERSTANDING THE LEVEL.IT LC Patent and Patent Improvements Pending

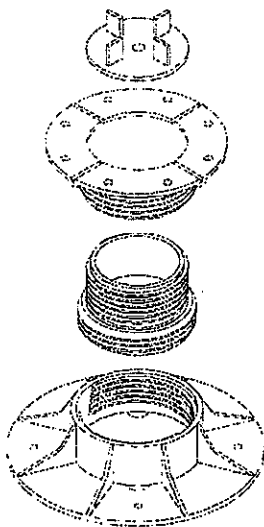

LC Tab

LT316 - 3/16" standard
LT18 - 1/8" optional

LC Top

"Engagement Bumps" prevent overextension. Mates with LC Bottom or LC C3 coupler

LC Coupler (yellow)

"Engagement Bumps" prevent overextension. Do not extend beyond bumps except to add a coupler. Remove coupler to reach lowest elevations. Item LC Not sold separately.

LC Base

Scored base for easy trimming
Works with LC Top or LC coupler
48 sq. in. base for weight distribution
"Speed Bumps" prevent overextension

Model LC works for elevations between 2" and 4 3/4".

Add couplers to reach up to 12" in elevation.

For elevations over 12" see our Versadjust line.

Accessories are available to compensate for slope and low height applications from 1/8 inch to 2 inches.

LC Base (Bottom View)

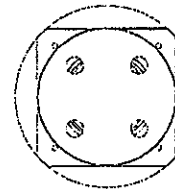

The LC Base is scored to allow easier trimming to fit the pedestal in tight spots.

When cutting the LC Base, round off any sharp edges to protect the roofing membrane.

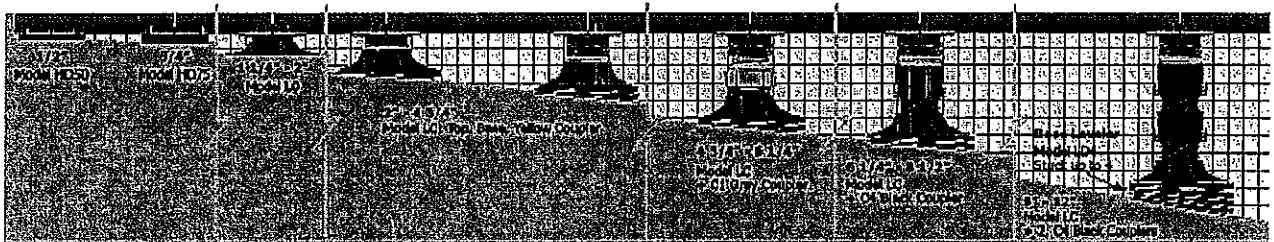

MAINTENANCE GUIDE

Routine maintenance of your paver deck system will enhance the beauty, reduce major repairs, and prolong the life of your deck. Below is a list of maintenance guidelines that should be performed on a regular basis:

1. Check for "rocking" pavers. If you notice pavers rocking back and forth while walking on the deck simply lift paver up and shim 1 or more corners until paver is level on all four corners. To ensure pedestal stability, make sure "speed bumps" are engaged. Bison B11 (1/16") or PS1 (1/8") shims can be ordered and shipped.
2. Depending on substrate materials some settling and or deflection can occur. Remove paver and adjust the pedestal by turning the base until level height is achieved. You may need to do this on more than one pedestal to level out an area.
3. Clean drains and scuppers on a regular basis. Water should completely drain off roof deck within 48 hours after rainfall, under ambient drying conditions. Sitting or "ponding" water can be detrimental to deck systems.
4. Periodically check spacer tabs between pavers and replace broken spacer tabs immediately. Loss of spacer tabs can cause unsafe deck movement.
5. Make sure the edge restraint stays intact and in good condition. There should not be room around perimeters of the deck in excess of 1/8" which would cause lateral movement of pavers, and void the Bison warranty.
6. Follow paver manufacturers' suggestions for upkeep and maintenance of pavers.

ADVANCED LAYOUT AND PEDESTAL PLACEMENT

Acronym	Definition
LP	Low Point
HP	High Point
RD	Roof Drain

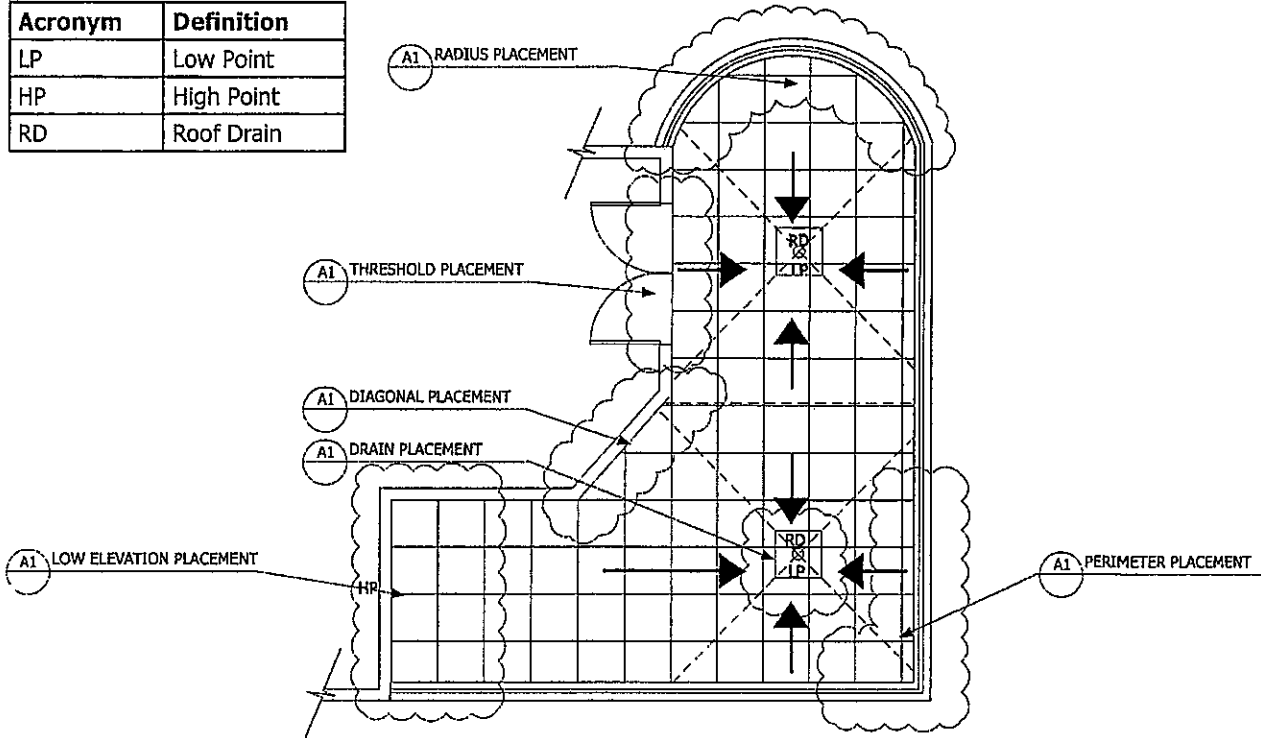

"T" METHOD INSTALLATION

1. Determine cavity height at all thresholds, drains and high points.
2. Deduct thickness of decking material.
3. Mark top of pedestal elevation around deck with laser level
4. Plan paver/pedestal layout pattern
5. Install "T" shaped portion of deck starting from threshold or high point
6. Adjust to correct height and level.
7. Installation on both sides of the "T" can proceed.

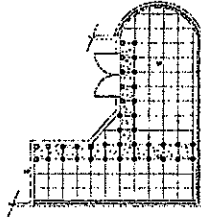

DETERMINING CAVITY HEIGHT

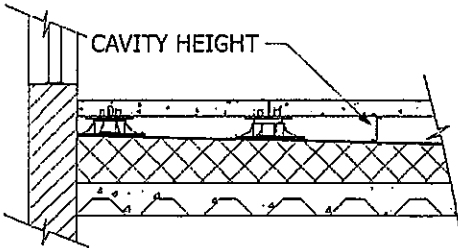

The cavity height is the space between the top of the roofing membrane, and the bottom of the decking material.

This is the height the pedestal will cover.

Use of a laser level or chalk line may assist.

Also refer to the detachable Level.it measuring device printed on the box.

THRESHOLD AND PERIMETER PLACEMENT

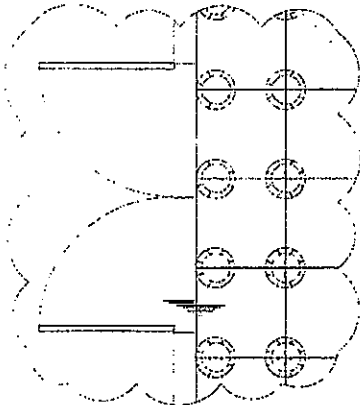

Remove tabs as necessary to inset edge pedestals.

Trim the base for tight fits.

Never allow more than 1 tab width between the decking material and your containment.

Pedestals may be inverted for particularly tight fits.

Excess tabs may be glued into place with construction adhesive to ensure spacing when "normal" tab placement is not possible.

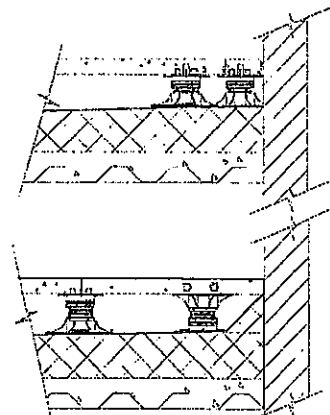

RADIUS PLACEMENT

Use extra pedestals under triangular pieces to prevent rocking.

Never allow more than 1 tab width between the decking material and your containment.

Add an extra pedestal at perimeter bends.

Remove extra tabs to inset pedestals on edge.

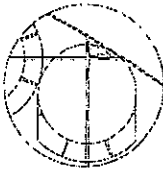

Adhere small pavers to top of pedestal with construction adhesive.

Trim pedestal base as needed to fit around perimeter.

Use removed tabs to maintain spacing between pavers.

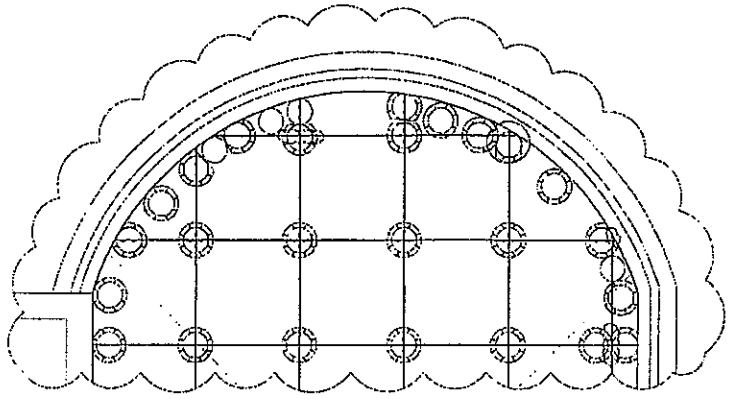

LOW ELEVATION PLACEMENT

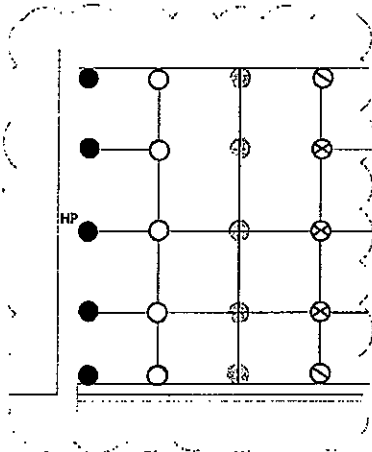

For low elevations the following pedestals are available:

LOW HEIGHT PEDESTALS

Model:		Height:
VT18 or VT316	●	1/8"
HD25	○	1/4"
HD50	⊙	1/2"
HD75	⊗	3/4"
LO	⊗	1/4 - 2"

Shims can also be used to accommodate variations in height, in either 1/8" (PS1) or 1/16" (B11) increments.

DIAGONAL PLACEMENT

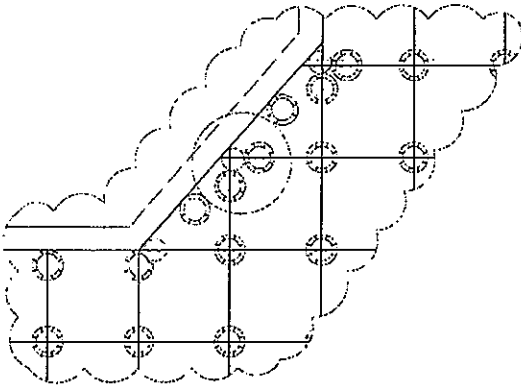

Use extra pedestals under triangular pieces to prevent rocking.

Never allow more than 1 tab width between the decking material and your containment.

Remove extra tabs to inset pedestals on edge.

Adhere small pavers to top of pedestal with construction adhesive.

Trim pedestal base as needed to fit around perimeter.

Use removed tabs to maintain spacing between pavers.

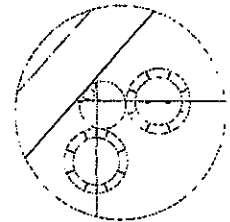

DRAIN PLACEMENT

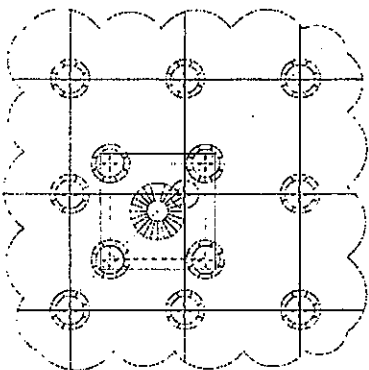

Elevate a steel plate or spare paver above the drain, but below the deck itself.

Use that elevated paver to support a pedestal where you need for the deck above.

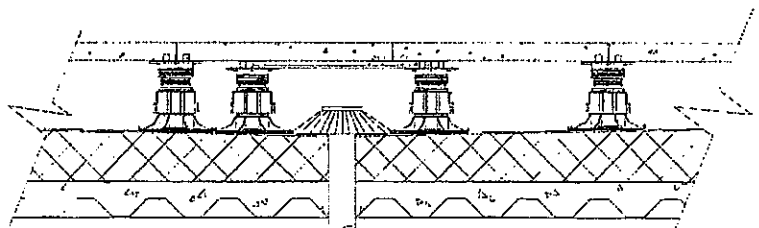

SLOPE COMPENSATION METHODS

BASE LEVELER

Each LD4 compensates for 1/4" per foot (2%) slope and adds 3/8" to the overall height of the pedestal. A maximum of four (4) LD4s may be used to compensate for up to 1" per foot (0-8%) slope.

Place LD4 with ridges facing up.

Finger tab points downhill for 1/4" per foot (2%) slope.

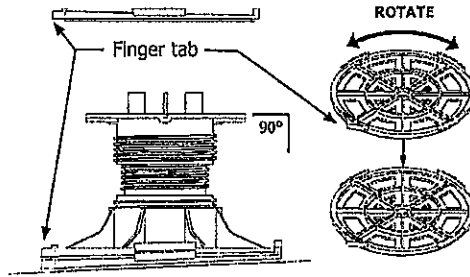

SHIMS UNDER PEDESTALS

Place shims (whole or in segments) under the pedestal in a stairstep fashion to compensate for sloping substrates. Use only B11 shims for this application. Use no more than four (4) shims.

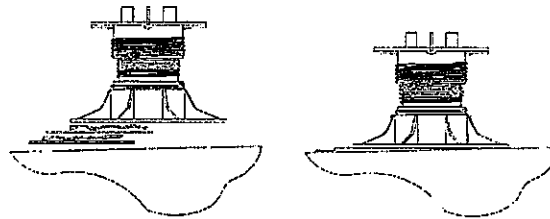

WORKING WITH SHIMS

PS1 (1/8") SHIMS

PS1s may be placed on top of pedestals to accommodate for minor leveling of pavers with thickness variations. Use no more than 2 shims. If using only 1/4 segment, adhere it to the pedestal with construction adhesive.

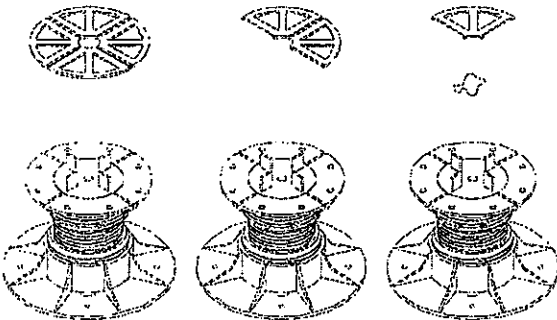

B11 (1/16") SHIMS

B11s may be placed on top of pedestals to accommodate for minor leveling of pavers with thickness variations. Use no more than 2 shims. If using only 1/4 segment, adhere it to the pedestal with construction adhesive.

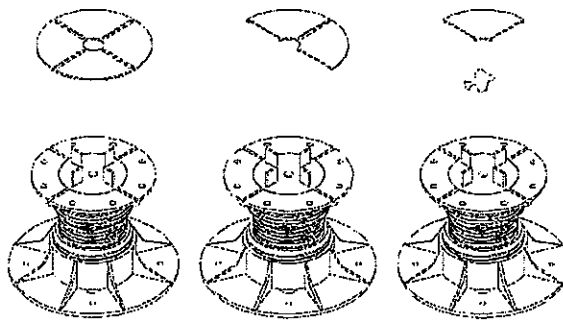

PEDESTAL BASE PADS

Floating Insulation Base (FIB)

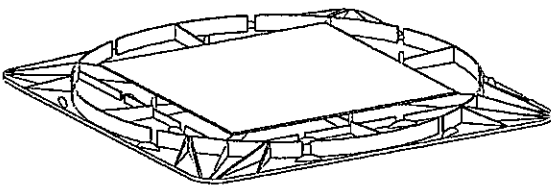

If integral roof insulation is installed immediately below the membrane, the type and density of the insulation is of utmost importance. Roofing systems having "common" insulations with a medium density of 20 psi must also use Bison Floating Insulation Bases (FIB). FIBs are installed immediately below the Bison Deck Support pedestals to disperse the deck load.

Do not use Bison Deck Supports over any insulation less than 20 psi or with low density polystyrene (bead board) insulation.

Floating Foundation Base (FFB)

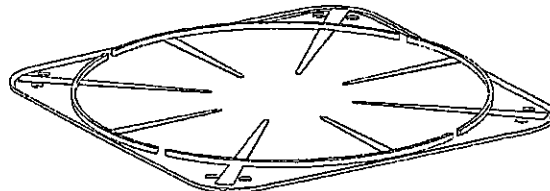

Bison Floating Foundation Bases (FFB) must be used beneath all on grade Bison Deck Support decks. Level the surface and set directly on grade as a base.