

Bond Oversight Committee CIP Status Review

August 4, 2011

Cañada College

Building Renewal, Renovation, and New Construction Status

-   **Completed**
-   **In Progress**
-   **Not Funded**
-   **Undetermined**

The colors depicted on the buildings represent the percentage of the building that has been completed; not necessarily the area within the building where work has been performed

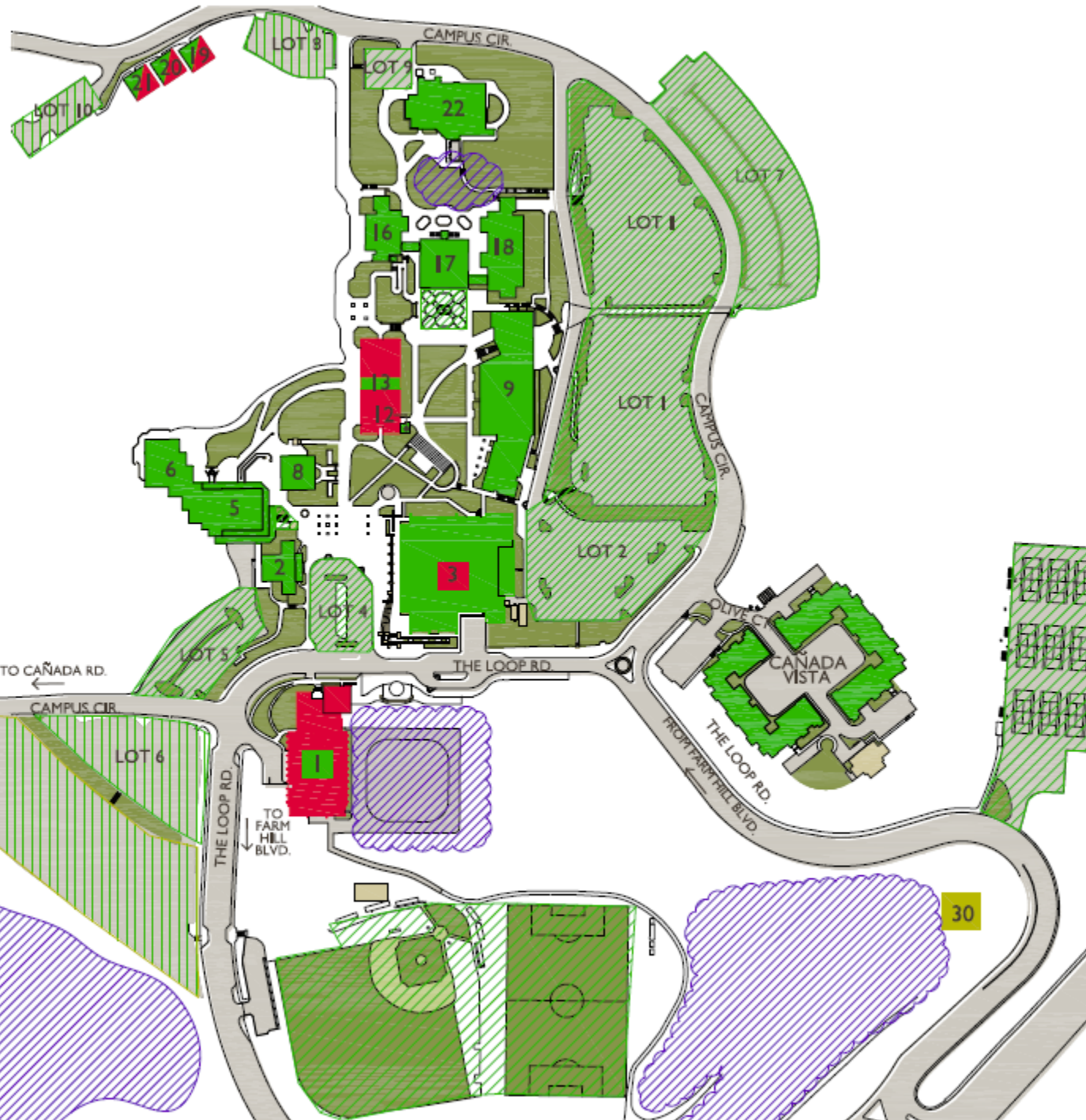

College Of San Mateo

Building Renewal, Renovation, and New Construction Status



The colors depicted on the buildings represent the percentage of the building that has been completed; not necessarily the area within the building where work has been performed

Facilities Planning
07/21/2011

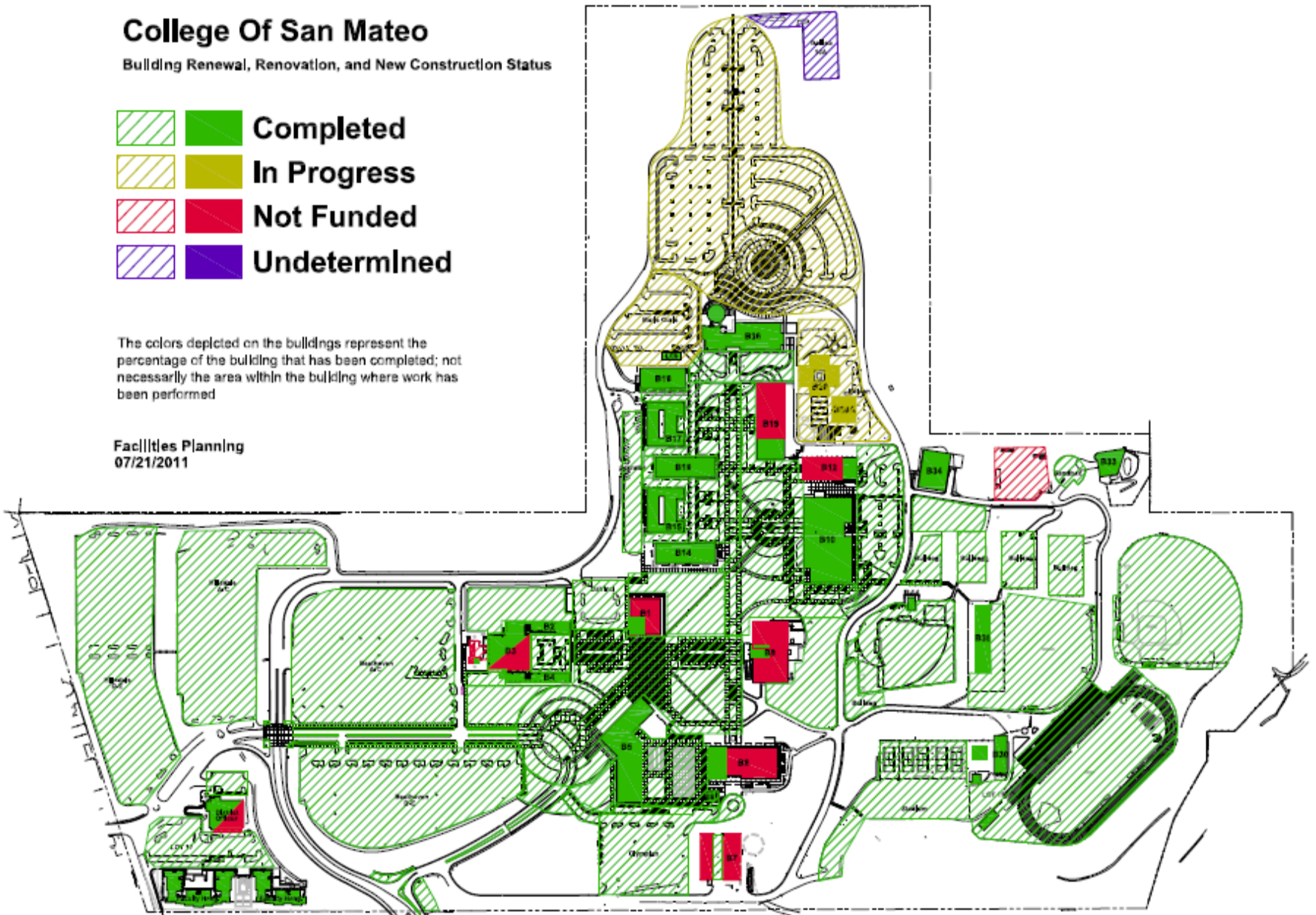

Skylline College

Building Renewal, Renovation, and New Construction Status

-   Completed
-   In Progress
-   Not Funded
-   Undetermined

The colors depicted on the buildings represent the percentage of the building that has been completed; not necessarily the area within the building where work has been performed

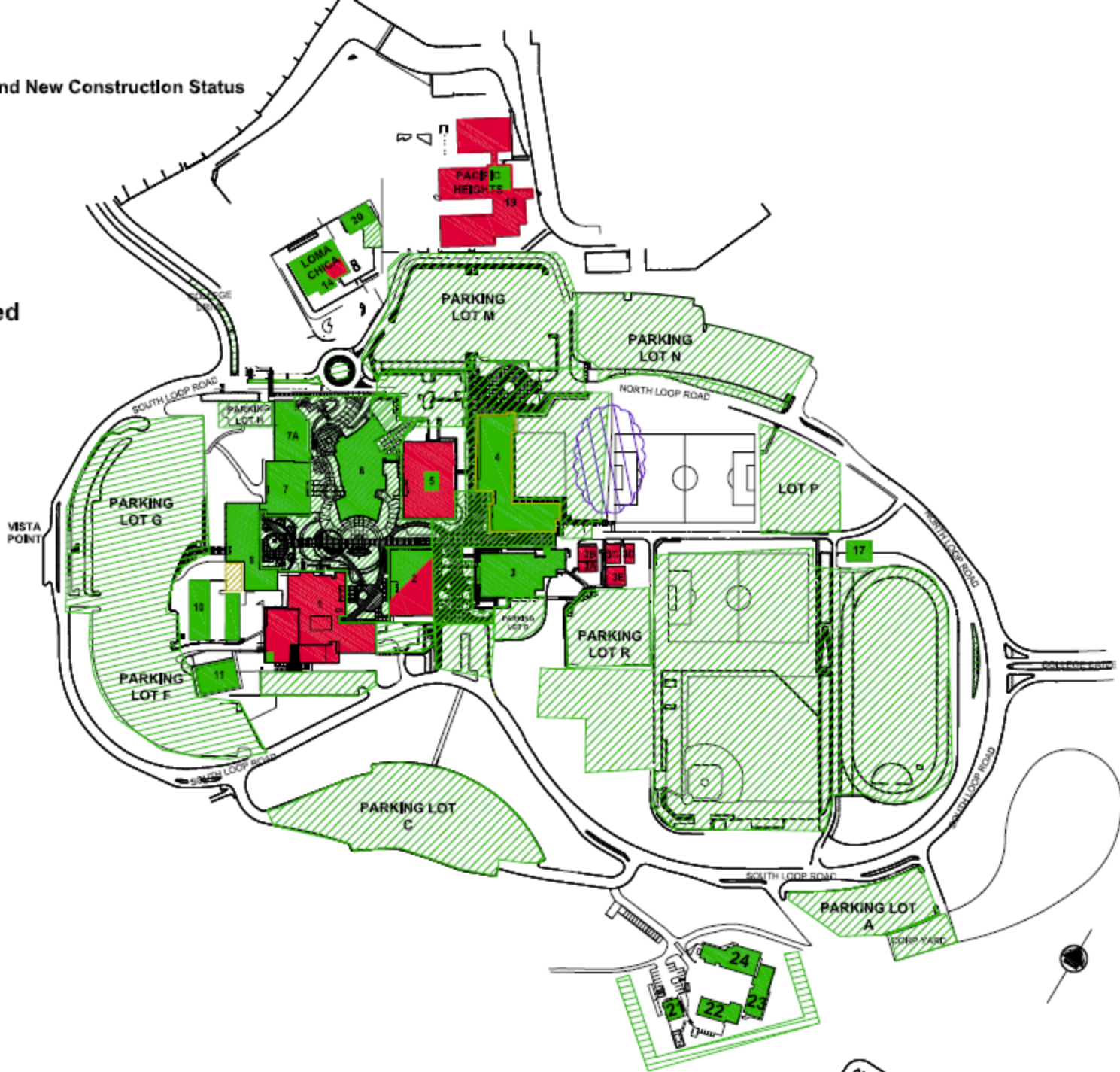

Projects in Design

- CAN B5 Dining Room Renovation (Pjt 343)
 - Project manager Barry Chin
 - Project web page
 - <http://www.smccd.edu/accounts/smccd/departments/facilities/CanDiningRoom.shtml>
 - Renderings
 - <\\appserv2\DisCIP2\Projects\343 CAN B5 6 Dining Room\Design\4. CDs\Renderings from DSA FCD Set>
 - Budget \$1,201,000
 - Schedule
 - DSA approval early August 2011
 - Bidding August 2011
 - Contract award by BoT September 28, 2011
 - Construction Oct 2011 – Jan 2012
 - FF&E and A/V Feb – March 2012
 - Occupancy mid March 2012

Projects Out to Bid

- DW Boiler NOx project (Pjt 071)
 - Project manager Roger Anchartechar
 - Project web page
 - http://www.smccd.edu/accounts/smccd/departments/facilities/DW_BoilerNOXUpgrade.shtml
 - Contractor prequalification
 - Budget \$1,500,000
 - Schedule
- CSM B12 + Colonnades Reroof (Pjt 449)
 - Project manager Roger Anchartechar
 - Budget \$496,000

Projects in Construction

- Can B16 Science Lab TI (Pjt 380)
 - Project and construction manager Gogo Heinrich
 - Contractor John Plane Construction
 - Budget \$157,544
 - Schedule
 - Construction Jun – mid Aug 2011

Projects in Construction

- Can 12kV Electrical Infrastructure Replacement (Pjt 359)
 - Project manager Mary Ann Duggan
 - Construction manager Linda Rizzoli
 - Contractor BN Builders
 - Project web page
 - http://www.smccd.edu/accounts/smccd/departments/facilities/CAN_ElectInfr.shtml
 - Budget \$3,695,600
 - Schedule
 - Construction Jul 2011 - Feb 2012

Projects in Construction

- CSM B34 Tenant Improvement (Pjt 458E)
 - Project manager Michele Rudovsky
 - Construction manager Christine Tai
 - Contractor Pankow
 - Project web page
 - http://www.smccd.edu/accounts/smccd/departments/facilities/CSM_B12151734Mod_01.shtml
 - Renderings
 - <\\appserv2\DisCIP2\Projects\458 CSM B12, 15, 17, 34 Modernization\Design\Building 34\3. Design Development\CSM B34 Exterior Improvements\CSM B34 Photos for Rendering\CSM B34 Rendering Fair Fieldstone GAbbey Roof WestElev1.jpg>
 - Budget \$3,211,000
 - Schedule
 - ITS Occupancy July 18, 2011
 - Receiving Occupancy August 15, 2011
 - Fire Tech Occupancy August 15, 2011

Projects in Construction

- Hillsdale Parking Lot Repairs and Improvements (Pjt 458H)
 - Project manager Michele Rudovsky
 - Construction manager Christine Tai
 - Contractor Pankow
 - Project web page
 - http://www.smccd.edu/accounts/smccd/departments/facilities/CS_M_B12151734Mod_01.shtml
 - Budget \$3,044,626
 - Schedule
 - Upper lot Occupancy end June 2011
 - Lower lot Occupancy end July 2011

Projects in Construction

- CSM North Gateway Phase 1 (Pjt 453L)
 - Project manager Karen Powell
 - Construction manager Sajid Sulaiman
 - Contractor Robert A. Bothman
 - Project web page
 - http://www.smccd.edu/accounts/smccd/departments/facilities/CSM_NorthGateway_01.shtml
 - Budget \$2,300,000
 - Schedule
 - Construction Dec 2010 - Sep 2011

Projects in Construction

- Sky 12kV Electrical Infrastructure Load Center 2 Replacement (Pjt 253)
 - Project manager Mary Ann Duggan
 - Construction manager Mony Thach
 - Contractor John Plane Construction
 - Project web page
 - http://www.smccd.edu/accounts/smccd/departments/facilities/SKY_LC2.shtml
 - Budget \$1,420,600
 - Schedule
 - Construction Jul 2011 - Jan 2012

Projects About to Field

- CSM North Gateway Part 2 (Pjt 453A)
 - Project manager Karen Powell / Karen Pinkham
 - Construction manager Sajid Sulaiman
 - Contractor Schembri Construction
 - Project web page
 - http://www.smccd.edu/accounts/smccd/departments/facilities/CSM_NorthGateway_02.shtml
 - Budget \$15,737,724
 - Schedule
 - Construction Sep 2011 – Dec 2012
 - Lawsuit filed by Citizens for a Green San Mateo

Projects About to Field

- CSM Edison Parking Lot(Pjt 452U)
 - Project manager Barry Chin
 - Construction manager ??
 - Contractor McCarthy Building Companies
 - Budget \$3,000,000
 - Schedule
 - Construction ~~Jul 2011 – Oct 2011~~ (*delayed*)
 - Lawsuit filed by Friends of the Garden

Questions & Answer

José D. Nuñez, LEED® AP

Vice Chancellor

Facilities Planning, Maintenance & Operations

(650) 574-6512

nunezj@smccd.edu