

NO.	DESCRIPTION	DATE
1001	SCHEMATIC DESIGN	04/20/08
1002	50% DESIGN DEVELOPMENT	06/13/08
1003	SUBMITTAL	07/23/08
1004	CONSTRUCTION DEVELOPMENT	07/23/08
1005	CONSTRUCTION DEVELOPMENT	10/10/08
1006	CONSTRUCTION DEVELOPMENT	10/10/08
1007	CONSTRUCTION DEVELOPMENT	11/11/08
1008	CONSTRUCTION DEVELOPMENT	11/11/08
1009	CONSTRUCTION DEVELOPMENT	12/23/08
1010	CONSTRUCTION DEVELOPMENT	02/03/09
1011	CONSTRUCTION DEVELOPMENT	04/20/09
1012	CONSTRUCTION DEVELOPMENT	05/12/09
1013	CONSTRUCTION DEVELOPMENT	06/10/09
1014	CONSTRUCTION DEVELOPMENT	08/12/09
1015	CONSTRUCTION DEVELOPMENT	12/27/10

RECORD DRAWINGS

ISSUED TO FIELD

DATE: 08/12/09

BY: [Signature]

PROJECT: SKYLINE COLLEGE

FILE # 41-C1

DATE: APRIL # 01-110117

FILE # 41-C1

DATE: \_\_\_\_\_

AC: \_\_\_\_\_

SSS: \_\_\_\_\_

DATE: \_\_\_\_\_

IDENTIFICATION STAMP

**Increment 3**

**SKYLINE COLLEGE**  
 SAN MATEO COUNTY  
 SAN MATEO COLLEGE  
 DISTRICT

**CIP2 DESIGN-BUILD**  
**PROJECT**  
**BUILDING 4**  
**INCREMENT 3**

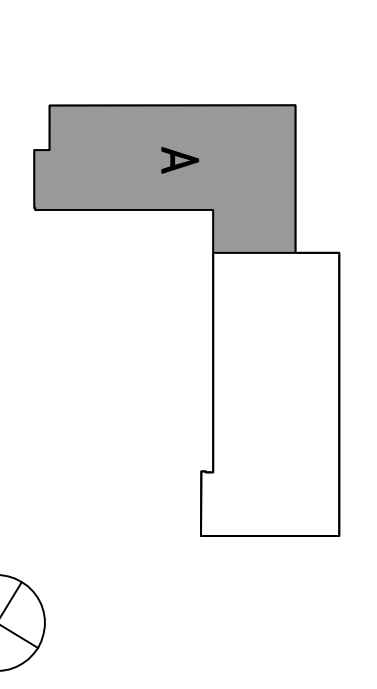

PROJECT NO: SP1057010  
 DRAWN BY: JB  
 DATE: 04/28/08  
 CHECKED BY: ALS  
 SCALE: 1/8"=1'-0"

**ELECTRICAL**  
**ROOF**  
**POWER AND SIGNAL**  
**PLAN**

SHEET NO: **E-304**

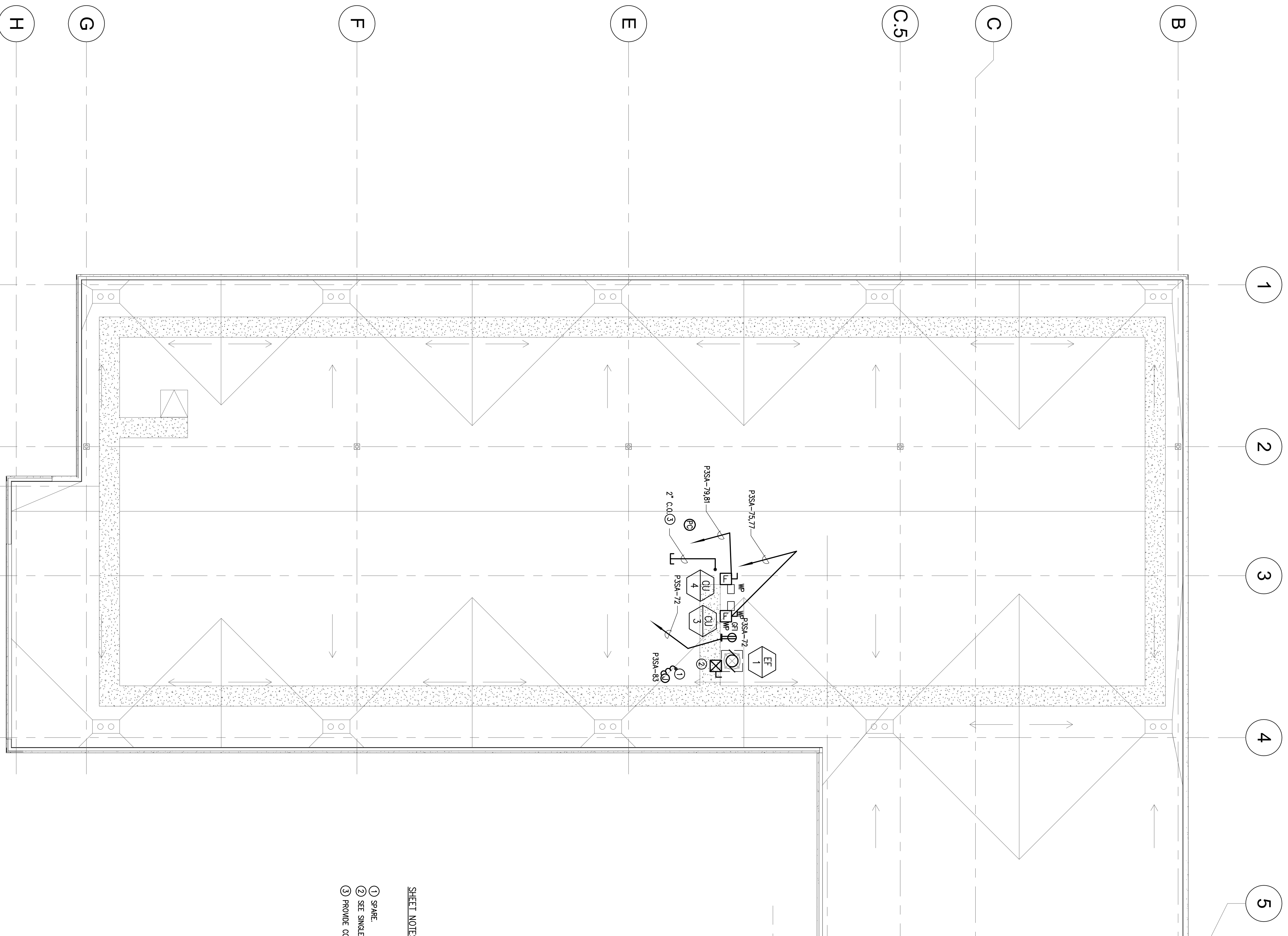

- SHEET NOTES**
- 1) SPINE
  - 2) SEE SINGLE LINE DIAGRAM
  - 3) PROVIDE CONDUIT SIZE-OUT FOR FUTURE SATELLITE DATA CABLES. COORDINATE LOCATION IN FIELD.

**ROOF PLAN - POWER AND SIGNAL PLAN**

SCALE: 1/8"=1'-0"

All drawings and written material, including but not limited to, shall be the property of the Architect and shall remain the property of the Architect. No part of this drawing shall be reproduced or transmitted in any form or by any means, electronic, mechanical, photocopying, recording, or by any information storage and retrieval system, without the prior written permission of the Architect.

This drawing is not to be used for any other project without the prior written permission of the Architect. The Architect shall not be responsible for any errors or omissions in this drawing.