

KRUGER BENSEN ZIEMER ARCHITECTS, INC.
 30 W. ARRELLA
 805/963.1725 SANTA BARBARA, CA 93101

STEVE DOWTY, A.I.A.
 PRINCIPAL IN CHARGE

GERALD SHUSTA
 PROJECT ARCHITECT

DALAN ENGINEERING, INC.
 ELECTRICAL ENGINEERS
 DALAN JOB No AA181
 8638 DARBY AVENUE (714) 771-4221
 NORTHIDGE, CA. 91325 (805) 684-4944
 (818) 772-2220 FAX (818) 772-2239

DEMOLITION NOTES:

- COORDINATE WITH CAMPUS REPRESENTATIVE, PRIOR TO REMOVAL WORK AND ANY WIRE (EXTENSIVE)
- PROTECT EXISTING CONDUIT, WIRES, DEVICES, EQUIPMENT TO REMAIN.
- REMOVE CONDUIT, WIRES, DEVICES IN WALLS TO BE DEMOLISHED, REMOVE CONDUIT AND WIRE BACK TO PERVIOUS DEVICE AND SAVE OFF CONDUCTOR, MAINTAIN CONTINUITY OF EXISTING CIRCUITS.
- COORDINATE DEMOLITION WITH OTHER TRADE. MAINTAIN EXISTING POWER TO EXISTING EQUIPMENT TO REMAIN.
- CONTRACTOR TO RE-TYPE PANEL INDEX CARD FOR ALL PANELS.
- MARK ANY EXISTING CIRCUIT DEMOLISHED AND NOT REUSED (SHOWN AS NEW IN PANEL SCHEDULE) OR SERVING OTHER EXISTING OUTLETS, AS "SPARE" IN RE-TYPED INDEX CARD.

DOTTED LINE INDICATES BOUNDARIES OF NEW REMODEL WORK. REFER TO SPECIAL KEY NOTES FOR SCOPE OF:
 a) EXISTING EQUIPMENT TO BE PROTECTED.
 b) AREAS OF LIGHTING DEMOLITION.
 c) AREAS OF POWER DEMOLITION.

NOTES

- ELECTRICAL PANELS SHOWN HERE ARE TO REMAIN.
- DISCONNECT & REMOVE EXISTING LIGHTING ONLY IN AREAS WHERE NEW LIGHTING IS TO BE INSTALLED.
- EXISTING LIGHTING & POWER & ANY ELECTRICAL DEVICES TO REMAIN IN THIS AREA.
- DISCONNECT & REMOVE ALL FLOOR/WALL POWER, DATA & SURFACE RACEWAY IN THESE AREAS. REMOVE ALL CONDUCTORS TO PANELBOARD OF ORIGIN. REMOVE ALL DATA/VOICE CABLES TO ORIGINATING SOURCE (EQUIPMENT RACK IN ROOM 2122).
- PROTECT EXISTING DATA & POWER CABLE TRAY MOUNTED UNDER CEILING INSTALLED DURING PHASE ONE.
- PROTECT EXISTING LIGHTING CIRCUITS (CL1A-4,6,9) AND DISTRIBUTION CONDUIT & J-BOXES FOR EXISTING LIGHTING IN THIS AREA. THE EXISTING HOMERUN & LIGHTING CIRCUITS SHALL BE RE-USED FOR CONNECTION OF NEW LIGHTS.
- DISCONNECT AND REMOVE EXISTING FLOOR MOUNT DATA RACKS AND TURN OVER TO MR. OMER THOMPSON AT SKYLINE'S TELECOMMUNICATIONS TECHNOLOGY DEPARTMENT. (TELE: 650-738-4341)
- DISCONNECT AND REMOVE EXISTING FLOOR MOUNT DATA RACK AND ASSOCIATED PULL BOX ON THE COLUMN. CONTACT MR. MICHAEL MCNEIL @ SKYLINE COLLEGE FOR STORAGE INSTRUCTIONS (TELE: 650-738-405).
- PROTECT EXISTING HOMERUN TO CR1A-21,23,25, RELEASED CIRCUITS FROM RECEPTACLES ON THIS WALL CIRCUIT CR1A-21 SHALL BE EXTENDED TO NEW AUTOMATIC SLIDING DOOR. SEE DRAWING E-2.3

GENERAL NOTES:

- IN AREAS WHERE THERE NO ALTERATIONS INDICATED, THE EXISTING FACILITIES SHALL BE RETAINED IN SERVICE. IN CASE OF DOUBT, ASSUME THAT THE EXISTING ELECTRICAL WIRING IS TO REMAIN IN OPERATION THROUGHOUT THE CONSTRUCTION PERIOD AND THEREAFTER.

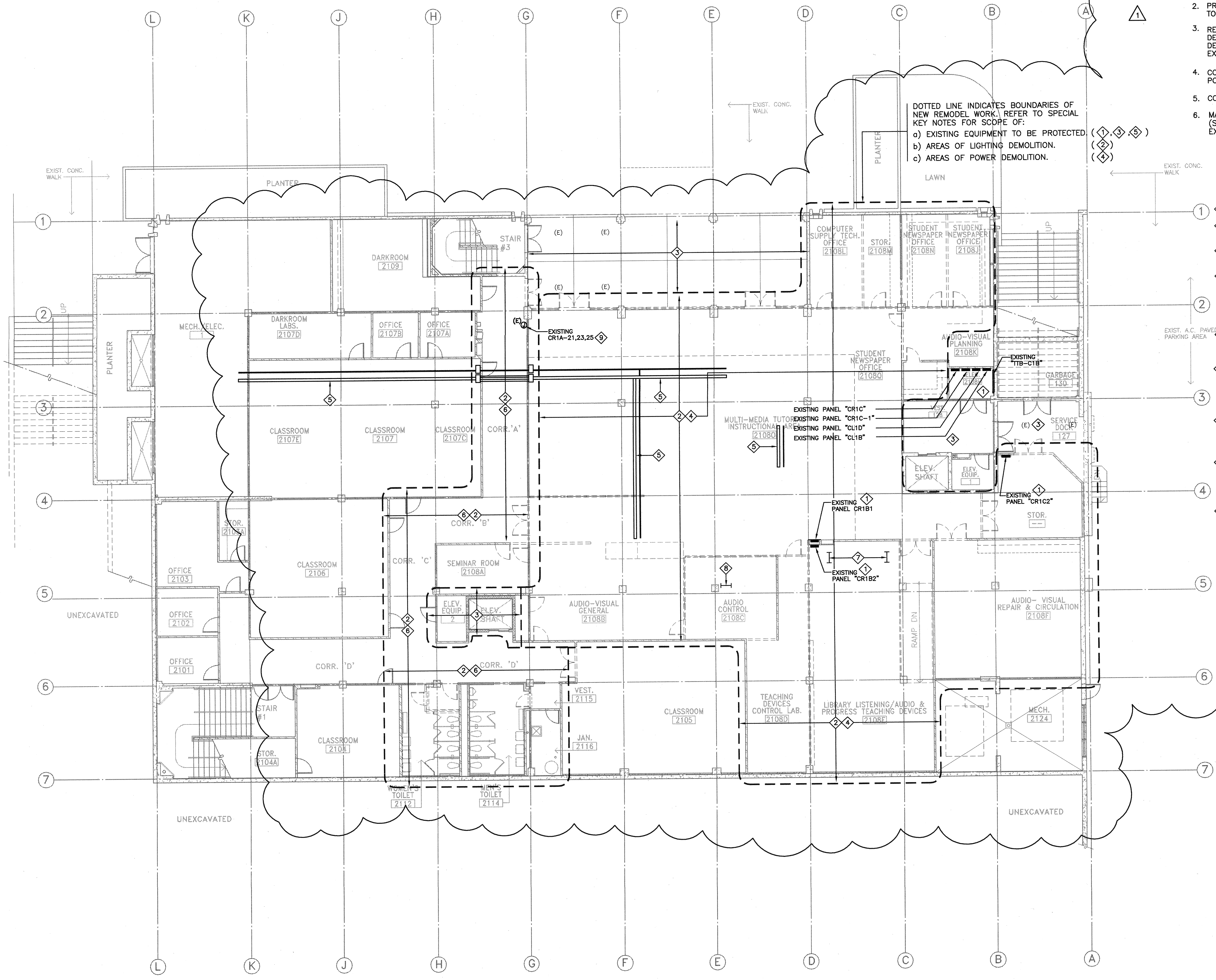

1 EXISTING FLOOR PLAN W/ DEMOLITION
 SCALE: 1/8"=1'-0"

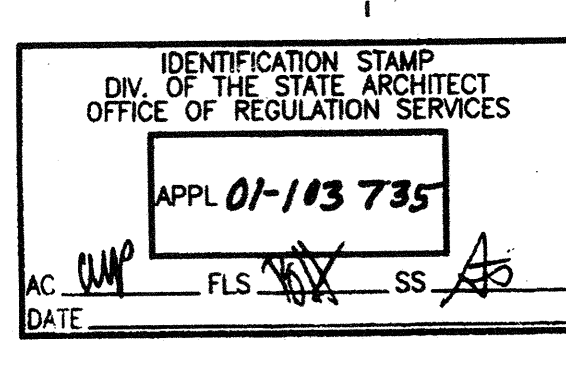
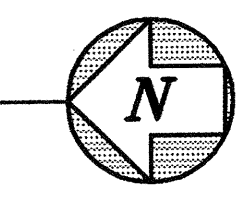

CENTER FOR ADVANCED LEARNING TECHNOLOGY
SKYLINE COLLEGE
 SAN MATEO COUNTY COMMUNITY COLLEGE DISTRICT
 SAN BRUNO, CALIFORNIA 94066
 3300 COLLEGE DRIVE

NO.	DESCRIPTION	DATE	BY
1	BID SET REVISIONS	10/25/01	
	DSA SUBMITTAL	06/15/01	

DRAWN	LOG
CHECKED DK	
DATE 03/21/01	
JOB NO. 98-03	
SHEET TITLE	
1ST FLOOR EXISTING CONDITIONS AND DEMOLITION PLAN	
SHEET	
E-1.2	