

2 LC 4 DEMOLITION
GO.03

DEMOLITION NOTES

1. Perform Selective Demolition as required to perform the work indicated on the Structural and Electrical Drawings. Repair concealed construction to match existing conditions adjacent.
2. Patch all abandoned penetrations neat and watertight.
3. Refer to Structural and Electrical drawings for additional requirements.
4. Remove concrete pads and attachments adjacent to Building 18 where existing electrical equipment is removed.

DEMOLITION KEYNOTES

- (D1) Remove existing concrete panels at roof of inner Load Center 4 vault. Store and protect for reinstallation. Reinstall concrete panels. Seal between panel joints and repair fluid-applied elastomeric coating system over the entire surface of panels removed and reinstalled as part of this project for a waterproof tie-in.
- (D2) Remove and reinstall metal gratings as required to remove existing electrical switchgear.
- (D3) Sawcut and remove portion of inner Load Center 4 vault wall for new conduit penetrations SSD.
- (D4) Sawcut parallel to stairs and remove section of concrete pavement to construct new point of entry for conduits through wall of outer Load Center 4 vault. Provide layout of pavement to be removed and replaced and obtain approval of Architect and District prior to proceeding. SSD for additional requirements. Seal joint between new slab and wall of Load Center.

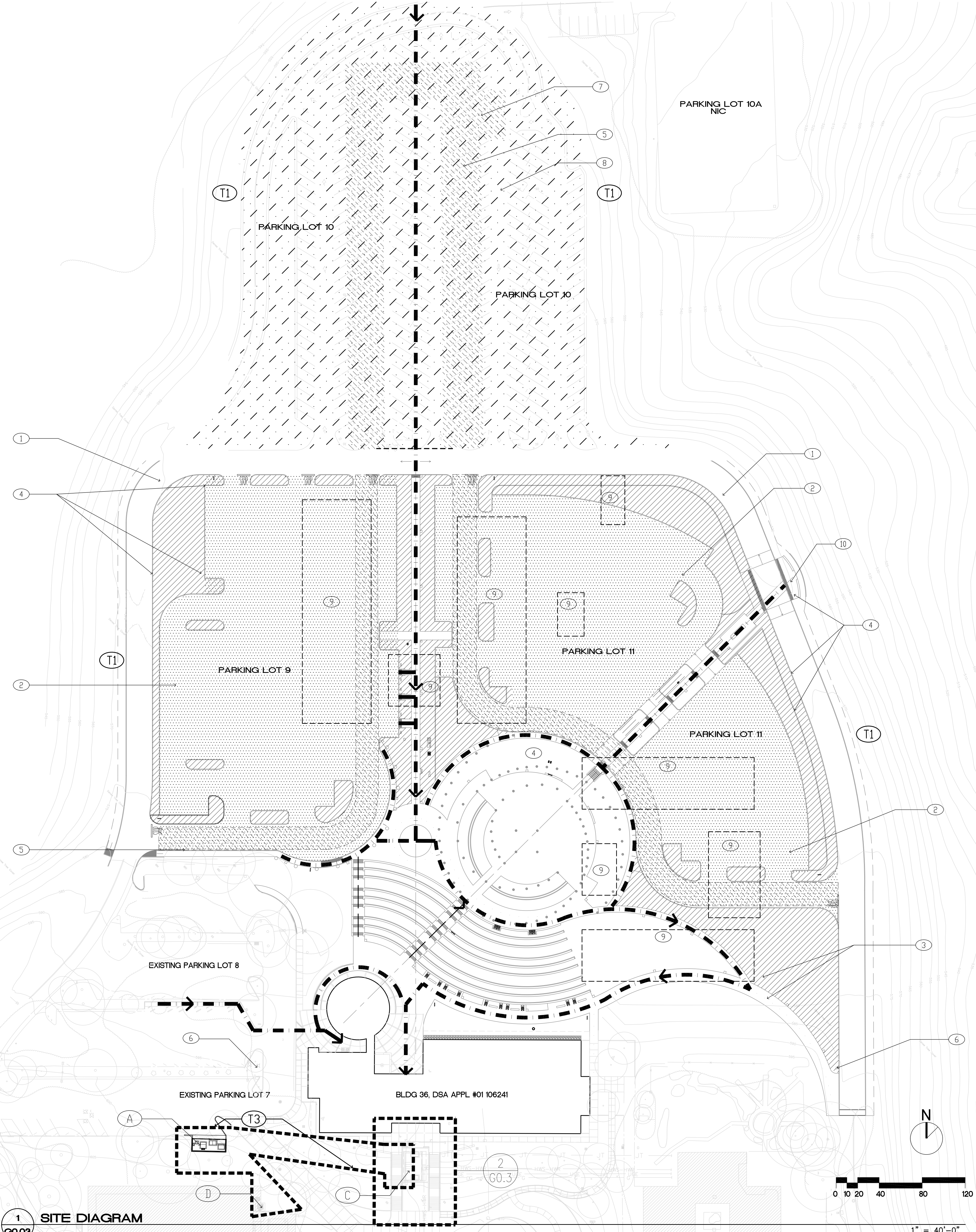

1 SITE DIAGRAM
GO.03

KEY NOTES:

- (A) LOAD CENTER 8
- (B) NOT USED
- (C) EXISTING LOAD CENTER 4 VAULT UNDERGROUND, SEE 8&10/S1.01
- (D) EXISTING TRANSFORMER AND SWITCHGEAR TO BE REMOVED

TREE NOTES

- (T1) REMOVE ALL DESIGNATED TREES IN THE INDICATED AREA AS LISTED IN SECTION 31-1300 - TREE PROTECTION AND TRIMMING - TREE REMOVAL AND PRUNING SCHEDULE. TREES ARE TAGGED ON SITE
- (T2) NOT USED
- (T3) STAKE AND OBTAIN APPROVAL FOR UTILITY TRENCHES PRIOR TO PROCEEDING. ROUTE TRENCHES OUTSIDE DRIPLINE OF EXISTING TREES

KEY NOTES N.I.C.:

- (1) EXISTING ROAD: TO BE OVERLAYED NEW AC, SEE CIVIL PLANS.
- (2) FINISH GRADE, PERMEABLE AGGREGATE BASE FOR EROSION CONTROL
- (3) RAMP & ACCESSIBLE PATHWAY FROM PLAZA TO LOWER LEVEL OF BUILDING 36
- (4) CURBS, PLANTERS, HARDSCAPE AND LANDSCAPING PER LANDSCAPE DRAWINGS
- (5) EMERGENCY VEHICLE ACCESS ROAD
- (6) (E) FIRE HYDRANTS
- (7) (N) FIRE HYDRANTS PHASE 1, SEE CIVIL DRAWINGS
- (8) LIGHTING FOR EMERGENCY VEHICLE ACCESS ROAD, SEE ELEC DWGS
- (9) BUILDINGS TO BE DEMOLISHED
- (10) VISTA AREA

NOTES:

PROPOSED IMPROVEMENTS ARE PART OF SEPARATE DSA APPLICATION UON
 WHERE PAVEMENT, LANDSCAPING, IRRIGATION, OR SITE IMPROVEMENTS ARE DAMAGED IN THE WORK AREA OR IN THE CONTRACTOR'S STAGING AND PARKING AREA, RESTORE IMPROVEMENTS TO THEIR ORIGINAL CONDITION

PHASE 1 LEGEND:

- LIMIT OF WORK BOUNDARY
- - - ACCESSIBLE PATH OF TRAVEL
- [Hatched Box] LANDSCAPE PLANTING N.I.C.
- [Dotted Box] EMERGENCY VEHICLE ACCESS ROAD N.I.C.
- [Stippled Box] PHASE 1 PERMEABLE AGGREGATE BASE COURSE N.I.C.
- [Diagonal Lines Box] FUTURE PHASE 3 UON N.I.C.

REVISIONS		
NO.	DATE	DESCRIPTION

DATE	FEBRUARY 24, 2012
DRAWN	DK
CHECKED	ML
SCALE	
JOB NO.	2805