

ADDENDUM	1/04	4/1/04
PRE-APPLICATION REVIEW	02/06/04	
ISSUED FOR PLAN CHECK	03/03/04	
ISSUED FOR PERMIT	03/03/04	
ISSUED FOR BID		
ISSUED FOR CONSTRUCTION		

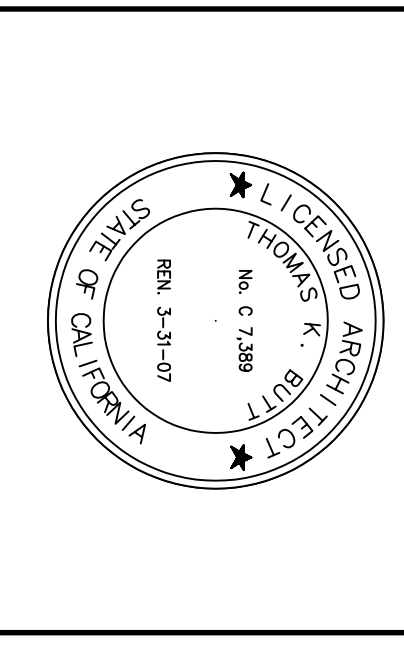

CONSULTANT:

INTERACTIVE
ARCHITECTURE • PLANNING • ENGINEERING
117 PARK PLACE
POINT RICHMOND
CALIFORNIA 94801
(916) 238-7435
(FAX) 238-5325
http://www.interactive.com

PROJECT:
BUILDING NO. 18
(NORTH HALL)
MODERNIZATION

SAN MATEO CO. COMMUNITY COLLEGE DISTRICT
1700 WEST HILLSDALE BLVD,
SAN MATEO, CA 94402

DR. GREGORIO SANCHEZ
OFFICE OF RESIDENTIAL SERVICES
APPL 106047
DATE: 1/3 SS

APPROVED
DATE: 1/3 SS

DR. OF THE STATE ARCHITECT
APPL 106047
DATE: 1/3 SS

BLDG 18 - SECOND FLOOR PLAN MODERNIZATION WORK

MOD

A2.3

SHEET NUMBER

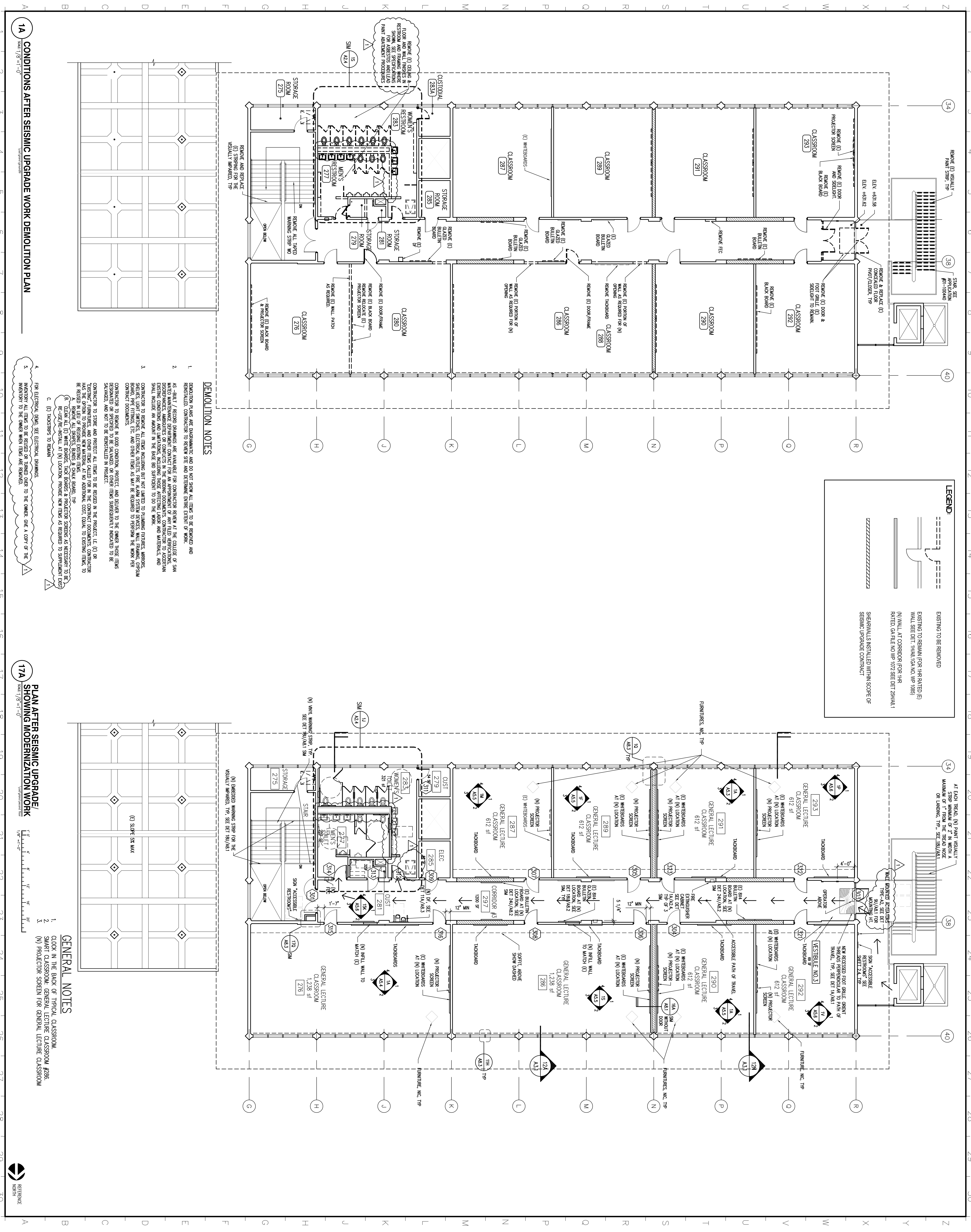

1A
CONDITIONS AFTER SEISMIC UPGRADE WORK DEMOLITION PLAN

17A
PLAN AFTER SEISMIC UPGRADE/SHOWING MODERNIZATION WORK