

2.7A PLAN AT LEVEL +687'-0" 1/4"=1'-0"

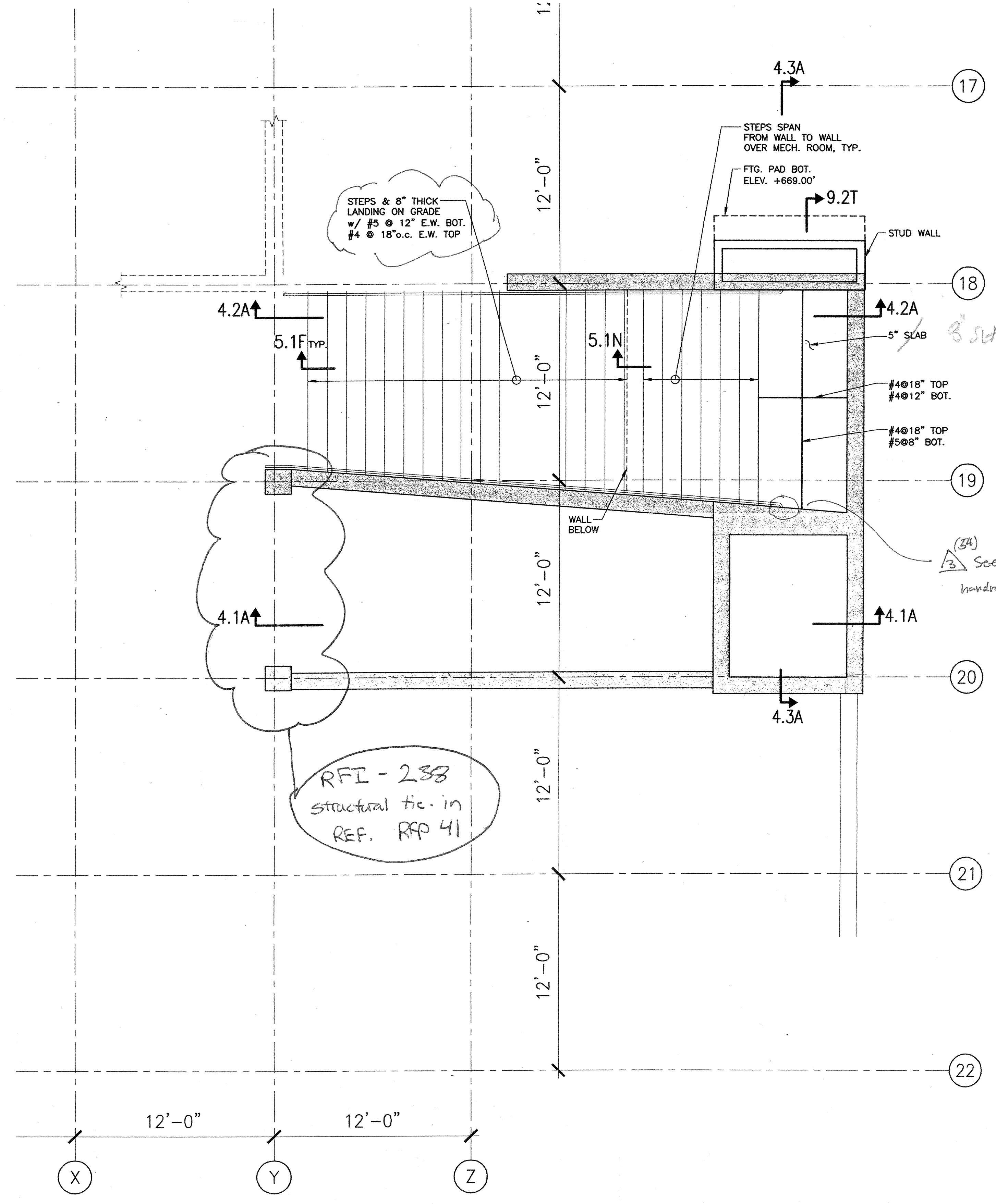

2.7B PLAN AT LEVEL +671'-0" 1/4"=1'-0"

12. Detail 2.7B/S2.7 shows an 8" thick landing on grade with #5 at 12" o.c. e.w. bot. and #4 at 18" o.c. e.w. top. However, detail 2.7B/S2.7 references detail 5.1F/S5.1 which shows a 6" thick landing with c.w. top. Detail 2.7B/S2.7 also references detail 5.1F/S5.1 which shows a 6" thick landing with #4 at 12" o.c. e.w.; a 12" slab; and an 8" wall not shown on detail 4.2A/S4.2. Nor does 5.1F/S5.1 show the transition from the landing to the stairs above. Please revise detail 5.1F/S5.1 to conform and continue in further detail the design shown in plan 2.7B/S2.7 and section 4.2A/S4.2.
 Response: Use landing and reinforcement shown on section A/S4.2, which clearly defines concrete reinforcing. See plan A/S2.6 and section A/S4.2 for locations of the walls below the stairs.

SHEET NOTES

- REFER TO ARCHITECTURAL AND MECHANICAL DRAWINGS FOR LOCATIONS OF EQUIPMENT, SIZE OF OPENING, CURB DETAILS.
- SEE GENERAL NOTES, EXISTING CONSTRUCTION DIVISION, ITEM "C" FOR NEW PENETRATIONS REQUIREMENTS.
- COORDINATE WITH ARCHITECTURAL DRAWINGS AND ELEVATOR VENDOR ALL DIMENSIONS AND ALL REQUIREMENTS PRIOR TO START OF CONSTRUCTION.
- FOR SAFETY BEAM SEE S.2N SIM.



architecture
planning
interiors

Bunton Clifford Associates, Inc.
210 Hammond Ave.
Fremont, California 94539
[T] 510.445.1000
[F] 510.445.1005
www.BCAincOnline.com

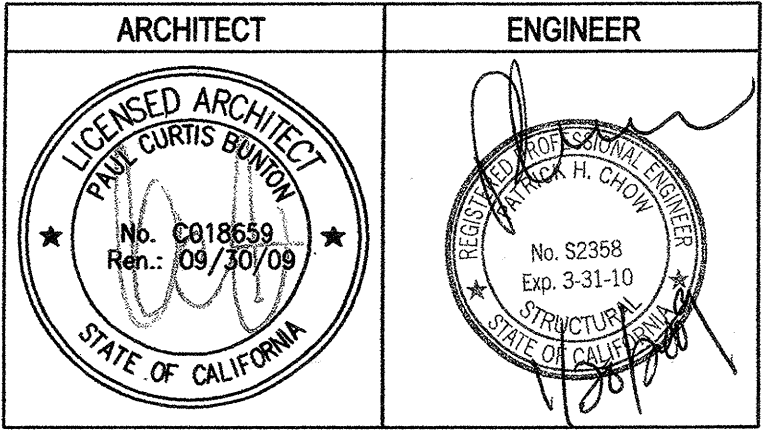

GENERAL NOTES
 1. This sheet is part of a set and is not to be used alone.
 2. This sheet is not to be used for construction unless the architect's stamp and signature appear on the drawings and the status box indicates drawings have been released for construction.
 3. These plans and prints thereof, as instruments of service, are owned by the architect and are for use on this project only. Reproduction and/or distribution without the prior written consent of the architect is forbidden.
 4. Copyright Bunton Clifford Associates, 2007.

REMARKS	DATE

PERFORMANCE HISTORY	DATE

FILE NO. 41-C1

IDENTIFICATION STAMP
 DIV. OF THE STATE ARCHITECT

01- 110074

AC _____ FLS _____ SS _____
 DATE **MAR 19 2008**

**BUILDINGS 5 & 6
RENOVATIONS**

San Mateo County Community
College District

DSA BACK-CHECK

CAÑADA COLLEGE
4200 Farm Hill Boulevard
Redwood City, CA 94061

EXTERIOR ELEVATOR
FRAMING PLANS

Date: 12/31/08
 Scale: AS NOTED
 Project Number: 07013

Drawing Number: **S2.7**