

CITY CLERK
CITY OF SAN MATEO
330 WEST TWENTIETH AVENUE
SAN MATEO, CALIFORNIA 94403

Exp. No. 10 ✓

SAN MATEO JUNIOR COLLEGE
DISTRICT
APR 6 2 03 PM '88

This is to certify that the interest in real property conveyed
by deed or grant dated January 28, 19 88
from SAN MATEO COUNTY COMMUNITY COLLEGE DISTRICT

to the City of San Mateo, California, a political corporation, and/or
Governmental Agency, is hereby accepted by the undersigned officer or
agent in behalf of the City Council of said City of San Mateo pursuant
to authority conferred by Resolution No. 154 (1977) of the said City
Council adopted on August 15, 1977, and recorded October 28, 1977, in
Volume 7643 at Page 435, Official Records of San Mateo County, and the
grantee consents to recordation thereof by its duly authorized officer

DATED: March 16, 19 88

88033635

Doris Christen
DORIS CHRISTEN, CITY CLERK

Govt. Entity Acquiring
Title - Tax Exempt
Effective 11-10-69
County Parcel APN 038-281-030
APN 038-281-040
APN 041-330-010

D1-88

I certify this to be a full, true and correct
copy of the document it purports to be as the
same is on file in my office

4-5-88
Doris Christen
City Clerk of the City of San Mateo

Gov Code Sec. 27281

88033635

RECORDING REQUESTED BY

And When Recorded Mail This Deed and, Unless Otherwise Shown Below, Mail Tax Statements To:

NAME City Clerk
STREET ADDRESS City of San Mateo
CITY 330 West 20th Avenue
STATE ZIP San Mateo, CA 94403

RF	
CO	
LN	
MF	
AF	
BR	

588

RECORDED AT REQUEST OF

City San Mateo

MAR 21 3 05 PM '88

WARREN SLOCUM RECORDER
SAN MATEO COUNTY
OFFICIAL RECORDS

SPACE ABOVE THIS LINE FOR RECORDER'S USE

Title Order No _____ Escrow No _____

DOCUMENTARY TRANSFER TAX \$ _____
COMPUTED ON FULL VALUE OF PROPERTY CONVEYED,
OR COMPUTED ON FULL VALUE LESS LIENS AND
ENCUMBRANCES REMAINING AT TIME OF SALE

Signature of Declarant or Agent determining tax: Firm Name

GRANT DEED

FOR A VALUABLE CONSIDERATION, receipt of which is hereby acknowledged,
San Mateo County Community College District

hereby GRANT(S) to the City of San Mateo, a municipal corporation,
right-of-way for street purposes upon, over, and across

the following described real property in the City of San Mateo
county of San Mateo, state of California:

*Governmental entity acquiring title
Tax exempt effective November 10, 1969*

as described in Exhibit A hereto.

SAN MATEO COUNTY COMMUNITY
COLLEGE DISTRICT

Dated January 28, 1988
STATE OF CALIFORNIA }
COUNTY OF San Mateo } SS
On January 28, 1988 before me, the under-
signed a Notary Public in and for said County and State,
personally appeared _____

William E Jordan

William E Jordan, President

PORTION OF W. HILLSDALE BLVD. AND CSM DR. (PARCEL A)

DESCRIPTION

Beginning at a point on the most southeasterly line of Parcel 1 as said Parcel is described in Final Order of Condemnation, filed November 18, 1958, in Book 3495 at page 4, San Mateo County Records, said point bears North 43°15' East 7.42 feet from a 1" iron pipe monument, said monument being the most Westerly corner of West Hillsdale Boulevard as shown on that certain map entitled "COLLEGE PORTAL PROPERTIES UNIT NO. 1, SAN MATEO, SAN MATEO COUNTY, CALIFORNIA" filed in the office of the County Recorder of said County on February, 1968 in Book 67 of Maps at Page 32; thence North 43°15' East 114.29 feet; thence North 78°17'18" West 56.13 feet; thence along the arc of a tangent curve to the right, having a radius of 39.50 feet and a central angle of 81°17'51", 56.05 feet to a point of cusp; thence North 69°38'34" West 34.23 feet; thence South 19°54'05" West 12.70 feet; thence along the arc of a tangent curve to the left, having a radius of 78.00 feet and a central angle of 24°13'23", 32.98 feet to the beginning of a non-tangent curve, a radial to said curve to the right, having a radius of 68.00 feet and a central angle of 65°58'53", 78.31 feet to the beginning of a reverse curve; thence along the arc of said curve to the left, having a radius of 375.00 feet and a central angle of 7°08'14", 46.71 feet to the beginning of a reverse curve; thence along the arc of said curve to the right, having a radius of 377.00 feet and a central angle of 51°46'53", 340.72 feet to the beginning of a compound curve; thence along the arc of said curve to the right, having a radius of 198.00 feet and a central angle of 19°29'01", 67.33 feet; thence North 46°33'45" West 165.94 feet to the beginning of a non-tangent curve, the radial to said beginning bears South 9°19'28" East; thence along the arc of said curve to the right, having a radius of 24.50 feet and a central angle of 30°16'08", 12.94 feet to a point of cusp; thence South 43°37'11" West 50.78 feet to the beginning of a non-tangent curve, a radial to said beginning bears North 71°40'28" East; thence along the arc of said curve to the right, having a radius of 24.50 feet and a central angle of 51°10'19", 21.88 feet to the beginning of a compound curve; thence along the arc of said curve to the right, having a radius of 124.50 feet and a central angle of 10°35'28", 23.01 feet; thence South 43°26'15" West 5.99 feet; thence along the arc of a tangent curve to the left, having a radius of 211.50 feet and a central angle of 52°04'59", 192.26 feet; thence South 8°38'44" East 177.47 feet; thence along the arc of a tangent curve to the right, having a radius of 211.50 feet and a central angle of 11°50'23", 43.70 feet to the beginning of a compound curve; thence along said curve to the right, having a radius of 9.50 feet and a central angle of 92°03'18" 15.26 feet to the beginning of a non-tangent curve, a radial to said beginning bears South 83°23'49" East; thence along the arc of said curve to the right, having a radius of 219.50 feet and a central angle of 32°43'47", 125.39 feet to a point on the Northeasterly line of Borel Avenue as shown on that certain map entitled "TRACT NO. 650 BAYWOOD PARK, SAN MATEO COUNTY, CALIFORNIA" filed in the office of the County Recorder of said County on January, 1952 in Book 34 of Maps at Page 24, said point bears South 64°57'02" East 289.76 feet from a 1" iron pipe monument, said monument being on the Northeasterly line of Lot 9 Block 8 of said map; thence along said Northeasterly line of Borel Avenue as shown on said map, South 64°57'02" East 38.58 feet; thence North 39°48'57" East 34.12 feet; thence along the arc of a tangent curve to the left, having a radius of 100.00 feet and a central angle of 11°19'23", 19.76 feet to the beginning of a compound curve; thence along the arc of said curve to the left, having a radius of 220.00 feet and a central angle of 37°08'18", 142.60 feet; thence North 8°38'44" West 180.94 feet; thence along the arc of a tangent curve to the right, having a radius of

88033635

119.50 feet and a central angle of $42^{\circ}43'15''$, 89.10 feet to the beginning of a compound curve; thence along the arc of said curve to the right, having a radius of 103.50 feet and a central angle of $61^{\circ}18'31''$, 110.75 feet; thence South $84^{\circ}36'58''$ East 10.00 feet; thence along the arc of a tangent curve to the right, having a radius of 50.50 feet and a central angle of $18^{\circ}50'55''$, 16.61 feet to the beginning of a compound curve; thence along the arc of said curve to the right, having a radius of 103.50 feet and a central angle of $13^{\circ}16'21''$, 23.98 feet to the beginning of a reverse curve; thence along the arc of said curve to the left, having a radius of 423.00 feet and a central angle of $59^{\circ}22'49''$, 438.39 feet to the beginning of a reverse curve; thence along the arc of said curve to the right, having a radius of 220.00 feet and a central angle of $5^{\circ}15'16''$, 20.18 feet; thence North $73^{\circ}22'46''$ East 8.72 feet; thence along the arc of a tangent curve to the left, having a radius of 500.00 feet and a central angle of $3^{\circ}04'59''$, 26.91 feet to the beginning of a reverse curve; thence along the arc of said curve to the right, having a radius of 299.50 feet and a central angle of $19^{\circ}39'51''$, 102.79 feet to the point of beginning and containing 72528.7 square feet more or less.

Reserving therefrom a storm drain easement 10.00 foot in width, more particularly described as follows:

Commencing at a 1" iron pipe monument, said monument pipe being the most Westerly corner of West Hillsdale Boulevard as shown on that certain map entitled "COLLEGE PORTAL PROPERTIES UNIT NO. 1, SAN MATEO, SAN MATEO COUNTY, CALIFORNIA" filed in the office of the County Recorder of said County on February, 1968 in Book 67 of Maps at Page 32; thence North $43^{\circ}15'$ East 7.42 feet to a point of cusp; thence along the arc of a curve to the left, with a tangent bearing South $89^{\circ}57'38''$ west, a radius of 299.50 feet and a central angle of $18^{\circ}53'32''$, 98.76 feet to the True Point of Beginning; thence along the arc of a tangent curve to the left, having a radius of 299.50 feet and a central angle of $0^{\circ}46'19''$, 4.04 feet to the beginning of a reverse curve; thence along the arc of said curve to the right, having a radius of 500.00 feet and a central angle of $0^{\circ}53'47''$, 7.82 feet; thence North $13^{\circ}14'22''$ East 64.91 feet to the beginning of a non-tangent curve, a radial to said beginning bears North $20^{\circ}46'24''$ West; thence along the arc of said curve to the right having a radius of 375.00 feet and a central angle of $0^{\circ}05'00''$, 0.55 feet to the beginning of a reverse curve; thence along the arc of said curve to the left, having a radius of 68.00 feet and a central angle of $10^{\circ}23'01''$, 12.32 feet thence South $13^{\circ}14'22''$ West 66.60 feet to the True Point of Beginning.

Also reserving therefrom a sanitary sewer easement 10.00 foot in width the centerline of which is more particularly described as follows;

Commencing at a 1" iron pipe monument, said pipe monument being on the Northeastly line of Lot 9 Block 8 as shown on that certain map entitled "TRACT NO. 650 BAYWOOD PARK, SAN MATEO COUNTY, CALIFORNIA" filed in the office of the County Recorder of said County on January, 1952 in Book 34 of Maps at Page 24, thence along the Northeastly line of Block 8 and Borel Avenue as shown on said map, South $64^{\circ}57'02''$ East 303.17 to the Southerly terminus of said centerline; thence North $32^{\circ}20'39''$ East 59.14 feet; thence North $46^{\circ}24'18''$ East 64.33 feet to a point on the Easterly line of afore described Parcel A, said point being the Northerly terminus of said centerline.

The Southerly termination of said easement shall be the Northeastly line of Borel Avenue as shown on said Baywood Park map. The Northerly termination of said easement shall be the Easterly line of Parcel A.

EXHIBIT A

88033635

ACQUISITION DESCRIPTION AND DIAGRAM
CITY OF SAN MATEO, CALIFORNIA

PROJECT CSM Drive Dedication COUNTY ASSESSOR'S PARCEL NO. Listed Below
LOCATION College of San Mateo, City of San Mateo, CA
GRANTOR San Mateo County Community College District
GRANTOR'S ADDRESS 3401 CSM Drive, San Mateo, CA 94402
TYPE OF DEDICATION Grant Deed for Right-Of-Way for street purposes
PROPOSED USE OF LAND Public Street

SAN MATEO JUNIOR COLLEGE DISTRICT

APN 038-281-030
APN 038-281-040
APN 041-330-010

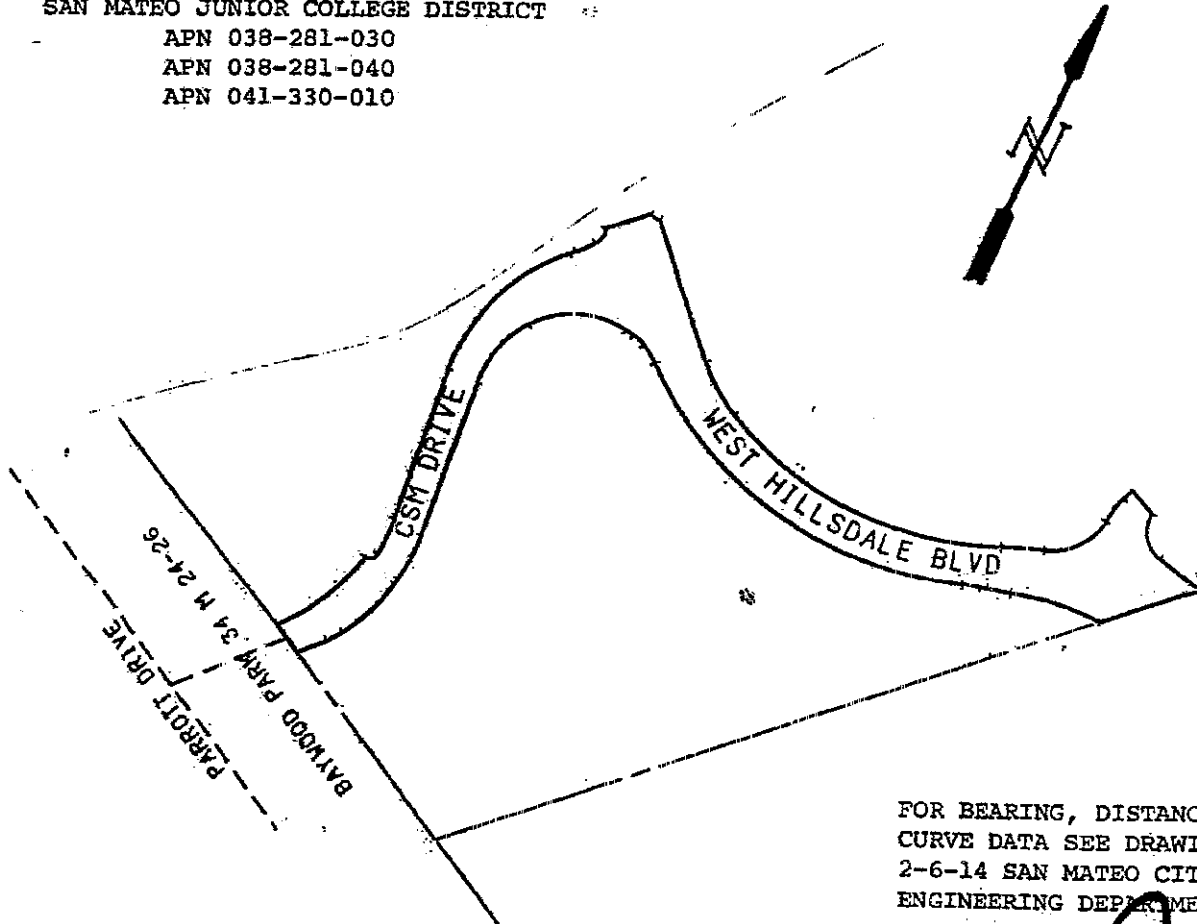

FOR BEARING, DISTANCE, AND
CURVE DATA SEE DRAWING NO.
2-6-14 SAN MATEO CITY
ENGINEERING DEPARTMENT FILES.

MAP:
Scale: Not to Scale
Prepared: BC
Checked: EB-D
Date: 3/14/88

Approved: *[Signature]*
Director of Public Works

Date: March 14, 1988

(Attach with Deed for Original Processing/Required by City Clerk to record properly).