

Burton Clifford Associates, Inc.
210 Hammond Ave.
Fremont, California 94539
T 510.445.1000
F 510.445.1005
www.BCAincOnline.com

Contract
Rene R Santos, PE
Project
2007-0009

INTERFACE
ENGINEERING

244 GRANT AVE., SUITE 450, SAN FRANCISCO, CA 94108
PHONE 415.499.7200 FAX 415.499.7899

ARCHITECT

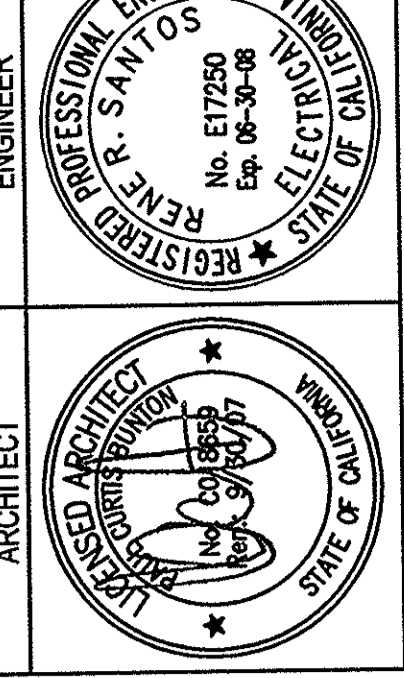

1. This sheet is not to be used for any other project.
2. All drawings and specifications are subject to change without notice and the architect's office shall be notified of any such changes.
3. All drawings and specifications are subject to the laws and regulations of the State of California and the local jurisdiction.
4. Copyright Burton Clifford Associates, 2007.

REVISIONS
DATE 6/19/07

NO.	DESCRIPTION	DATE
1	ISSUED FOR PERMITS	6/19/07
2	ISSUED FOR PERMITS	6/19/07
3	ISSUED FOR PERMITS	6/19/07
4	ISSUED FOR PERMITS	6/19/07
5	ISSUED FOR PERMITS	6/19/07
6	ISSUED FOR PERMITS	6/19/07
7	ISSUED FOR PERMITS	6/19/07
8	ISSUED FOR PERMITS	6/19/07
9	ISSUED FOR PERMITS	6/19/07
10	ISSUED FOR PERMITS	6/19/07
11	ISSUED FOR PERMITS	6/19/07
12	ISSUED FOR PERMITS	6/19/07
13	ISSUED FOR PERMITS	6/19/07
14	ISSUED FOR PERMITS	6/19/07
15	ISSUED FOR PERMITS	6/19/07
16	ISSUED FOR PERMITS	6/19/07
17	ISSUED FOR PERMITS	6/19/07
18	ISSUED FOR PERMITS	6/19/07
19	ISSUED FOR PERMITS	6/19/07
20	ISSUED FOR PERMITS	6/19/07

DATE 6/19/07

FILE NO.
DIV. OF THE STATE ARCHITECT

**FACILITIES
MAINTENANCE
CENTER**
San Mateo County Community
College District

**SITE
UTILITY
IMPROVEMENTS**

CAÑADA COLLEGE
4200 Farm Hill Boulevard
Redwood City, CA 94061

ELECTRICAL
SITE PLAN
BASE BID

Date 6/19/2007
Scale
Project Number 00018

GENERAL SHEET NOTES
A. COORDINATE JOINT TRENCH WITH CIVIL DRAWINGS WHERE APPLICABLE. CIVIL DRAWINGS INDICATE PATH FOR JOINT TRENCH.

- SHEET KEYNOTES**
- CONTRACTOR TO CLEAN (2) EXISTING 4" CONDUITS FOR FUTURE USE.
 - PROVIDE (1) 4" CONDUIT IN CONCRETE ENCASUREMENT FOR FUTURE ELECTRICAL TRAY FEEDER.
 - EXTEND (2) 4" CONDUITS FROM THE (E) COMMUNICATION PULLBOX AND PROVIDE PULLROPE FOR FUTURE CABLE BY OTHERS.
 - PROVIDE (2) 4" CONDUITS WITH PULLROPE FOR COMMUNICATIONS CABLING.
 - PROVIDE (1) 2" CONDUIT WITH PULLROPE FOR FIRE ALARM CABLING AND (2) 2" CONDUITS WITH PULLROPE FOR SPARES.
 - PROVIDE 30"x48" CONCRETE PULLBOX FOR ELECTRICAL FEEDER. PROVIDE ALL THE NECESSARY EXTENSIONS, LID AND COVER MARKED WITH "HIGH VOLTAGE" AS REQUIRED. CRUSHY, UTILITY VAULT OR EQUAL.
 - PROVIDE 17"-17"x30" CONCRETE PULLBOX FOR FIRE ALARM AND SPARE CONDUITS. PROVIDE ALL THE NECESSARY EXTENSIONS, LID AND COVER MARKED WITH "HIGH VOLTAGE" AS REQUIRED. CRUSHY, UTILITY VAULT OR EQUAL.
 - PROVIDE 36"x60"x48" DEEP PULLBOX FOR COMMUNICATIONS CONDUITS. PROVIDE ALL THE NECESSARY EXTENSIONS, LID AND COVER MARKED WITH "HIGH VOLTAGE" AS REQUIRED. CRUSHY, UTILITY VAULT OR EQUAL. VERIFY AND COORDINATE ALL WORK WITH THE DISTRICT COMMUNICATIONS ENGINEER PRIOR TO COMMENCEMENT OF WORK.
 - NOT USED.
 - EXISTING 4" UNDERGROUND CONDUITS FROM LOAD CENTER, "LC1" TO (E) MANHOLE ADJACENT TO CENTRAL PLANT ELECTRICAL ROOM.
 - TOP OF PULLBOX TO BE INSTALLED AT SAME HEIGHT AS FINISHED GRADE.

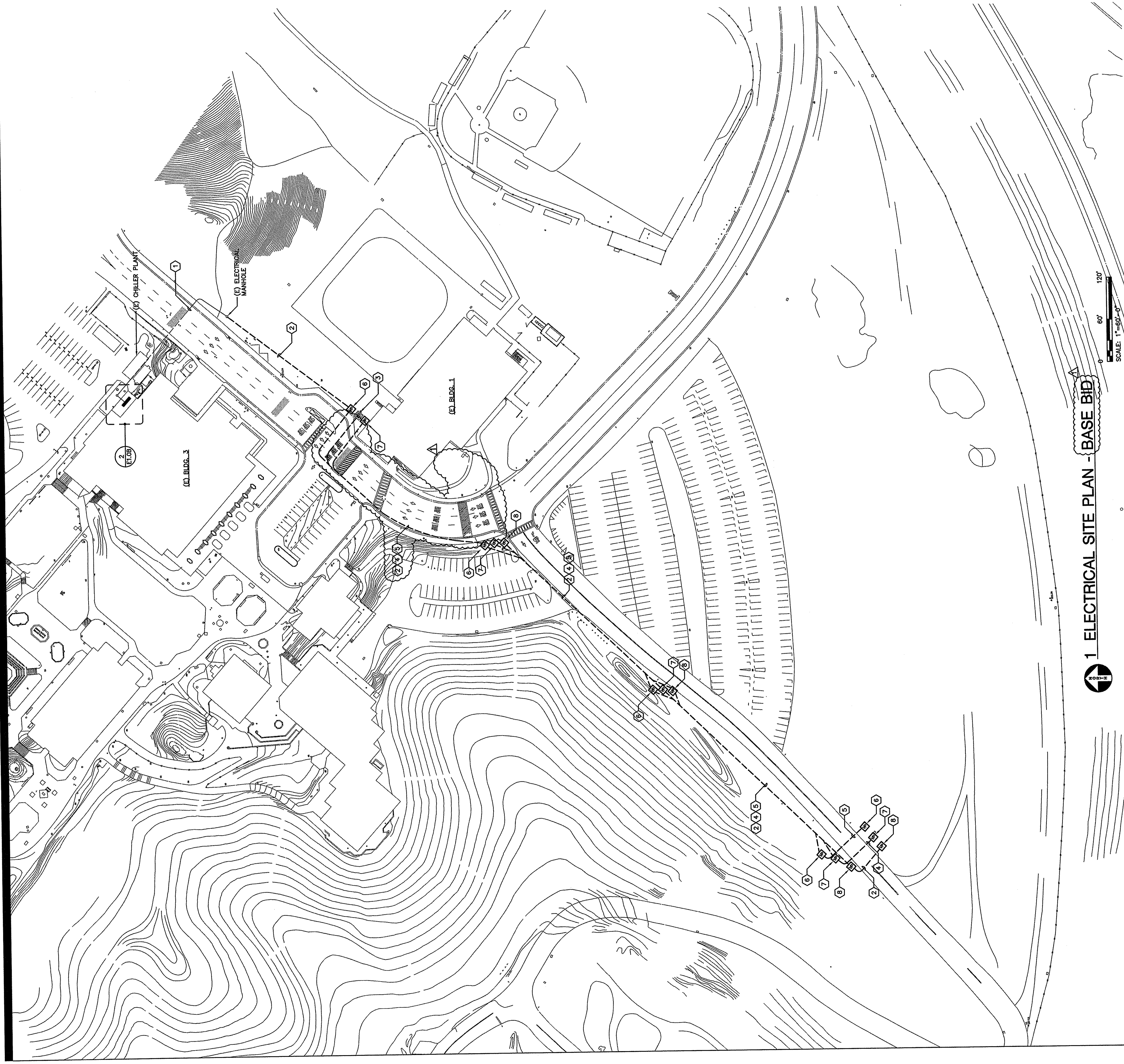

1 ELECTRICAL SITE PLAN - BASE BID

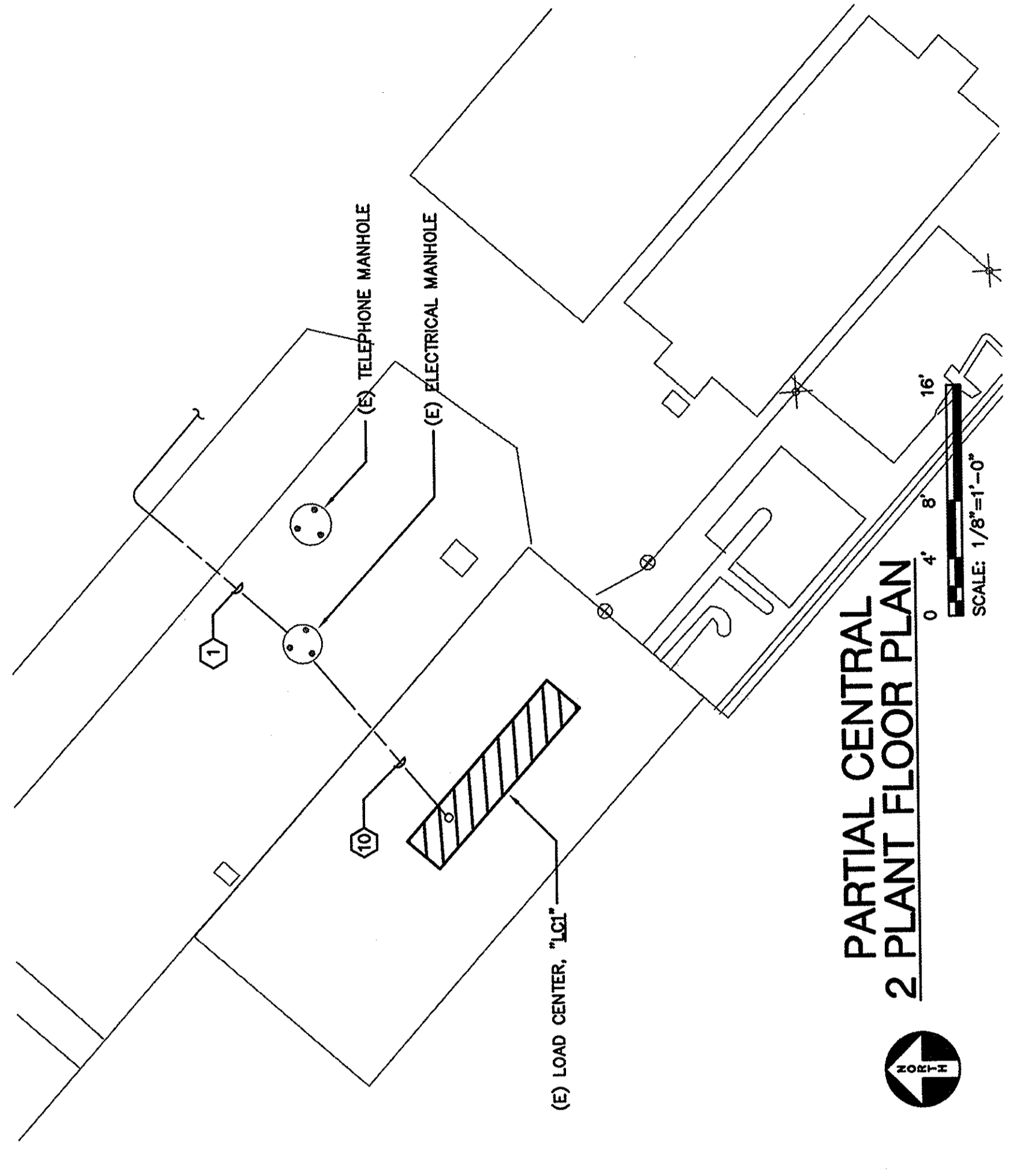

2 PLANT FLOOR PLAN