

THRUST BLOCK TABLE					
TYPE OF FITTING	.06" BEND & BURIES	45° BEND	22 1/2" BEND	11 1/4" BEND	TEE OR DEAD END
TYPICAL PLAN VIEW					
	REQUIRED BEARING TOTAL AREA IN SQUARE FEET				
Pipe Size	2.6	1.4	0.8	0.4	1.9
"4"	5.3	2.9	1.5	0.8	3.8
"6"	9.1	5.0	2.6	1.3	6.5
"8"	13.7	7.5	3.8	1.9	9.7
"10"	19.4	10.5	5.4	2.7	13.7

- THRUST BLOCK NOTES**
1. Thrust blocks to be constructed of 2500 Class 3 Caltrans concrete.
 2. Blocks to be poured against undisturbed soil.
 3. Joints to be kept free of concrete. Allow working room.
 4. Abrupt changes in vertical alignment shall be anchored per gravity block detail.
 5. Areas given are for PVC C900 class 200 pipe at a static test pressure of 200 psi in soil with 2,000 psf bearing capacity. Subject to field conditions.
 6. Tapping sleeves shall have thrust blocks sized the same as tees.



LEGEND

- CONCRETE PAVEMENT
- ASPHALT PAVEMENT
- MAINTENANCE PATHWAY

- SHEET NOTES:**
1. SEE MEP PLANS FOR CONTINUATION.
 2. FIRE SPRINKLER RISER, SEE PLUMBING DRAWING
 3. THRUST BLOCK, SEE DETAIL 1, THIS SHEET

Burton Clifford Associates, Inc.
 210 Hammond Ave.
 Fremont, California 94539
 [T] 510.445.1000
 [F] 510.445.1005
 www.BCAOnline.com

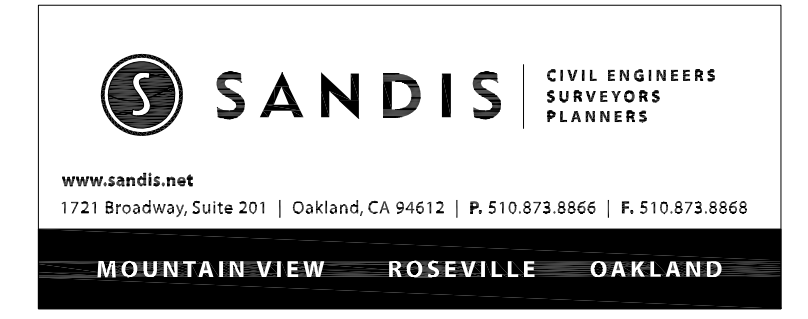

ARCHITECT	ENGINEER

- GENERAL NOTES**
1. This sheet is part of a set and is not to be used alone.
 2. This sheet is not to be used for construction unless the architect's stamp and signature appear on the drawings and the status box indicates drawings have been released for construction.
 3. These plans and prints thereof, as instruments of service, are owned by the architect and are for use on this project only. Reproduction and/or distribution without the prior written consent of the architect is forbidden.
 4. Copyright Burton Clifford Associates, 2007

REMARKS	DATE

- DRAWING STATUS**
- DSA PLAN CHECK
 - DSA BACK CHECK
 - BIDDING
 - CONSTRUCTION

FILE NO. _____
 IDENTIFICATION STAMP
 DIV. OF THE STATE ARCHITECT
 AC: _____ FLS: _____ SS: _____
 DATE: _____

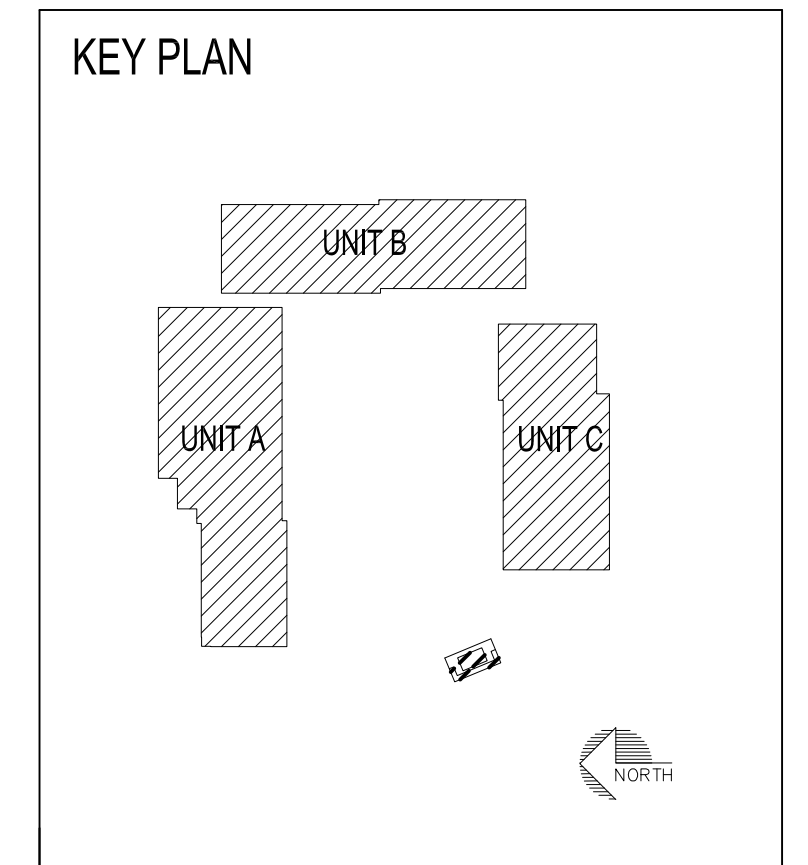

SKYLINE COLLEGE
 Facilities maintenance center
 3300 college drive
 SAN BRUNO,
 CALIFORNIA 94066

UTILITY PLAN

Date: 07/14/2008
 Drawing Number: C3.0
 Scale: AS NOTED
 Project Number: 06016