



SAN MATEO COUNTY
COMMUNITY COLLEGE DISTRICT

Facilities Planning & Operations 8th Annual General Session July 18, 2008



"Facilities Excellence"



Agenda

- FPO Department
- CIP
- M&O



"Facilities Excellence"

Guests

- Ron Galatolo
- Jim Keller
- Harry Joel
- Linda Da Silva
- Vicki Morrow
- Regina Stanback – Stroud
- Lori Adrian
- George Popyack
- Alan Miller
- Cristina Cruz
- Stephanie Bergren
- Larisa Howes
- Kanjana Srisupatopongsa



"Facilities Excellence"

Swinerton



- Jeff Gee
- Anne Daley
- Scott Adams
- Lisa Nagai
- Mark Eppard
- Rosemary Means
- Sajid Sulaiman
- Corina Mendoza
- Tobi Fenn
- Lilian Moujaes
- Peter Hempel
- Linda Rizzoli
- Avery Brundage
- Roxana Usner
- Tony Gupta
- Sandy Wong
- Zak Conway
- Tina Montano

"Facilities Excellence"

Retirees



"Facilities Excellence"

New Staff



- **Cañada College**
 - Tony Burrola – Custodian
 - Jesus Ceja – Groundskeeper
 - Joseph Puckett – Custodian
- **College of San Mateo**
 - John Rama King – Custodian
- **Skyline College**
 - Mohamad Baydoun – Custodian
 - Ke Tao Liu – Custodian
 - Qing “Linda” Liu – Custodian
- **District Office**
 - Devitt Hartney – Building Systems Engineer
 - Mike McGrew – Director of M & O
 - Dan Sarouhan – Project Manager

"Facilities Excellence"

Short-Term Employees

Ruben Pulido – CSM Groundskeeper

Armando Maldonado – Cañada Custodian



"Facilities Excellence"

Service Awards

- 20 Years
 - Hugh Wong
 - Jorge Ramirez
(retired Jan. 2008)



"Facilities Excellence"

Mission Statement

Ensure a safe, effective, and inspiring physical environment that supports and enhances the instructional mission of the San Mateo County Community College District



"Facilities Excellence"

Teamwork

team-work

Pronunciation: 'tEm-"work

Function: *noun*

Date: circa 1828

work done by a group of people with each doing a part but all working collaboratively towards a common goal



"Facilities Excellence"

Capital Improvement Program (CIP)



"Facilities Excellence"

Cañada College: Facilities Master Plan



"Facilities Excellence"

Cañada Bldg. 5, 6 & 8

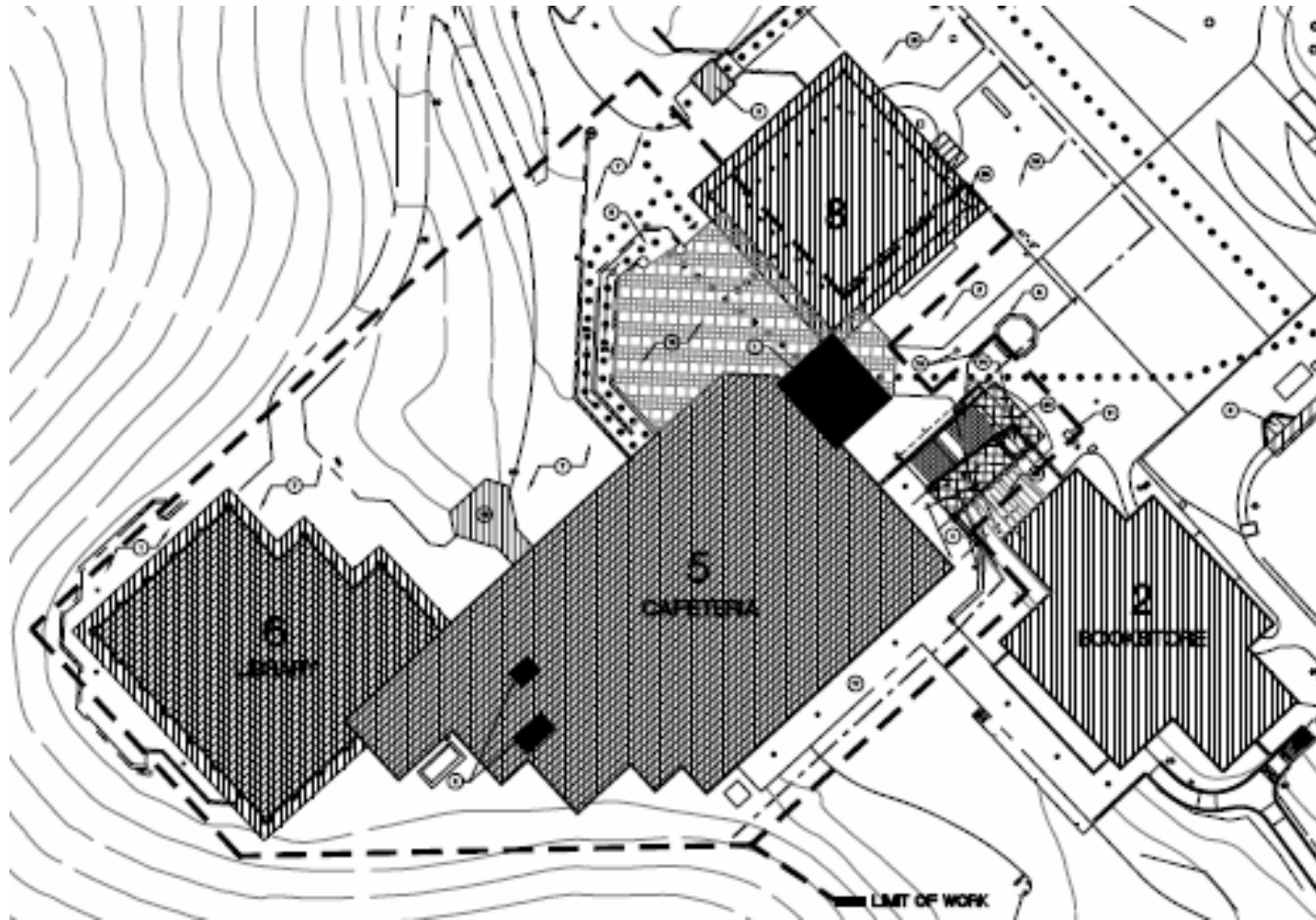

"Facilities Excellence"

Cañada Facilities Maintenance Center (FMC)



"Facilities Excellence"

Cañada College



"Facilities Excellence"

College of San Mateo: Facilities Master Plan



"Facilities Excellence"

College of San Mateo CIP2 Design Build



"Facilities Excellence"

College of San Mateo: Building 5N



04 Elevation - Northeast



05 Elevation - Northwest



06 Elevation - Southeast



07 Elevation - Southwest



"Facilities Excellence"

College of San Mateo: Building 10N



05 East Elevation
Scale 3/32" = 1'-0"



06 North Elevation
Scale 3/32" = 1'-0"



07 South and East Elevations



08 East and North Elevations

"Facilities Excellence"

College of San Mateo



"Facilities Excellence"

Skyline College: Facilities Master Plan



Figure 4.07

"Facilities Excellence"

Skyline College CIP2 Design Build



"Facilities Excellence"

Skyline Facilities Maintenance Center (FMC)



"Facilities Excellence"

Skyline College



"Facilities Excellence"

CIP2

- 2005 Measure A - \$468M
- Updated Master Plan
- Project Update
 - ▣ Cañada
 - ▣ CSM
 - ▣ Skyline

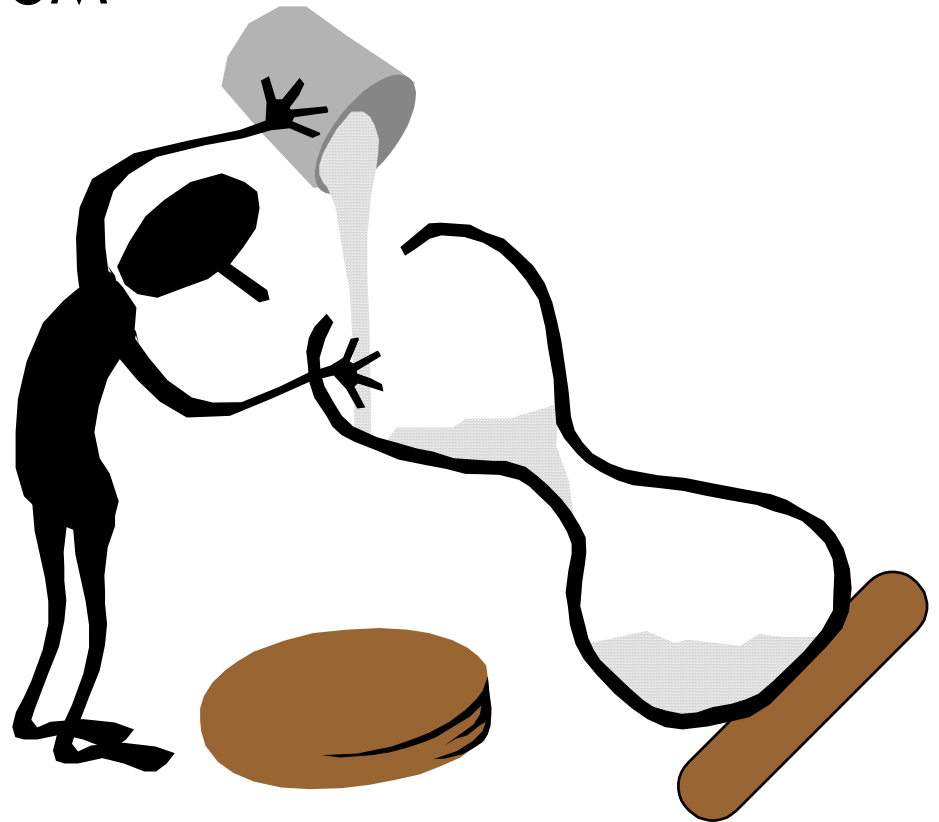

"Facilities Excellence"

CIP2: What does that mean to me?

- More utility shutdowns – planned & unplanned
- More construction traffic
- More dirt, dust, noise
- More controlled chaos
- More disruption to the educational mission



Major M&O Initiatives

- FEQN – did I miss something?
- Facilities Safety Task Force
- Staffing
 - more positions
 - Still not enough
- Budget – a bit more
- \$alary increases
- Facilities HelpCenter
- Unsung Heroes



"Facilities Excellence"

Mantra

Professionalism
Team Work
Customer Service
Communication

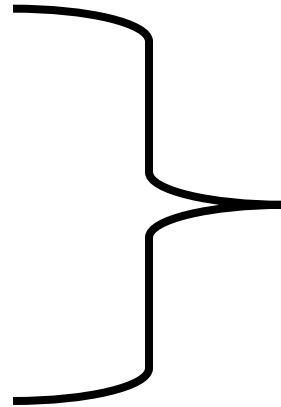

Facilities
Excellence



"Facilities Excellence"

