

WALL TYPE	STUD SIZE	BOARD # 1 TYPE / HT.	FINISH # 1 TYPE / HT.	BOARD # 2 TYPE / HT.	FINISH # 2 TYPE / HT.	NOTES
D	4"	WRGB / CLG HT.	CER TILE / 6" BELOW CLG	WRGB / CLG HT.	CER TILE / 6" BELOW CLG	RESTROOM PARTITION WALL
D1	4"	WRGB / CLG HT.	CER TILE / 6" BELOW CLG	-	-	RESTROOM FURRING WALL
D1A	4"	WRGB / CLG HT.	CER TILE / 6" BELOW CLG	GYP. BD. / FULL HT	PER FINISH SCHD	-
D1B	4"	WRGB / CLG HT.	CER TILE / 6" BELOW CLG	2 LAYERS OF GYP. BD.	PER FINISH SCHD	-
D2	4"	WRGB / CLG HT.	CER TILE / 6" BELOW CLG	-	-	SHOWER AREA FURRING WALL
D2A	4"	WRGB / CLG HT.	CER TILE / 6" BELOW CLG	GYP. BD. / FULL HT	PER FINISH SCHD	-
D3	4"	WRGB / CLG HT.	CER TILE / 6" BELOW CLG	WRGB / CLG HT.	CER TILE / 6" BELOW CLG	SHOWER PARTITION WALL
D4	2"	WRGB / CLG HT.	CER TILE / 6" BELOW CLG	-	-	RESTROOM CONC. FURRING GRAB BAR

ALL STUDS TO BE 18 GA (400S138-43)

**D RESTROOM WALL PARTITIONS**  
3" = 1'-0"

**C FULL HEIGHT 2/1 LAYER PARTITION**  
3" = 1'-0"

**B FULL HEIGHT DOUBLE LAYER**  
3" = 1'-0"

**A SINGLE LAYER GYP - WALL PARTITION**  
3" = 1'-0"

WALL TYPE	STUD SIZE	1ST LAYER OF 5/8" GWB HT.	2ND LAYER GWB / FINISHES HT.	NOTES
A	4"	FULL HT	N/A	
A1	4"	+6" ABOVE CEILING	N/A	
A2	6"	FULL HT	N/A	

\* NOTE:  
1. GYP. BD. TO BE CONTINUE TO UNDERSIDE OF STRUCTURE AT ALL AREAS WITHOUT CEILING  
2. ALL STUDS TO BE 18 GA (400S138-43, 600S138-43)

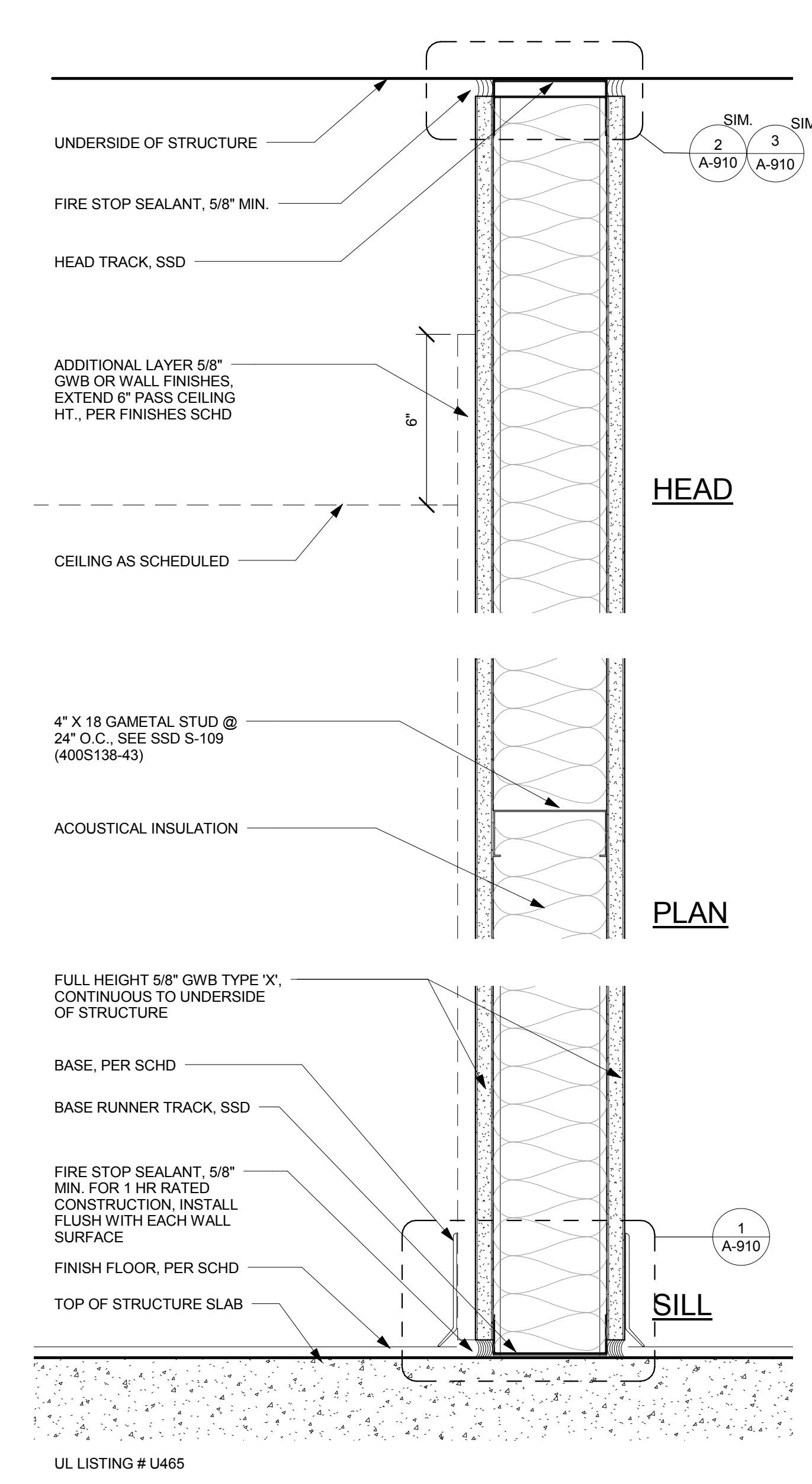
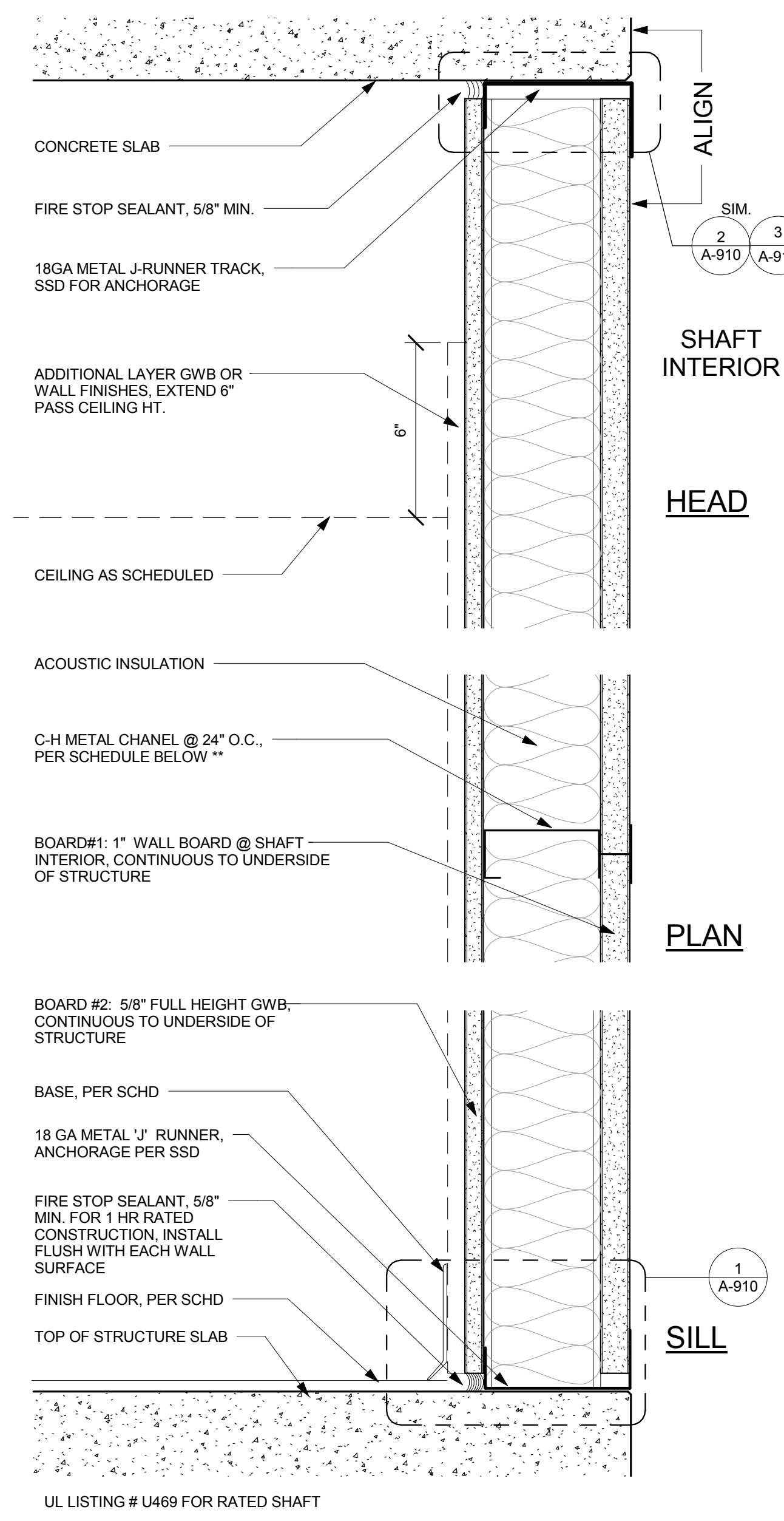

WALL TYPE	STUD SIZE	RATING	BOARD # 1 TYPE / HT.	BOARD # 2 TYPE / HT.	NOTES
H1	4"	60 MIN	1" GWB TYPE X / FULL HT	5/8" GWB TYPE X / FULL HT	
H2	4"	NON-RATED	1" GWB / FULL HT	5/8" GWB / FULL HT	
H3	8"	NON-RATED	1" GWB / FULL HT	5/8" GWB / FULL HT	
H4	6"	60 MIN	1" GWB / FULL HT	5/8" GWB / FULL HT	ELEVATOR SHAFT WALL

\*\* ALL STUDS TO BE 18 GA

UL LISTING # U469 FOR RATED SHAFT

UL LISTING # U465

WALL TYPE	STUD SIZE	1ST LAYER 5/8" GWB HEIGHT.	2ND LAYER GWB / FINISHES HT.	NOTES
E	4"	FULL HT	N/A	ONLY IN AREA W/O CLG
E1	4"	FULL HT	+6" ABOVE CEILING	
E2	7/8" HAT CHANNEL	+6" ABOVE CEILING	N/A	
E4	4"	+6" ABOVE CEILING	N/A	

ALL STUDS TO BE 18 GA (400S138-43)

**H SHAFT WALL PARTITION**  
3" = 1'-0"

**F FIRE RATED PARTITION**  
3" = 1'-0"

**E FURRING PARTITION**  
3" = 1'-0"