

FILE LOCATION: P:\2163.002\Permit Pkg 3\CAD\Arch\SKYLINE PK#3 CONFORM SET\Elec\030504E10.dwg
 LAST SAVED ON: 9/10/04 at 4:19pm, PLOTTED ON: 9/13/04 at 2:12pm

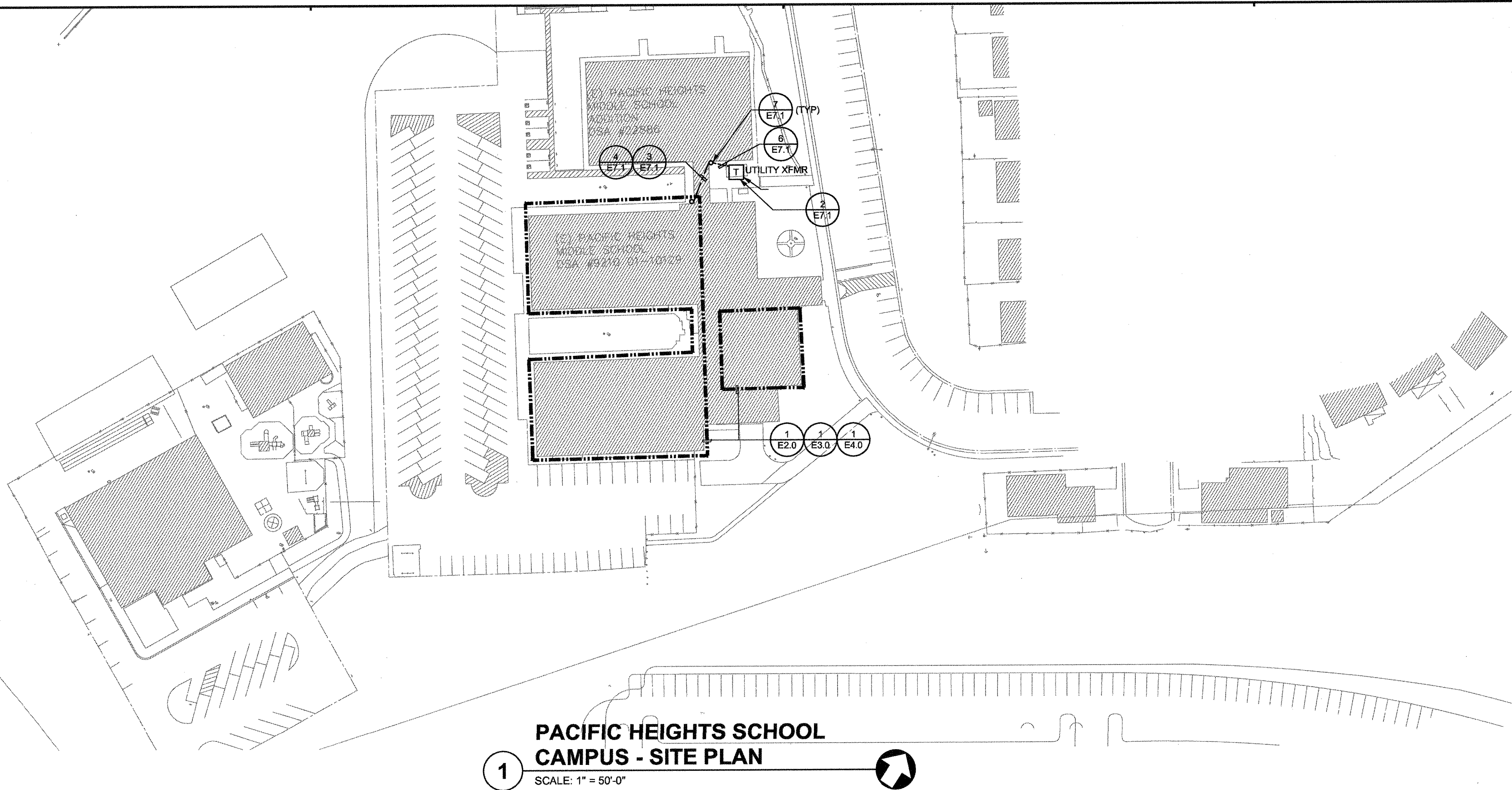

1 PACIFIC HEIGHTS SCHOOL
 CAMPUS - SITE PLAN
 SCALE: 1" = 50'-0"

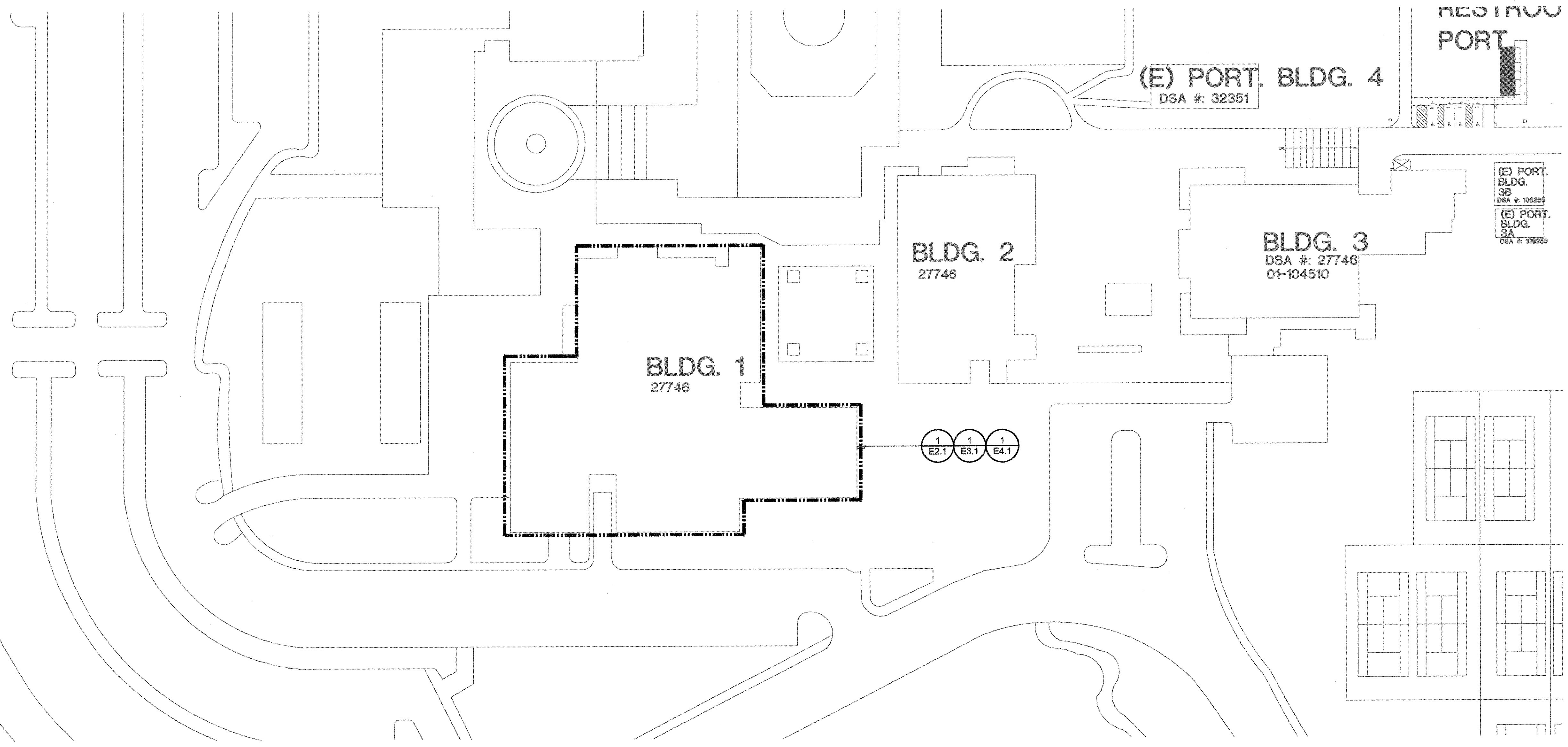

2 SITE PLAN - SKYLINE COLLEGE
 SCALE: 1" = 50'-0"

GENERAL NOTES

1. THE CONTRACTOR SHALL COORDINATE ALL ELECTRICAL SERVICE INSTALLATION AND/OR DEMOLITION WITH PG&E.
2. ALL PROVISIONS SHALL BE MADE TO DISCONNECT EXISTING SERVICE EQUIPMENT AND RECONNECT NEW SERVICE EQUIPMENT WITH MINIMAL POWER DISRUPTION.
3. COORDINATE EXACT LOCATIONS OF ALL ARCHITECTURAL, MECHANICAL, PLUMBING, LANDSCAPING AND CIVIL EQUIPMENT WITH ARCHITECTURAL, MECHANICAL, PLUMBING, LANDSCAPING AND CIVIL DRAWINGS.
4. ALL INCOMING SERVICE SITE WORK SHOWN IS PART OF ADD'L TERMITE #1.

SHEET NOTES

1. UTILITY XFMR AND XFMR PAD TO BE REPLACED. UTILITY XFMR PROVIDE BY PG&E AND XFMR PAD PROVIDE BY CONTRACTOR.

Sugimura & Associates Architects
 Architecture • Interiors
 Landscape Architecture
 2155 South Bascom Ave. Suite 200
 Campbell, CA 95008
 408-879-0600 Fx 408-377-6066
 COPYRIGHT © 2001 Sugimura & Associates/Architects

IPCAAS
 INTEGRATED DESIGN ASSOCIATES INC
 CONSULTING ELECTRICAL ENGINEERS
 3140 Via La Oca Boulevard, Suite 110
 San Ramon, CA 94583
 925-376-2800 FAX 925-376-2801

REGULATORY STAMP
 DIV. OF THE STATE ARCHITECTS
 OFFICE OF REGULATION SERVICES
 APP. NO. _____
 AC. _____
 DATE _____
 REGISTERED PROFESSIONAL ARCHITECT
 955 Clay St., Suite 1001
 Oakland, CA 94612

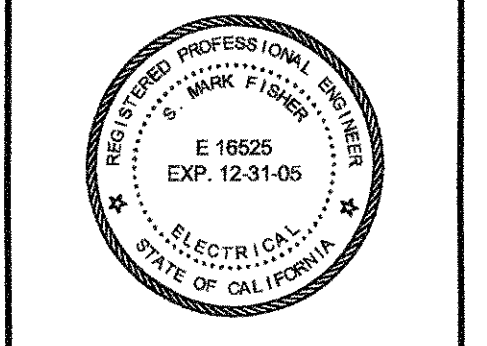

DSA SUBMITTAL - 02.13.04

PACIFIC HEIGHTS AND SKYLINE COLLEGE SITE PLANS
 SKYLINE COLLEGE SWING SPACE
 PERMIT PACKAGE #3
 SKYLINE COLLEGE
 3300 COLLEGE DRIVE
 SAN BRUNO, CA 94066

REVISIONS		
NO.	ITEM	DATE
1	CONSTRUCTION ISSUE	6/10/04

CLIENT APPROVAL:
 DRAWN BY: RCS
 CHECKED BY: SMF
 JOB NO: 2163.002 DATE: 5 FEB. 2004

E1.0
 OF SHEETS