

LEGEND	PLAN NOTES
◊ (N) DOOR, SEE SPECS	① (N) 6" CONCRETE PAD, SSD
▨ (N) 1 HOUR WALL-5/8" TYPE 'X' GYP. BD ON EACH SIDE OF 3-5/8" METAL STUDS. ABUSE RESISTANT GYP. BD UP TO 4'-0" FROM FLOOR	② (N) RETAINING WALL
	③ (E) CONCRETE PAD TO REMAIN
	④ REMOVE (E) ABANDONED VENT PIPE
	⑤ (N) TRENCH DRAIN
	⑥ REMOVABLE LOUVER & MULLION
	⑦ (N) FRP DOOR IN REMOVABLE FRAME
	⑧ RELOCATE ELEC. PANEL, SED
	⑨ (N) 1 HOUR WALL ON CONCRETE CURB
	⑩ (N) REMOVABLE RAIL, TYP.
	⑪ NOT USED
	⑫ (E) EXPANSION TANK ABOVE
	⑬ (N) CONCRETE SHEAR WALL, SSD
	⑭ (N) ROOF OPENING FOR FAN ABOVE
	⑮ (E) AREA DRAIN, SEE CIVIL DWGS
	⑯ (N) CONC. SEE CIVIL/STRUCT.
	⑰ (N) PUMP, SMD
	⑱ (N) TRANSFORMER, SED
	⑲ (E) SPRINKLER HEAD ABOVE, TYP. RELOCATE AS REQUIRED IN CONFORMANCE W/ CODE REQUIREMENTS

**SHEET NOTES**

1. PROVIDE FIRESTOPPING AT ALL NEW AND EXISTING PIPING, CONDUITS AND OTHER PENETRATIONS THROUGH FIRERESISTIVE RATED WALLS. SEE SHEET A4.0
2. ALL EXTERIOR EQUIPMENT INCLUDING COOLING TOWER, TRANSFORMER, SWITCHGEAR AND PIPING TO BE PAINTED.
3. SEE A2.0 FOR DOOR & ROOM SCHEDULES.
4. REMOVE AND RELOCATE (E) SPRINKLER HEADS WHERE NECESSARY ASSOCIATED WITH NEW WORK

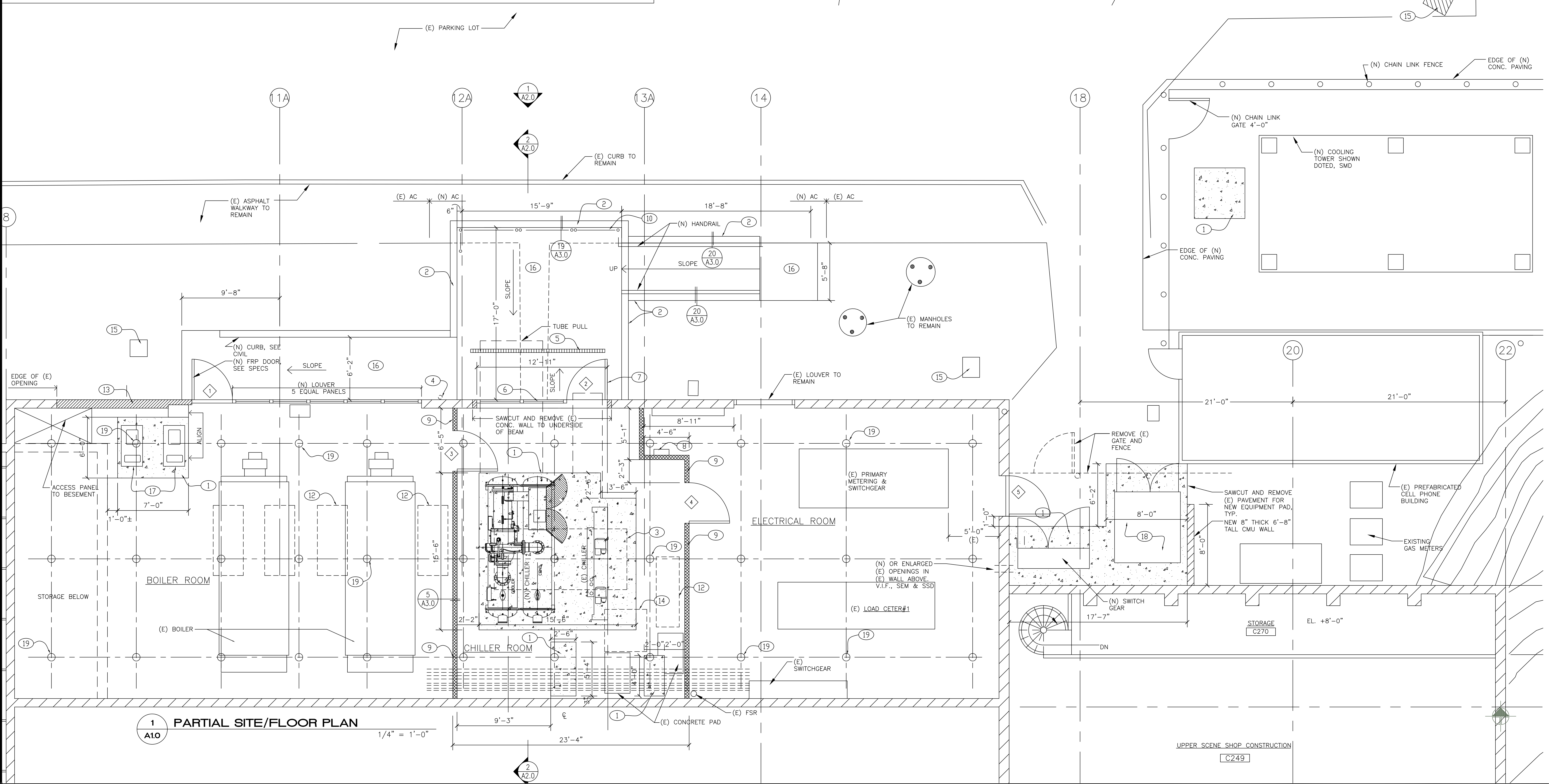

**ChevronTexaco**  
Chevron Energy Solutions Company  
A Division of Chevron U.S.A., Inc.

REV. DATE BY DESCRIPTION

11/01/06 CLOSEOUT DOCUMENTS

REGISTERED ARCHITECT  
Christopher Hall  
REN. 12/31/05  
NO. C15916  
STATE OF CALIFORNIA

IDENTIFICATION STAMP  
DIVISION OF THE STATE ARCHITECT  
FILE #41-C1  
APPLICATION NUMBER: 106992  
DATE: 11/01/06

**Canada College Modernization**  
CENTRAL PLANT RENOVATION  
San Mateo County Community College District

Partial Site/  
Floor and Roof  
Plans

SCALE: as shown  
PROJECT NO.:  
DESIGNED BY:  
CHECKED BY:  
DATE: 6/3/05  
SHEET NO.:  
SHEET TOTAL:  
FILE NAME:

**A1.0**