

College of San Mateo

Building 15 Modernization San Mateo County Community College District

ARCHITECT OF RECORD
noll & tam
architects and planners
729 Heinz Avenue
Berkeley, CA 94710
510.649.8295
fax 510.649.3008

PROJECT TEAM

Designer / Builder

Pankow Special Projects
2101 Webster Street, Suite 1500
Oakland, CA 94612
Tel: 510.893.5170
FAX: 510.893.8950

Architects

Noll & Tam Architects
729 Heinz Avenue, Suite 7
Berkeley, California 94710
Tel: 510.649.8295
FAX: 510.649.3008

Structural Engineers

KPFF Consulting Engineers
1160 Battery Street, Suite 300
San Francisco, California 94111
Tel: 415.989.1004
FAX: 415.989.1552

Design-Build Mechanical

ACCO Engineered Systems
1133 Aladdin Avenue
San Leandro, CA 94577
Tel: 510.346.4300
FAX: 510.347.1317

Design-Build Plumbing

L.J. Kruse
920 Pardee Street
Berkeley, CA 94710
Tel: 510.644.0260
FAX: 510.849.9909

Design-Build Electrical

Cupertino Electric, Inc.
1470 Caesar Chavez
San Francisco, CA 94142
Tel: 415.970.3442
FAX: 415.970.3434

LOCAL FIRE AUTHORITY REVIEW

SEE SHEET R-2

CAMPUS ACCESSIBILITY

SEE SHEET R-1

GENERAL SITE PLAN - EXISTING

SCALE: 1" = 120'-0"

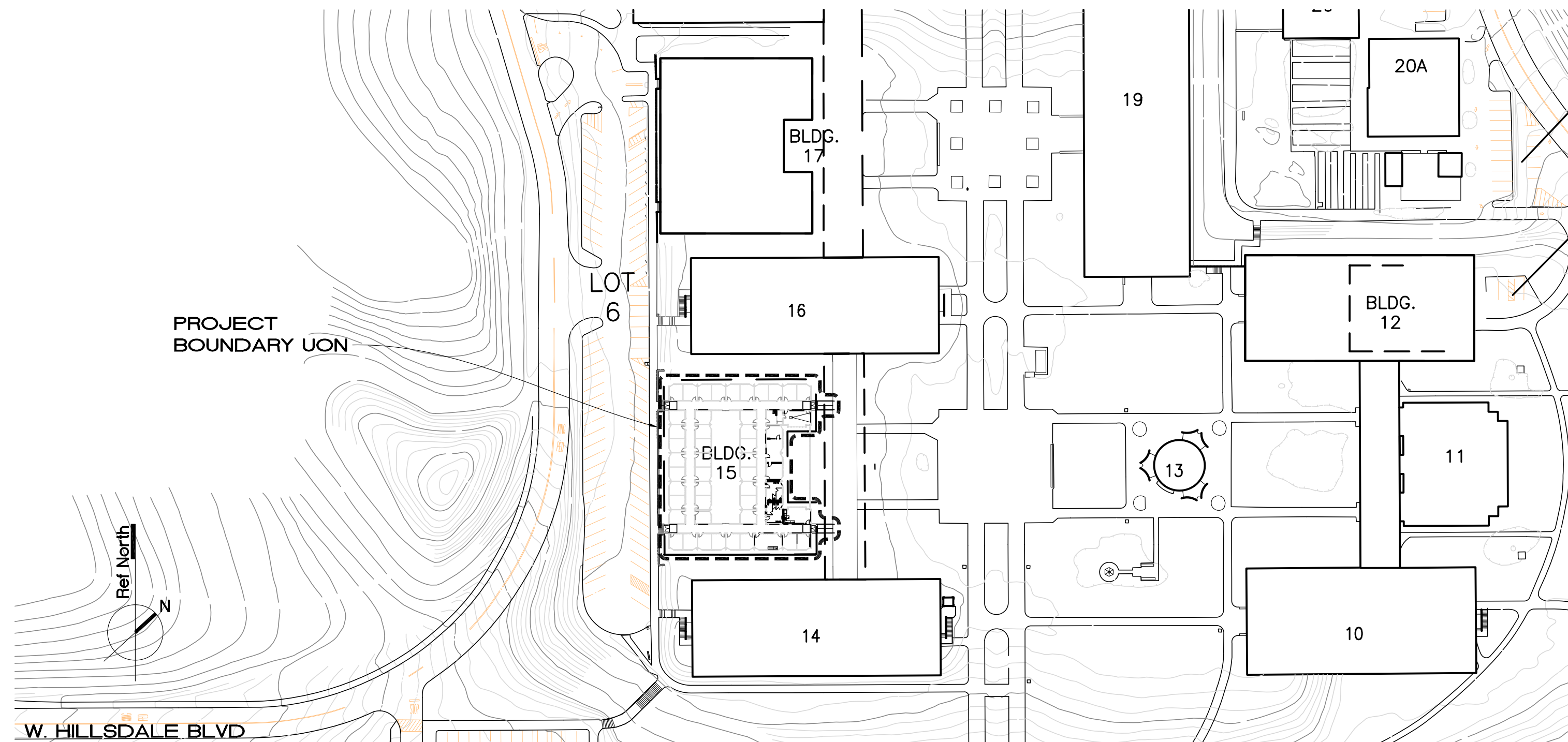

VICINITY MAP

NOT TO SCALE

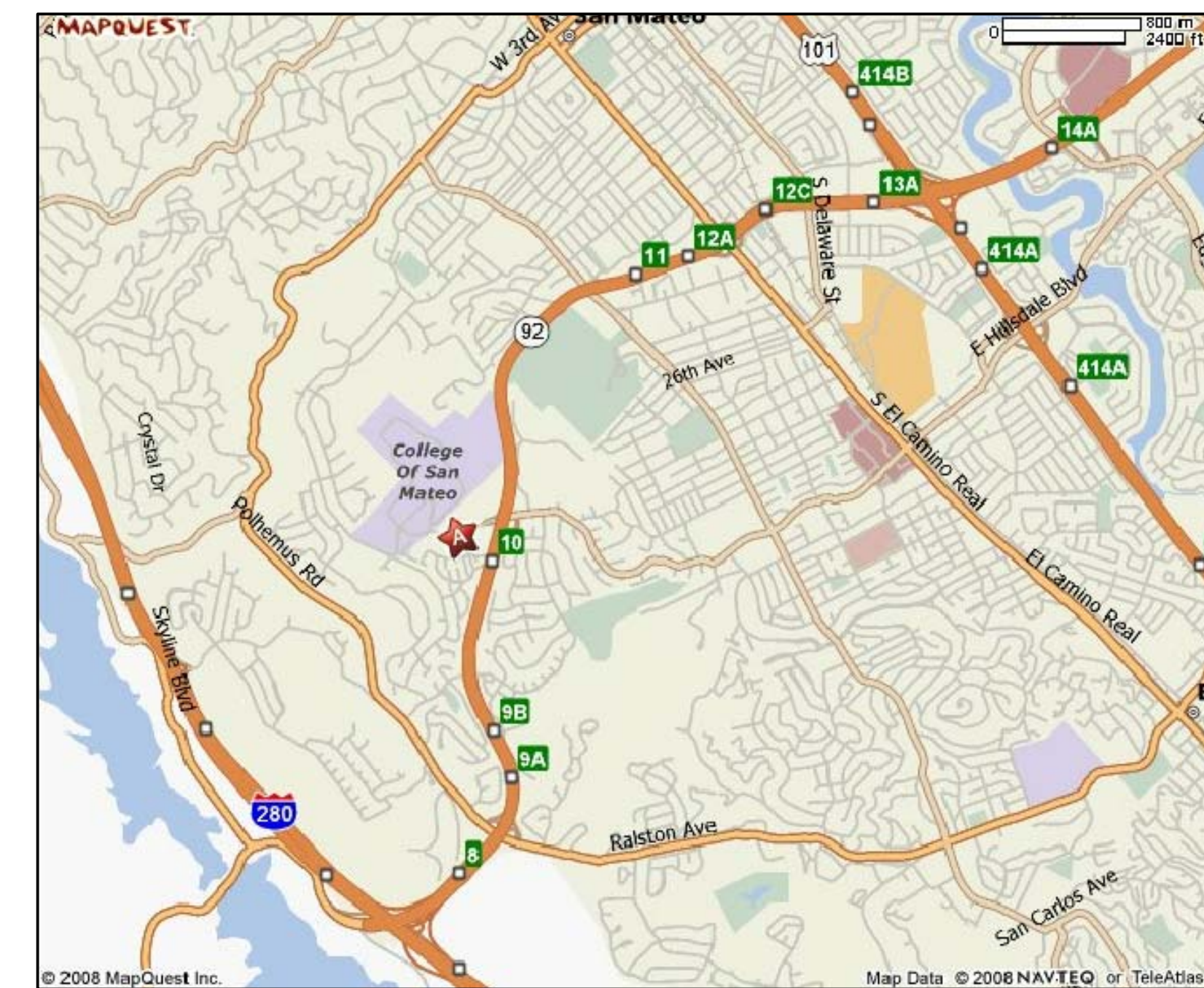

CODE COMPLIANCE

2007 CBC, TITLE 24 CCR (WITH 2007 AMMENDS.)

- Part 1 Building Standards Administrative Code

Part 2 California Building Code (CBC)

Part 3 California Electrical Code (CEC)

Part 4 California Mechanical Code

Part 5 California Plumbing Code

Part 6 California Energy Code

Part 9 California Fire Code

Part 12 California Referenced Standards Code

State Fire Marshal Regulations
National Reference Standards

ADA Code of Federal Regulations including Amendments

ASD(AISC) Manual of Steel Construction, 9th Edition

ACI-318-95 Code & Commentary

2002 NFPA 13 Installation of Sprinkler Systems

2003 NFPA 14 Installation of Standpipe, Private Hydrant
and Hose Systems

2002 NFPA 17A to a UL 300 for Class I Hood Fire
Suppression System. (Wet Chemical Extinguishing Systems)

2002 NFPA 24 Installation of Private Fire Service Mains
and Their Appurtenances

2002 NFPA 72 National Fire Alarm Code
NFPA 90A, 2002 Edition

CHAPTER 4 PART 1, TITLE 24 C.C.R. ADMINISTRATIVE REQUIREMENTS (PARTIAL LISTING ONLY)

- A copy of Parts 1 and 2, Title 24, C.C.R. shall be kept on the job site at all times.
- All change orders and addend to be signed by the Architect and the Owner and approved by DSA. Change orders are not valid until approved by DSA Section 4-338, Part 1, title 24.
- All tests to conform to the requirements of Section 4-335, Part 1, Title 24, and approved T & I sheet. Tests of materials and testing laboratory shall be in accordance with Section 4-335 of Part 1, Title 24 and the District shall employ and pay the laboratory. Costs of re-test may be back charged to the Contractor.
- DSA shall be notified at the start of construction and prior to the placement of concrete per Section 4-331, Part 1, Title 24.
- Inspector shall be approved by DSA. Inspector shall be in accordance with Section 4-333(b). The duty of the Inspector shall be in accordance with Section 4-342, Part 1, Title 24.
- Supervision of Construction by DSA shall be in accordance with section 4-334, Part 1, Title 24.
- Contractor, Inspector, Architect, and Engineers shall submit verified reports (Form SSS-6) in accordance with Section 4-336 and 4-343, Part 1, Title 24.
- The Architect and the Structural Engineer shall perform their duties in accordance with Section 4-33(a) and 4-341, Part 1, Title 24.
- The Contractor shall perform his duties in accordance with Section 4-343, Part 1, Title 24.
- The intent of the drawings and specifications is to construct the school building in accordance with Title 24, C.C.R. Should any conditions develop not covered by the contract documents wherein the finished work will not comply with Title 24, C.C.R., a change order detailing and specify the required work shall be submitted to and approved by the Office of Regulation Services before proceeding with the work.

DIVISION OF THE STATE ARCHITECT REQUIREMENTS

- Addenda and Changes as per Section 4-338.
- Inspector approved by DSA.
- Inspector and Continuous inspection of work per Section 4-333(b) and 4-342.
- Tests and testing laboratory per Section 4-335 (Owner shall pay the testing laboratory).
- Special inspection per Section 4-333(c).
- Contractor shall submit verified report per section 4-336 & 4-343 (c).
- Administration of Construction per Part I, Title 24, C.C.R.
- Duties of Architect, Structural Engineer, or Professional Engineer per Section 4-333(a) and 4-341.
- Duties of contractor per Section 4-343.
- Verified Reports per Section 4-336.
- A copy of Part 1 & 2 of Title 24, shall be kept and available in field during Construction.
- DSA shall be notified on start of construction per Section 4-331.
- Supervision by DSA per Section 4-343.
- DSA is not subject to arbitration.

SCOPE OF WORK

BUILDING 15:

- MODERNIZATION OF EXISTING RESTROOMS
- DOOR HARDWARE UPGRADES IN HALLWAYS
- INSTALLATION OF SUSPENDED ACOUSTIC CEILING IN HALLWAYS
- INTERIOR IMPROVEMENTS TO THE FOLLOWING ROOMS:
WORK ROOM 15-113
MEETING ROOM 15-155
DEAN'S OFFICE 15-166
DIVISION OFFICE 15-168
BREAK ROOM 15-114
- ENLARGING DOORS TO THE FOLLOWING ROOMS TO BE 3'-0":
WORK ROOM 15-113
MEETING ROOM 15-155
DEAN'S OFFICE 15-166
DIVISION OFFICE 15-168
BREAK ROOM 15-114
WOMEN 15-162
MEN 15-164
- NEW ENTRANCE DOORS AND RAMPS
- SIGNAGE

ARCHITECT'S STATEMENT

With the exception of the General (G Series) and Architectural (A Series) these drawings and/or specifications and/or calculations for the items listed above have been prepared by other design professionals or consultants who are licensed and/or authorized to prepare such drawings in this state. These documents have been examined by me for design intent and appear to meet the appropriate requirements of Title 24, California Code of Regulations and the project specifications prepared by me.

The items listed above have been coordinated with my plans and specifications and are acceptable for incorporation into the construction of this project for which I am the individual designated to be in general responsible charge.

The accepted drawings are listed above.

Christopher Noll, Principal
NOLL & TAM Architects

Date

CA License No C15915

Expiration Date: 12/31/09

IDENTIFICATION STAMP DIVISION OF THE STATE ARCHITECT

APPLICATION NUMBER 01 XXXXXX
AC _____ FLS _____ SS _____
DATE _____

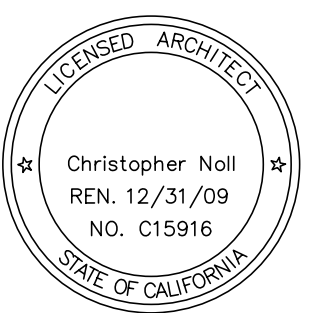

DSA SUBMITTAL

COLLEGE OF SAN MATEO BUILDING 15 MODERNIZATION

SMCCCD
3401 CSM Drive
San Mateo, CA 94402
College of San Mateo
1700 W. Hillsdale Blvd.
San Mateo, CA 94402

SHEET TITLE

Cover Sheet

REVISIONS

NO.	DATE	DESCRIPTION

DATE MARCH 9, 2009

DRAWN CB

CHECKED JC

SCALE NA

N&T JOB NO.: 2901

SHEET NUMBER

COVER