

IDENTIFICATION STAMP
DIV. OF THE STATE ARCHITECT
OFFICE OF REGULATION SERVICE

APPL # 01-110097

AC: RLS SS SS
DATE: APR 09 2009

FILE NUMBER:

This set of other project documents and all files, notations and design incorporated herein are instruments of service. All project documents are the registered property of LPA, Inc. and cannot be used for any other project or for any other project or purpose without the written consent of LPA, Inc. The user of these documents shall be deemed to have accepted the responsibility for any errors or omissions in these documents and shall be held liable for any damages or losses resulting therefrom. LPA, Inc. and its consultants shall not be held liable for any damages or losses resulting from the use of these documents in any way other than that intended by LPA, Inc. and its consultants. LPA, Inc. and its consultants shall not be held liable for any damages or losses resulting from the use of these documents in any way other than that intended by LPA, Inc. and its consultants. LPA, Inc. and its consultants shall not be held liable for any damages or losses resulting from the use of these documents in any way other than that intended by LPA, Inc. and its consultants.

© Copyright 2008

College of San Mateo
Site Package
San Mateo, CA

Developed for
San Mateo County Community College District

Revision	Description	Date

Revision	Description	Date

Job No.	27082.30
Date	09 APRIL 2009
Drawn by	AG, RF
Checked by	SM
Scale	1" = 20'-0"

IRRIGATION PLAN
L5.01

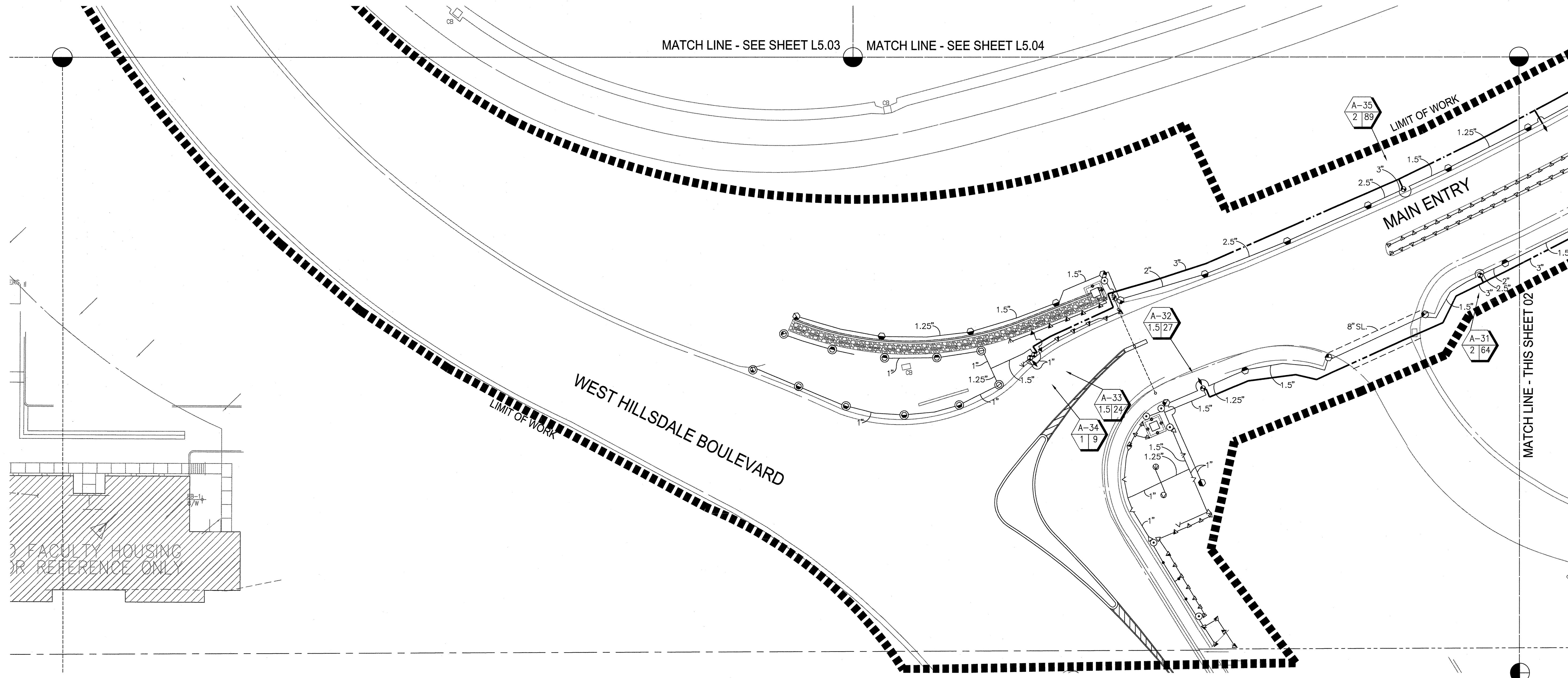

- NOTES:
- ONE BUBBLER SYMBOL IS SHOWN AT TREES FOR GRAPHIC CLARITY ONLY. INSTALL TWO BUBBLERS AT EACH TREE AS DETAILED.
 - IRRIGATION EQUIPMENT MAY BE SHOWN WITHIN HARDSCAPE FOR GRAPHIC CLARITY ONLY. INSTALL ALL IRRIGATION EQUIPMENT WITHIN PLANTED AREAS. IRRIGATION PIPE AND WIRE CROSSING BENEATH HARDSCAPE SURFACES SHALL BE CONTAINED WITHIN SLEEVING OR SCHEDULE 40 PVC CONDUIT. SLEEVING SIZE SHALL BE A MINIMUM OF TWO TIMES THE AGGREGATE DIAMETER OF ALL PIPES CONTAINED WITHIN SLEEVE. PROVIDE VERTICAL SWEEP FOR ALL ELECTRICAL CONDUIT ON EACH SIDE OF HARDSCAPE AND TERMINATE ENDS AT 12" MINIMUM DEPTH AND 12" FROM HARDSCAPE SURFACE.
 - UNSIZE LATERAL LINE PIPING LOCATED DOWN STREAM OF 1" PIPING SHALL BE 3/4" IN SIZE (TYPICAL).
 - SIZING OF LATERAL PIPE SHALL BE AS FOLLOWS:

.75"	0-6 GPM
1"	7-12 GPM
1.25"	13-20 GPM
1.5"	21-32 GPM
2"	33-50 GPM
2.5"	51-70 GPM
3"	71-120 GPM

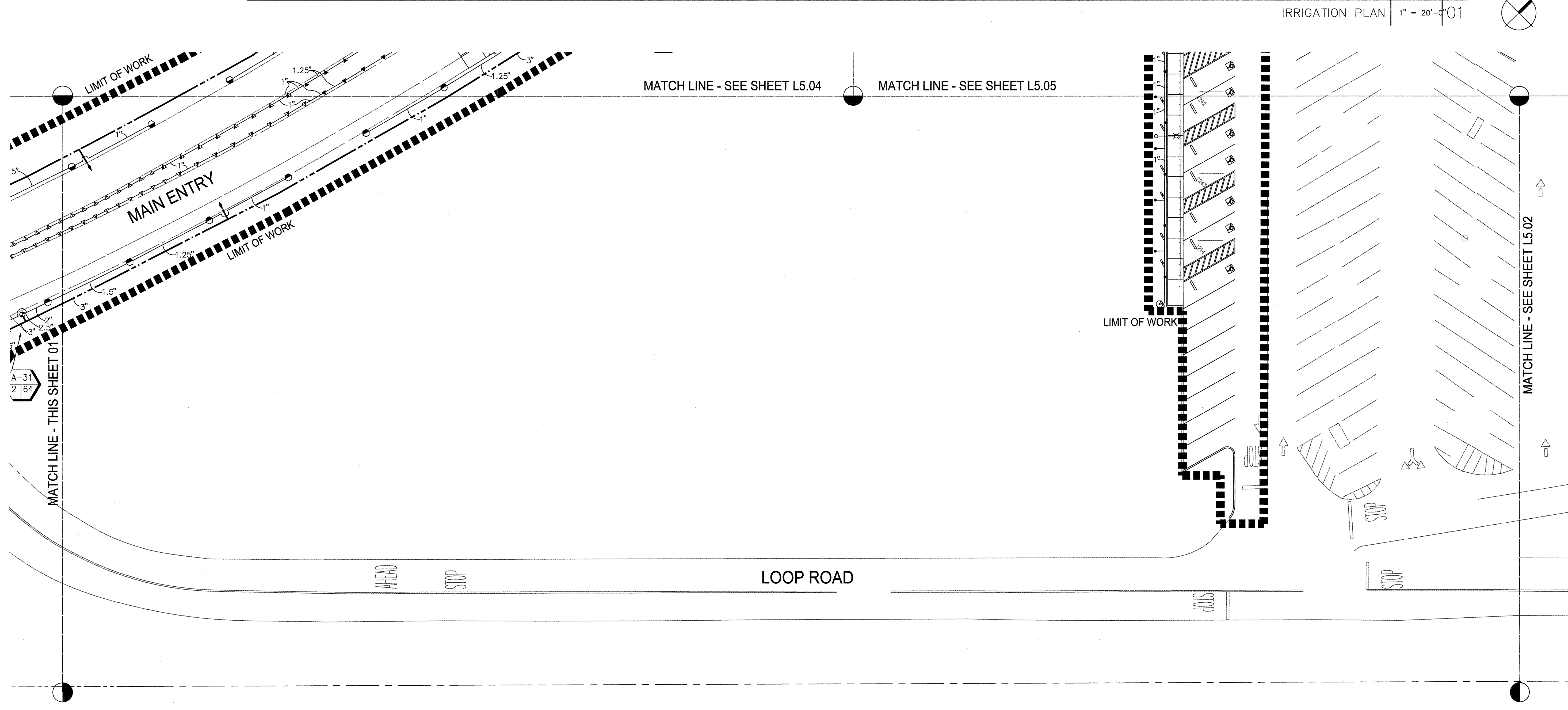

IRRIGATION PLAN | 1" = 20'-0"

Prepared by:
Russell D. Mitchell Associates, Inc.
2760 Camino Del Rio
Marina del Rey, CA 90292
Phone (310) 335-3450
Fax (310) 335-3471
RMA@MARRIGATION.COM