

The lighting calculations provided in this report approximate the light levels expected within the space as defined and are based on the information provided to Cal Lighting. Please verify the data to assure the accuracy of the report. Cal Lighting is not responsible for light output of lamps and ballasts, or design variables.

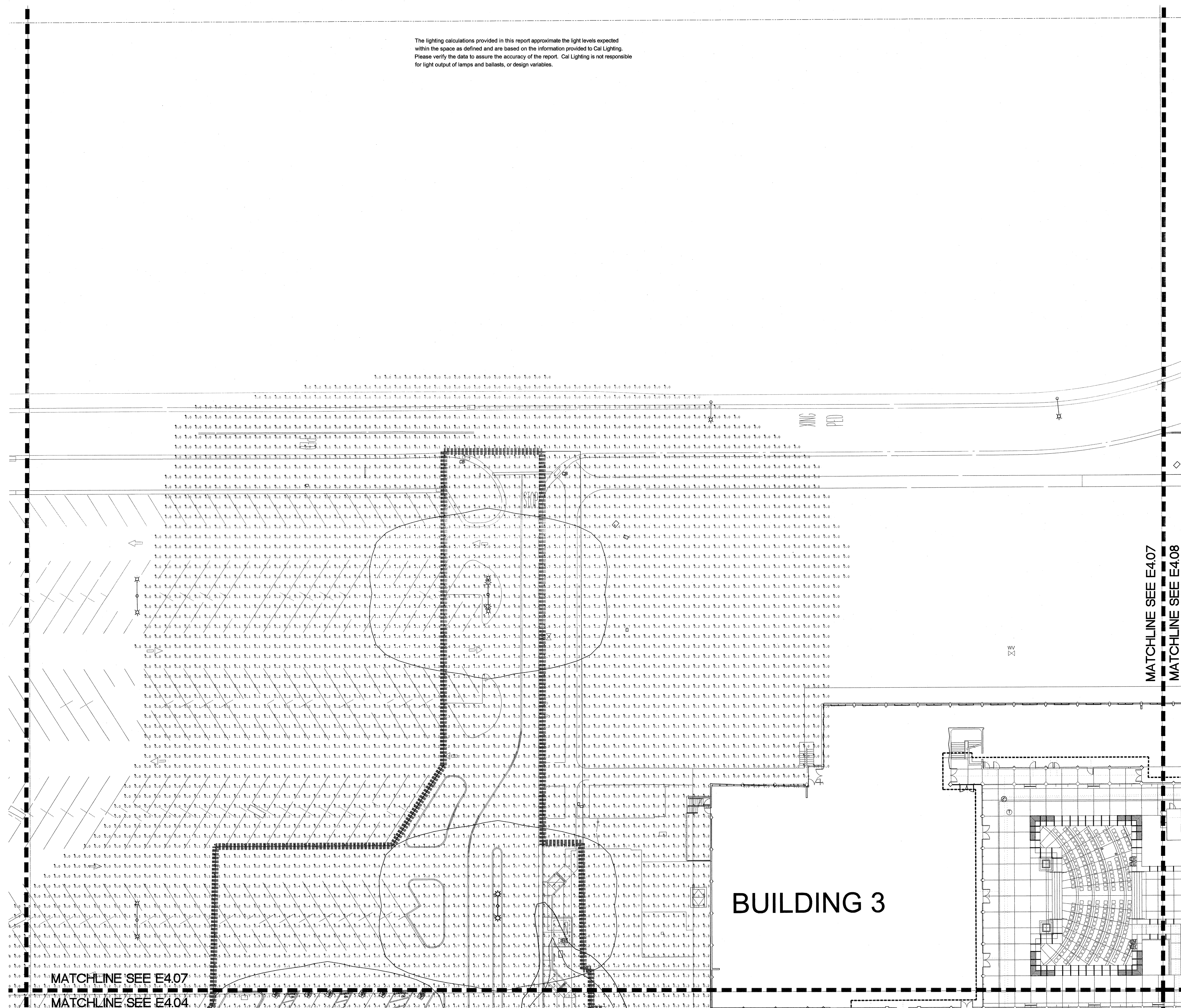

BUILDING 3

MATCHLINE SEE E4.07  
MATCHLINE SEE E4.08

MATCHLINE SEE E4.07  
MATCHLINE SEE E4.04

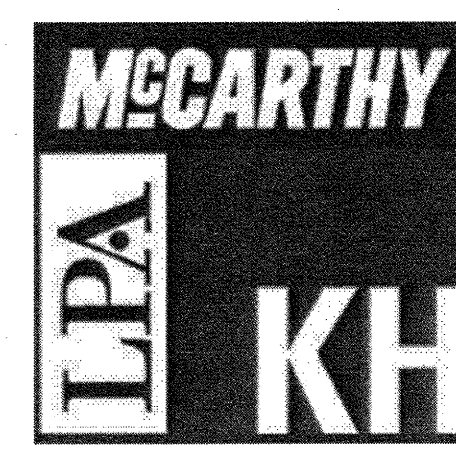

McCarthy Building Companies, Inc.  
343 Sansome Street, 14th Floor  
San Francisco, California 94104  
P 415 | 364-1339  
F 415 | 397-5999

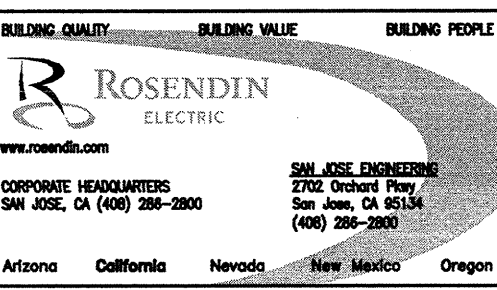

IDENTIFICATION STAMP  
DIV. OF THE STATE ARCHITECT  
OFFICE OF REGULATION SERVICE  
APPL. # 01-110097  
AC. RLS SS P.M.  
DATE APR 09 2009  
FILE NUMBER:

The use of other project documents and all data, including but not limited to, drawings, specifications, and reports, is subject to the provisions of the contract documents. The architect is not responsible for the accuracy of information provided by others. The architect is not responsible for the accuracy of information provided by others. The architect is not responsible for the accuracy of information provided by others.

Copyright 2008

College of San Mateo  
Site Package  
San Mateo, CA  
Developed for  
San Mateo County Community College District

Date	Revision	Description

Date	Description
19 SEPT 2008	DSA SUBMITTAL
09 APRIL 2009	DSA FINAL

Job No.	300065
Date	09 APRIL 2009
Drawn by	REI CAD TEAM
Checked by	THSR/SHV
Scale	AS SHOWN
Site Lighting Plan - Ltg. Extended Photometric <b>E4.07</b>	