

MATCH LINE - SEE SHEET C6.03

MATCH LINE - SEE SHEET C6.04

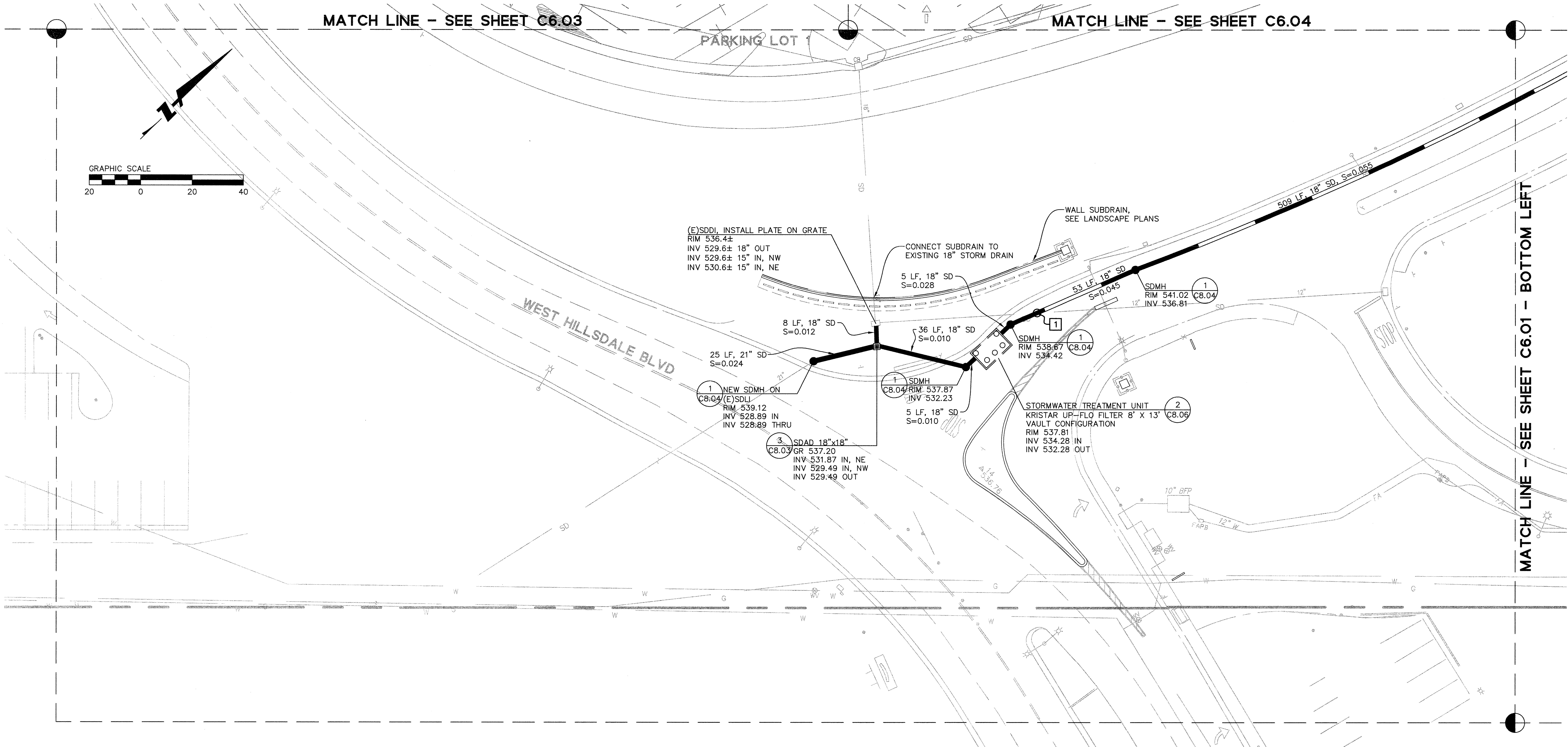
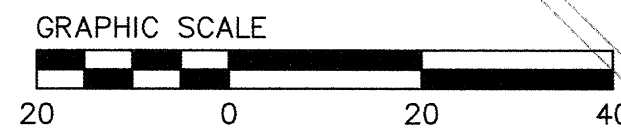

MATCH LINE - SEE SHEET C6.01 - BOTTOM LEFT

MATCH LINE - SEE SHEET C6.04

MATCH LINE - SEE SHEET C6.05

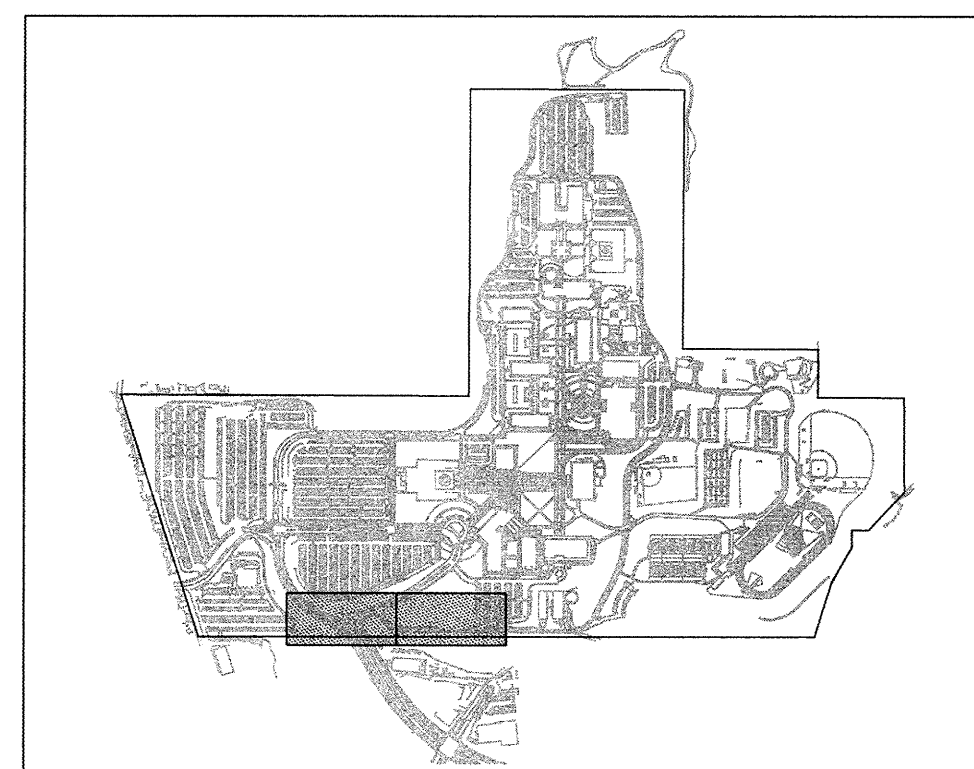

KEYMAP

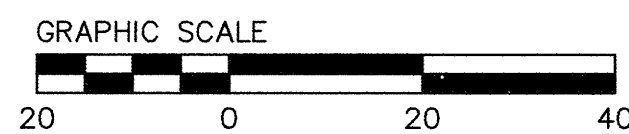

UTILITY NOTES

1. REFER TO SHEETS C8.03 THROUGH C8.05 FOR UTILITY DETAILS.

MATCH LINE - SEE SHEET C6.01 - TOP RIGHT

MATCH LINE - SEE SHEET C6.02

CROSSING/CONNECTION INVERT TABLE		
NO.	UTILITY SIZE	INV. ELEV.
1	(E) 15" SD	532.09
	18" SD	535.38
2	(E) 8" SS	579.27
	12" SD	576.77
3	6" SD	576.23
	8" W	574.06
4	6" SD	577.15
	8" SS	575.18
5	8" SS	575.22
	8" W	573.05
6	6" SD	576.88
	8" W	574.71
7	6" SS	578.24
	8" SS	574.90
8	8" W	572.52
	12" SD	574.69
9	8" SS	577.94
	12" SD	573.24
10	8" SS	573.70
	8" W	576.01
11	(E) 8" W	577.94
	8" SS	573.24
12	6" SD	578.09
	6" SD	578.09
13	6" SD	578.19
	8" SS	575.95
14	6" SD	578.29
	8" W	575.05
15	6" SD	578.09
	6" SD	578.09
16	6" SD	578.53
	8" SS	576.49
17	6" SD	578.27
	8" W	576.60
18	6" SD	579.16
	6" SD	579.16
19	6" SD	579.45
	6" SD	577.22
20	6" SS	577.37
	8" W	580.20
21	6" SS	577.27
	6" SD	577.06
22	(E) 8" SS	578.25
	12" SD	581.29
23	4" SD	579.78
	6" SD	578.78
24	4" SS	579.18
	8" SS	579.01
	12" SD	585.07
25	(E) 8" W	583.42
	8" SS	579.48
26	(E) 8" W	583.50
	12" SD	583.67
27	12" SD	587.04
	12" SD	587.04
28	4" SD	593.73
	12" SD	587.11
29	4" SD, NE	592.83
	4" SD, SW	593.15
	12" SD, THRU	587.23
30	8" SD	591.94
	12" SD	591.22
31	(E) 3" HWS/HWR	599.50
	12" SD	593.81
32	(E) 2" HWS/HWR	593.00
	8" SD	590.72
	8" SD	590.72
33	4" SD	591.39
	6" SD	591.22
34	(E) 8" SS	582.98
	4" SD	590.34
	6" SD	590.17
35	6" SD	590.28
	8" SD	590.11
36	(E) 8" W	593.79
	6" SD	590.60
37	6" SD	590.06
	8" SD	589.89
38	6" SS	582.98
	8" SD	589.77
39	(E) 8" SS	582.73
	6" SS	582.90
40	(E) 8" SS	582.66
	6" SS	582.83
41	(E) 8" SS	581.88
	6" SS	588.33
42	8" SD	589.25
	8" SD	589.25
43	(E) 8" W	591.72
	8" SD	589.20
44	8" SD	588.98
	8" SD	588.98
45	(E) 3" HWS/HWR	595.69
	6" SD	593.76
	8" SD	588.76
46	(E) 3" HWS/HWR	595.69
	12" SD	587.83
47	6" SD	588.60
	12" SD	588.10
48	6" SD	588.93
	8" SD	583.61
49	4" SD, NE	593.85
	4" SD, SW	593.85
	6" SD	589.05
50	4" SD	593.60
	6" SD	592.31
51	6" SD	593.63
	6" SD	593.63
52	6" SD	594.25
	6" SD	584.30
53	(E) 3" HWS/HWR	596.23
	2 - 6" CWS/CWR	593.26
54	6" SD	596.08
	12" SD	594.11
55	2 - 6" CWS/CWR	594.19
	6" SD	596.19
56	2 - 6" CWS/CWR	597.22
	6" SD	588.09
57	2 - 6" CWS/CWR	595.75
	6" SD	597.25
58	6" SD	597.05
	12" SD	585.25
59	6" SD	598.60
	12" SD	595.57
60	(E) 4" HWS/HWR	600.89
	8" SD	597.15
61	(E) GAS	600.50
	8" SD	597.19
62	(E) GAS	602.72
	8" SD	602.85
	2 - 6" CWS/CWR	599.39
63	2 - 6" CWS/CWR	597.95
	6" SD	599.45
64	1.5" HWS/HWR	603.75
	6" SD	600.62
65	(E) 8" W	608.47
	8" SD	605.68
66	(E) 8" SD	615.25
	6" SD	610.35
67	(E) 8" SD	615.62
	6" SD	615.79
68	(E) 8" SD	615.10
	6" SD	615.36
69	2 - 4" CWS/CWR	600.67
	6" SD	598.36
70	2 - 6" CWS/CWR	600.76
	6" SD	598.72

NOTE: PROVIDE A MINIMUM OF 12" OF VERTICAL CLEARANCE BETWEEN UTILITIES CROSSING PRESSURIZED UTILITIES.

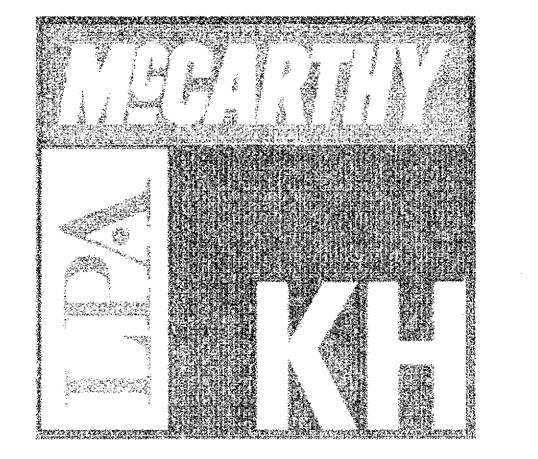

McCarthy Building Companies, Inc. 343 Sansome Street, 14th Floor San Francisco, California 94104 P 415 364-1339 F 415 397-5999



BKF ENGINEERS | SURVEYORS | PLANNERS 255 SHORELINE DRIVE, SUITE 200 REDWOOD CITY, CA 94065 PHONE: (650) 482-3300 FAX: (650) 482-6399

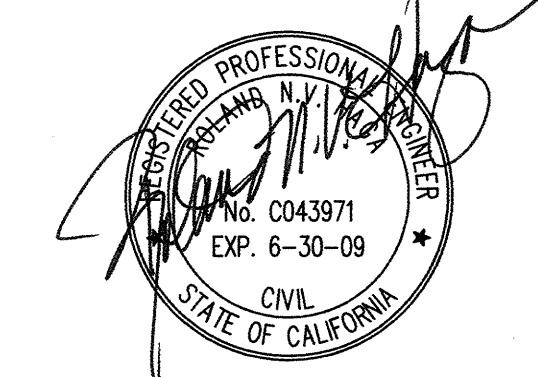

IDENTIFICATION STAMP DIV. OF THE STATE ARCHITECT OFFICE OF REGULATION SERVICE APPL # 01-110097

This and all other project documents and all data, including... (small text disclaimer)

Copyright 2008

College of San Mateo Site Package San Mateo, CA Developed for San Mateo County Community College District

Table with columns: Date, Revision, Description

Table with columns: Date, Revision, Description

Table with columns: Job No., Date, Drawn by, Checked by, Scale