

SAN MATEO COUNTY  
**COMMUNITY**  
COLLEGE DISTRICT

FACILITIES PLANNING,  
MAINTENANCE & OPERATIONS

# Capital Improvement Program Phase 3(CIP3)

MAY 20<sup>TH</sup>, 2015

SKYLINE COLLEGE CIP3 UPDATE FORUM



# Agenda

---

- CIP3 Planning Efforts
- Program Budget Overview
- Program Overview
  - Skyline College Building 1N
  - Skyline College Building 12N
- Tentative Schedule
- Pacific Heights (B19)
  - Swing Test Fit
  - Post Construction Test Fit
- Districtwide Project List
- Q & A

# CIP3 Planning Efforts

---

- Scheduling Consultant – Contract Awarded to AECOM (April 2015)
- Cost Estimating Consultant – Contract Awarded to Leland Saylor Associates (April 2015)
- California Environmental Quality Act (CEQA) – Completed (Winter 2015)
- Construction Management (PM/CM) – Contract Awarded to Swinerton (March 2015)
- Design Standards Revision – Completed (June 2015)
- Swing Space Planning (ONUMA) – In Progress
- Architect and Engineer (A&E) Selection for Design of First Wave Projects – Completed (April 2015)
- Design Build Entity Selection (CAN B1N, SKY B12N, CAN B23N, SKY B1N)– In Progress
- 2016 Annual General Contractor and Major Subcontractor Prequalification Process – Complete (Winter 2015/16)
- Project Labor Stabilization Agreement – Amendment Approved by BOT (March 2016), Execution in Process
- Contract Template Development – Completed (March 2016)

# Project Budget Overview

---



# Skyline College

---

Project	Recommended Project Budget
Social Science and Creative Arts (B1N)	\$160,000,000
Workforce and Economic Development Prosperity Center (FPP) (B2)	\$13,200,000
Library/Learning Resource (B5)	\$9,000,000
Environmental Science (B12N)	\$28,700,000
Early Childhood Education (B14)	\$1,500,000
Pac Heights (B19) & North Campus Improvements	\$23,000,000
Lot L Expansion	\$5,000,000
<b>Total:</b>	<b>\$240,400,000</b>

# Project Program Overview

---



# Skyline College Social Science and Creative Arts Building (B1)



# Skyline College Social Science and Creative Arts Building (B1)

---

- Budget \$160,000,000
  - Measure H
- Project Scope
  - Demolition of (E) Social Science and Creative Arts Building (B1) 72,853 GSF (79,453 – 6,600)
  - Retain and Protect 6,600 GSF of Level One during demolition and construction
  - Construct a New ~115,000 and renovate ~6,000 GSF Social Science and Creative Arts Building (B1)
  - Elements of the Program: 520 Seat New Theater w/Orchestra Pit, Scene Shop, Gallery, Music Choral Room/Recital Hall, Concert Band Room, Labs (Piano and MDI), Recording Rooms, Sculpture, Digital Arts, Art History, 2D Design, Photography, Social Sciences, Quad (Plaza) Extension
- Status
  - Programming completed September 2015
  - DBE Selection process begins August 2016
- Tentative Schedule
  - Target Occupancy Q1 2020





# Skyline College Environmental Studies Building (B12N)

---

- Budget \$28,700,000
  - Measure H
- Project Scope
  - Construct a New 21,060 GSF Environmental Studies Building (B12N)
  - Elements of the Program: (2) Flexible (Flat) 60 seat/each Classrooms, (2) Lecture (Tiered) 128 seat/each Classrooms, Event Space for 250 Occupants, Catering Kitchen, Entrance Lobby, Offices, Outdoor Lab, Connecting Corridor to Main Campus, Optimal Building Location (Panoramic View of Pacific Ocean)
- Status
  - Programming complete
  - DBE selection process begins May 30, 2016
- Tentative Schedule
  - Target occupancy Q1 2019

# Logistics



# Skyline College Pacific Heights (B19) B1 Swing Test Fit

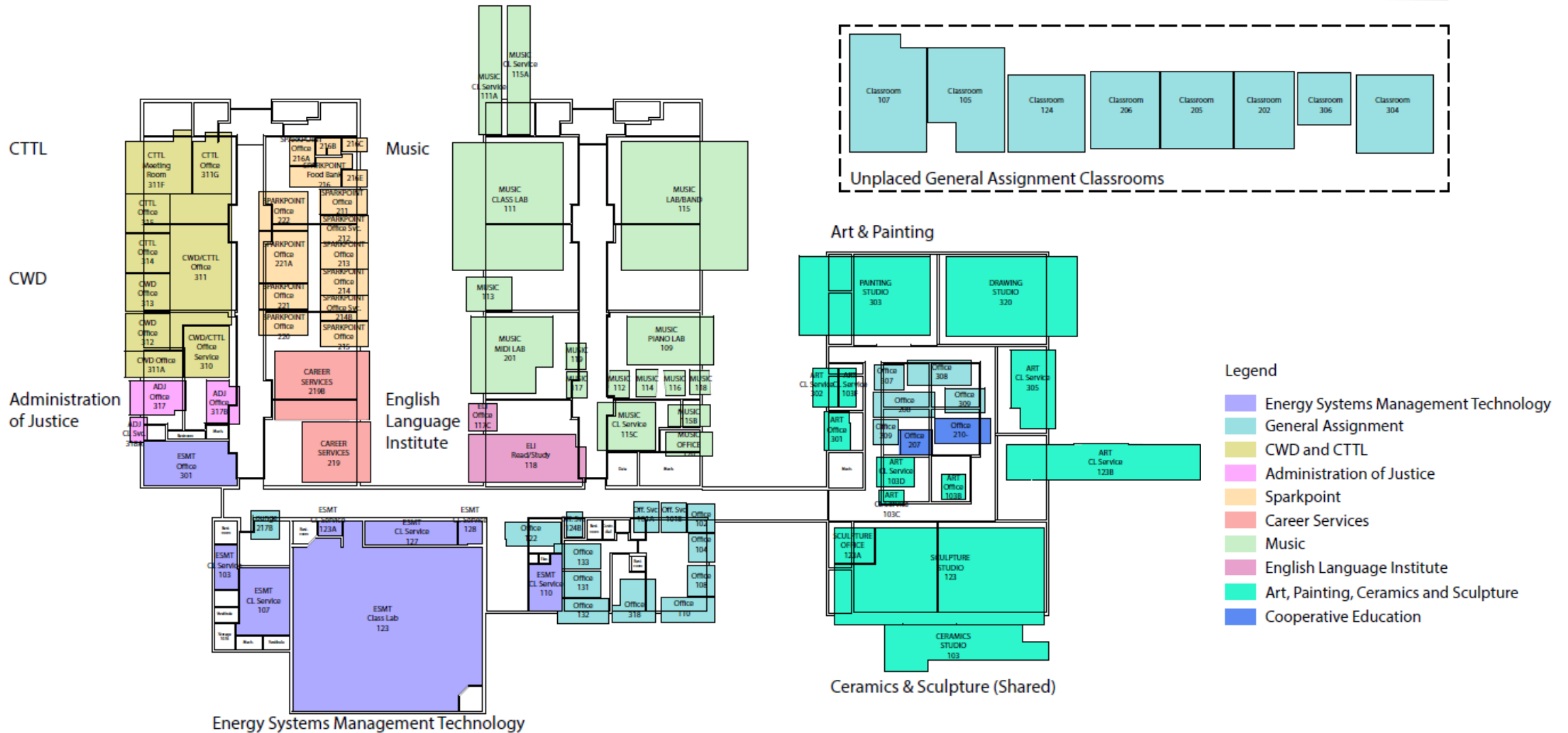

# Skyline College Pacific Heights (B19) Post Construction Test Fit

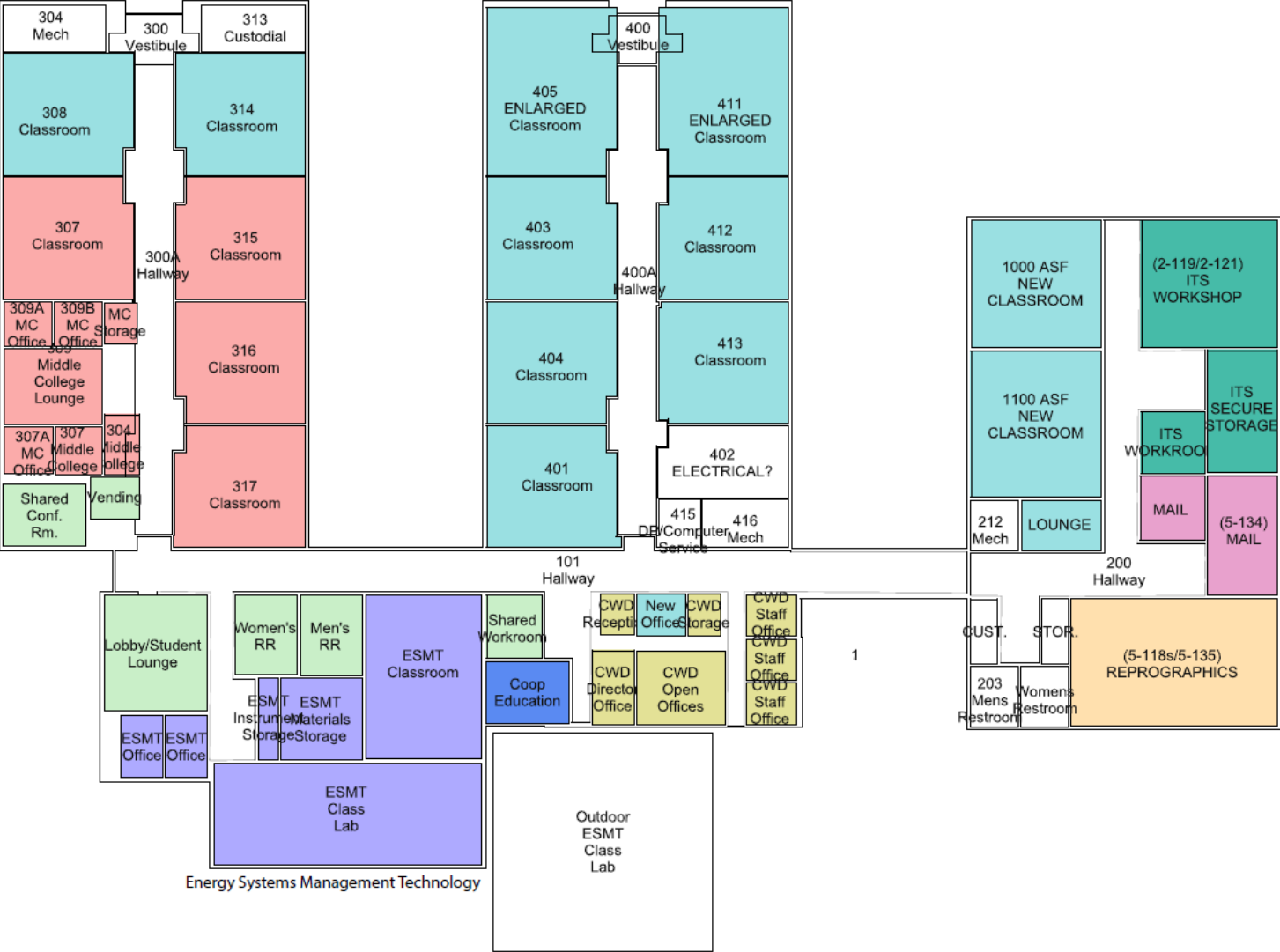

- Legend**
- Energy Systems Management Technology
  - General Assignment
  - CWD
  - Cooperative Education
  - Middle College
  - Shared Common Spaces
  - Information Technology Services (ITS)
  - Mail
  - Reprographics

# Skyline College Tentative Schedule\*

	2016					2017					2018					2019					2020					2021					2022					2023																																												
	A	M	J	J	A	S	O	N	D	J	F	M	A	M	J	J	A	S	O	N	D	J	F	M	A	M	J	J	A	S	O	N	D	J	F	M	A	M	J	J	A	S	O	N	D	J	F	M	A	M	J	J	A	S	O	N	D	J	F	M	A	M	J	J	A	S	O	N	D	J	F	M	A	M	J	J	A	S	O	N
<b>SKY Lot L Expansion</b>	Design		DSA			Bid					Construction																																																																					
<b>SKY B12</b>	RFSOQ/P		Design			DSA					Construction																																																																					
<b>SKY B19 Pac Hts</b>	Design - Swing Space					Bid					Construction										Design - Building Modernization					Bid					Construction																																																	
<b>SKY B1</b>	RFSOQ/P		Design			DSA					Construction																																																																					
<b>SKY B2**</b>						Design			DSA		Bid					Construction																																																																
<b>SKY B5</b>											Design		DSA			Bid					Construction																																																											

\*Schedule is subject to change due to agency requirements, unforeseen conditions, and/or design build contractor input  
 \*\* Subject to identifying swing space

# Districtwide Project List

Project	Recommended Project Budget
DW Instructional Equipment	\$0
Parking Lot and Roadway Repair/Resurface	\$15,000,000
Campus Utilities Upgrades and Repairs	\$10,000,000
Network Infrastructure & Phone System Upgrade	\$10,000,000
Swing Space	\$3,000,000
Surveillance/Camera/ACAMs/EAS Upgrades	\$0
Technology Upgrades	\$0
Data Center	\$0
Renewable and Sustainable Energy Projects	\$0
<b>Total:</b>	<b>\$38,000,000</b>

# Questions and Answers



Cañada College • College of San Mateo • Skyline College